

4

3

2

1

REVISIONS				
ZONE	LTR	DESCRIPTION	DATE	APPROVED
-	N/C	INITIAL RELEASE, ECN#T-4209	7-13-83	93

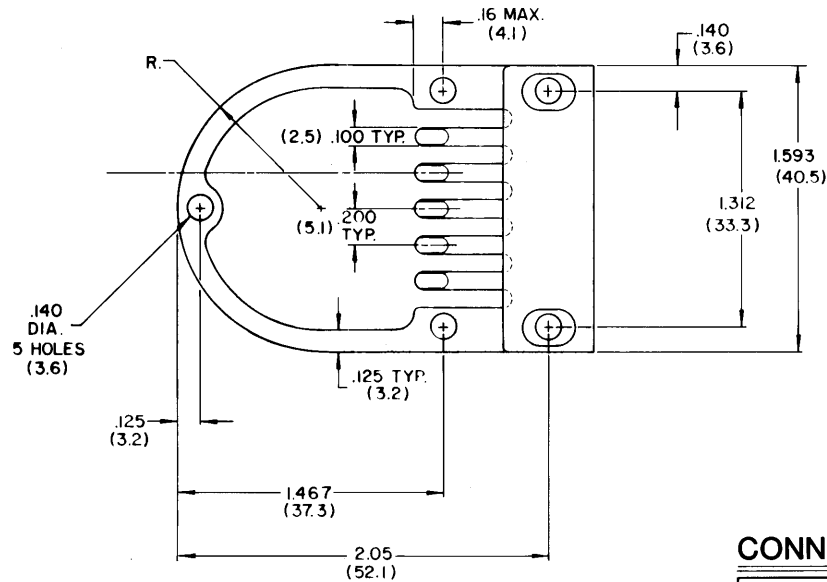
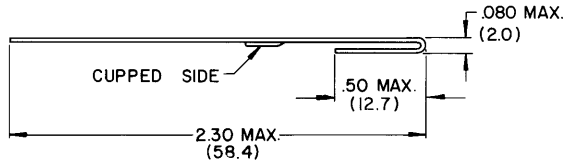

NOTES:

1. TERMINATING BUSS MATERIAL:
.020 COPPER ALLOY TIN PLATED.
2. BUSS TABS ARE DESIGNED TO TERMINATE THE FOLLOWING SHIELDED CABLE CONSTRUCTIONS:
88BII1, 20 THRU 26 AWG
88BII2, 20 THRU 26 AWG
88BII3, 20 THRU 26 AWG
88BII4, 20 THRU 26 AWG

Raychem Corporation 1983

CONNECTOR SPECIFICATION CONTROL DRAWING

UNLESS OTHERWISE SPECIFIED DIMENSIONS ARE IN INCHES BRACKETED DIMENSIONS () ARE METRIC AND TOLERANCES ARE: .xxx: ± .010 .xx: ± .03 Δ: ±	DRAWN	PIERCE	6-83	Raychem <small>RAYCHEM CORPORATION 300 CUNNINGHAM DRIVE MENLO PARK, CALIF. 94025</small>
	CHECKED	<i>[Signature]</i>	6-83	
	APPROVED	<i>[Signature]</i>	7-13-83	
	APPROVED	<i>[Signature]</i>	11-83	
				TITLE SHIELD, EMI BACKSHELL
				SIZE C
				CODE IDENT NO. 06090
				DWG. NO. D-659-0088
				WEIGHT
				SHEET
				OF

DO NOT SCALE THIS DRAWING

X-ON Electronics

Largest Supplier of Electrical and Electronic Components

Click to view similar products for [Solder Sleeves & Shield Tubing](#) category:

Click to view products by [TE Connectivity](#) manufacturer:

Other Similar products are found below :

[D-260-C-A](#) [899170-000](#) [620040N001](#) [620069N003](#) [620263N004](#) [CTA-0050-01](#) [629624-000](#) [6501390002](#) [CX0781-000](#) [CX0782-000](#)
[696396-000](#) [697080-000](#) [715325N001](#) [FLX40-030-02-CS8652](#) [908357N001](#) [D-436-38CS2908](#) [CB0213-000](#) [CB0219-000](#) [274384-000](#)
[285343-000](#) [970053-000](#) [ST18-2-00](#) [FLX40-020-04-CS8651](#) [317035-000](#) [325534-000](#) [D-100-00-WOTI](#) [D-150-1011](#) [395947-000](#)
[427243N001](#) [514535-000](#) [C03534-000](#) [CB0220-000](#) [D44133N001](#) [626168-000](#) [451893-000](#) [931289-000](#) [162583-000](#) [585769N001](#)
[610001N004](#) [6200060004](#) [622041N003](#) [626167-000](#) [EG3678-000](#) [650075N002](#) [6500820003](#) [6500850004](#) [650126N010](#) [650127N005](#)
[146201-000](#) [7400720001](#)