

CUSTOMER DRAWING		SCALE 5:1	SHEET 1 OF 1	REV G2
DRAWING NO. 00779-641524		SIZE	DATE	REV
NAME MTA-156		DESCRIPTION	DATE	REV
POSTED CONNECTOR ASSEMBLY, 22 AWG		DESCRIPTION	DATE	REV
TE Connectivity		DESCRIPTION	DATE	REV

FINISH	NO. OF CIRCUITS	A	B	C
TIN-LEAD	2	11.89 [1.468]	8.03 [1.316]	3.96 [1.556]
TIN	3	15.85 [1.624]	11.99 [1.472]	7.92 [1.312]
TIN	4	19.81 [1.780]	15.95 [1.628]	11.89 [1.468]
TIN	6	27.74 [1.092]	23.88 [1.940]	19.81 [1.780]
TIN	9	39.62 [1.560]	35.76 [1.408]	31.70 [1.248]
TIN	12	51.51 [2.028]	47.65 [1.876]	43.59 [1.716]
TIN	15	63.40 [2.496]	59.54 [2.344]	55.47 [2.184]
TIN	24	99.06 [3.900]	95.20 [3.748]	91.14 [3.588]

FINISH	NO. OF CIRCUITS	A	B	C
TIN-LEAD	2	11.89 [1.468]	8.03 [1.316]	3.96 [1.556]
TIN	3	15.85 [1.624]	11.99 [1.472]	7.92 [1.312]
TIN	4	19.81 [1.780]	15.95 [1.628]	11.89 [1.468]
TIN	6	27.74 [1.092]	23.88 [1.940]	19.81 [1.780]
TIN	9	39.62 [1.560]	35.76 [1.408]	31.70 [1.248]
TIN	12	51.51 [2.028]	47.65 [1.876]	43.59 [1.716]
TIN	15	63.40 [2.496]	59.54 [2.344]	55.47 [2.184]
TIN	24	99.06 [3.900]	95.20 [3.748]	91.14 [3.588]

1	MATERIAL: CONNECTOR- NYLON UL94V-2 (RED); CONTACTS- 0.30 [0.12] THK COPPER ALLOY (BRIGHT TIN-LEAD 0.00203 [0.00080] MIN THK); (MATTE TIN 0.00203 [0.00080] MIN THK); CONTACTS ACCEPT #22 AWG SOLID, FUSED STRANDED OR STRANDED (7 STRANDS) WIRE WITH 2.41 [0.95] MAX INSULATION DIA. BOW, IN ANY DIRECTION, NOT TO EXCEED 0.15 [0.06] PER IN. HOUSING FEATURES: FEED-THRU. DIMENSIONS IN BRACKETS ARE IN INCHES.
2	CONTACTS ACCEPT #22 AWG SOLID, FUSED STRANDED OR STRANDED (7 STRANDS) WIRE WITH 2.41 [0.95] MAX INSULATION DIA. BOW, IN ANY DIRECTION, NOT TO EXCEED 0.15 [0.06] PER IN.
3	HOUSING FEATURES: FEED-THRU.
4	DIMENSIONS IN BRACKETS ARE IN INCHES.
5	OBsolete PARTS: OBSOLETE CIS STREAMLINING PER D.RENAUD/D.SINISI
6	OBsolete PARTS

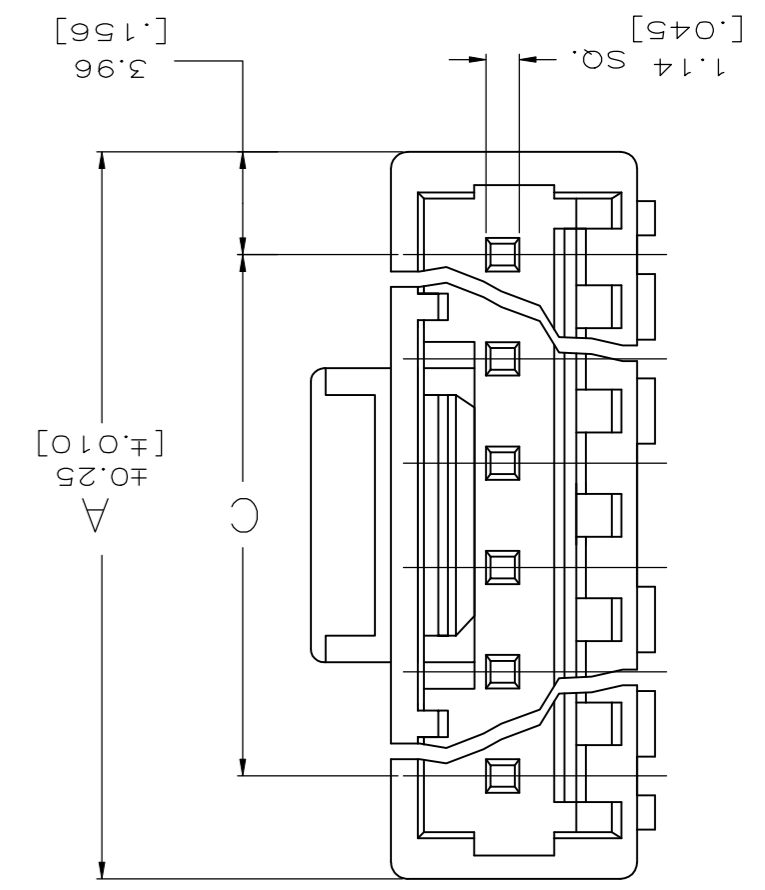
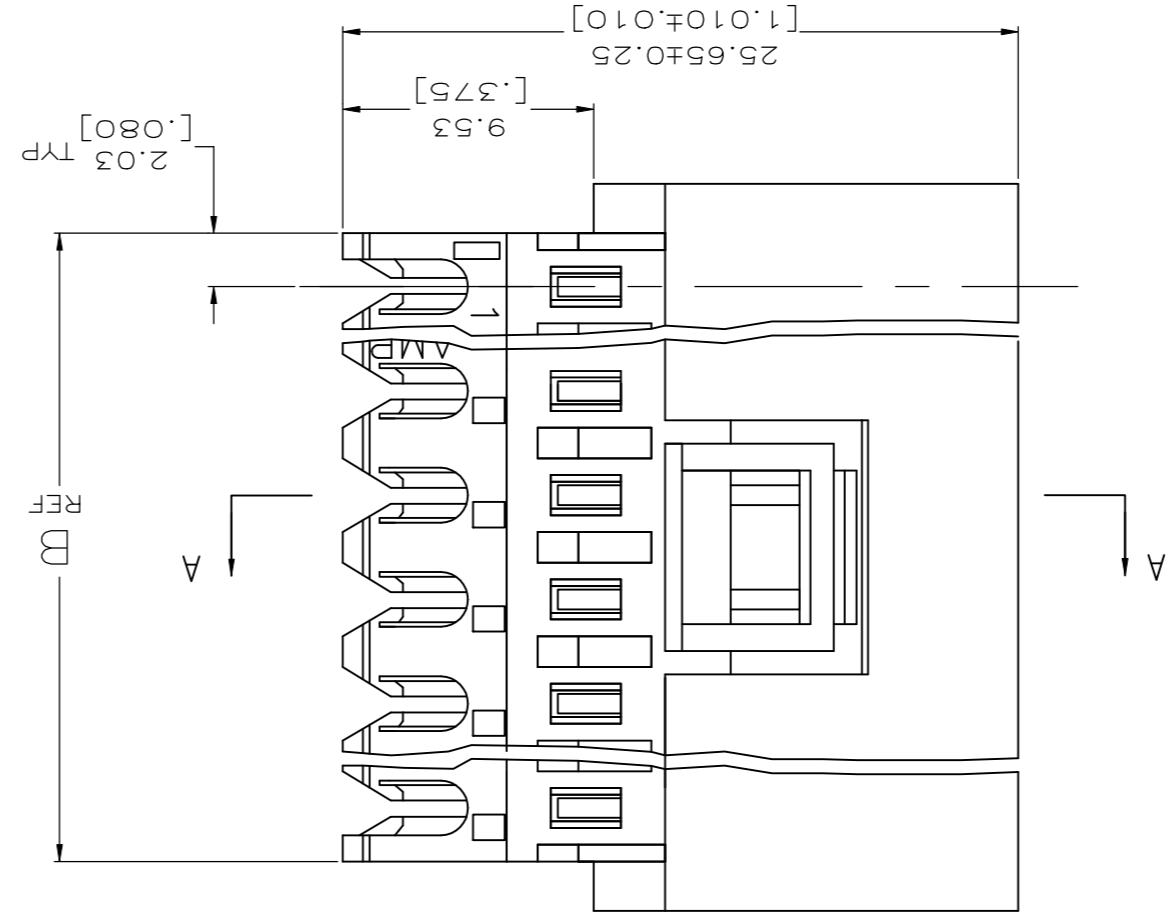
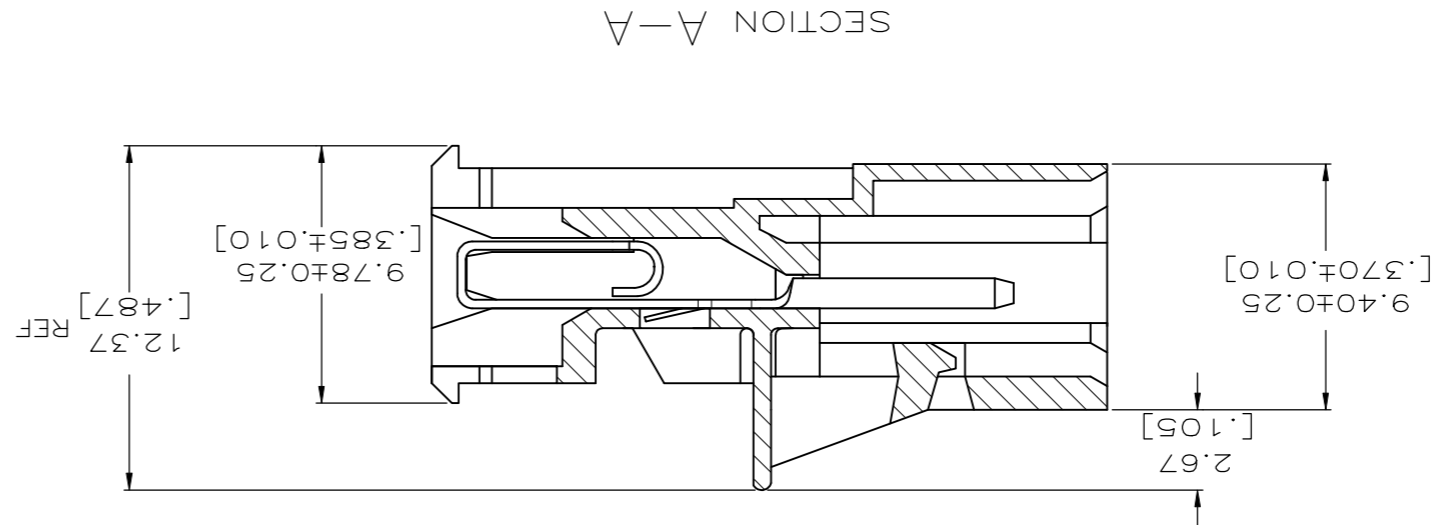
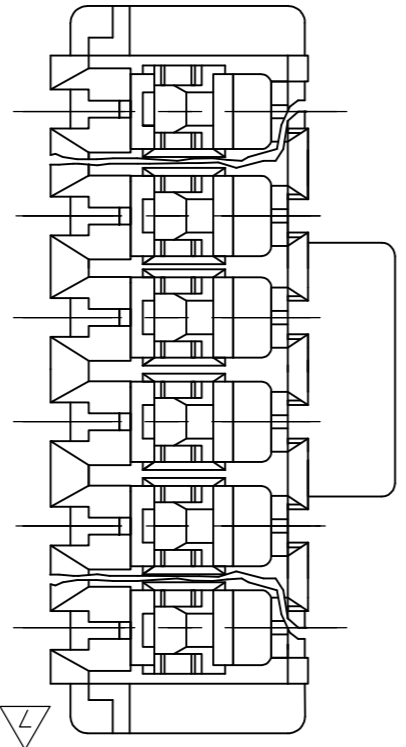

REV	DATE	DESCRIPTION	BY	CHK
0	10JAN2018	REVISED PER ECR-17-018200	BD	SG

X-ON Electronics

Largest Supplier of Electrical and Electronic Components

Click to view similar products for te connectivity manufacturer:

Other Similar products are found below :

[570416-000](#) [CLTEQ-M81CE-SSRELAY-4-20V](#) [4-1633138-8](#) [D38999/24FJ4AN](#) [4-1195131-0](#) [650069-000](#) [SMD100-2](#) [2EDL4CM](#)
[DTS20W19-11PD-3028](#) [DTS20W19-11PD-3028-LC](#) [DTS20W19-32SD-3028-LC](#) [DTS20W19-32SD-3028](#) [NC6-P104-06](#) [TXR64AB90-](#)
[3616AI](#) [DTS26F21-41HE](#) [DTS26F21-41AE](#) [DTS26F21-41PE-LC](#) [DTS26F21-11SE-3028-LC](#) [D38999/24WF32JE](#) [D38999/24WF32SE-LC](#)
[DTS24W19-32HE](#) [D38999/20JB35HA](#) [D38999/24WJ20PA](#) [164-8033-08](#) [D38999/24FF32JE](#) [D38999/24FF32SE-LC](#) [D38999/24WF32JB](#)
[D38999/24WG11HA](#) [D38999/24WG11HN](#) [MS27467T21F11H](#) [DJT16E21-11HA](#) [DTS24F19-32HE](#) [1-532955-3](#) [DTS20W19-32SA-3028-LC](#)
[DTS24F19-11SC-3028-LC](#) [DTS24F19-11SC-3028](#) [DJT14E13-98HB](#) [D38999/20WC8BB](#) [1-330599-5](#) [DTS24F21-41HN-LC](#) [DTS24F21-](#)
[41HN](#) [DTS24F21-41AN](#) [DTS24F21-39HN](#) [DTS24F21-41PN-LC](#) [AFD50-10-6SN-1A-LC](#) [DJT10F17-26HC](#) [DTS24W19-32HB](#)
[ACT20JE99HA](#) [DJT10E17-26HC](#) [DJT10E17-26HN](#)