

THIS DRAWING IS UNPUBLISHED. RELEASED FOR PUBLICATION  
 © COPYRIGHT - By - TE CONNECTIVITY ALL RIGHTS RESERVED.

LOC	DIST	REVISIONS			
P	LTR	DESCRIPTION	DATE	DWN	APVD
CM	00	N1	ECO-14-010907	10SEP2014	KR OC

- 1 MATERIAL: CONNECTOR-NYLON UL94V-2 (RED).  
CONTACTS-0.30 [.012] THICK COPPER ALLOY 0.00038 [.000015] GOLD OR 0.00038 [.000015] TOTAL GOLD FLASH OVER PALLADIUM NICKEL, PER TE CONNECTIVITY'S DISCRETION, IN CONTACT AREA WITH MATTE TIN FOR 641190-2 THRU 2-641190-8, MATTE WHISKER MITIGATED TIN FOR 3-641190-2 THRU 5-641190-8 OVER NICKEL UNDERPLATE.
- 2 CONTACTS ACCEPT 22 AWG WIRE WITH 1.52[.060] MAX INSULATION DIAMETER.
- 3 CONTACTS MUST ACCEPT 0.64#0.03[.025] POST AND REMAIN LOCKED IN POSITION.
- 4 IDENTIFICATION NUMBER FOR LAST CIRCUIT MAY NOT APPEAR ON ALL ASSEMBLIES.
- 5 DIMENSIONS IN BRACKETS ARE IN INCHES.
- 6 HOUSING FEATURES ARE: CLOSED END WITH LOCKING RAMP AND WITH POLARIZING TAB.
- 7 OBSOLETE PARTS: OBSOLETE CIS STREAMLINING PER D.RENAUD/D.SINISI

NO	60.96[2.400]	24	5-644038-4
NO	58.42[2.300]	23	5-644038-3
NO	55.88[2.200]	22	5-644038-2
NO	53.34[2.100]	21	5-644038-1
NO	50.80[2.000]	20	5-644038-0
NO	48.26[1.900]	19	4-644038-9
NO	45.72[1.800]	18	4-644038-8
NO	43.18[1.700]	17	4-644038-7
NO	40.64[1.600]	16	4-644038-6
NO	38.10[1.500]	15	4-644038-5
NO	35.56[1.400]	14	4-644038-4
NO	33.02[1.300]	13	4-644038-3
NO	30.48[1.200]	12	4-644038-2
NO	27.94[1.100]	11	4-644038-1
NO	25.40[1.000]	10	4-644038-0
NO	22.86[.900]	9	3-644038-9
NO	20.32[.800]	8	3-644038-8
NO	17.78[.700]	7	3-644038-7
NO	15.24[.600]	6	3-644038-6
NO	12.70[.500]	5	3-644038-5
NO	10.16[.400]	4	3-644038-4
NO	7.62[.300]	3	3-644038-3
NO	5.08[.200]	2	3-644038-2

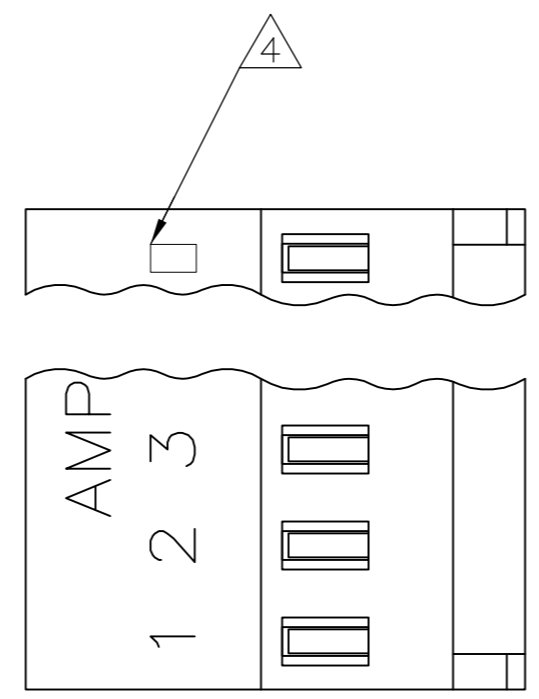

NO	60.96[2.400]	24	2-644038-4	SUPERSEDED 7
NO	50.80[2.000]	20	2-644038-0	SUPERSEDED 7
NO	40.64[1.600]	16	1-644038-6	
NO	38.10[1.500]	15	1-644038-5	
NO	35.56[1.400]	14	1-644038-4	
NO	33.02[1.300]	13	1-644038-3	
NO	30.48[1.200]	12	1-644038-2	
NO	27.94[1.100]	11	1-644038-1	
NO	25.40[1.000]	10	1-644038-0	
NO	22.86[.900]	9	644038-9	
NO	20.32[.800]	8	644038-8	
NO	17.78[.700]	7	644038-7	
NO	15.24[.600]	6	644038-6	
NO	12.70[.500]	5	644038-5	
NO	10.16[.400]	4	644038-4	
NO	7.62[.300]	3	644038-3	
NO	5.08[.200]	2	644038-2	
LEADFREE	DIM A	NO. OF CIRCUITS	PART NO.	

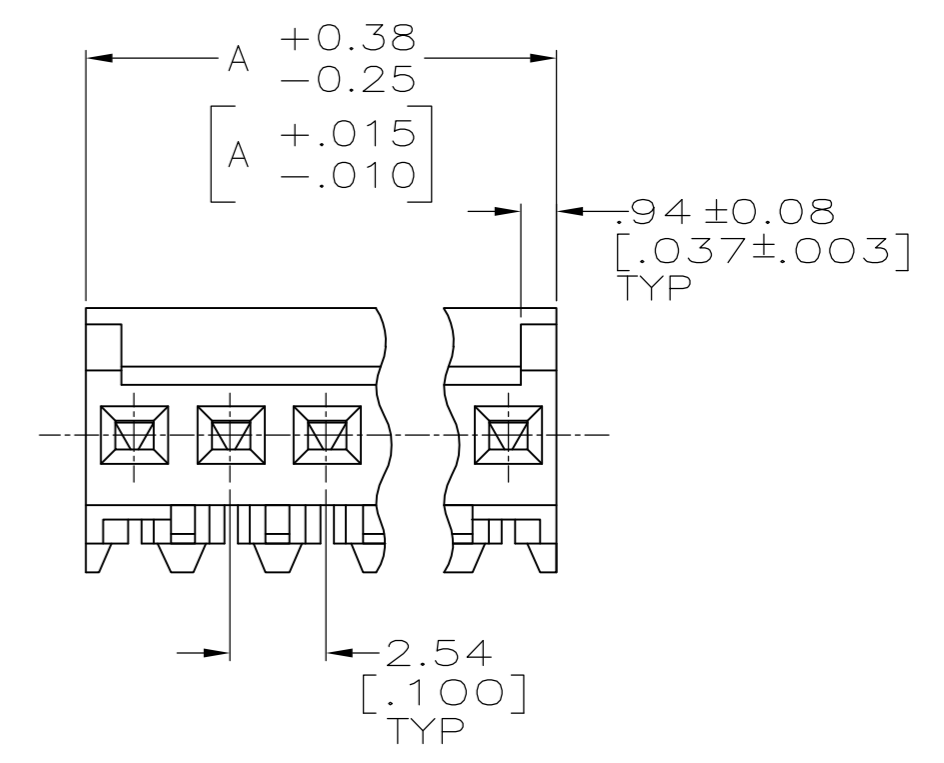
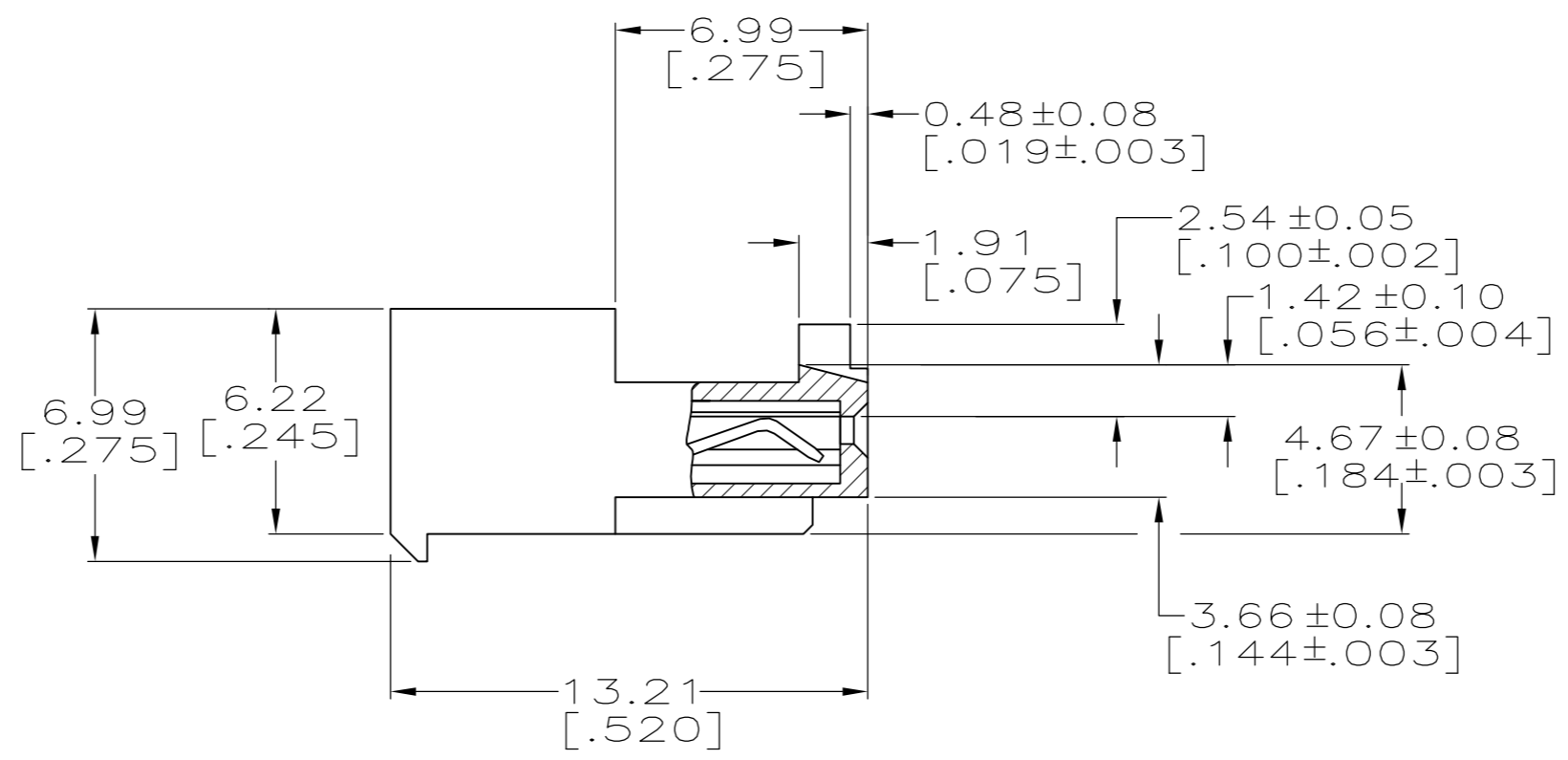

**METRIC**

THIS DRAWING IS A CONTROLLED DOCUMENT.		DWN S. CARPENTER 12JUN2003		
DIMENSIONS: mm [INCHES]		CHK D. BOSSI 12JUN2003		
TOLERANCES UNLESS OTHERWISE SPECIFIED:		APVD D. BOSSI 12JUN2003	NAME	
0 PLC ±	1 PLC ±	PRODUCT SPEC	MTA-100 CONNECTOR ASSEMBLY, 22 AWG, STANDARD	
2 PLC ±	3 PLC ± 0.13 [.005]	APPLICATION SPEC	SIZE	CAGE CODE
4 PLC ±	ANGLES ±	FINISH	A2	00779
MATERIAL		WEIGHT	DRAWING NO	RESTRICTED TO
1		1	114-1019	-
		CUSTOMER DRAWING	SCALE	SHEET
			5:1	1 of 1
			REV	N1

## X-ON Electronics

Largest Supplier of Electrical and Electronic Components

*Click to view similar products for te connectivity manufacturer:*

Other Similar products are found below :

[570416-000](#) [CLTEQ-M81CE-SSRELAY-4-20V](#) [D38999/24FJ4AN](#) [358838-000](#) [4-1195131-0](#) [650069-000](#) [SMD100-2](#) [CB-1022B-78](#)  
[RM707012](#) [RP410012](#) [MMS42](#) [1-640426-8](#) [2EDL4CM](#) [DTS20W19-11PD-3028-LC](#) [RM202615](#) [NC6-P104-06](#) [MSPS103B](#) [DTS26F21-41AE](#) [DTS26F21-41PE-LC](#) [DTS26F21-11SE-3028-LC](#) [1932144-1](#) [293545-4](#) [LVR125S](#) [MS27466T25F4PB](#) [CKB-38-78010](#)  
[1206SFF150F/63-2](#) [D38999/20JB35HA](#) [D38999/24WJ20PA](#) [1754138-1](#) [TE1500A2R2J](#) [DTS24F25-29PC-3028-LC](#) [D38999/24WG11HA](#)  
[D38999/24WG11HN](#) [MS27467T21F11H](#) [DJT16E21-11HA](#) [1206SFH150F/24-2](#) [DTS24F19-11SC-3028-LC](#) [DTS24F21-41HN-LC](#)  
[DTS24F21-41AN](#) [DTS24F21-41PN-LC](#) [MS27467T21F35J](#) [MS27467T21F11J](#) [MS27467T21F16H-LC](#) [MS27467T21F35H](#)  
[MS27467T21F41H-LC](#) [DJT16E21-11PA-LC](#) [DJT16E21-11HA-LC](#) [DJT16E21-11AA](#) [MS27467T21B11JA](#) [DJT16E21-11JA](#)