

THIS DRAWING IS UNPUBLISHED. RELEASED FOR PUBLICATION. ALL RIGHTS RESERVED.

| REVISIONS | | | | |
|-----------|-----|---------------------------|-----------|--------|
| # | LTR | DESCRIPTION | DATE | BY |
| P2 | | REVISED PER ECO-11-004587 | 11MAR11 | RK HMR |
| R | | REVISED PER ECO-18-000976 | 13APR2018 | RS JO |

- 1 OBSOLETE PART NO.
- 2 'AMP', PART NUMBER AND DATE CODE MARKED WHEN HOUSING SIZE PERMITS.
- 3 .046±.015 CHARS. MARKED FIRST AND EVERY 5TH CAVITY, ONE SIDE.
- 5 SUPERSEDED BY 3-87456-3.
- 6 SUPERSEDED BY 4-87456-5.
- 7 OBSOLETE PARTS: OBSOLETE CIS STREAMLINING PER D.RENAUD/D.SINISI

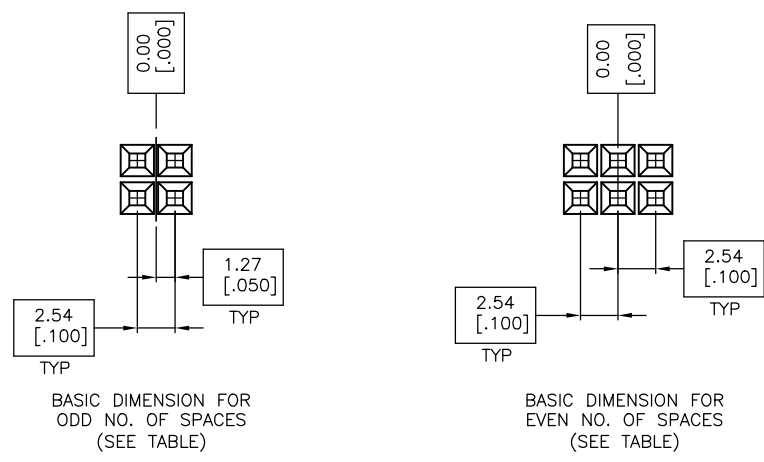
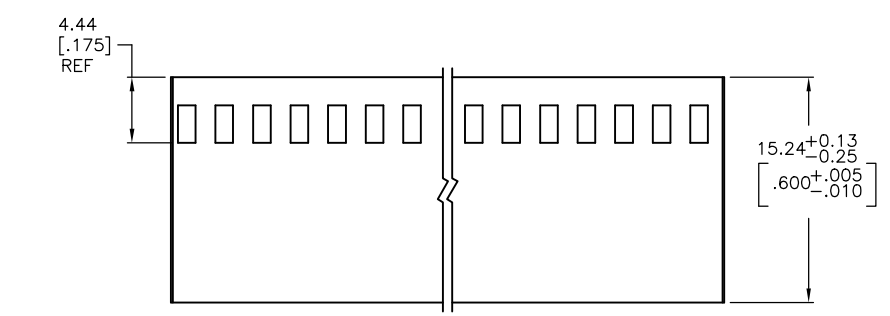
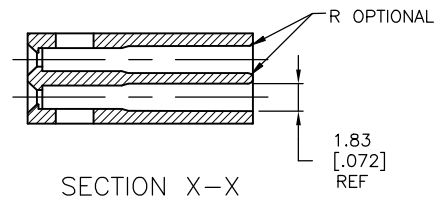
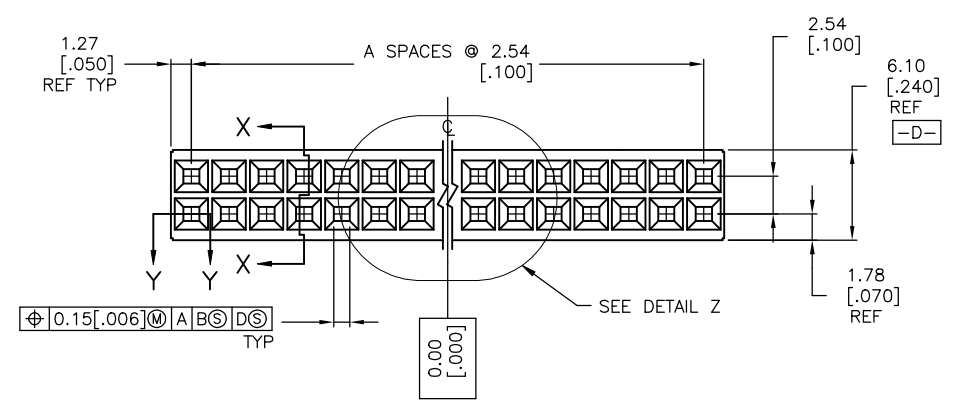
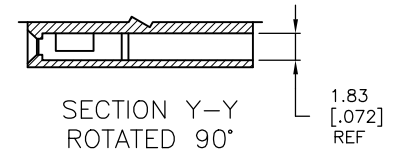
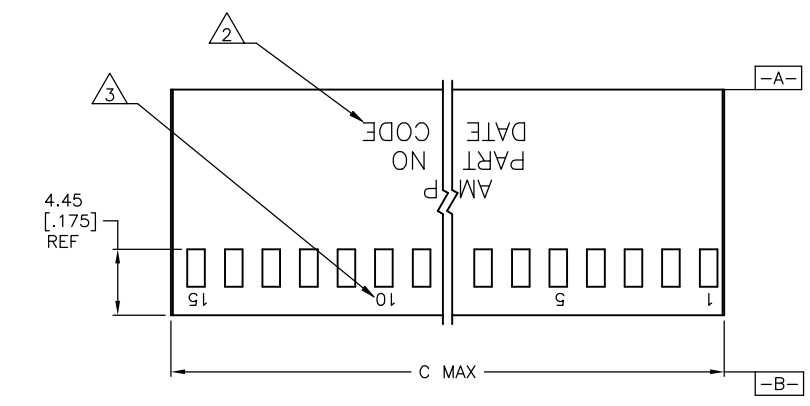

| | | | | |
|--------------------------|---------------|----|------------------|-----------------|
| 6-87456-5 | 81.28 [3.200] | 31 | 64 | 6-87456-6 |
| 6-87456-3 | 73.66 [2.900] | 28 | 58 | 6-87456-4 |
| 6-87456-1 | 71.12 [2.800] | 27 | 56 | 6-87456-2 |
| 5-87456-9 | 60.96 [2.400] | 23 | 48 | 6-87456-0 |
| 5-87456-7 | 83.82 [3.300] | 32 | 66 | 5-87456-4 |
| 5-87456-5 | 88.90 [3.505] | 34 | 70 | 5-87456-6 |
| 5-87456-3 | 2.67 [.105] | - | 2 | - |
| 5-87456-1 | 76.33 [3.005] | 29 | 60 | 5-87456-2 |
| 4-87456-9 | 5.21 [.205] | 1 | 4 | 5-87456-0 |
| 4-87456-7 | 91.57 [3.605] | 35 | 72 | 4-87456-8 |
| 4-87456-5 | 68.71 [2.705] | 26 | 54 | 4-87456-6 |
| 4-87456-3 | 53.47 [2.105] | 20 | 42 | 4-87456-4 |
| 4-87456-1 | 66.17 [2.605] | 25 | 52 | 4-87456-2 |
| 3-87456-9 | 63.63 [2.505] | 24 | 50 | 4-87456-0 |
| 3-87456-7 | 56.01 [2.205] | 21 | 44 | 3-87456-8 |
| 3-87456-5 | 50.93 [2.005] | 19 | 40 | 3-87456-6 |
| 3-87456-3 | 48.39 [1.905] | 18 | 38 | 3-87456-4 |
| 3-87456-1 | 45.85 [1.805] | 17 | 36 | 3-87456-2 |
| 2-87456-9 | 43.31 [1.705] | 16 | 34 | 3-87456-0 |
| 2-87456-7 | 40.77 [1.605] | 15 | 32 | 2-87456-8 |
| 2-87456-5 | 38.23 [1.505] | 14 | 30 | 2-87456-6 |
| 2-87456-3 | 35.69 [1.405] | 13 | 28 | 2-87456-4 |
| 2-87456-1 | 33.15 [1.305] | 12 | 26 | 2-87456-2 |
| 1-87456-9 | 30.61 [1.205] | 11 | 24 | 2-87456-0 |
| 1-87456-7 | 28.07 [1.105] | 10 | 22 | 1-87456-8 |
| 1-87456-5 | 25.53 [1.005] | 9 | 20 | 1-87456-6 |
| 1-87456-3 | 22.99 [.905] | 8 | 18 | 1-87456-4 |
| 1-87456-1 | 20.45 [.805] | 7 | 16 | 1-87456-2 |
| 87456-9 | 17.91 [.705] | 6 | 14 | 1-87456-0 |
| 87456-7 | 15.37 [.605] | 5 | 12 | 87456-8 |
| 87456-5 | 12.83 [.505] | 4 | 10 | 87456-6 |
| 87456-3 | 10.29 [.405] | 3 | 8 | 87456-4 |
| 87456-1 | 7.75 [.305] | 2 | 6 | 87456-2 |
| PART NO. WITHOUT MARKING | C | A | NO. OF POSITIONS | PART NO. MARKED |

THIS DRAWING IS A CONTROLLED DOCUMENT. E. BRANDBERG 11-06-92, J. GESFORD 11-30-92, J. GESFORD 11-30-92

TE Connectivity Ltd.

HOUSING, MOD IV DOUBLE ROW, .100X.100 C/L CRIMP SNAP-IN, SHORT ENTRY

SIZE: A1 00779 C-87456

SCALE: 4:1 SHEET 1 OF 1 REV R

X-ON Electronics

Largest Supplier of Electrical and Electronic Components

Click to view similar products for [Headers & Wire Housings](#) category:

Click to view products by [TE Connectivity](#) manufacturer:

Other Similar products are found below :

[892-18-020-10-001101](#) [58102-G61-06LF](#) [582553-1](#) [0009485154](#) [009176003701906](#) [0050291907](#) [LY20-4P-DT1-P1E-BR](#) [02.125.8002.8](#)
[609-3404](#) [61062-3](#) [61082-181009](#) [622-3653LF](#) [63453-116](#) [636-1030](#) [636-1427](#) [636-3427](#) [636-4007](#) [641938-9](#) [641991-4](#) [644827-2](#) [65817-](#)
[010LF](#) [65817-015LF](#) [65863-015LF](#) [66207-023LF](#) [67095-007LF](#) [67601157](#) [68645-018](#) [68648-049](#) [70.362.1628.0](#) [70-4210](#) [70-4226B](#) [70-](#)
[4853B](#) [707-5020](#) [707-5028](#) [71.350.2428.0](#) [71918-208LF](#) [71961-016LF](#) [733-134](#) [733-162](#) [754199-000](#) [760-3052](#) [787-8014-00](#) [79531-3000](#)
[FCN-360C032-B](#) [FCN-367T-T012/H](#) [FCN-723D010/2](#) [80.063.4001.1](#) [800-90-001-10-001000](#) [800-90-010-10-002000](#) [801-43-002-10-013000](#)