

THIS DRAWING IS UNPUBLISHED. RELEASED FOR PUBLICATION  
 © COPYRIGHT - By - ALL RIGHTS RESERVED.

|     |      |           |     |                      |           |     |      |
|-----|------|-----------|-----|----------------------|-----------|-----|------|
| LOC | DIST | REVISIONS |     |                      |           |     |      |
| FT  | 0    | P         | LTR | DESCRIPTION          | DATE      | DWN | APVD |
|     |      |           | F1  | WIRE SIZE CORRECTION | 05MAR2015 | CR  | PS   |

**MATERIAL:**  
 HOUSING: THERMOPLASTIC, UL94V-0, BLACK.  
 TERMINAL: M3 THREAD, BRIGHT TIN PLATED, COPPER ALLOY.  
 SCREWS: M3 THREAD ZINC PLATED STEEL, EXCEPT WHERE OTHERWISE NOTED.

**ELECTRICAL:**  
 RATED CURRENT: 10A.  
 OPERATING VOLTAGE: 300V.  
 WIRE RANGE: 18-22 AWG.

**MECHANICAL:**  
 PITCH (TERMINAL SPACING): .250"  
 OPERATING TEMP.: 120°C MAX.

- ① SEE FIGURE.
- ② M3 SCREWS, ZINC PLATED STEEL AND M3 THREADED TERMINAL.
- 3 RUNNING TORQUE: 4 IN-LB MAX.
- ④ OBSOLETE PARTS: OBSOLETE CIS STREAMLINING PER D.RENAUD/D.SINISI
- ⑤ PRELIMINARY PART NUMBER

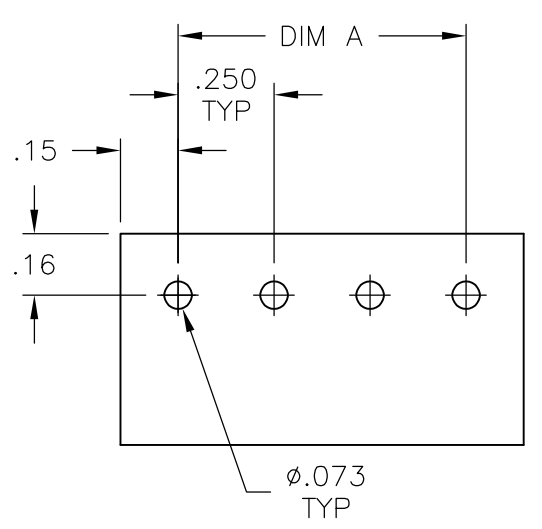
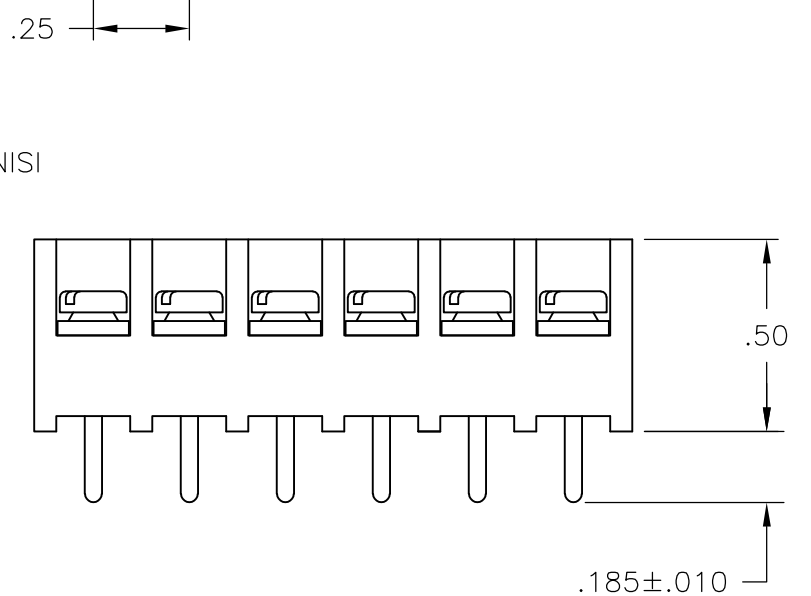
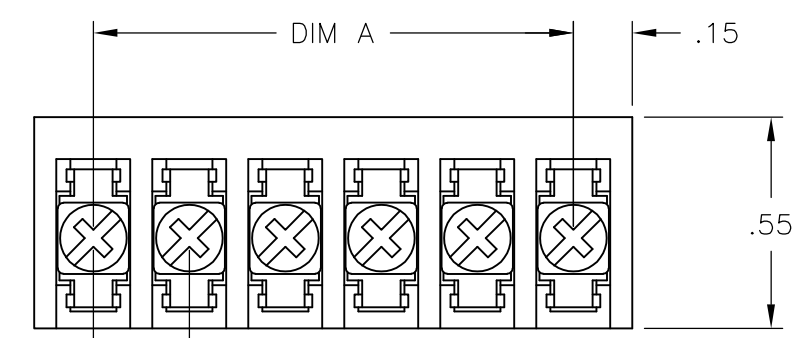

RECOMMENDED PCB LAYOUT

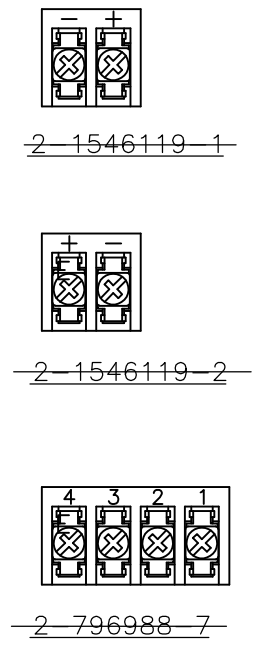

| DIM. "A" | NO. OF POS. | CATALOG NUMBER  | PART NO.               |
|----------|-------------|-----------------|------------------------|
| ⑤ .25    | 2           | 3PCV-02-006-SPL | 796597-3               |
| 7.25     | 30          | 3PCV-30-006     | 4-1546119-3            |
| 7.00     | 29          | 3PCV-29-006     | 2-1546533-9            |
| 6.75     | 28          | 3PCV-28-006     | 2-1546533-8            |
| 6.50     | 27          | 3PCV-27-006     | 2-1546533-7            |
| 6.25     | 26          | 3PCV-26-006     | 4-1546119-2            |
| 6.00     | 25          | 3PCV-25-006     | 2-1546533-5            |
| 5.75     | 24          | 3PCV-24-006     | 4-1546119-1            |
| 5.50     | 23          | 3PCV-23-006     | 2-1546533-3            |
| 5.25     | 22          | 3PCV-22-006     | 3-1546119-9            |
| 5.00     | 21          | 3PCV-21-006     | 2-1546533-1            |
| ④ 4.75   | 20          | 3PCV-20-308     | 796597-2               |
| 4.75     | 20          | 3PCV-20-006     | 796597-1               |
| 4.50     | 19          | 3PCV-19-006     | 1-1546533-9            |
| 4.25     | 18          | 3PCV-18-006     | 3-1546119-7            |
| 4.00     | 17          | 3PCV-17-006     | 3-1546119-6            |
| 3.75     | 16          | 3PCV-16-006     | 7-1437646-8            |
| 3.50     | 15          | 3PCV-15-006     | 7-1437646-5            |
| 3.25     | 14          | 3PCV-14-006     | 7-1437646-3            |
| 3.00     | 13          | 3PCV-13-006     | 3-1546119-2            |
| 2.75     | 12          | 3PCV-12-006     | 6-1437646-7            |
| 2.50     | 11          | 3PCV-11-006     | 2-1546119-9            |
| 2.25     | 10          | 3PCV-10-006     | 6-1437646-2            |
| 2.00     | 9           | 3PCV-09-006     | 5-1437646-9            |
| 1.75     | 8           | 3PCV-08-006     | 5-1437646-7            |
| 1.50     | 7           | 3PCV-07-006     | 5-1437646-4            |
| 1.25     | 6           | 3PCV-06-006     | 5-1437646-0            |
| 1.00     | 5           | 3PCV-05-006     | 4-1437646-5            |
| ④ ① .75  | 4           | 3PCV-04-006-SPL | <del>2-796988-7</del>  |
| .75      | 4           | 3PCV-04-006     | 4-1437646-2            |
| .50      | 3           | 3PCV-03-006     | 3-1437646-9            |
| ④ ① .25  | 2           | 3PCV-02-297     | <del>2-1546119-2</del> |
| ④ ① .25  | 2           | 3PCV-02-296     | <del>2-1546119-1</del> |
| .25      | 2           | 3PCV-02-006     | 3-1437646-3            |

- ④ ① OBSOLETE
- ④ ① OBSOLETE
- ④ ① OBSOLETE

|  |  |                  |            |                      |                            |               |               |
|--|--|------------------|------------|----------------------|----------------------------|---------------|---------------|
| THIS DRAWING IS A CONTROLLED DOCUMENT. |  | DWN              | S SCHLEGEL | 24MAR03              | <b>STE</b> TE Connectivity |               |               |
| DIMENSIONS: INCHES                     |  | CHK              | S YODER    | 3/24/03              |                            |               |               |
| TOLERANCES UNLESS OTHERWISE SPECIFIED: |  | APVD             | S YODER    | 3/24/03              | NAME                       |               |               |
| 0 PLC ± -                              |  | PRODUCT SPEC     |            | 3PCV-XX-006 ASSEMBLY |                            |               |               |
| 1 PLC ± -                              |  | APPLICATION SPEC |            | SIZE                 | CAGE CODE                  | DRAWING NO    | RESTRICTED TO |
| 2 PLC ± .02                            |  | MATERIAL         |            | A300779              |                            | C-4-1437646-2 |               |
| 3 PLC ± .010                           |  | FINISH           |            | CUSTOMER DRAWING     |                            | SCALE         | SHEET         |
| 4 PLC ± -                              |  | MATERIAL         |            | -                    |                            | NTS           | 1 OF 1        |
| ANGLES ± -                             |  | MATERIAL         |            | -                    |                            | REV           | F1            |

## X-ON Electronics

Largest Supplier of Electrical and Electronic Components

*Click to view similar products for [Barrier Terminal Blocks](#) category:*

*Click to view products by [TE Connectivity](#) manufacturer:*

Other Similar products are found below :

[CR151D20104](#) [670A-RZ-15-KT20](#) [6C1N03](#) [6PCR-02](#) [6PCR-02-008](#) [6PCR-05-008](#) [6PCR-08-008](#) [6PCR-09-008](#) [6PCR-13-006](#) [6PCR-15-006](#) [6PCR-21-006](#) [6PCV-06-008](#) [6PCV-06-716](#) [6PCV-09-001](#) [6PCV-10-009](#) [6PCV-15-008](#) [6PCV-17-1206](#) [6PCV-20-323](#) [6PCV-20-720](#) [6PCV-30-006](#) [6STR-06-006](#) [6STR-08-006](#) [6STR-12-008](#) [6STR-13-006](#) [6STR-14-008](#) [6STR-16-008](#) [6STR-17-008](#) [6STR-21-008](#) [6STR-25-008](#) [6STR-27-008](#) [6STV-03-006](#) [6STV-03-008](#) [6STV-04-006](#) [6STV-09-006](#) [6STV-10-006](#) [6WWR-03-693](#) [6WWV-12-008](#) [72212603](#) [72504-C-50](#) [72506-C](#) [72507-C-50](#) [73203](#) [75505-C](#) [75505-C-50](#) [75510-C](#) [77010-50](#) [7C1N08](#) [812-GP-3/4ST-09](#) [8-1437402-5](#) [8PCR-06-006](#)