

THIS DRAWING IS UNPUBLISHED. RELEASED FOR PUBLICATION , 19

© COPYRIGHT 19 BY AMP INCORPORATED. ALL INTERNATIONAL RIGHTS RESERVED.

PROJ LGC DIST  
5049 DF A0

		REVISIONS			
ZONE	LTR	DESCRIPTION	DATE	APPD	
	0	RLSE/NPR 89-015 CCT	2-89	EH	
	A	REV PER ECN DF-1837 TW	5-89	EH	
✓	B	REV PER DF-3934 CT	6-89	12-70	

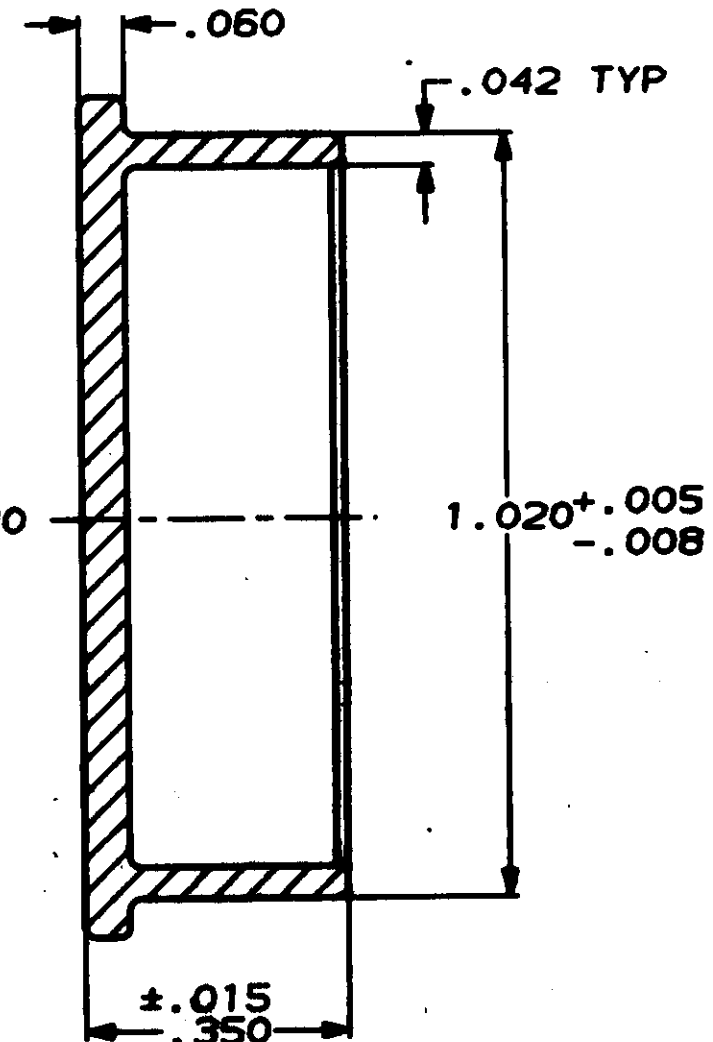
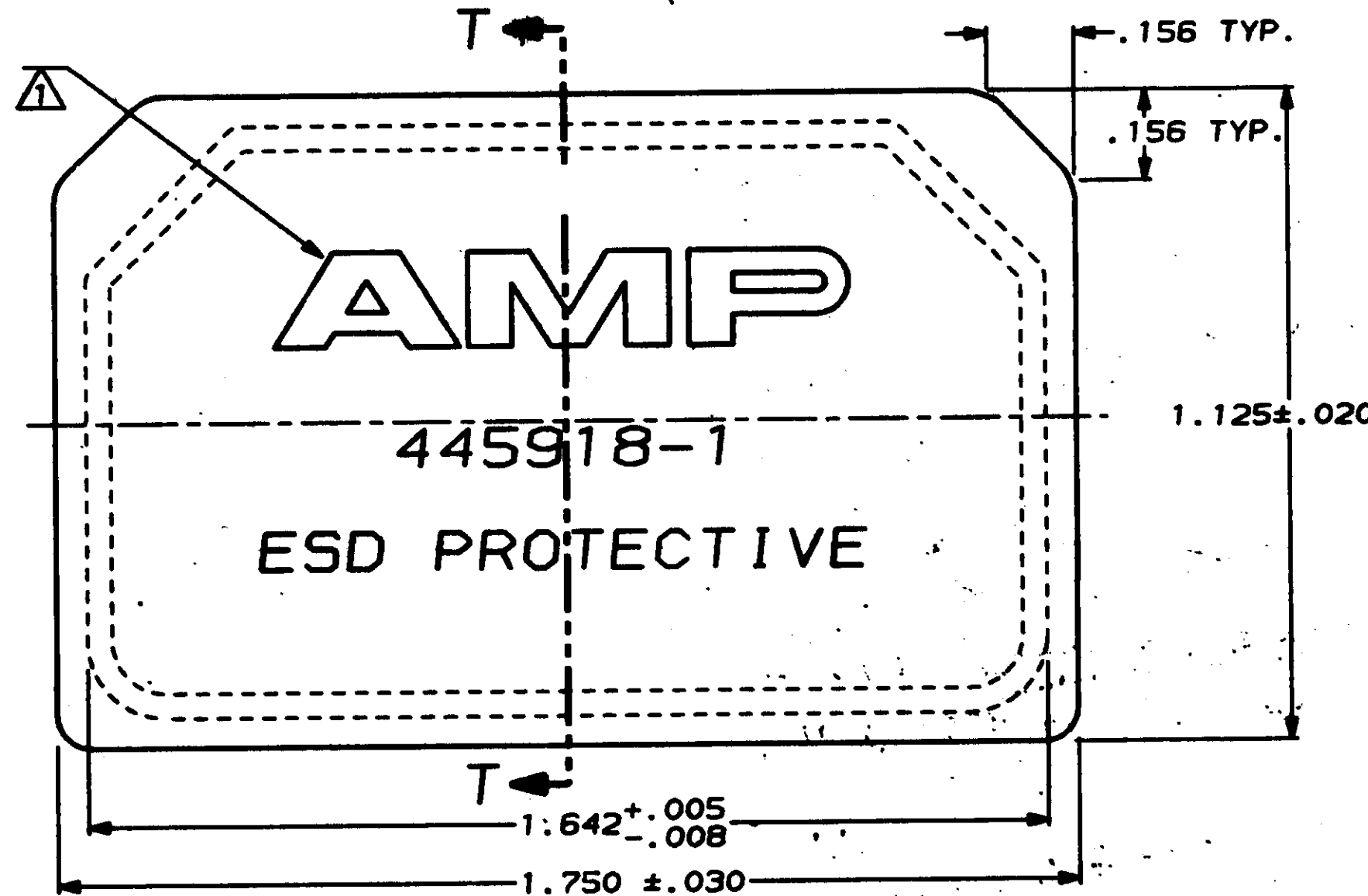

SECTION T-T

⚠ MARKING IS MOLDED IN AND RAISED .005-.012 ABOVE SURFACE APPROX: AS SHOWN.

DO NOT SCALE PRINT. UNLESS SPECIFIED DIMENSIONS IN INCHES TOLERANCES ON: Ø PLC DEC ± .005 Ø PLC DEC ± .008 ANGLES ± .5		ON 2-15-89 C.E. THOMPSON CHK 3-1-89 E. HENNING APPD 3-1-89 E. HENNING APPD 3-1-89 E. HENNING	445918-1 PART NO	
MATERIAL CONDUCTIVE THERMOPLASTIC	FINISH BLACK	PRODUCT SPEC -	AMP INCORPORATED Harrisburg, Pa. 17106	
		APPLICATION SPEC -	DUST COVER, ARINC 404 DUAL RECEPTACLE	
		SCALE 4:1	SIZE B	FIG. NO. 00779
			DRAWING NO. 445918	
			SHEET 1 OF 1	

CUSTOMER DRAWING

## X-ON Electronics

Largest Supplier of Electrical and Electronic Components

*Click to view similar products for [TE Connectivity](#) manufacturer:*

Other Similar products are found below :

[D38999/24FJ4AN](#) [570416-000](#) [CLTEQ-M81CE-SSRELAY-4-20V](#) [4-1195131-0](#) [650069-000](#) [SMD100-2](#) [358838-000](#) [CB-1022B-78](#)  
[RM707012](#) [RP410012](#) [MMS42](#) [1-640426-8](#) [2EDL4CM](#) [DTS20W19-11PD-3028-LC](#) [RM202615](#) [NC6-P104-06](#) [MSPS103B](#) [DTS26F21-](#)  
[41HE-LC](#) [DTS26F21-41AE](#) [DTS26F21-41PE-LC](#) [DTS26F21-11SE-3028-LC](#) [30DCB6](#) [1932144-1](#) [293545-4](#) [LVR125S](#) [MS27466T25F4PB](#)  
[CKB-38-78010](#) [TR04AI-TINELLOCKRING](#) [1206SFF150F/63-2](#) [D38999/20JB35HA](#) [TE1500A2R2J](#) [D38999/20WC8BB](#) [DTS24F19-11SC-](#)  
[3028-LC](#) [D38999/24WG11HA](#) [D38999/24WG11HN](#) [MS27467T21F11H](#) [DJT16E21-11HA](#) [MS27467T21F35J](#) [MS27467T21F11J](#)  
[MS27467T21F16H-LC](#) [MS27467T21F35H](#) [MS27467T21F41H-LC](#) [1206SFH150F/24-2](#) [RP330024](#) [DJT16E21-11PA-LC](#) [DJT16E21-11HA-](#)  
[LC](#) [DJT16E21-11AA](#) [MS27467T21B11JA](#) [DJT16E21-11JA](#) [MS27467T21B11JA-LC](#)