

- 1 MATERIAL: CONNECTOR-NYLON UL94V-2 (GREEN).
CONTACTS-0.30 [.012] THICK COPPER ALLOY
0.00076 [.000030] GOLD OR 0.00076 [.000030]
TOTAL GOLD FLASH OVER PALLADIUM NICKEL,
PER TE CONNECTIVITY'S DISCRETION, IN
CONTACT AREA WITH BRIGHT TIN-LEAD
FOR 641240-2 THRU 2-641240-8, MATTE
WHISKER MITIGATED TIN FOR 3-641240-2
THRU 5-641240-8 OVER NICKEL UNDERPLATE.
- 2 CONTACTS ACCEPT 28 AWG WIRE WITH 1.52 [.060] MAX INSULATION DIAMETER.
- 3 CONTACTS MUST ACCEPT 0.64±0.03 [.025±.001] SQUARE POST AND REMAIN LOCKED IN POSITION.
- 4 IDENTIFICATION NUMBER FOR LAST CIRCUIT MAY NOT APPEAR ON ALL ASSEMBLIES.
- 5 DIMENSIONS IN BRACKETS ARE IN INCHES.
- 6 HOUSING FEATURES ARE: CLOSED END WITH LOCKING RAMP.
- 7 OBSOLETE PARTS: OBSOLETE CIS STREAMLINING PER D.RENAUD/D.SINISI

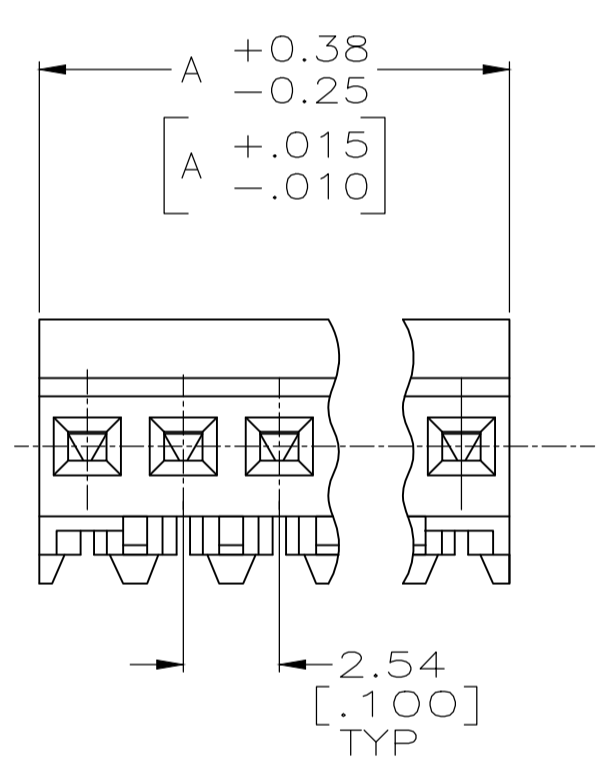
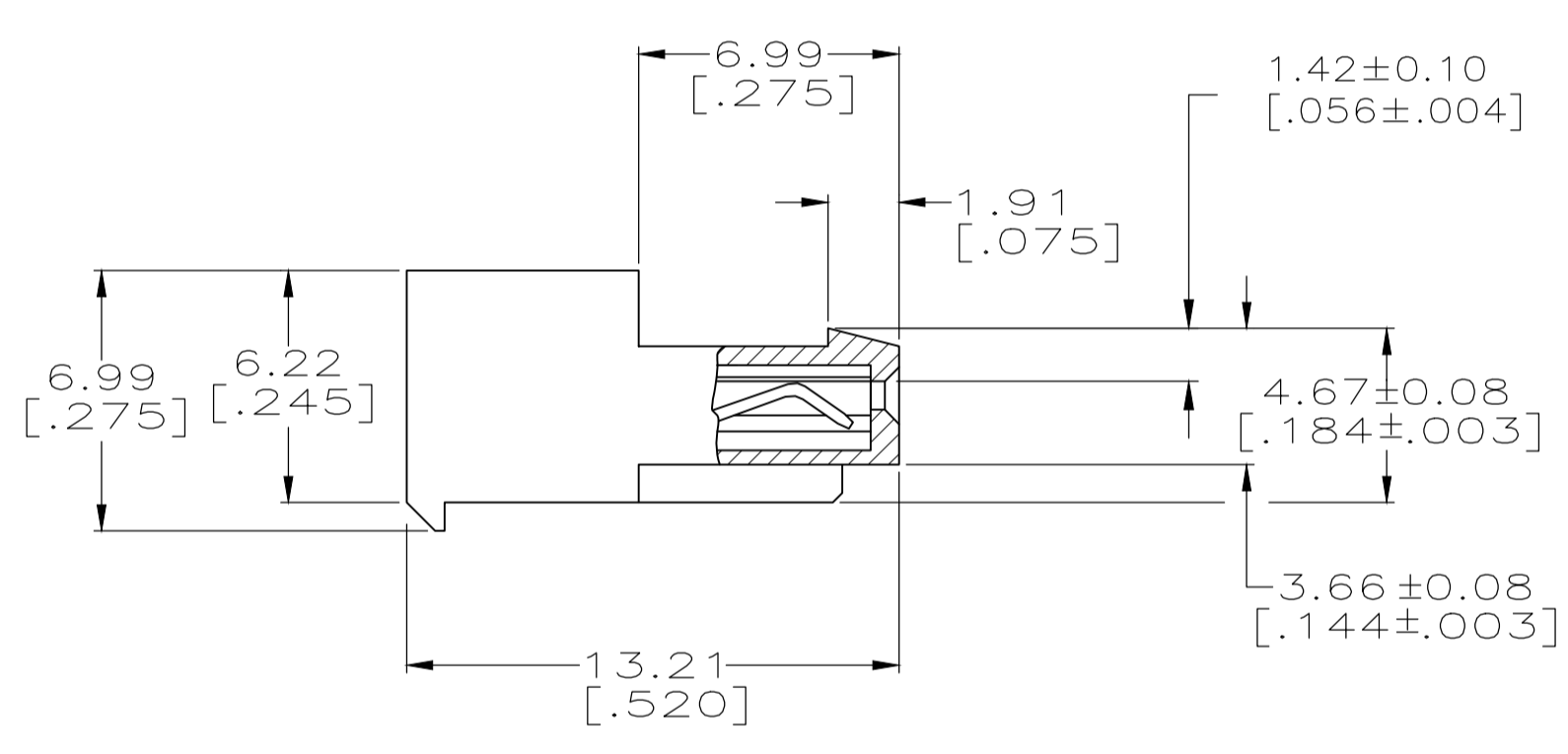
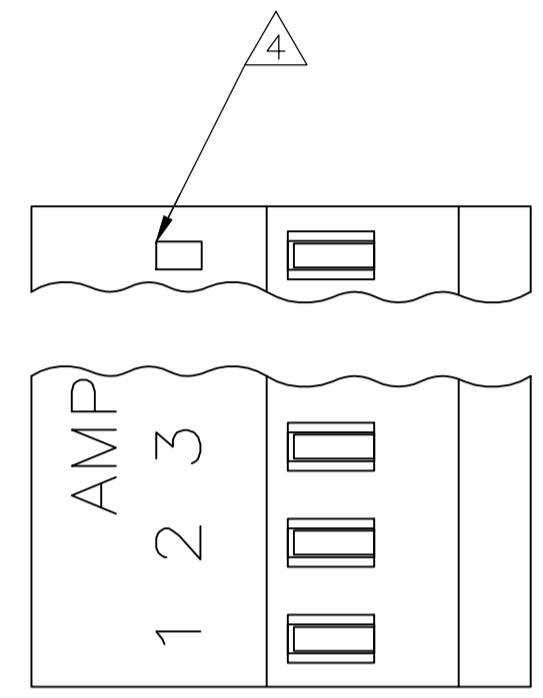

LEAD FREE	71.12 [.2800]	28	5-641240-8	CONTAINS LEAD	71.12 [.2800]	28	2-641240-8
	68.58 [.2700]	27	5-641240-7		68.58 [.2700]	27	2-641240-7
	66.04 [.2600]	26	5-641240-6		66.04 [.2600]	26	2-641240-6
	63.50 [.2500]	25	5-641240-5		63.50 [.2500]	25	2-641240-5
	60.96 [.2400]	24	5-641240-4		60.96 [.2400]	24	2-641240-4
	58.42 [.2300]	23	5-641240-3		58.42 [.2300]	23	2-641240-3
	55.88 [.2200]	22	5-641240-2		55.88 [.2200]	22	2-641240-2
	53.34 [.2100]	21	5-641240-1		53.34 [.2100]	21	2-641240-1
	50.80 [2.000]	20	5-641240-0		50.80 [2.000]	20	2-641240-0
	48.26 [1.900]	19	4-641240-9		48.26 [1.900]	19	1-641240-9
	45.72 [1.800]	18	4-641240-8		45.72 [1.800]	18	1-641240-8
	43.18 [1.700]	17	4-641240-7		43.18 [1.700]	17	1-641240-7
	40.64 [1.600]	16	4-641240-6		40.64 [1.600]	16	1-641240-6
	38.10 [1.500]	15	4-641240-5		38.10 [1.500]	15	1-641240-5
	35.56 [1.400]	14	4-641240-4		35.56 [1.400]	14	1-641240-4
	33.02 [1.300]	13	4-641240-3		33.02 [1.300]	13	1-641240-3
	30.48 [1.200]	12	4-641240-2		30.48 [1.200]	12	1-641240-2
	27.94 [1.100]	11	4-641240-1		27.94 [1.100]	11	1-641240-1
	25.40 [1.000]	10	4-641240-0		25.40 [1.000]	10	1-641240-0
	22.86 [.900]	9	3-641240-9		22.86 [.900]	9	641240-9
20.32 [.800]	8	3-641240-8	20.32 [.800]	8	641240-8		
17.78 [.700]	7	3-641240-7	17.78 [.700]	7	641240-7		
15.24 [.600]	6	3-641240-6	15.24 [.600]	6	641240-6		
12.70 [.500]	5	3-641240-5	12.70 [.500]	5	641240-5		
10.16 [.400]	4	3-641240-4	10.16 [.400]	4	641240-4		
7.62 [.300]	3	3-641240-3	7.62 [.300]	3	641240-3		
5.08 [.200]	2	3-641240-2	5.08 [.200]	2	641240-2		
DIM A	NO.OF POSN	ASSEMBLY		DIM A	NO.OF POSN	ASSEMBLY	

SUPERCEDED

SUPERCEDED

METRIC

THIS DRAWING IS A CONTROLLED DOCUMENT.

DIMENSIONS: mm [INCHES]	TOLERANCES UNLESS OTHERWISE SPECIFIED:	DIN S. HOOVER 28-DEC-2004	TE Connectivity
0 PLC ±	±	CHK: D. ROSSI 28-DEC-2004	NAME: MTA .100 CONNECTOR ASSEMBLY 28 AWG, STANDARD
1 PLC ±	±	APVD: D. ROSSI 28-DEC-2004	PRODUCT SPEC: 108-1050
2 PLC ±	±		APPLICATION SPEC: 114-1019
3 PLC ±	±		SIZE: A1
4 PLC ±	±		SCALE: 5:1
ANGLES ±	±		SHEET 1 OF 1
FINISH ±	±		REV M1

CUSTOMER DRAWING

X-ON Electronics

Largest Supplier of Electrical and Electronic Components

Click to view similar products for te connectivity manufacturer:

Other Similar products are found below :

[570416-000](#) [CLTEQ-M81CE-SSRELAY-4-20V](#) [D38999/24FJ4AN](#) [358838-000](#) [4-1195131-0](#) [650069-000](#) [SMD100-2](#) [CB-1022B-78](#)
[RM707012](#) [RP410012](#) [MMS42](#) [1-640426-8](#) [2EDL4CM](#) [DTS20W19-11PD-3028-LC](#) [RM202615](#) [NC6-P104-06](#) [TXR64AB90-3616AI](#)
[MSPS103B](#) [DTS26F21-41AE](#) [DTS26F21-41PE-LC](#) [DTS26F21-11SE-3028-LC](#) [1932144-1](#) [293545-4](#) [LVR125S](#) [MS27466T25F4PB](#) [CKB-](#)
[38-78010](#) [1206SFF150F/63-2](#) [5-2027513-8](#) [D38999/20JB35HA](#) [D38999/24WJ20PA](#) [1754138-1](#) [TE1500A2R2J](#) [DTS24F25-29PC-3028-LC](#)
[164-8033-08](#) [D38999/24WG11HA](#) [D38999/24WG11HN](#) [MS27467T21F11H](#) [DJT16E21-11HA](#) [1206SFH150F/24-2](#) [1-532955-3](#) [DTS24F19-](#)
[11SC-3028-LC](#) [DTS24F21-41HN-LC](#) [DTS24F21-41AN](#) [DTS24F21-41PN-LC](#) [DBAS 70-7-0 SN 090-1A SCC](#) [MS27467T21F35J](#)
[MS27467T21F11J](#) [MS27467T21F16H-LC](#) [MS27467T21F35H](#) [MS27467T21F41H-LC](#)