

1. SOLISTRAND* TERMINALS AND SPLICES

SOLISTRAND* Terminals and Splices

(Refer to pages 4 and 5 for application tooling and accessories).

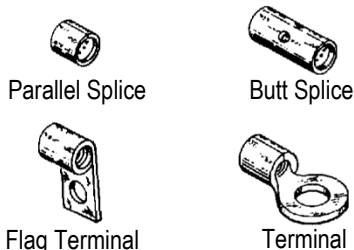

Pressure Type Wire Connector Chart (Use Type "W" Tooling)

WIRE SIZE RANGE	UL 424C LISTED	SP LR 7189 CERTIFIED
22-16 Solid or Stranded	22-16 Solid or Stranded	22-16 Solid or Stranded
16-14 Solid or Stranded	16-14 Solid or Stranded	16-14 Solid or Stranded
12-10 Solid or Stranded	12-10 Stranded	12-10 Solid or Stranded
8 Thru 600 MCM Solid or Stranded	8 Thru 600 MCM Stranded	8 Thru 4/0 Solid or Stranded

NOTE: 22-16 terminals and splices are stamped 22-18 in accordance with MIL-T-7928.

Figure 1

1.1. Tool and Die Selections

A. Hydraulic

Wire Size	Dies for 59973-1, 69065		Dies for 69067		59975-5, 69069 with/Self-Contained Dies	Dies for 48445-1, 1752788-1	Dies for 69082, 1752786-1	Dies for 69097		Dies for 69099, 1752868-1
	Nest	Indenter	Nest	Indenter				Nest	Indenter	
8	48126	48355	48126 [^] 48506 [^]	48355 [^] 48505 [^]	59975-1 69069	---	---	46146	46145	69216
8 H.D.	48128-1	48127-1	48128-1	48127-1	---	---	---	---	---	---
6	48128	48127	48128 [^] 48508 [^]	48127 [^] 48507 [^]	59975-1 69069	---	---	46134	46133	69217
6 H.D.	48129-1	48127-1	48129-1	48127-1	---	---	---	---	---	---
4	48129	48127	48129 [^] 48509 [^]	48127 [^] 48507 [^]	59975-1 69069	---	---	46135	46133	69218
4 H.D.	48130-1	48127-1	48130-1	48127-1	---	---	---	---	---	---
2	48130	48127	48130 [^] 48510 [^]	48127 [^] 48507 [^]	59975-1 69069	---	---	46136	46133	45433
2 H.D.	48132-1	48131-1	48132-1	48131-1	---	---	---	---	---	---
1/0	48132	48131	48132 [^] 48652 [^]	48131 [^] 48511 [^]	---	---	---	46138	46137	45436
1/0 H.D.	48133-1	48131-1	48133-1	48131-1	---	---	---	---	---	---
2/0	48133	---	48133 [^] 48805 [^]	48131 [^] 48511 [^]	---	---	---	---	---	45439
3/0	48134	48131	48134 [^] 48806 [^]	48131 [^] 48511 [^]	---	---	---	---	---	45442
4/0	300430	---	300430 [^] 48807 [^]	48131 [^] 48511 [^]	---	---	---	---	---	45445
250-300 MCM	---	---	---	---	---	48816	69911	---	---	---
300-350 MCM	---	---	---	---	---	48817	69912	---	---	---
400 MCM	---	---	---	---	---	48818	69913	---	---	---
500-600 MCM	---	---	---	---	---	48819	69914	---	---	---

[^] Flag Terminals

Figure 2

B. Hand Tools

Wire Size	HAND TOOLS
26-22	69363†
22-18	---
22-16	49935†
16-14	49935†
14-12	49592†
12-10 16-14 H.D.	49935†
	49965† (Flag Only)
8	69339● (Str. Wire)
	69355●
6	59083● (No Ratchet)
4	---
2	---
1/0	---

†Long Handle, ●Heavy Head

Figure 3

C. Pneumatic and Tape

Wire Size	PNEUMATIC				TAPE	
	Heads for 626	Heads for 69015	Jaws for 68068-[]	Dies for 69710-1	Dies for 69875 •Reversed ••Standard	Dies for 68250-1
26-22	---	---	---	---	68108-1	---
22-18	314516-1 679301-1	---	---	---	---	---
22-16	314516-1 679301-1	---	---	47812	68240-1• 68096-1••	---
16-14	314517-1 679301-1	---	---	47813	68241-1• 68097-1••	---
14-12	314518-1 679301-1	---	---	---	90566-1	---
12-10 16-14 H.D.	679301-1	---	---	47814†	68242-1• 68338-1••	---
8	1338757-1	49956	68135	---	68243-1◇	68312-1◇
		48412●				
6	1338758-1	48172	68136	---	---	68313-1◇
		48413●				
4	---	48173	---	---	---	---
2	---	48174	---	---	---	---
		48415●				
1/0	---	48183	---	---	---	---

● Flag Terminals, † Str. Wire Only, ◇ Single Indent

Figure 4

2. AMPOWER* TERMINALS AND SPLICES

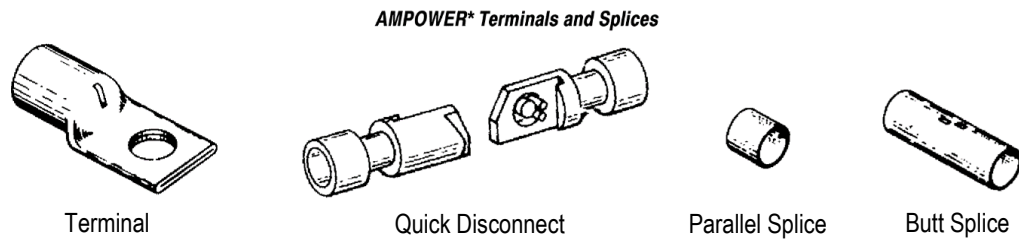

Pressure Type Wire Connector Chart
(Use Type "C" Tooling)

WIRE SIZE RANGE	 424C LISTED	 LR 7189 CERTIFIED
6 thru 1000 MCM	6 thru 1000 MCM Stranded	6 thru 1000 MCM Stranded

Figure 5

2.1. Tool and Die Selections

A. Hydraulic (Use Power Unit 69120-[] or 314979-1)

Wire Size	Dies for 69099 1752868-1	Dies for 69082 1752786-1	Dies for 69065 59973-1	Dies for 58445-1 1752788-1	Dies for 68073-2
6	69133-1	---	---	---	---
4	69134-2	---	---	---	---
2	46765-3	---	46321-3	---	---
1/0	46766-2	---	46322-2	---	---
	68361-1† (with Locator)				
2/0	46767-2	---	46323-2	---	---
	68253-1† (with Locator)				
3/0	46749-2	---	46324-2	---	---
	59867-1† (with Locator)				
4/0	46750-2	---	46325-2	---	---
	68304-1† (with Locator)				
250 MCM	46751-2 68203-1†	---	---	46326-2	---
300 MCM	46752-2	---	---	---	---
350 MCM	46753-2	69653 68204-1†	---	---	---
400 MCM	---	46754-2 68332-1†	---	---	---
500 MCM	---	46755-2 68206-1†	---	---	---
600 MCM	---	46756-2	---	---	---
600 H.D.	---	59870-1	---	---	---
700 MCM	---	46757-2	---	---	---
800 MCM	---	46758-2	---	---	---
900 MCM	---	46759-2	---	---	---
1000 MCM	---	46760-2	---	---	---
1250 MCM	---	---	---	---	68114-1
1500 MCM	---	---	---	---	68282-1

†Quick Disconnect Terminals Only

Figure 6

Tooling and Accessories

Hydraulic

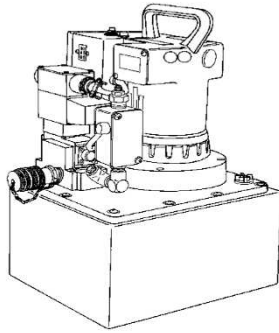

DYNA-CRIMP*
Hydraulic Power Units
69120-1 (115 VAC – 60 Hz)
1804700-1 (115 VAC – 60 Hz)
69120-2 (230 VAC – 60 Hz)
1804700-2 (230 VAC – 60 Hz)

Handle Control w/Hose and
Cord 59907-[] and 1901775-[]



Foot Control
68284-1

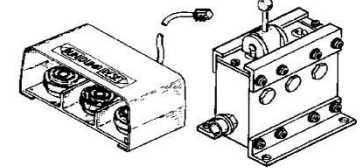

3-Way Multi-
directional Valve
59220 (No Safety Sw)
59220-2 (w/Safety Sw)

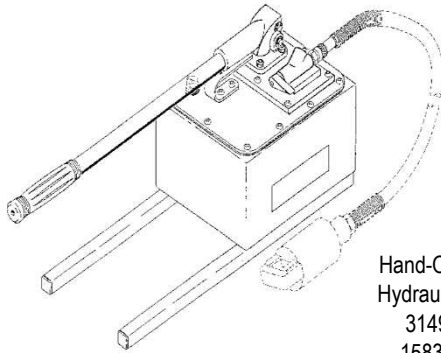

Hand-Operated
Hydraulic Pump
314979-1
1583661-1

Hose Assy w/Crimping
Head Coupling
59909-[], 1583662-[]

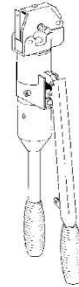

Hand Tool
59975-1

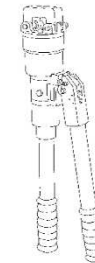

Hand Tool
59973-1

Tape Machines

AMP-TAPETRONIC*
Machine 68250-1

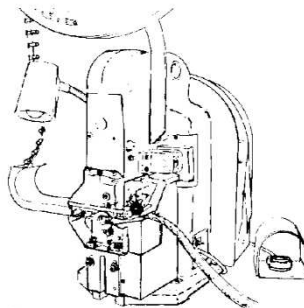

AMP-TAPETRONIC*
Machine 69875

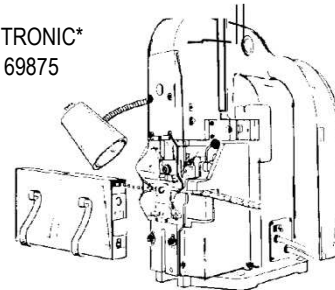

Pneumatic

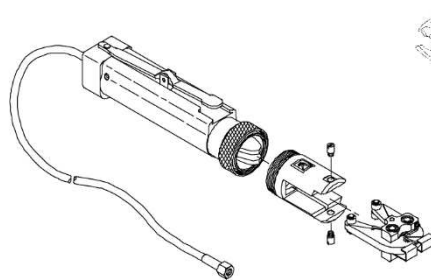

626 Pneumatic Tooling Systems

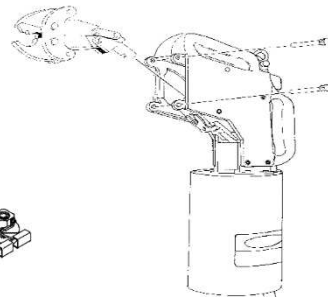

69015

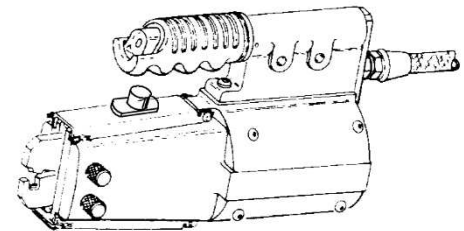

68068

Figure 7

Tooling and Accessories

Hydraulic Crimping Heads

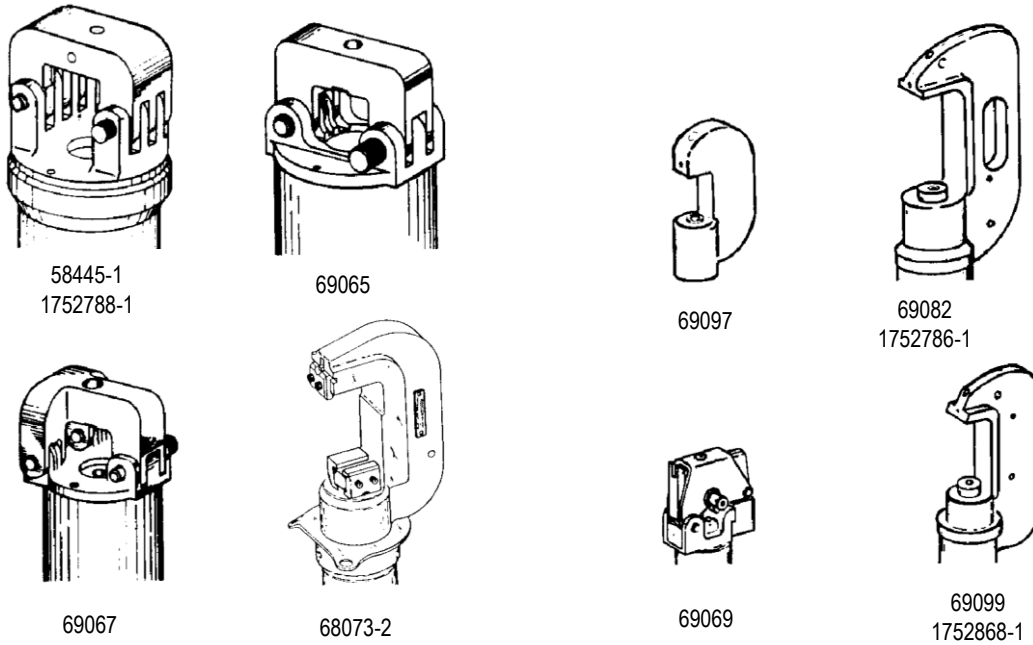

Figure 8

Hand Tools

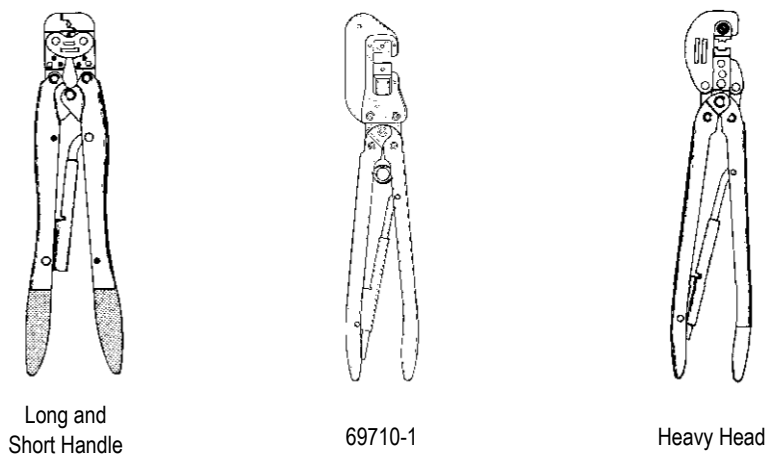

Figure 9

3. REVISION SUMMARY

- ◆ All paragraphs revised due to formatting adjustments and editing.
- ◆ Corrections to Figure 6 were made, as follows: added line item for 350 MCM and corrected line item for 400 MCM to match previous revision.

X-ON Electronics

Largest Supplier of Electrical and Electronic Components

Click to view similar products for [Extraction, Removal & Insertion Tools](#) category:

Click to view products by [TE Connectivity](#) manufacturer:

Other Similar products are found below :

[M8196914-08](#) [768211-2](#) [809-131](#) [844751-2](#) [8-59558-2](#) [91018-1](#) [12014013](#) [12093647](#) [1-21048-0](#) [R282867020](#) [12093078](#) [1-21048-6](#)
[12121897](#) [DCF.91.405.5LT](#) [1322](#) [15314260](#) [15350698](#) [15350707](#) [15430130](#) [1579018-4](#) [1643916-1](#) [1-679532-0](#) [1976593-3](#) [OUTEXT-0321](#)
[2-1579008-3](#) [2-1579008-4](#) [229694-7](#) [231106-1](#) [241469](#) [91040-3](#) [91040-7](#) [965004-000](#) [965069-000](#) [1738219-1](#) [ET-JL05-16](#) [FG 0300 146](#)
[3000](#) [FIT-6](#) [210S048](#) [2-1579007-9](#) [231879-1](#) [312138-3](#) [RJ11FODE](#) [356-162](#) [M8196914-10](#) [4-1579018-0](#) [430395-001](#) [483249-1](#) [5-](#)
[1579007-2](#) [5-1579007-9](#) [BPR10](#)