

THIS DRAWING IS UNPUBLISHED. RELEASED FOR PUBLICATION
 © COPYRIGHT - By - ALL RIGHTS RESERVED.

| LOC | DIST | REVISIONS | | | | | |
|-----|------|-----------|-----|---------------------------|-----------|-----|------|
| AD | 00 | P | LTR | DESCRIPTION | DATE | DWN | APVD |
| | | T | | REVISED PER ECO-15-008006 | 17NOV2015 | NK | MM |

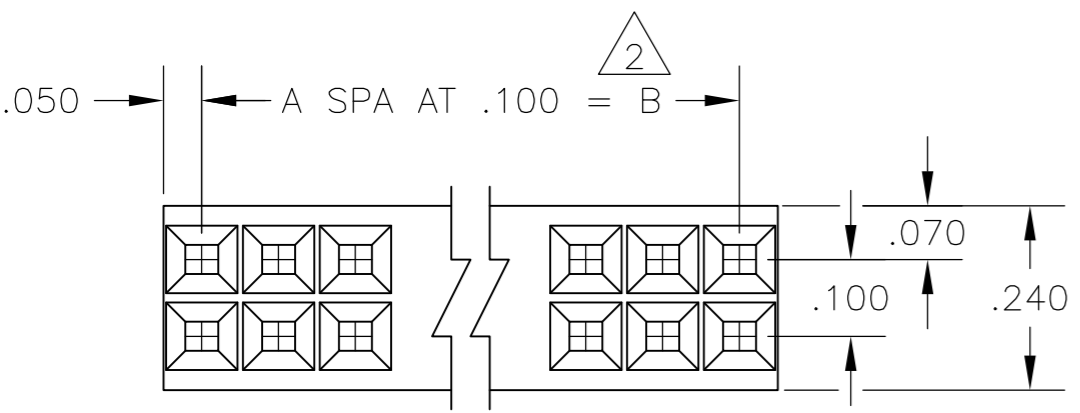
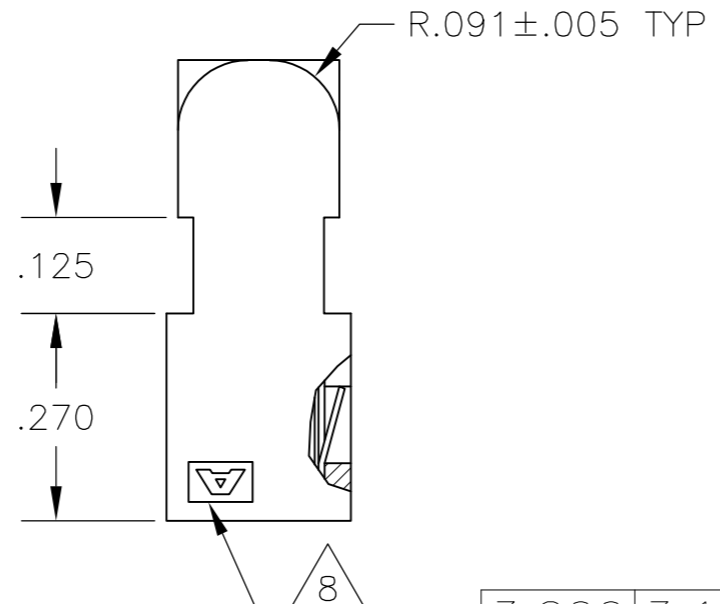
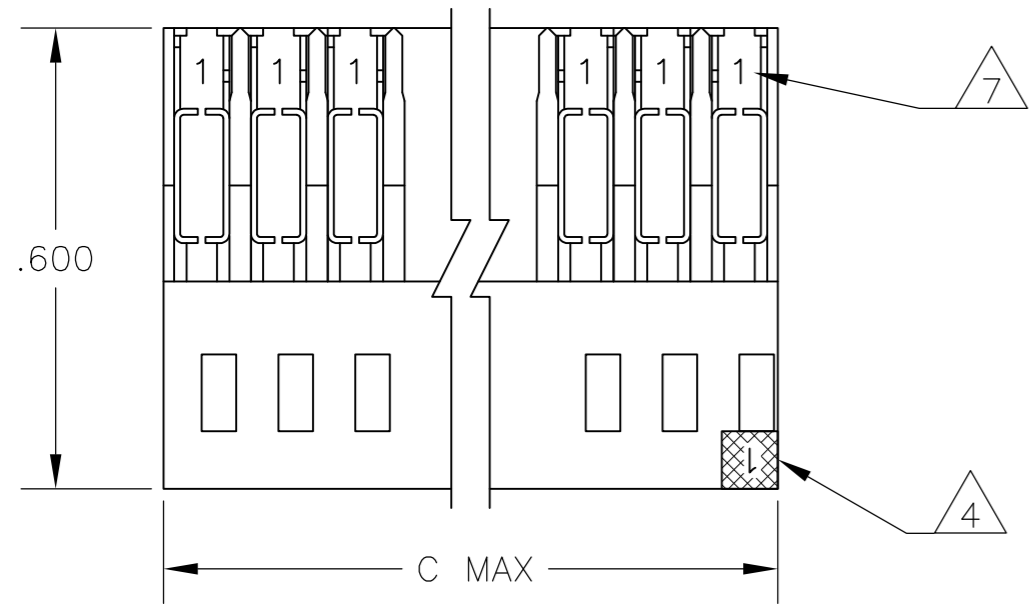

| C | B | A | NO OF POS | ASSEMBLY PART NUMBER |
|-------|-------|----|-----------|----------------------|
| 3.200 | 3.100 | 31 | 64 | 3 8-102393-0 |
| 3.000 | 2.900 | 29 | 60 | 3 7-102393-8 |
| 2.700 | 2.600 | 26 | 54 | 3 7-102393-5 |
| 2.500 | 2.400 | 24 | 50 | 3 7-102393-3 |
| 2.000 | 1.900 | 19 | 40 | 3 6-102393-8 |
| 1.700 | 1.600 | 16 | 34 | 3 6-102393-5 |
| 1.600 | 1.500 | 15 | 32 | 3 6- -4 |
| 1.500 | 1.400 | 14 | 30 | 3 6- -3 |
| 1.400 | 1.300 | 13 | 28 | 3 6- -2 |
| 1.300 | 1.200 | 12 | 26 | 3 6- -1 |
| 1.200 | 1.100 | 11 | 24 | 3 6- -0 |
| 1.100 | 1.000 | 10 | 22 | 3 5- -9 |
| 1.000 | .900 | 9 | 20 | 3 5- -8 |
| .900 | .800 | 8 | 18 | 3 5- -7 |
| .800 | .700 | 7 | 16 | 3 5- -6 |
| .700 | .600 | 6 | 14 | 3 5- -5 |
| .600 | .500 | 5 | 12 | 3 5- -4 |
| .500 | .400 | 4 | 10 | 3 5- -3 |
| .400 | .300 | 3 | 8 | 3 5- -2 |
| .300 | .200 | 2 | 6 | 3 5-102393-1 |

| | C | B | A | NO OF POSN | ASSEMBLY PART NUMBER |
|--------------|-------|-------|----|------------|----------------------|
| SUPERSEDED | 3.600 | 3.500 | 35 | 72 | 3-102393-4 |
| SUPERSEDED | 3.500 | 3.400 | 34 | 70 | 3- -3 |
| SUPERSEDED | 3.400 | 3.300 | 33 | 68 | 3- -2 |
| SUPERSEDED | 3.300 | 3.200 | 32 | 66 | 3- -1 |
| SUPERSEDED | 3.200 | 3.100 | 31 | 64 | 3- 1-0 |
| SUPERSEDED | 3.100 | 3.000 | 30 | 62 | 2- -9 |
| SUPERSEDED | 3.000 | 2.900 | 29 | 60 | 2- 1-8 |
| SUPERSEDED | 2.900 | 2.800 | 28 | 58 | 2- -7 |
| SUPERSEDED | 2.800 | 2.700 | 27 | 56 | 2- -6 |
| 9 OBSOLETE | 2.700 | 2.600 | 26 | 54 | 2- 1-5 |
| SUPERSEDED | 2.600 | 2.500 | 25 | 52 | 2- -4 |
| SUPERSEDED | 2.500 | 2.400 | 24 | 50 | 2- 1-3 |
| SUPERSEDED | 2.400 | 2.300 | 23 | 48 | 2- -2 |
| SUPERSEDED | 2.300 | 2.200 | 22 | 46 | 2- -1 |
| SUPERSEDED | 2.200 | 2.100 | 21 | 44 | 2- -0 |
| SUPERSEDED | 2.100 | 2.000 | 20 | 42 | 1- -9 |
| SUPERSEDED | 2.000 | 1.900 | 19 | 40 | 1- 1-8 |
| SUPERSEDED | 1.900 | 1.800 | 18 | 38 | 1- -7 |
| SUPERSEDED | 1.800 | 1.700 | 17 | 36 | 1- -6 |
| 9 OBSOLETE | 1.700 | 1.600 | 16 | 34 | 1- 1-5 |
| 9 OBSOLETE | 1.600 | 1.500 | 15 | 32 | 1- 1-4 |
| 9 OBSOLETE | 1.500 | 1.400 | 14 | 30 | 1- 1-3 |
| 9 OBSOLETE | 1.400 | 1.300 | 13 | 28 | 1- 1-2 |
| 9 SUPERSEDED | 1.300 | 1.200 | 12 | 26 | 1- 1-1 |
| 9 OBSOLETE | 1.200 | 1.100 | 11 | 24 | 1- 1-0 |
| 9 OBSOLETE | 1.100 | 1.000 | 10 | 22 | 1- -9 |
| 9 SUPERSEDED | 1.000 | .900 | 9 | 20 | 1- 1-8 |
| 9 SUPERSEDED | .900 | .800 | 8 | 18 | 1- -7 |
| 9 SUPERSEDED | .800 | .700 | 7 | 16 | 1- 1-6 |
| 9 SUPERSEDED | .700 | .600 | 6 | 14 | 1- -5 |
| 9 SUPERSEDED | .600 | .500 | 5 | 12 | 1- 1-4 |
| 9 SUPERSEDED | .500 | .400 | 4 | 10 | 1- -3 |
| 9 SUPERSEDED | .400 | .300 | 3 | 8 | 1- 1-2 |
| 9 SUPERSEDED | .300 | .200 | 2 | 6 | 1- 102393-1 |

- 1 .000030 GOLD IN THE CONTACT AREA, .000050-.000100 TIN-LEAD IN THE TERMINATION AREA, ALL OVER .000050 NICKEL.
- 2 TOLERANCE NON-CUMULATIVE.
- 3 .000030 GOLD IN THE CONTACT AREA, .000050-.000100 TIN IN THE TERMINATION AREA, ALL OVER .000050 NICKEL.
- 4 MOLDED CIRCUIT #1 IDENTIFIER IN LOCATION SHOWN.
- 5 OBSOLETE PART NUMBER
- 6 USE WITH 26-30 AWG WIRE SIZE, .050 MAX INSULATION DIA., .015 MAX INSULATION WALL THICKNESS.
- 7 CONTACT IDENTIFICATION NUMBER "1" LOCATED IN THIS AREA.
- 8 AMP TRADEMARK (EITHER SIDE).
- 9 OBSOLETE PARTS: OBSOLETE CIS STREAMLINING PER D.RENAUD/D.SINISI

THIS DRAWING IS A CONTROLLED DOCUMENT.

| | | |
|------|-------------|--------|
| DWN | L.D.RINGLEY | 7-1-85 |
| CHK | P.C.deJONG | 7-1-85 |
| APVD | P.C.deJONG | 7-1-85 |

TE Connectivity

ASSEMBLY, MASS TERMINATION, AMPMODU, DOUBLE ROW, .100 X .100 CL, #26-#30 AWG WIRE SIZE

SCALE 4:1 SHEET 1 OF 1 REV T

X-ON Electronics

Largest Supplier of Electrical and Electronic Components

Click to view similar products for [Headers & Wire Housings](#) category:

Click to view products by [TE Connectivity](#) manufacturer:

Other Similar products are found below :

[892-18-020-10-001101](#) [58102-G61-06LF](#) [582553-1](#) [0009485154](#) [009176003701906](#) [0050291907](#) [LY20-4P-DT1-P1E-BR](#) [02.125.8002.8](#)
[609-3404](#) [61062-3](#) [61082-181009](#) [622-3653LF](#) [63453-116](#) [636-1030](#) [636-1427](#) [636-3427](#) [636-4007](#) [641938-9](#) [641991-4](#) [644827-2](#) [65817-](#)
[010LF](#) [65817-015LF](#) [65863-015LF](#) [66207-023LF](#) [67095-007LF](#) [67601157](#) [68645-018](#) [68648-049](#) [70.362.1628.0](#) [70-4210](#) [70-4226B](#) [70-](#)
[4853B](#) [707-5020](#) [707-5028](#) [71.350.2428.0](#) [71918-208LF](#) [71961-016LF](#) [733-134](#) [733-162](#) [754199-000](#) [760-3052](#) [787-8014-00](#) [79531-3000](#)
[FCN-360C032-B](#) [FCN-367T-T012/H](#) [FCN-723D010/2](#) [80.063.4001.1](#) [800-90-001-10-001000](#) [800-90-010-10-002000](#) [801-43-002-10-013000](#)