

REVISIONS					
P	LTR	DESCRIPTION	DATE	DWN	APVD
L3		REVISED PER ECO-20-008708	22JUN2020	RK	JO

D

C

B

A

- 1 SHALL BE THE INTERSECTION OF THE POST AND HOUSING
- 2 THE NOTED DIMENSIONS APPLY AT THE INTERSECTION OF THE POST AND THE HOUSING.
- 3 0.00254[.000100]-0.00508[.000200] MATTE TIN-LEAD OVER 0.00127[.000050] NICKEL ENTIRE POST.
- 4 HOUSING: LCP, COLOR-BLACK.
POST: COPPER ALLOY.
PICK AND PLACE CAP: PPA, COLOR-BLACK.
- 5 PACKAGED IN TAPE AND REEL PER EIA-481 SPECIFICATIONS.
SEE TABLE FOR TAPE WIDTHS.
- 6 PRELIMINARY PART NUMBER - NOT RELEASED FOR PRODUCTION
- 7 0.00254[.000100]-0.00508[.000200] MATTE TIN OVER 0.00127[.000050] NICKEL ENTIRE POST.

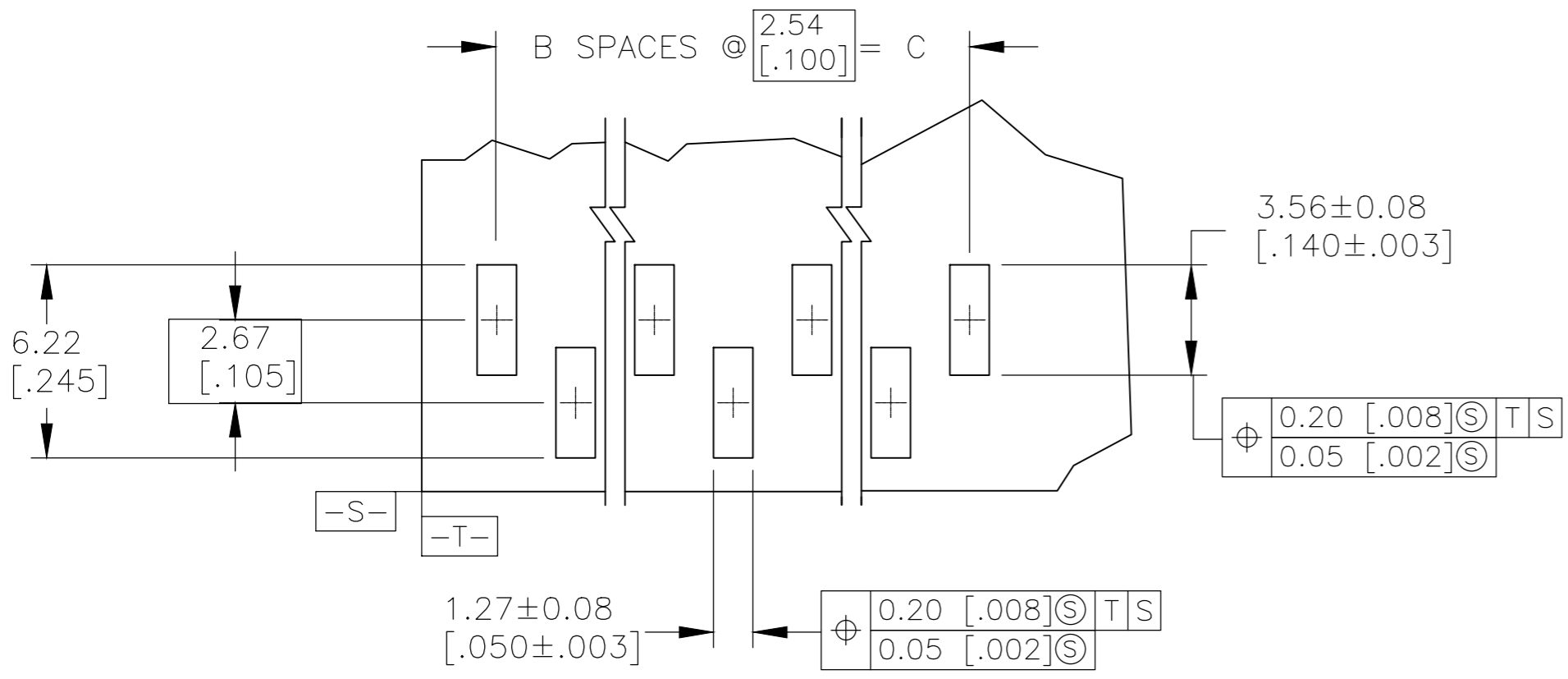
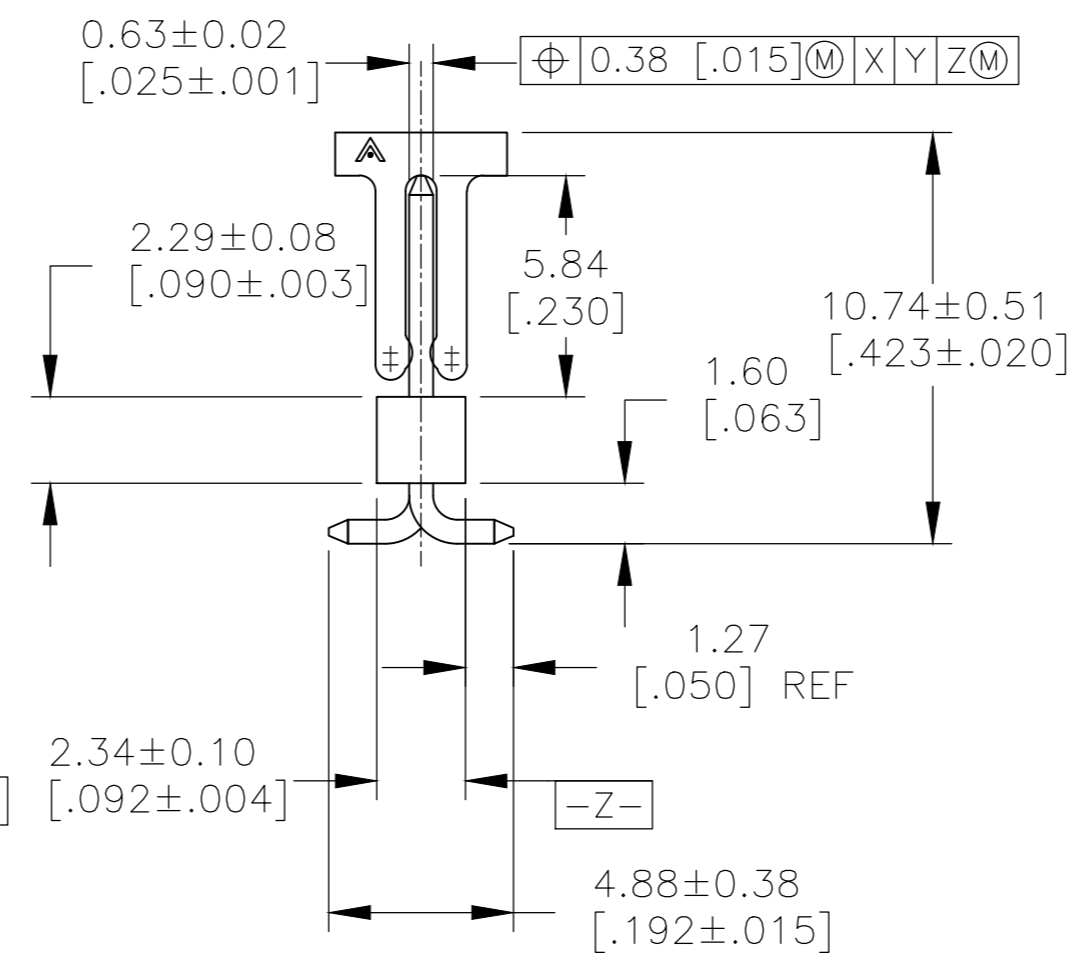
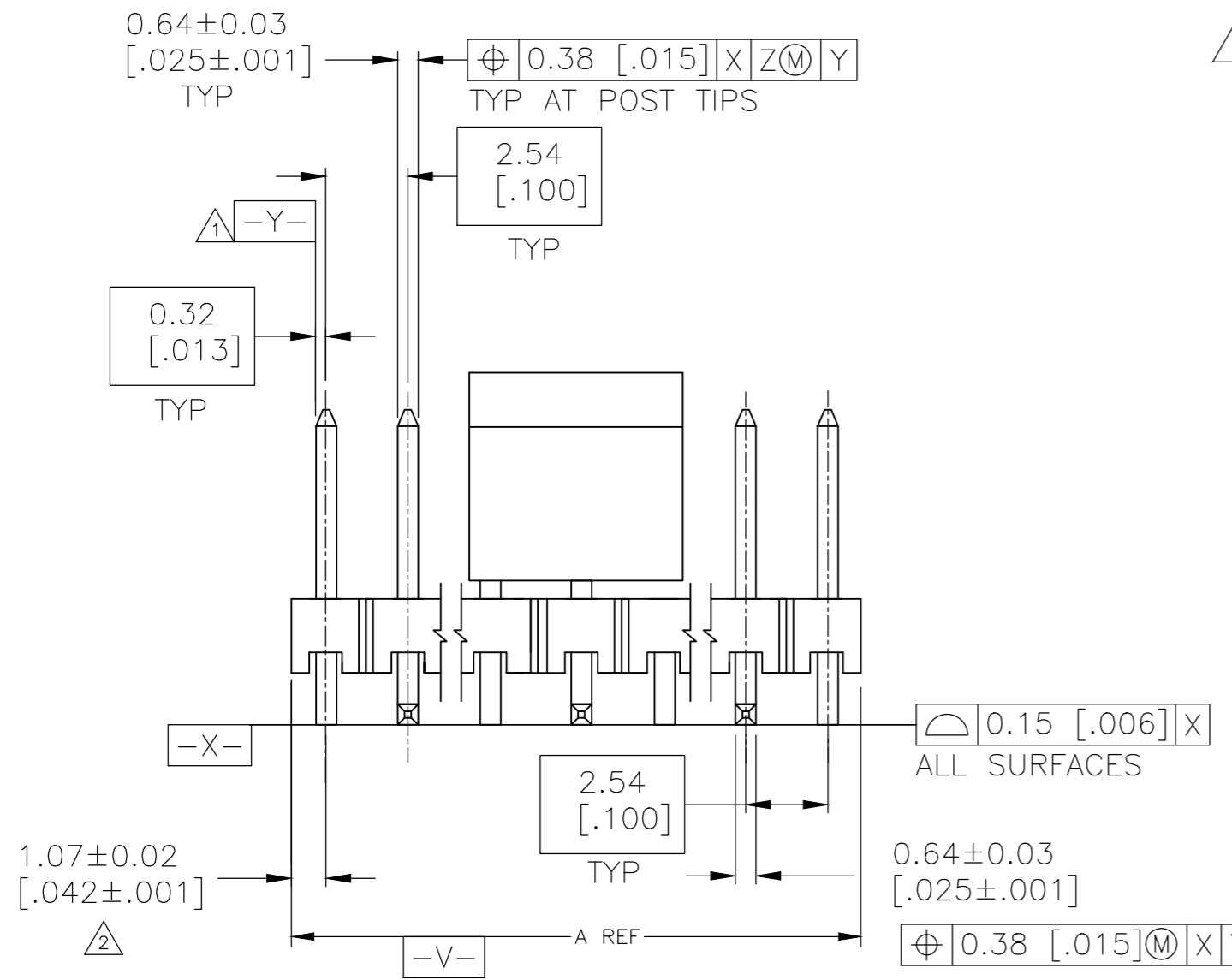
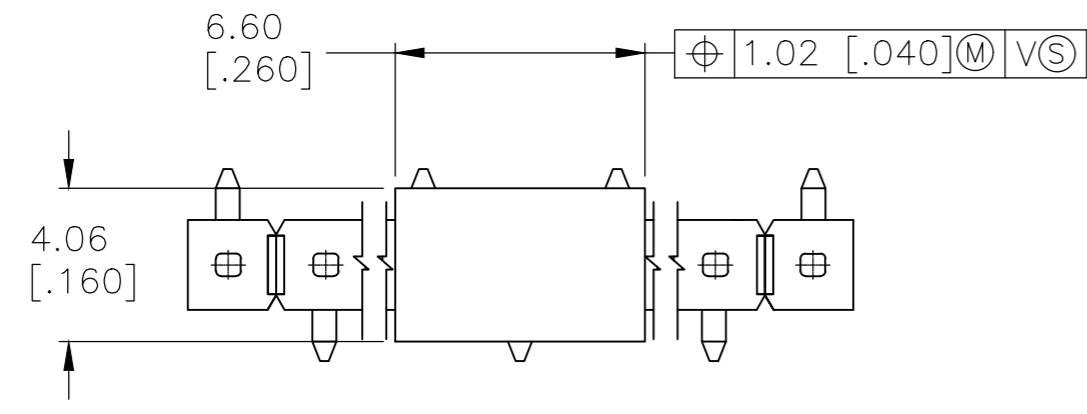

RECOMMENDED PCB LAYOUT FOR USE WITH 0.20[.008] THICK STENCIL

PLATING	TAPE WIDTH	C	B	A	NO OF POSN	PART NUMBER
7	56MM	35.56 [1.400]	14	37.69 [1.484]	15	6-147291-3
7	56MM	33.02 [1.300]	13	35.15 [1.384]	14	6-147291-2
7	56MM	30.48 [1.200]	12	32.61 [1.284]	13	6-147291-1
7	56MM	25.4 [1.000]	10	27.53 [1.084]	11	6-147291-0
7	56MM	22.86 [.900]	9	24.99 [.984]	10	5-147291-9
6	7	32MM	4	10.16 [.400]	5	5-147291-8
6	7	32MM	5	12.70 [.500]	6	5-147291-7
7	24MM	7.26 [.300]	3	9.75 [.384]	4	5-147291-6
7	24MM	5.08 [.200]	2	7.21 [.284]	3	5-147291-5
7	56MM	27.94 [1.100]	11	30.07 [1.184]	12	5-147291-4
7	44MM	20.32 [.800]	8	22.45 [.884]	9	5-147291-3
7	44MM	17.78 [.700]	7	19.91 [.784]	8	5-147291-2
7	44MM	15.24 [.600]	6	17.37 [.684]	7	5-147291-1
3	24MM	7.26 [.300]	3	9.75 [.384]	4	147291-6
3	24MM	5.08 [.200]	2	7.21 [.284]	3	147291-5
3	56MM	27.94 [1.100]	11	30.07 [1.184]	12	147291-4
3	56MM	22.58 [.900]	9	27.53 [1.084]	10	147291-3
3	44MM	17.78 [.700]	7	19.91 [.784]	8	147291-2
3	44MM	15.24 [.600]	6	17.37 [.684]	7	147291-1

THIS DRAWING IS A CONTROLLED DOCUMENT.

DIMENSIONS: mm [INCHES]	TOLERANCES UNLESS OTHERWISE SPECIFIED:	DWN B. HAYMAKER 14JUN99	TE Connectivity
	0 PLC ± -	CHK J. GESFORD 14JUN99	
	1 PLC ± -	APVD J. GESFORD 14JUN99	
	2 PLC ± -	PRODUCT SPEC	
	3 PLC ± 0.13 [.005]	APPLICATION SPEC	
MATERIAL	FINISH	WEIGHT	RESTRICTED TO
	SEE TABLE		A2 - C=147291
CUSTOMER DRAWING			SCALE 5:1 SHEET 1 OF 1 REV L3

X-ON Electronics

Largest Supplier of Electrical and Electronic Components

Click to view similar products for [Headers & Wire Housings](#) category:

Click to view products by [TE Connectivity](#) manufacturer:

Other Similar products are found below :

[892-18-020-10-001101](#) [58102-G61-06LF](#) [582553-1](#) [0009485154](#) [009176003701906](#) [0050291907](#) [LY20-4P-DT1-P1E-BR](#) [02.125.8002.8](#)
[609-3404](#) [61062-3](#) [61082-181009](#) [622-3653LF](#) [63453-116](#) [636-1030](#) [636-1427](#) [636-3427](#) [636-4007](#) [641938-9](#) [641991-4](#) [644827-2](#) [65817-010LF](#) [65817-015LF](#) [65863-015LF](#) [66207-023LF](#) [67095-007LF](#) [67601157](#) [68645-018](#) [68648-049](#) [70.362.1628.0](#) [70-4210](#) [70-4226B](#) [70-4853B](#) [707-5020](#) [707-5028](#) [71.350.2428.0](#) [71918-208LF](#) [71961-016LF](#) [733-134](#) [733-162](#) [754199-000](#) [760-3052](#) [787-8014-00](#) [79531-3000](#)
[FCN-360C032-B](#) [FCN-367T-T012/H](#) [FCN-723D010/2](#) [80.063.4001.1](#) [800-90-001-10-001000](#) [800-90-010-10-002000](#) [801-43-002-10-013000](#)