

THIS DRAWING IS UNPUBLISHED. RELEASED FOR PUBLICATION .19
 (C) COPYRIGHT 19 BY AMP INCORPORATED. ALL RIGHTS RESERVED.

LOC	DIST	REVISIONS					
		P	LTR	DESCRIPTION	DATE	DWN	APVD
G	86	F		REV PER 063A-0485-01	21AUG01	JR	MS

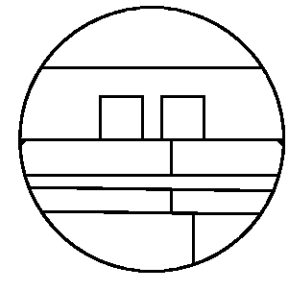
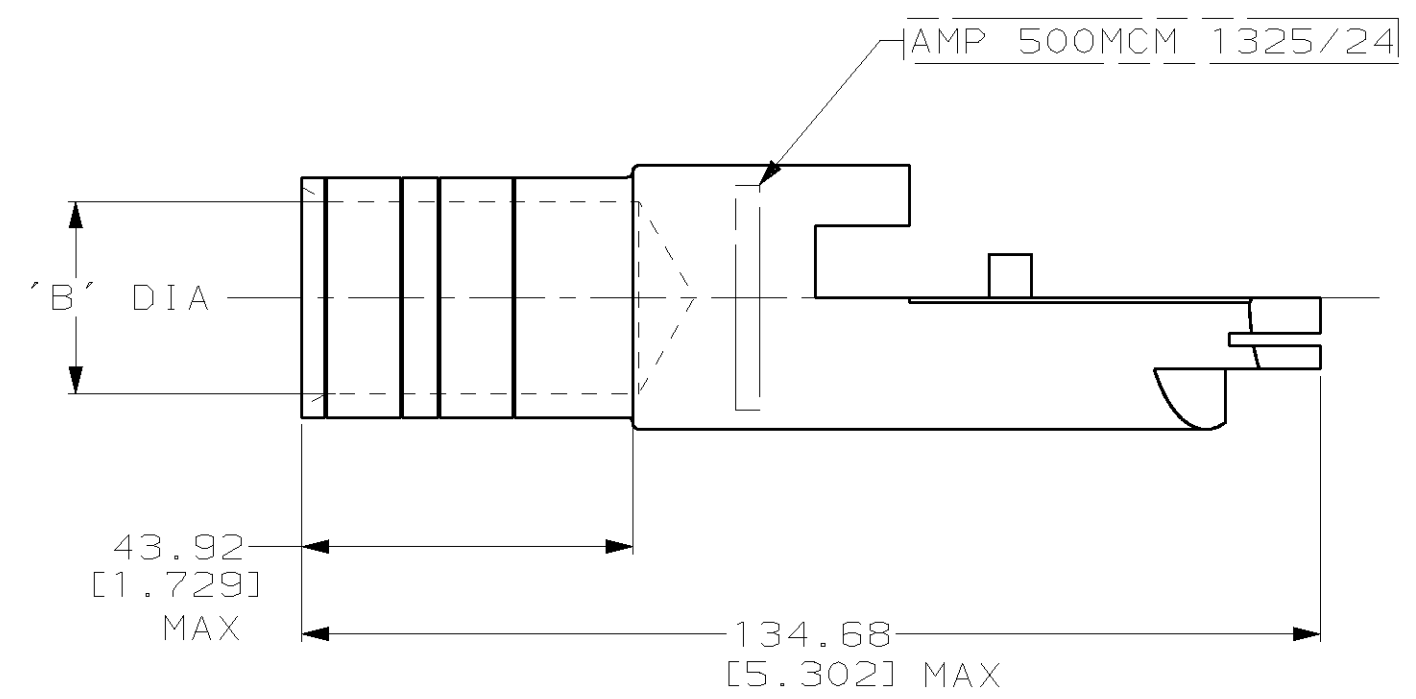
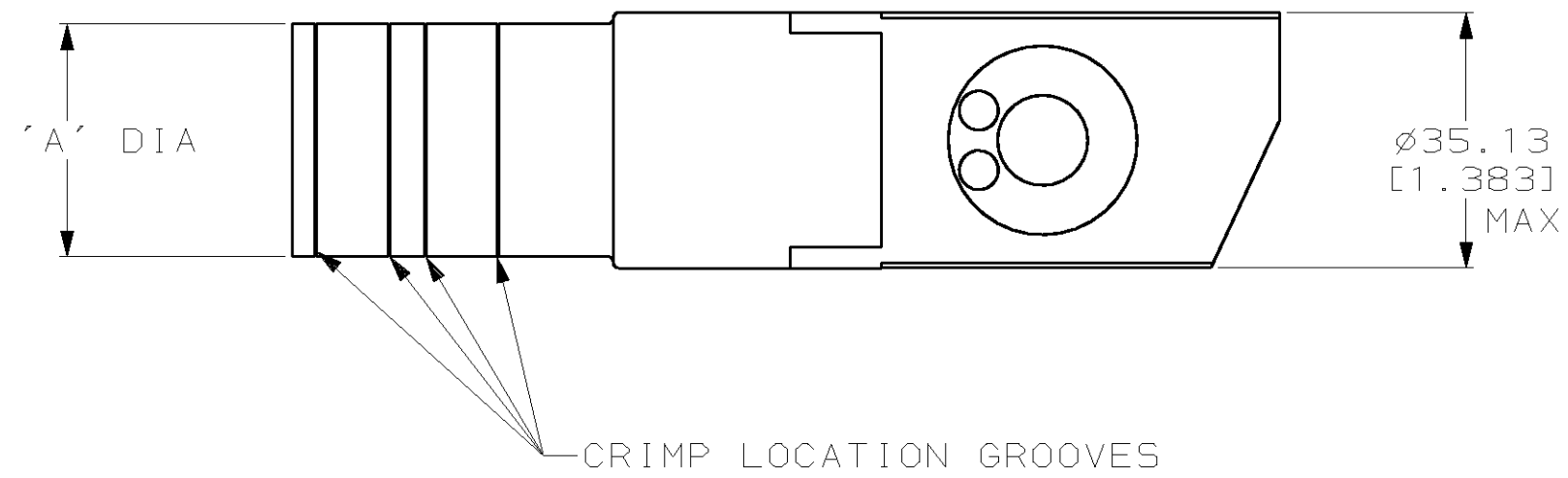

26.92-26.67 [1.060-1.050]	33.66-33.40 [1.325-1.315]	53435-2
25.53-25.40 [1.005-1.000]	32.00-31.75 [1.260-1.250]	53435-1
'B'	'A'	AMP PART NUMBER

DIMENSIONS:		TOLERANCES UNLESS OTHERWISE SPECIFIED:		DWN		AMP Incorporated	
mm [INCHES]		0 PLC ±		DK SCHRUM 17JUN96		Harrisburg, PA 17105-3608	
		1 PLC ±		CHK WJ VOCKROTH 25JUN96		AMP TERMINAL ASSEMBLY, QUICK-DISCONNECT, AMPPOWER, WIRE SIZE: 500 MCM	
		2 PLC ±0.20(.008)		APVD JL MECKLEY 25JUN96			
		3 PLC ±		PRODUCT SPEC		NAME	
		4 PLC ±		APPLICATION SPEC		108-13014	
		ANGLES ±		WEIGHT		SIZE CAGE CODE DRAWING NO	
MATERIAL		FINISH		- lbs		A2 00779 C-53435	
BODY & PINS		SILVER PL		CUSTOMER DRAWING		SCALE 1:1 SHEET 1 OF 1 REV F	
BRASS		0.00127(.000050) MIN					
PER 00-B-626		THK PER 00-S-365					

53435

X-ON Electronics

Largest Supplier of Electrical and Electronic Components

Click to view similar products for [Terminals](#) category:

Click to view products by [TE Connectivity](#) manufacturer:

Other Similar products are found below :

[00-054007-01074-6](#) [00-054007-70206-1](#) [00-054007-70210-8](#) [00-054007-70217-7](#) [00-054007-70226-9](#) [00-054007-70228-3](#) [00-054007-70248-1](#) [00-054007-70256-6](#) [00-054007-70301-3](#) [00-054007-70316-7](#) [00-054007-49560-4](#) [00-054007-70209-2](#) [00-054007-70225-2](#) [00-054007-70227-6](#) [00-054007-70231-3](#) [00-054007-70241-2](#) [00-054007-70242-9](#) [00-054007-70244-3](#) [00-054007-70246-7](#) [00-054007-70263-4](#) [00-054007-70288-7](#) [00-054007-70290-0](#) [00-054007-70300-6](#) [00-054007-70304-4](#) [01-2065-1-0216](#) [01-2900-1-04412](#) [00581P0075](#) [600TS-10](#) [60205-1](#) [604200-1](#) [605601-1](#) [60598-1-CUT-TAPE](#) [61314-6-C](#) [61810-3](#) [61-S](#) [61-SN](#) [626-0194](#) [62-NBM-A](#) [62-SN](#) [62-SP](#) [63-S](#) [640179-1](#) [M55155/059I03](#) [M55155/079C01](#) [M55155/099H02](#) [M55155/109H01](#) [M55155/109H02](#) [M55155/12XH05](#) [M55155/16XH02](#) [M55155/29-5S](#)