

THIS DRAWING IS UNPUBLISHED. RELEASED FOR PUBLICATION  
 © COPYRIGHT BY TYCO ELECTRONICS CORPORATION. ALL RIGHTS RESERVED.

LOC	DIST	REVISIONS			
P	LTR	DESCRIPTION	DATE	DWN	APVD
AJ	16	01	REVISED PER ECO-05-007704	02SEP05	BM KW

- 1 CONTACT CRIMP TOOLING: CRIMP TOOL M22520/2-01 WITH POSITIONER DMC K997 SELECTOR SETTING #4 FOR RG-174/U, RG-188/U & RG-316/U SINGLE AND DOUBLE SHIELDED CABLE.
- 2 FERRULE CRIMP TOOLING: CRIMP TOOL M22520/5-01 WITH DIE SET M22520/5-35B OR USE A 3.25 [.128] X 10.16 [.400] HEX DIE SET.
- 3. PRODUCT DESIGNED TO MEET PRODUCT SPECIFICATION 108-1574.
- 4. INSTRUCTION SHEET: 408-4032

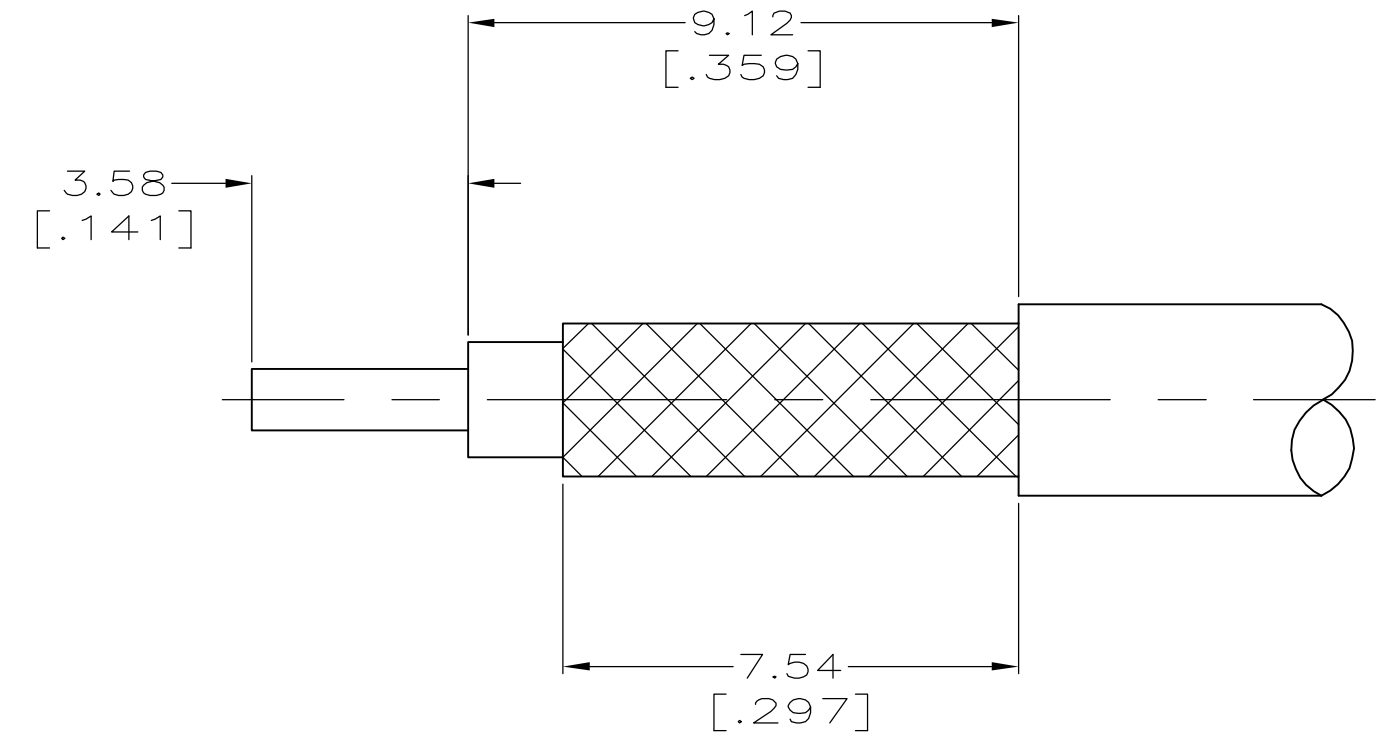
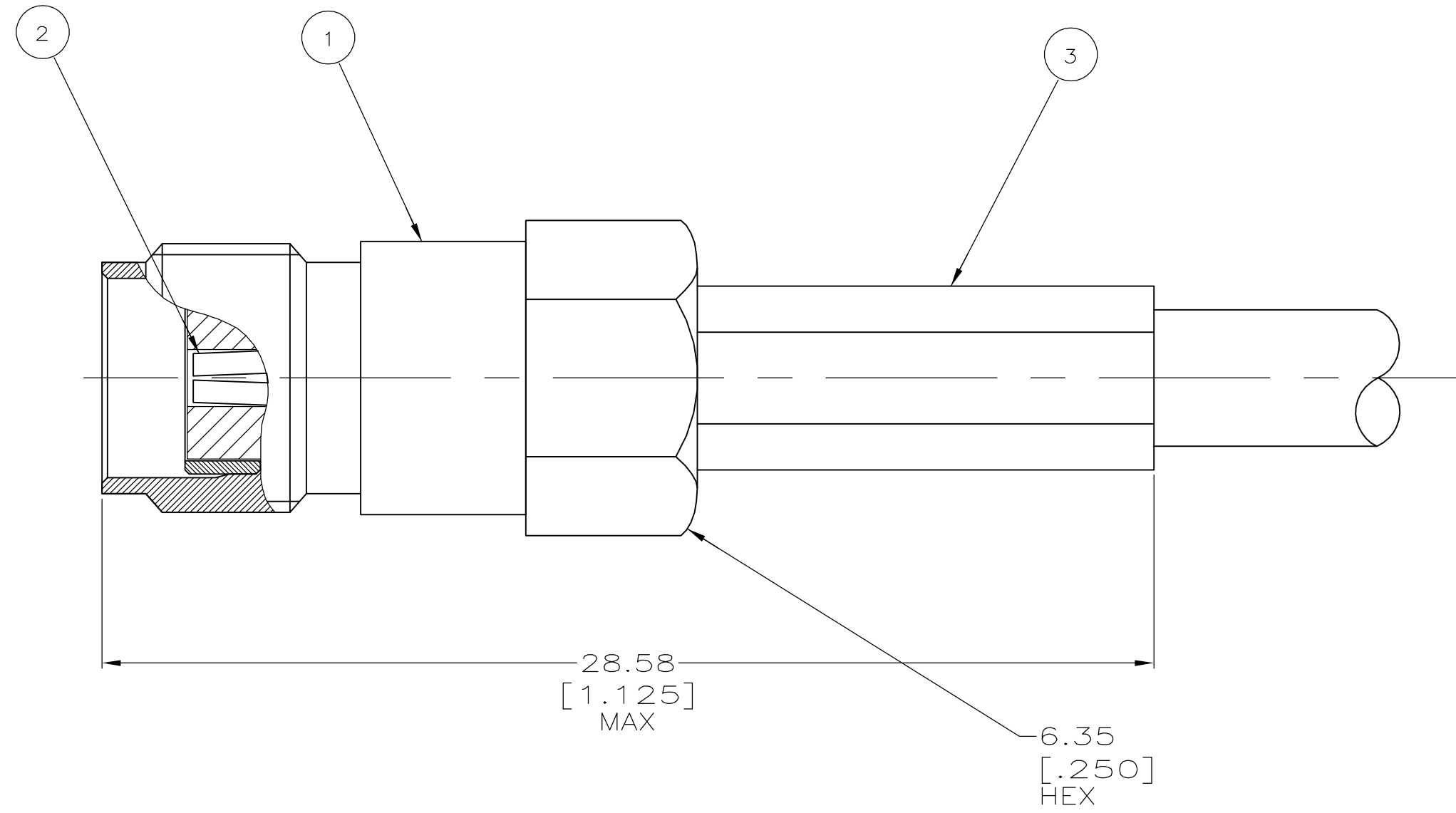

RECOMMENDED STRIP LENGTHS

△△	RG-174, -188, & -316/U	9-446556-1	447842-3	447963-2	5447648-3
CRIMP TOOLING	CABLE	③ FERRULE QTY=1	② CONTACT QTY=1	① JACK ASSY QTY=1	PART NUMBER

THIS DRAWING IS A CONTROLLED DOCUMENT.

DIMENSIONS: mm [INCHES]	TOLERANCES UNLESS OTHERWISE SPECIFIED:	DWN L. VARELA - 31JAN2005	Tyco Electronics Corporation Harrisburg, Pa 17105-3608
	0 PLC ± -	CHK J. HAVENER 31JAN2005	
	1 PLC ± -	APVD D. CAMELIO 31JAN2005	
	2 PLC ± 0.40 [.016]	PRODUCT SPEC	
	3 PLC ± -	APPLICATION SPEC	NAME JACK, HEX CRIMP, COMMERCIAL, SMA
	4 PLC ± -	WEIGHT	SIZE CAGE CODE DRAWING NO RESTRICTED TO
MATERIAL	FINISH	CUSTOMER DRAWING	A2 00779 C=5447648
		SCALE 8:1	SHEET 1 OF 1 REV 01

## X-ON Electronics

Largest Supplier of Electrical and Electronic Components

*Click to view similar products for [RF Connectors / Coaxial Connectors](#) category:*

*Click to view products by [TE Connectivity](#) manufacturer:*

Other Similar products are found below :

[8915-1511-000](#) [89674-0827](#) [6001-7071-019](#) [6002-7051-003](#) [6002-7551-202](#) [6059674-1](#) [619550-1](#) [630059-000](#) [M39030/3-01N](#) [6500-7071-046](#) [6769](#) [CX050L2AQ](#) [7002-1541-010](#) [7002-1542-011](#) [7004-1512-000](#) [7009-1511-004](#) [7010-1511-000](#) [7029-1511-060](#) [7101-1541-010](#) [7101-1571-002](#) [7145-1521-002](#) [7203-1571-003](#) [7209-1511-011](#) [7210-1511-015](#) [7210-1511-019](#) [73137-5015](#) [73216-2241](#) [73404-2300](#) [7405-1521-005](#) [7405-1521-802](#) [8527](#) [8547](#) [FS11V](#) [877931](#) [8808-1511-001](#) [9049-9513-000](#) [9074-9513-000](#) [9101-9573-002](#) [910A205F](#) [9130-9573-002](#) [PL11SC-026](#) [PL375-33](#) [PL40-5](#) [PL74C-221](#) [PL75MC-217](#) [PL803-7](#) [1200690078](#) [1-201144-1](#) [R107003010W](#) [R110A172100](#)