

LOC	DIST	REVISIONS					
FT	60	P	LTR	DESCRIPTION	DATE	OWN	APVD
		M2		REVISED PER ECO-13-005883	23JUL13	KH	MM

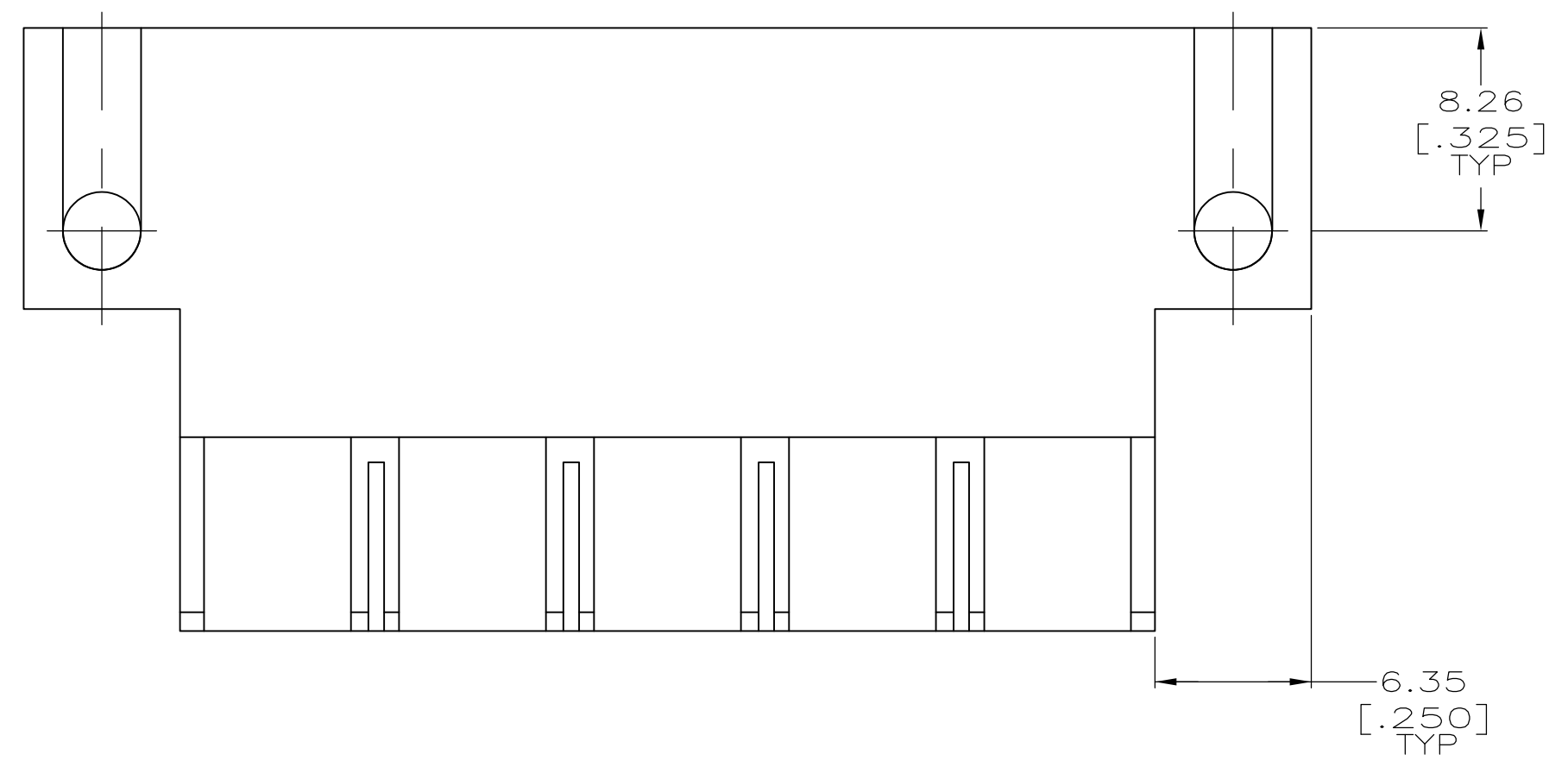
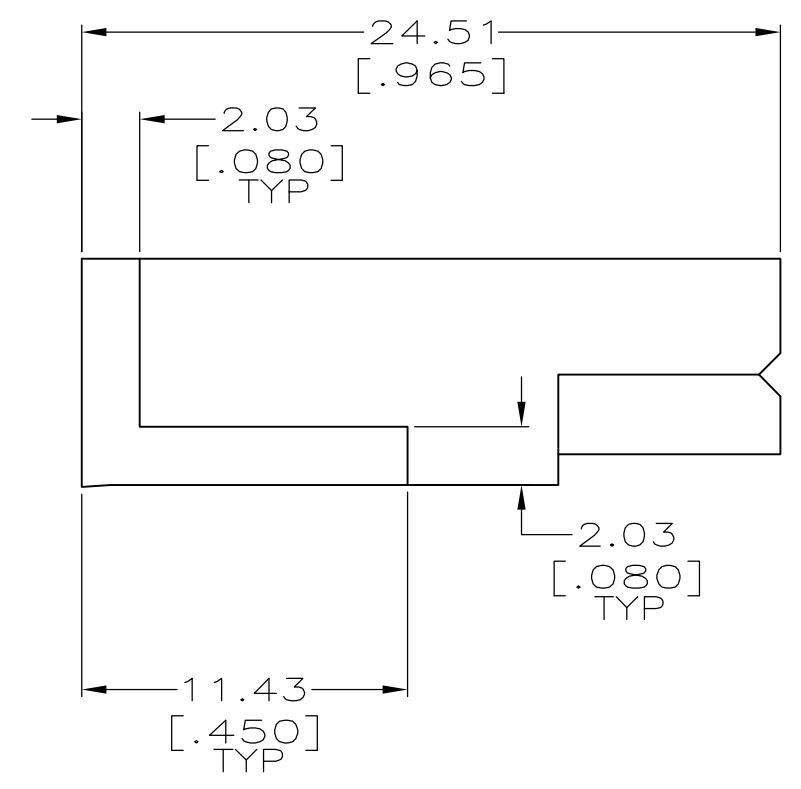
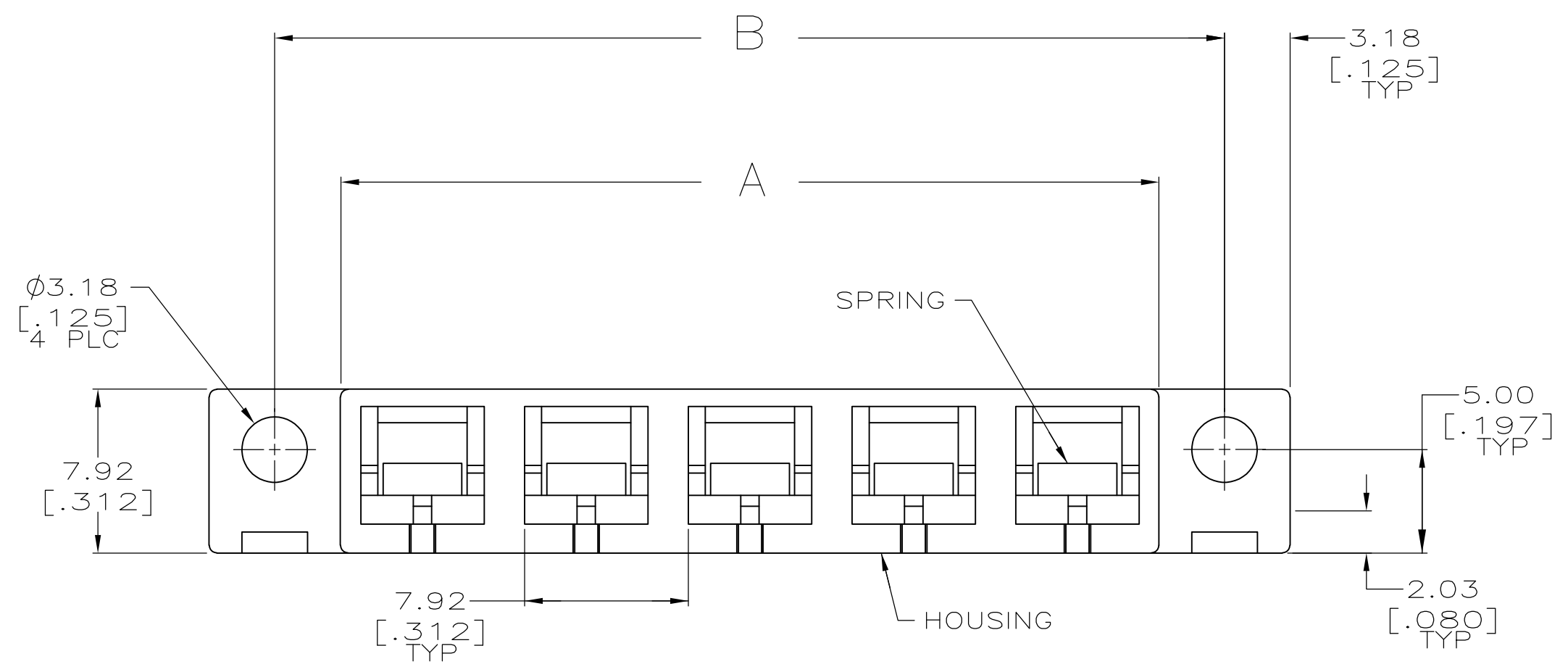

- HOUSING MATES WITH ITSELF 54489, 54483 OR GROUPS OF 53894.
 - ACCEPTS ANY SERIES 1 POWER LOCK CONTACTS.
- 3 HOUSING: NYLON, NATURAL.
SPRING: STAINLESS STEEL.

OBSOLETE	53.90	47.55	6	54489-6
	[2.122]	[1.872]		
	45.97	39.62	5	54489-5
	[1.810]	[1.560]		
	38.05	31.70	4	54489-4
	[1.498]	[1.248]		
30.12	23.77	3	54489-3	
[1.186]	[.936]			
22.20	15.85	2	54489-2	
[.874]	[.624]			
	B	A	NO OF POSN	PART NUMBER

THIS DRAWING IS A CONTROLLED DOCUMENT.

DWN	M.BINNER	10 APR 97	STE TE Connectivity
CHK	R.STONE	24 APR 97	
APVD	M.MCALONIS	22 MAY 97	
DIMENSIONS: mm[INCHES]			NAME
TOLERANCES UNLESS OTHERWISE SPECIFIED:			PRODUCT SPEC
0 PLC	± -		108-11026
1 PLC	± -		APPLICATION SPEC
2 PLC	± 0.25 [.010]		114-6032
3 PLC	± -		SIZE
4 PLC	± -		A2
ANGLES	± -		CAGE CODE
FINISH	-		00779
MATERIAL	3		DRAWING NO
			G-54489
			RESTRICTED TO
			-
CUSTOMER DRAWING			SCALE
			4:1
			SHEET
			1 OF 1
			REV
			M2

X-ON Electronics

Largest Supplier of Electrical and Electronic Components

Click to view similar products for [Power to the Board](#) category:

Click to view products by [TE Connectivity](#) manufacturer:

Other Similar products are found below :

[6450171-4](#) [6450552-7](#) [6600323-8](#) [6643429-1](#) [6646040-2](#) [6651939-1](#) [6766604-1](#) [120959-1](#) [1393557-2](#) [1393532-2](#) [1393532-3](#) [1393532-4](#)
[1393557-1](#) [1600812-5](#) [1-6450861-2](#) [1744132-7](#) [1761122-1](#) [1766250-1](#) [1892109-1](#) [2-6450860-5](#) [2-6450870-0](#) [1-6450161-4](#) [1-6450850-6](#) [1-6450869-6](#) [1645526-2](#) [1-6600130-0](#) [2005243-2](#) [377-0020-11130](#) [TE34-12-16P-F0](#) [5-6450830-6](#) [5646956-4](#) [377-0080-11131A](#) [4-6450830-9](#)
[4-6600333-3](#) [10125416-4050LF](#) [6600320-3](#) [3-6450860-5](#) [1888123-2](#) [6450166-1](#) [6643978-1](#) [6766605-1](#) [701-15-02109](#) [N11444](#) [6651938-1](#)
[6450810-7](#) [46437-1112](#) [1-1589677-8](#) [5646956-5](#) [6450813-2](#) [6450129-4](#)