

THIS DRAWING IS UNPUBLISHED. RELEASED FOR PUBLICATION
 © COPYRIGHT - By - ALL RIGHTS RESERVED.

| REVISIONS | | | | |
|-----------|-----|---------------|-----------|----------|
| P | LTR | DESCRIPTION | DATE | DWN APVD |
| J2 | | ECO-18-000875 | 24APR2018 | RS SG |

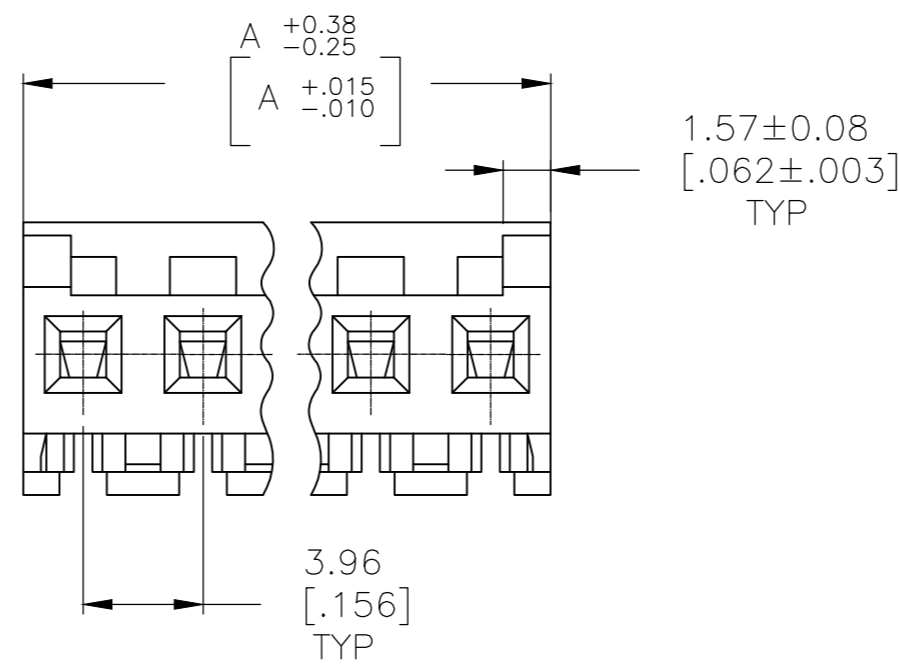
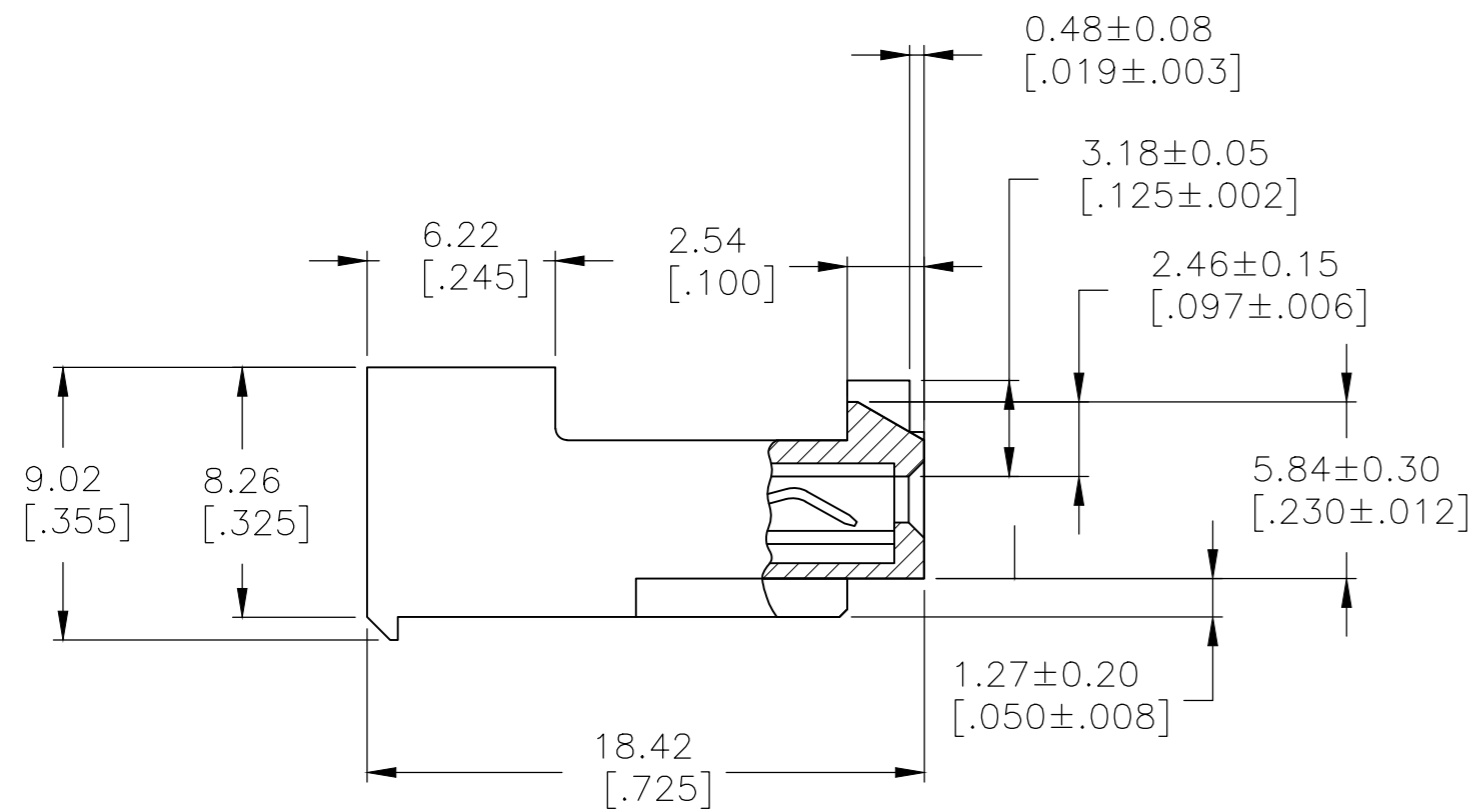
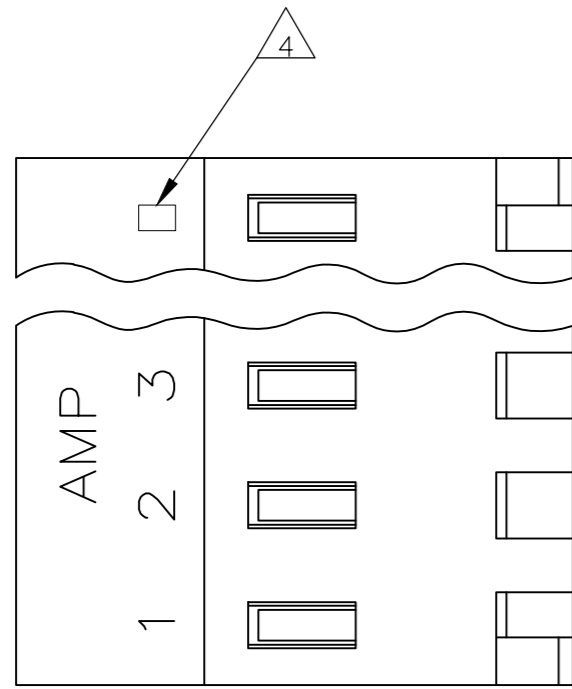

| | | |
|--------------|----|------------|
| 95.10[3.744] | 24 | 5-643817-4 |
| 91.13[3.588] | 23 | 5-643817-3 |
| 87.17[3.432] | 22 | 5-643817-2 |
| 83.21[3.276] | 21 | 5-643817-1 |
| 79.25[3.120] | 20 | 5-643817-0 |
| 75.29[2.964] | 19 | 4-643817-9 |
| 71.32[2.808] | 18 | 4-643817-8 |
| 67.36[2.652] | 17 | 4-643817-7 |
| 63.40[2.496] | 16 | 4-643817-6 |
| 59.44[2.340] | 15 | 4-643817-5 |
| 55.47[2.184] | 14 | 4-643817-4 |
| 51.51[2.028] | 13 | 4-643817-3 |
| 47.55[1.872] | 12 | 4-643817-2 |
| 43.59[1.716] | 11 | 4-643817-1 |
| 39.62[1.560] | 10 | 4-643817-0 |
| 35.66[1.404] | 9 | 3-643817-9 |
| 31.70[1.248] | 8 | 3-643817-8 |
| 27.74[1.092] | 7 | 3-643817-7 |
| 23.77[.936] | 6 | 3-643817-6 |
| 19.81[.780] | 5 | 3-643817-5 |
| 15.85[.624] | 4 | 3-643817-4 |
| 11.89[.468] | 3 | 3-643817-3 |
| 7.92[.312] | 2 | 3-643817-2 |

| | | | | |
|---|--------------------------|--------------|-----------------|------------|
| 7 | SUPERSEDED BY 5-643817-4 | 95.10[3.744] | 24 | 2-643817-4 |
| 7 | SUPERSEDED BY 5-643817-3 | 91.13[3.588] | 23 | 2-643817-3 |
| 7 | SUPERSEDED BY 5-643817-2 | 87.17[3.432] | 22 | 2-643817-2 |
| 7 | SUPERSEDED BY 5-643817-1 | 83.21[3.276] | 21 | 2-643817-1 |
| 7 | SUPERSEDED BY 5-643817-0 | 79.25[3.120] | 20 | 2-643817-0 |
| 7 | SUPERSEDED BY 4-643817-9 | 75.29[2.964] | 19 | 1-643817-9 |
| 7 | SUPERSEDED BY 4-643817-8 | 71.32[2.808] | 18 | 1-643817-8 |
| 7 | SUPERSEDED BY 4-643817-7 | 67.36[2.652] | 17 | 1-643817-7 |
| 7 | SUPERSEDED BY 4-643817-6 | 63.40[2.496] | 16 | 1-643817-6 |
| 7 | SUPERSEDED BY 4-643817-5 | 59.44[2.340] | 15 | 1-643817-5 |
| 7 | SUPERSEDED BY 4-643817-4 | 55.47[2.184] | 14 | 1-643817-4 |
| 7 | SUPERSEDED BY 4-643817-3 | 51.51[2.028] | 13 | 1-643817-3 |
| 7 | SUPERSEDED BY 4-643817-2 | 47.55[1.872] | 12 | 1-643817-2 |
| 7 | SUPERSEDED BY 4-643817-1 | 43.59[1.716] | 11 | 1-643817-1 |
| 7 | SUPERSEDED BY 4-643817-0 | 39.62[1.560] | 10 | 1-643817-0 |
| 7 | SUPERSEDED BY 3-643817-9 | 35.66[1.404] | 9 | 643817-9 |
| 7 | SUPERSEDED BY 3-643817-8 | 31.70[1.248] | 8 | 643817-8 |
| 7 | SUPERSEDED BY 3-643817-7 | 27.74[1.092] | 7 | 643817-7 |
| 7 | SUPERSEDED BY 3-643817-6 | 23.77[.936] | 6 | 643817-6 |
| 7 | SUPERSEDED BY 3-643817-5 | 19.81[.780] | 5 | 643817-5 |
| 7 | SUPERSEDED BY 3-643817-4 | 15.85[.624] | 4 | 643817-4 |
| 7 | SUPERSEDED BY 3-643817-3 | 11.89[.468] | 3 | 643817-3 |
| 7 | SUPERSEDED BY 3-643817-2 | 7.92[.312] | 2 | 643817-2 |
| | | DIM A | NO. OF CIRCUITS | PART NO. |

1 MATERIAL: CONNECTOR - NYLON UL94-V2 (ORANGE)
 CONTACTS - 0.30 [.012] THICK COPPER ALLOY
 (BRIGHT TIN-LEAD 0.00203 [.000080] MIN. THICK
 FOR CONTACTS 643817-2 THRU 2-643817-4).
 (MATTE WHISKER MITIGATED TIN 0.00203 [.000080] MIN. THICK
 FOR CONTACTS 3-643817-2 THRU 5-643817-4).

2 CONTACTS ACCEPT 18 AWG WIRE WITH 2.41 [.095] MAX INSULATION DIAMETER.

3 CONTACTS MUST ACCEPT 1.14±0.03 [.045±.001] POST AND REMAIN LOCKED IN POSITION.

4 IDENTIFICATION NUMBER FOR LAST CIRCUIT MAY NOT APPEAR ON ALL ASSEMBLIES.

5 DIMENSIONS IN BRACKETS ARE IN INCHES.

6 HOUSING FEATURES ARE: CLOSED END WITH LOCKING RAMP AND POLARIZING TAB.

7 OBSOLETE PARTS: OBSOLETE CIS STREAMLINING PER D.RENAUD/D.SINISI

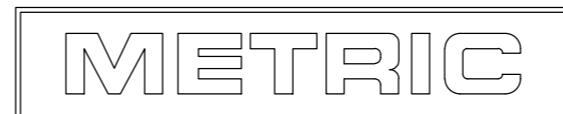

| | | | | |
|--|---------------------|----------------------------|--|---------------|
| THIS DRAWING IS A CONTROLLED DOCUMENT. | | DWN S. CARPENTER 09JUL2003 | TE Connectivity Ltd. | |
| DIMENSIONS: mm [INCHES] | | CHK D. BOSSI 09JUL2003 | | |
| TOLERANCES UNLESS OTHERWISE SPECIFIED: | | APVD D. BOSSI 09JUL2003 | NAME | |
| 0 PLC ± - | 1 PLC ± - | PRODUCT SPEC | MTA 156 CONNECTOR ASSEMBLY, 18 AWG, STANDARD | |
| 2 PLC ± - | 3 PLC ± 0.13 [.005] | APPLICATION SPEC | SIZE | CAGE CODE |
| 4 PLC ± - | ANGLES ± - | FINISH | 114-1020 | 00779 |
| MATERIAL | FINISH | WEIGHT | DRAWING NO | RESTRICTED TO |
| 1 | 1 | - | 114-1020 | - |
| CUSTOMER DRAWING | | | SCALE 4:1 | SHEET 1 OF 1 |
| | | | REV J2 | |

X-ON Electronics

Largest Supplier of Electrical and Electronic Components

Click to view similar products for te connectivity manufacturer:

Other Similar products are found below :

[570416-000](#) [CLTEQ-M81CE-SSRELAY-4-20V](#) [4-1633138-8](#) [D38999/24FJ4AN](#) [4-1195131-0](#) [650069-000](#) [SMD100-2](#) [2EDL4CM](#)
[DTS20W19-11PD-3028](#) [DTS20W19-11PD-3028-LC](#) [DTS20W19-32SD-3028-LC](#) [DTS20W19-32SD-3028](#) [NC6-P104-06](#) [TXR64AB90-](#)
[3616AI](#) [DTS26F21-41HE](#) [DTS26F21-41AE](#) [DTS26F21-41PE-LC](#) [DTS26F21-11SE-3028-LC](#) [D38999/24WF32JE](#) [D38999/24WF32SE-LC](#)
[DTS24W19-32HE](#) [5-2027513-8](#) [D38999/20JB35HA](#) [D38999/24WJ20PA](#) [164-8033-08](#) [D38999/24FF32JE](#) [D38999/24FF32SE-LC](#)
[D38999/24WF32JB](#) [D38999/24WG11HA](#) [D38999/24WG11HN](#) [MS27467T21F11H](#) [DJT16E21-11HA](#) [DTS24F19-32HE](#) [1-532955-3](#)
[DTS20W19-32SA-3028-LC](#) [DTS24F19-11SC-3028-LC](#) [DTS24F19-11SC-3028](#) [DJT14E13-98HB](#) [D38999/20WC8BB](#) [1-330599-5](#)
[DTS24F21-41HN-LC](#) [DTS24F21-41HN](#) [DTS24F21-41AN](#) [DTS24F21-39HN](#) [DTS24F21-41PN-LC](#) [AFD50-10-6SN-1A-LC](#) [DBAS 70-7-0](#)
[SN 090-1A SCC](#) [DJT10F17-26HC](#) [DTS24W19-32HB](#) [ACT20JE99HA](#)