

LOC		DIST		REVISIONS			
P	LTR	DESCRIPTION	DATE	DMN	APVD		
B1		REVISED PER ECO-11-004835	11MAR11	RK	HMR		

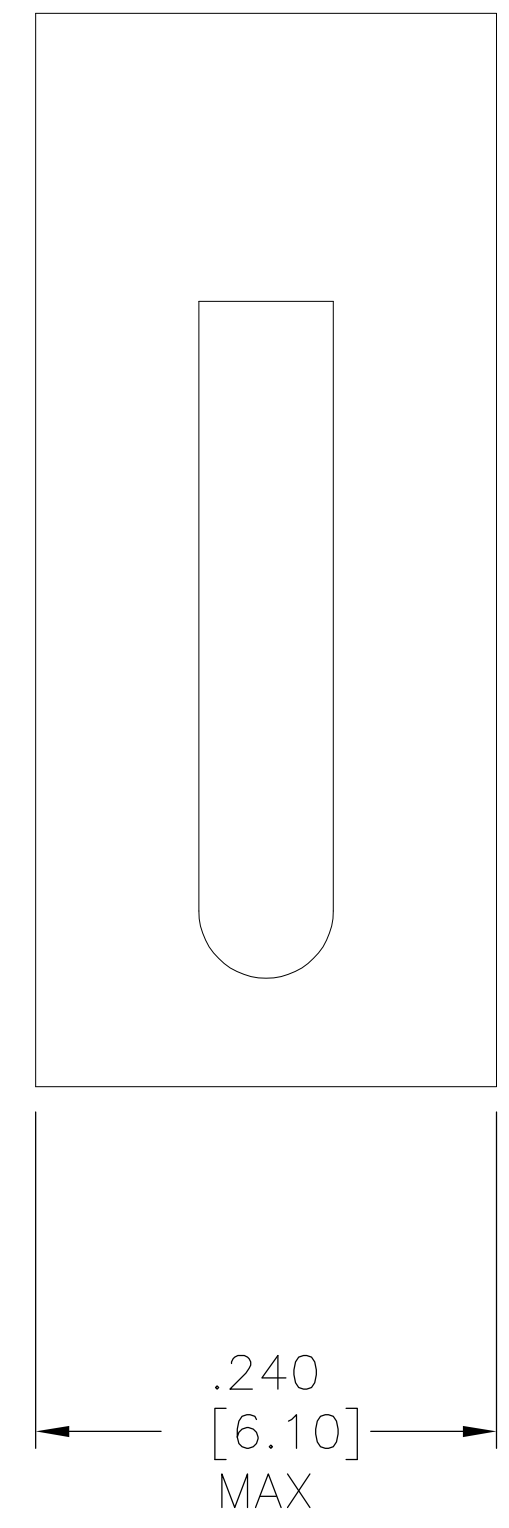
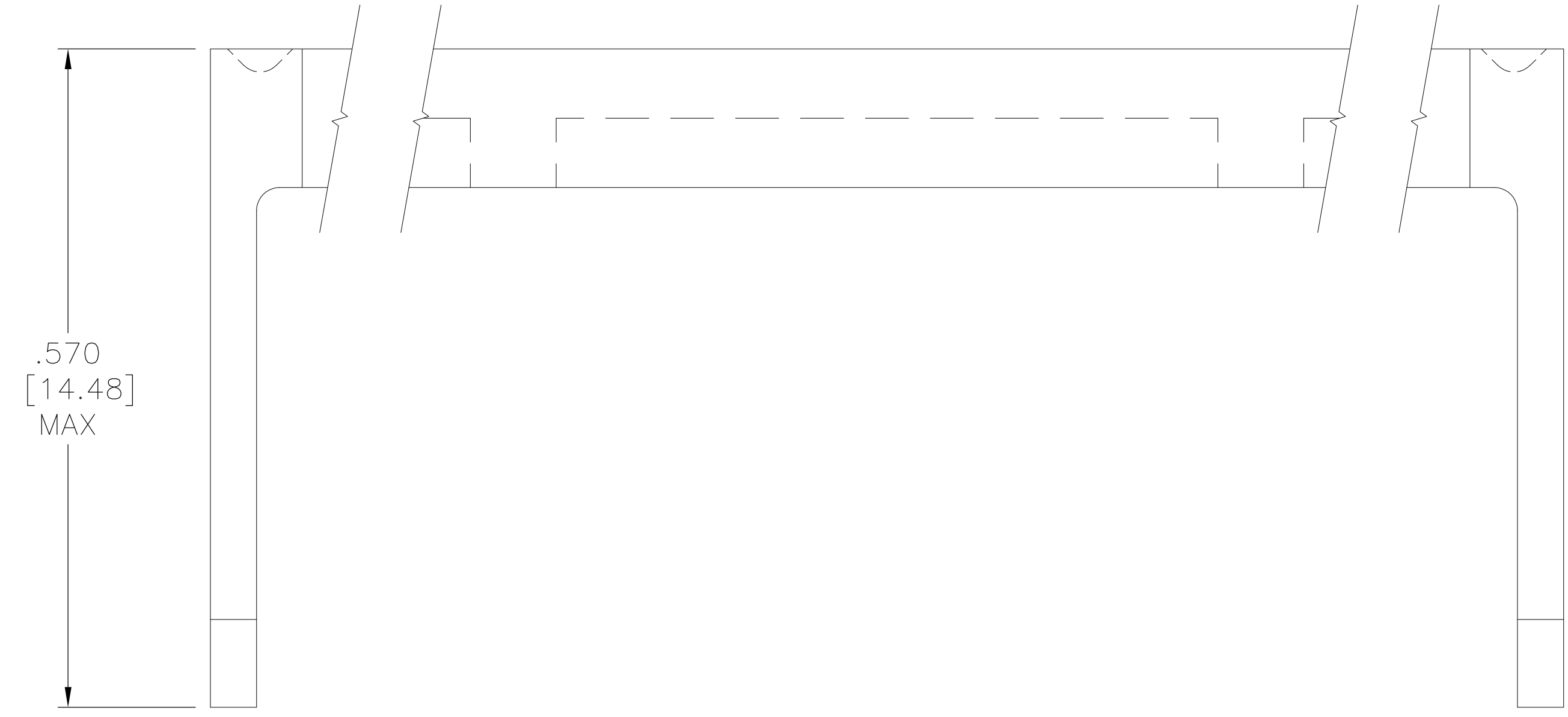
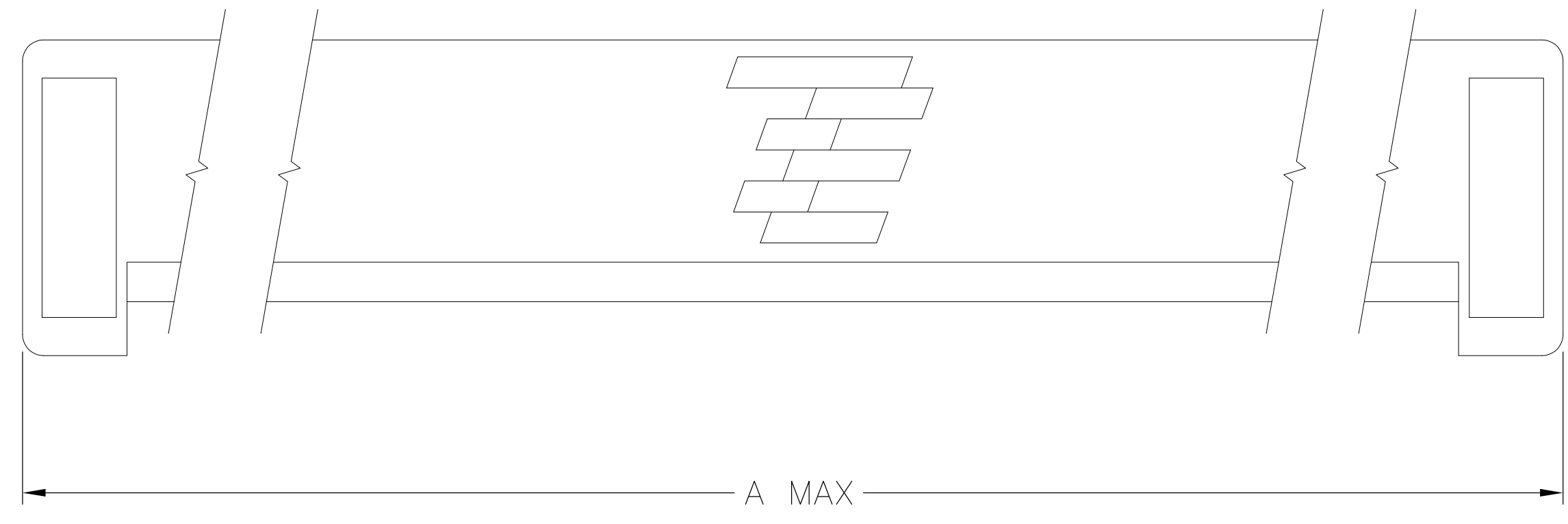

MATERIAL: GLASS REINFORCED THERMOPLASTIC RATED 94V-0.

2. COLOR: BLUE

609-6431HD	85.95	(3.384)	64	1-1437022-3
609-5031HD	68.17	(2.684)	50	8-1437021-1
609-4031HD	55.47	(2.184)	40	5-1437021-5
609-3431HD	47.85	(1.884)	34	3-1437021-2
609-2631HD	37.69	(1.484)	26	1-1437021-2
609-2031HD	30.07	(1.184)	20	8-1437020-6
609-1631HD	24.99	(0.984)	16	6-1437020-6
609-1431HD	22.45	(0.884)	14	5-1437020-1
609-1031HD	17.37	(0.684)	10	3-1437020-7
<b>T&amp;B PART NO (REF)</b>	<b>A</b>	<b>NO OF POSN</b>	<b>PART NO</b>	

THIS DRAWING IS A CONTROLLED DOCUMENT.

DIMENSIONS: mm [INCHES]	TOLERANCES UNLESS OTHERWISE SPECIFIED:	DIN W. DABULAS 3/25/83	CHK: G. KLEMM 3/25/83	APVD: R.R. 3/31/83	NAME: HEAVY DUTY STRAIN RELIEF FEMALE SOCKET CONNECTOR
0. PLC ± .05	1. PLC ± .05	2. PLC ± .05	3. PLC ± .05	4. PLC ± .05	ANGLES ± .5
MATERIAL:	FINISH: -	SIZE: A1	WEIGHT: -	CAGE CODE: 00779	DRAWING NO: 3-1437020-7
CUSTOMER DRAWING		SCALE: 10:1	SHEET: 1 OF 1	REV: B1	RESTRICTED TO: -

**STE** TE Connectivity

## X-ON Electronics

Largest Supplier of Electrical and Electronic Components

*Click to view similar products for [Headers & Wire Housings](#) category:*

*Click to view products by [TE Connectivity](#) manufacturer:*

Other Similar products are found below :

[892-18-020-10-001101](#) [58102-G61-06LF](#) [582553-1](#) [0009485154](#) [009176003701906](#) [0050291907](#) [LY20-4P-DT1-P1E-BR](#) [02.125.8002.8](#)  
[609-3404](#) [61062-3](#) [61082-181009](#) [622-3653LF](#) [63453-116](#) [636-1030](#) [636-1427](#) [636-3427](#) [636-4007](#) [641938-9](#) [641991-4](#) [644827-2](#) [65817-](#)  
[010LF](#) [65817-015LF](#) [65863-015LF](#) [66207-023LF](#) [67095-007LF](#) [67601157](#) [68648-049](#) [70.362.1628.0](#) [70-4210](#) [70-4226B](#) [70-4853B](#) [707-](#)  
[5020](#) [707-5028](#) [71.350.2428.0](#) [71918-208LF](#) [71961-016LF](#) [733-134](#) [733-162](#) [754199-000](#) [760-3052](#) [787-8014-00](#) [79531-3000](#) [FCN-](#)  
[360C032-B](#) [FCN-367T-T012/H](#) [FCN-723D010/2](#) [80.063.4001.1](#) [800-90-001-10-001000](#) [800-90-010-10-002000](#) [801-43-002-10-013000](#)  
[801-43-006-10-002000](#)