

POLARIZING KEY
TYCO PART NUMBER: 1-1437023-2
T&B PART NUMBER (REF): 609-0000
PURCHASE SEPARATELY

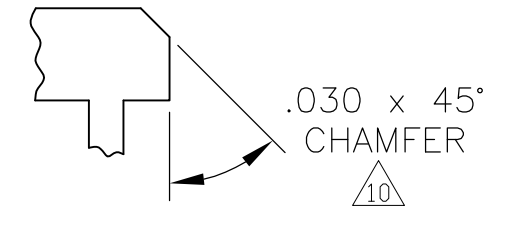

DETAIL X
SCALE 5:1

- 20 POSITION CONNECTOR ASSEMBLY SHOWN.
- MOLDED PARTS: THERMOPLASTIC, UL94V-0 RATED, COLOR BLUE. CONTACTS: BERYLLIUM COPPER.
- CONTACTS: 0.00076[.000030] MIN GOLD ON MATING AREA, 0.00254-0.00508[.000100-.000200] BRIGHT TIN LEAD ON TERMINATION END, ALL OVER 0.00127[.000050] MIN NICKEL ON ENTIRE CONTACT.
- CONTACTS: 0.00127[.000050] MIN GOLD ON MATING AREA, 0.00254-0.00508[.000100-.000200] BRIGHT TIN LEAD ON TERMINATION END, ALL OVER 0.00127[.000050] MIN NICKEL ON ENTIRE CONTACT.
- POLARIZER FEATURE DOES NOT EXIST ON POSITION #1 END FOR 14 POSITION AND SMALLER ASSEMBLIES.
- POLARIZER FEATURE DOES NOT EXIST ON THIS END FOR 6 POSITION ASSEMBLY.
- FOR TERMINATION OF 28 OR 30 AWG STRANDED PVC INSULATED FLAT RIBBON CABLE.
- STRAIN RELIEF PACKAGED SEPARATELY AND SHIPPED WITH ASSEMBLY.
- DATE CODE STAMPED ON THIS SIDE OF CONNECTOR. 6 POSITION CONNECTORS EXCLUDED.
- ALTERNATE COVER END APPLIES TO INDICATED NUMBERS.
- OBsolete PARTS: OBSOLETE CIS STREAMLINING PER D.RENAUD/D.SINISI

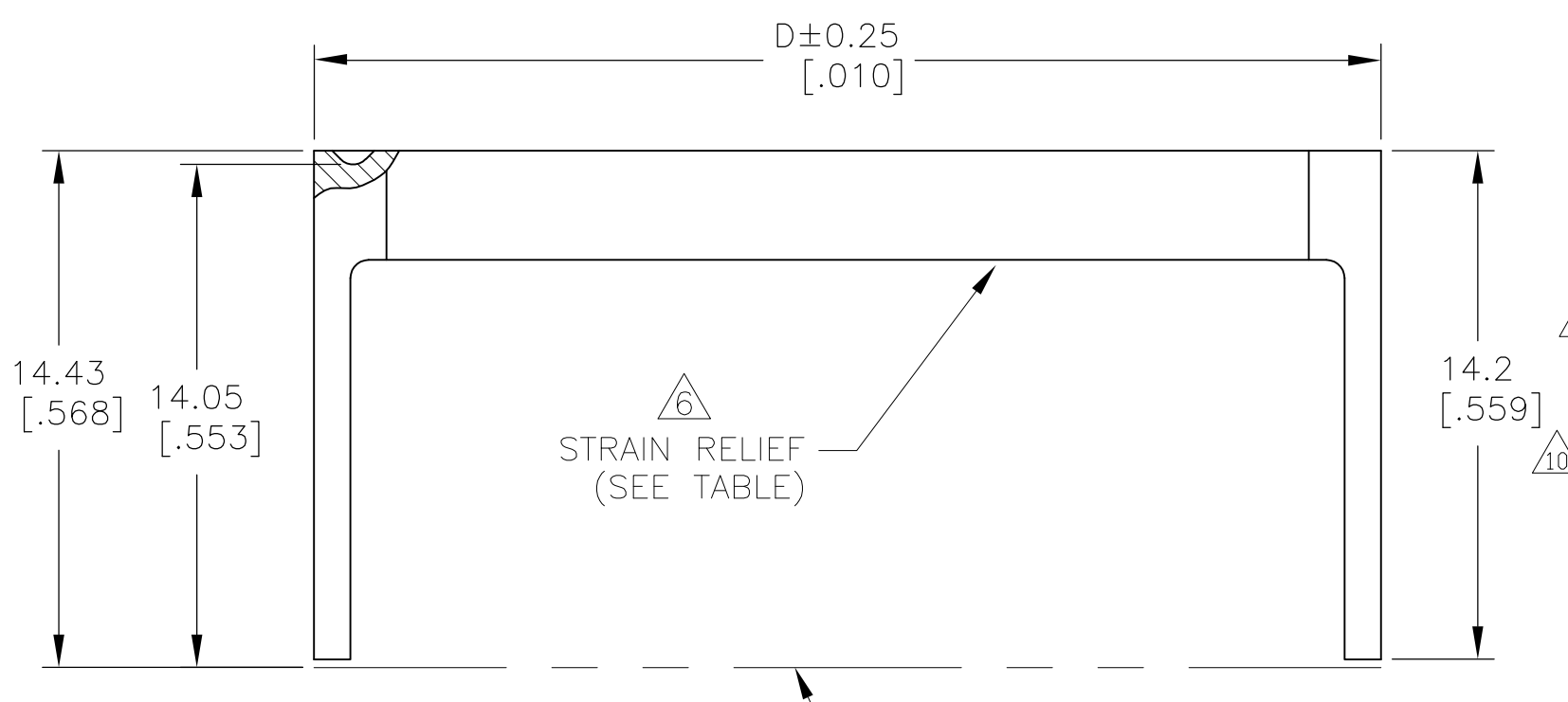
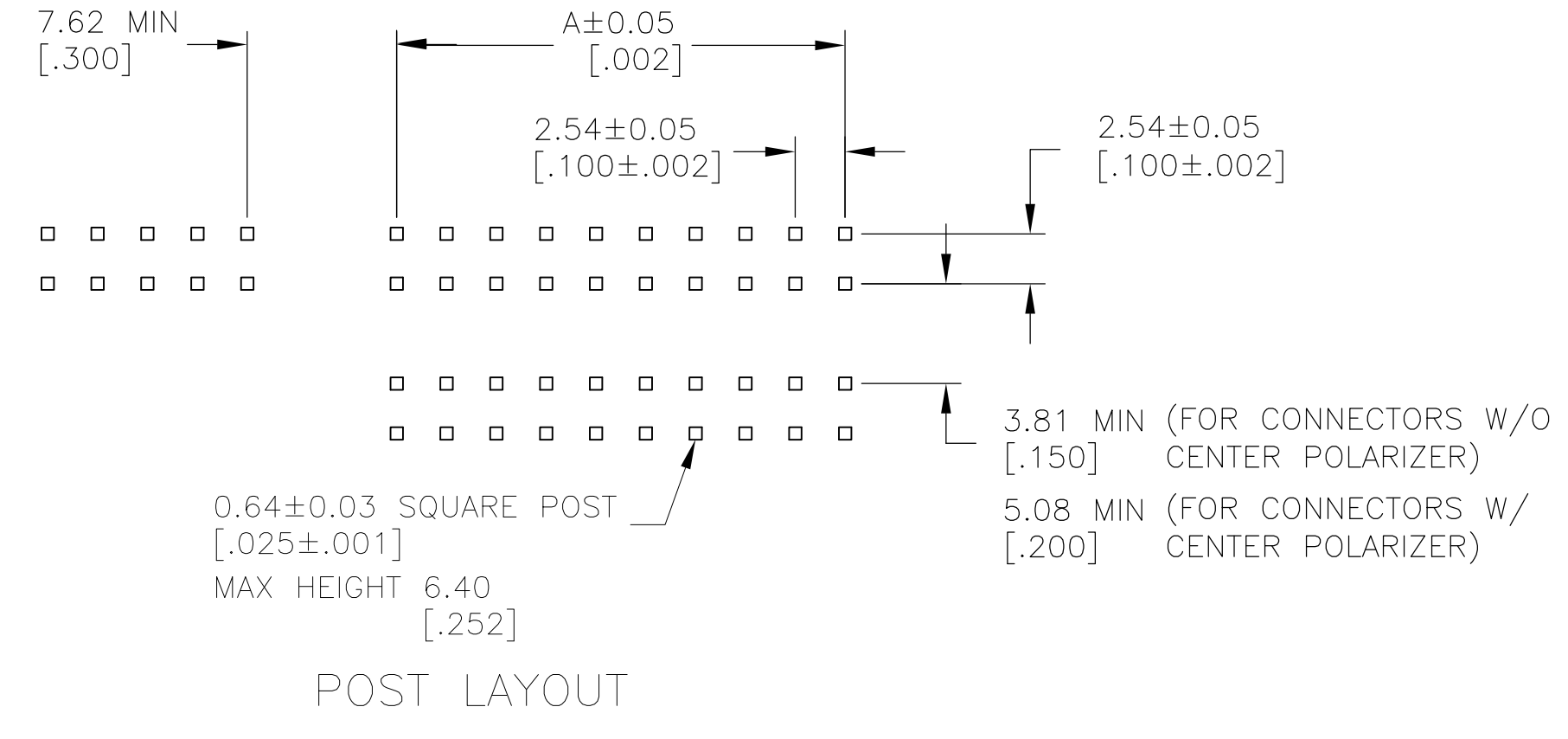
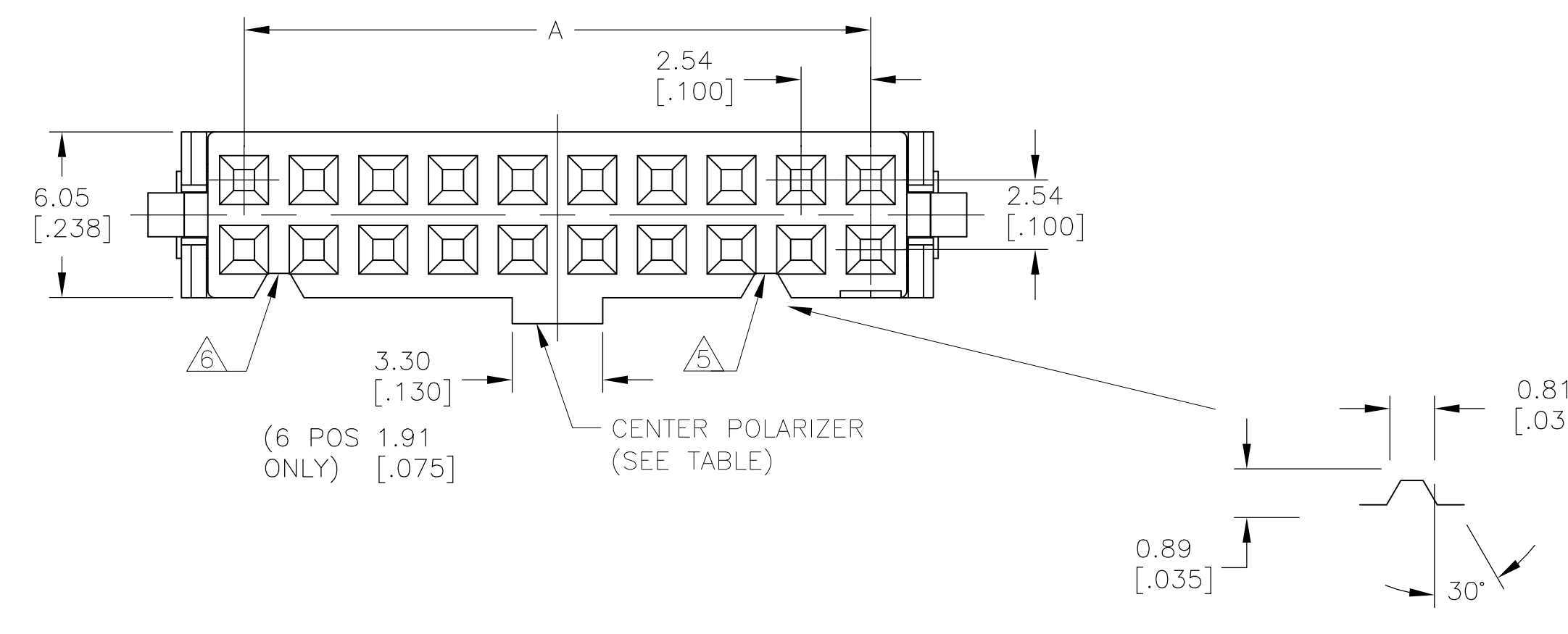

OBsolete	YES	YES	3	85.65[3.372]	85.75[3.376]	80.01[3.150]	78.74[3.100]	64	609-6441	1-1437022-5
OBsolete	NO	YES	3	-	85.75[3.376]	80.01[3.150]	78.74[3.100]	64	609-6430	1-1437022-2
SUPERSEDED BY 2-1658526-4	YES	YES	3	67.87[2.672]	67.97[2.676]	62.23[2.450]	60.96[2.400]	50	609-5041	8-1437021-3
SUPERSEDED BY 2-1658526-3	NO	YES	3	-	67.97[2.676]	62.23[2.450]	60.96[2.400]	50	609-5030	7-1437021-4
SUPERSEDED BY 2-1658526-2	YES	NO	3	67.87[2.672]	67.97[2.676]	62.23[2.450]	60.96[2.400]	50	609-5001M	7-1437021-1
SUPERSEDED BY 4-1658526-3	NO	NO	3	-	67.97[2.676]	62.23[2.450]	60.96[2.400]	50	609-5000M	6-1437021-8
SUPERSEDED BY 2-1658526-1	YES	YES	3	55.17[2.172]	55.27[2.176]	49.53[1.950]	48.26[1.900]	40	609-4041	5-1437021-7
SUPERSEDED BY 2-1658526-0	NO	YES	3	-	55.27[2.176]	49.53[1.950]	48.26[1.900]	40	609-4030	5-1437021-0
OBsolete	YES	NO	3	55.17[2.172]	55.27[2.176]	49.53[1.950]	48.26[1.900]	40	609-4001M	4-1437021-7
SUPERSEDED BY 4-1658526-1	NO	NO	3	-	55.27[2.176]	49.53[1.950]	48.26[1.900]	40	609-4000M	4-1437021-4
SUPERSEDED BY 4-1658526-0	YES	YES	3	50.09[1.972]	50.19[1.976]	44.45[1.750]	43.18[1.700]	36	609-3641	4-1437021-2
SUPERSEDED BY 3-1658526-8	NO	YES	3	-	50.19[1.976]	44.45[1.750]	43.18[1.700]	36	609-3630	4-1437021-0
	YES	YES	3	47.55[1.872]	47.65[1.876]	41.91[1.650]	40.64[1.600]	34	609-3441	3-1437021-4
	NO	YES	3	-	47.65[1.876]	41.91[1.650]	40.64[1.600]	34	609-3430	2-1437021-6
SUPERSEDED BY 1658623-8	YES	NO	3	47.55[1.872]	47.65[1.876]	41.91[1.650]	40.64[1.600]	34	609-3401M	2-1437021-2
OBsolete	NO	NO	3	-	47.65[1.876]	41.91[1.650]	40.64[1.600]	34	609-3400M	1-1437021-9
	YES	YES	3	37.39[1.472]	37.49[1.476]	31.75[1.250]	30.48[1.200]	26	609-2641	1-1437021-4
	NO	YES	3	-	37.49[1.476]	31.75[1.250]	30.48[1.200]	26	609-2630	1437021-5
SUPERSEDED BY 3-1658526-5	YES	NO	3	37.39[1.472]	37.49[1.476]	31.75[1.250]	30.48[1.200]	26	609-2601M	1437021-2
SUPERSEDED BY 3-1658526-5	NO	NO	3	-	37.49[1.476]	31.75[1.250]	30.48[1.200]	26	609-2600M	9-1437020-8
OBsolete	YES	YES	3	34.85[1.372]	34.95[1.376]	29.21[1.150]	27.94[1.100]	24	609-2441	9-1437020-6
SUPERSEDED BY 1-1658526-4	NO	YES	3	-	34.95[1.376]	29.21[1.150]	27.94[1.100]	24	609-2430	9-1437020-3
OBsolete	NO	NO	3	-	34.95[1.376]	29.21[1.150]	27.94[1.100]	24	609-2400M	9-1437020-1
	YES	YES	3	29.77[1.172]	29.87[1.176]	24.13[.950]	22.86[.900]	20	609-2041	8-1437020-8
	NO	YES	3	-	29.87[1.176]	24.13[.950]	22.86[.900]	20	609-2030	7-1437020-9
SUPERSEDED BY 3-1658526-0	YES	NO	3	29.77[1.172]	29.87[1.176]	24.13[.950]	22.86[.900]	20	609-2001M	7-1437020-6
SUPERSEDED BY 3-1658526-0	NO	NO	3	-	29.87[1.176]	24.13[.950]	22.86[.900]	20	609-2000M	7-1437020-2
SUPERSEDED BY 6-1437020-8	NO	NO	4	-	29.87[1.176]	24.13[.950]	22.86[.900]	20	609-2000MP005	7-1437020-3
	YES	YES	3	24.69[.972]	24.79[.976]	19.05[.750]	17.78[.700]	16	609-1641	6-1437020-8
	NO	YES	3	-	24.79[.976]	19.05[.750]	17.78[.700]	16	609-1630	6-1437020-1
SUPERSEDED BY 1-1658526-0	YES	NO	3	24.69[.972]	24.79[.976]	19.05[.750]	17.78[.700]	16	609-1601M	5-1437020-9
OBsolete	NO	NO	3	-	24.79[.976]	19.05[.750]	17.78[.700]	16	609-1600M	5-1437020-6
SUPERSEDED BY 1658526-9	YES	YES	3	22.15[.872]	22.25[.876]	16.51[.650]	15.24[.600]	14	609-1441	5-1437020-2
	NO	YES	3	-	22.25[.876]	16.51[.650]	15.24[.600]	14	609-1430	4-1437020-6
OBsolete	YES	NO	3	22.15[.872]	22.25[.876]	16.51[.650]	15.24[.600]	14	609-1401M	4-1437020-4
OBsolete	NO	NO	3	-	22.25[.876]	16.51[.650]	15.24[.600]	14	609-1400M	4-1437020-2
	YES	YES	3	17.07[.672]	17.07[.672]	11.43[.450]	10.16[.400]	10	609-1041	3-1437020-9
	NO	YES	3	-	17.17[.676]	11.43[.450]	10.16[.400]	10	609-1030	3-1437020-0
OBsolete	YES	NO	3	17.07[.672]	17.07[.672]	11.43[.450]	10.16[.400]	10	609-1001M	2-1437020-7
SUPERSEDED BY 1658526-3	NO	NO	3	-	17.17[.676]	11.43[.450]	10.16[.400]	10	609-1000M	2-1437020-4
SUPERSEDED BY 1658526-2	YES	YES	3	11.99[.472]	12.09[.476]	6.35[.250]	5.08[.200]	6	609-0641	2-1437020-2
OBsolete	NO	YES	3	-	12.09[.476]	6.35[.250]	5.08[.200]	6	609-0630	2-1437020-0
OBsolete	YES	NO	3	11.99[.472]	12.09[.476]	6.35[.250]	5.08[.200]	6	609-0601M	1-1437020-9
SUPERSEDED BY 2-1658526-5	NO	NO	3	-	12.09[.476]	6.35[.250]	5.08[.200]	6	609-0600M	1-1437020-8

ELECTRICAL PROPERTIES	
CURRENT RATING	1 AMP
INSULATION RESISTANCE	>1 x 10 ⁹ OHMS @ 500 VDC
DWV	>500 VRMS AT SEA LEVEL
ENVIRONMENTAL PROPERTIES	
TEMPERATURE RATING	-55°C TO 125°C

THIS DRAWING IS A CONTROLLED DOCUMENT.

DIMENSIONS: INCHES. TOLERANCES UNLESS OTHERWISE SPECIFIED:

0 PLC	±	-
1 PLC	±	-
2 PLC	±	-
3 PLC	±	0.1X(.005)
4 PLC	±	-
ANGLES	±	-

MATERIAL: SEE TABLE. FINISH: SEE TABLE.

APPROVED: J. GERACE, C. ROHDE, M. WALMSLEY. DATE: 19AUG04.

TE Connectivity
CONNECTOR ASSEMBLY, FEMALE SOCKET TRANSITION

SIZE: A1. CASE CODE: 9-1437021-4. DRAWING NO: 00779. WEIGHT: -. RESTRICTED TO: -. CUSTOMER DRAWING. SCALE: 1:1. SHEET: 1 OF 1. REV: D.

X-ON Electronics

Largest Supplier of Electrical and Electronic Components

Click to view similar products for [Headers & Wire Housings](#) category:

Click to view products by [TE Connectivity](#) manufacturer:

Other Similar products are found below :

[95000-104TRLF](#) [10135584-644402LF](#) [DF62W-EP2022PCA](#) [95000-106TRLF](#) [DF62W-2022SCA](#) [DF62W-EP2022PC](#) [2203348](#) [DF62W-2022SC](#) [1084018](#) [1029039](#) [1084017](#) [802-10-012-10-002000](#) [1112640](#) [1112639](#) [000-34000](#) [0009482033](#) [0009507031](#) [57102-S06-03LF](#) [57202-S52-04LF](#) [PCN6-15S-2.5E](#) [0039019024](#) [58102-G61-06LF](#) [582553-1](#) [0009508121](#) [0050291907](#) [018731A](#) [LY20-4P-DT1-P1E-BR](#) [02.125.8002.8](#) [60101931](#) [60598-1 \(Cut Strip\)](#) [M1625-3R/100](#) [61062-3](#) [61082-181009](#) [636-1427](#) [638009-1](#) [641938-9](#) [641991-4](#) [644168-1](#) [647662-1](#) [65039-019ELF](#) [65817-002LF](#) [65817-015LF](#) [65863-015LF](#) [66207-023LF](#) [67016-026LF](#) [67046-001LF](#) [67095-007LF](#) [68002-116](#) [68016-236H](#) [68648-049](#)