

4

3

2

1

THIS DRAWING IS UNPUBLISHED. RELEASED FOR PUBLICATION AUG 2008
 © COPYRIGHT 2009 BY TYCO ELECTRONICS CORPORATION. ALL RIGHTS RESERVED.

LOC	DIST	REVISIONS			
P	LTR	DESCRIPTION	DATE	DRN	APPD
C6		REVISED (ECR-15-013726)	1MAR2016	A.X	H.W

OBSOLETE

7-1734038-1
6-1734038-1
5-1734038-1
4-1734038-2
3-1734038-3
3-1734038-2
3-1734038-1
2-1734038-1
1-1734038-2
1-1734038-1
1734038-3
1734038-2
1734038-1
PART NUMBER

THIS DRAWING IS A CONTROLLED DOCUMENT.		DRN F. YANG 31.JUL.2009	 TE Connectivity	
		CHK S. CHIEN 31.JUL.2009		
DIMENSIONS: MM		APRD W. KODAMA 31.JUL.2009	NAME	
TOLERANCES UNLESS OTHERWISE SPECIFIED:		PRODUCT SPEC		USB CONNECTOR, RECEPTACLE, R/A, A TYPE
0 PLC ± - 1 PLC ± 0.3 2 PLC ± 0.2 3 PLC ± 0.15 4 PLC ± ± 3' FINISH		APPLICATION SPEC		
MATERIAL	SEE NOTE	WEIGHT 1.82 GRAMS	SIZE A300779	DRAWING NO C=1734038
CUSTOMER DRAWING		SCALE		SHEET 1 OF 4 REV C6

LOC	DIST	REVISIONS			
P	LYR	DESCRIPTION	DATE	DM	APVD
		SEE SHEET 1.			

TE LOGO & DATE CODE

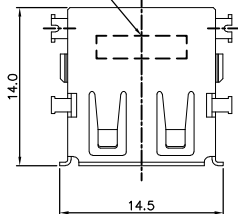

NOTES:

- MATERIAL:
HOUSING: (SEE TABLE) WITH 30% GF, UL 94V-0. BLACK COLOR.
CONTACT: PHOSPHOR BRONZE.
SHELL: BRASS.
- FINISH:
CONTACT: 0.762µm [30µ"] MIN. GOLD PLATING ON CONTACT AREA.
3.048µm [120µ"] MIN. MATTE TIN PLATING ON SOLDER TAIL.
WITH ENTIRE CONTACT UNDERPLATED 1.270µm [50µ"] MIN. NICKEL.
SHELL: 0.762µm [30µ"] MIN. NICKEL PLATING OVER 0.762µm [30µ"] MIN. Cu UNDERPLATED.
- REFLOW SOLDER CAPABLE TO 260°C PER TE SPEC 109-201, CONDITION B.

NO BOARD LOCK FUNCTION APPLIED.

LOW HALOGEN SPECIFICATION:
CHLORINE(Cl): 900ppm MAX.
BROMINE(Br): 900ppm MAX.

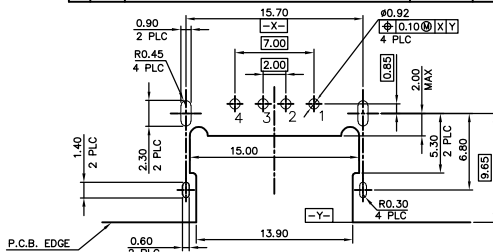
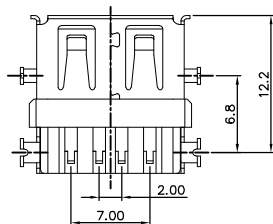
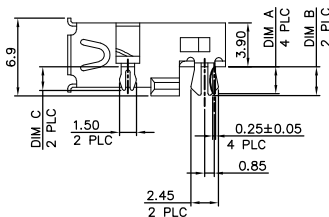
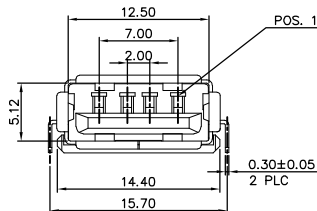

RECOMMEND P.C.B LAYOUT (THICKNESS 1.2~1.4mm)
(COMPONENT SIDE) TOLERANCE±0.05

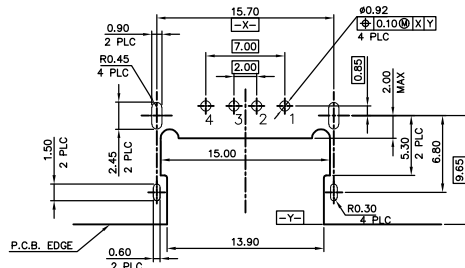

RECOMMEND P.C.B LAYOUT (THICKNESS=1.0~1.4mm) ▲
(COMPONENT SIDE) TOLERANCE±0.05

OBSOLETE	TAPE & REEL	2.40	2.55	2.10	HTN	B-1734038-4
		1.80	1.80	1.80	PAGT	B-1734038-2
	PACKAGING	2.40	2.55	2.10		B-1734038-1
	DIM A	DIM B	DIM C	FINISH	MATERIAL	PART NUMBER

THIS DRAWING IS A CONTROLLED DOCUMENT.

DIMENSIONS:		TOLERANCES UNLESS OTHERWISE SPECIFIED:	
MM		0 PLC	± .3
		1 PLC	± 0.3
		2 PLC	± 0.2
		3 PLC	± 0.15
		4 PLC	± .1
		ANGLES	± .3°
MATERIAL	SEE NOTE	FINISH	SEE NOTE

DM	CRK	APVD	NAME
PRODUCT SPEC	APPLICATION SPEC	WEIGHT	RESTRICTED 30
CUSTOMER DRAWING		1.56 GRAMS	
SIZE		CAGE CODE	DRAWING NO
A3		00779	C=1734038
SCALE	SHEET	REV	
	2 of 4	C6	

TE TE Connectivity
USB CONNECTOR, RECEPTACLE,
R/A, A TYPE

THIS DRAWING IS UNPUBLISHED. RELEASED FOR PUBLICATION AUG 2008
 © COPYRIGHT 2009 BY TYCO ELECTRONICS CORPORATION. ALL RIGHTS RESERVED.

LOC	DIST	REVISIONS			
#	LTR	DESCRIPTION	DATE	DNM	APVD
		SEE SHEET 1.			

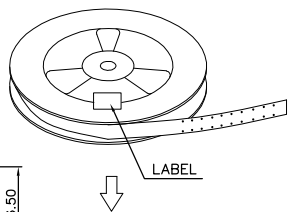
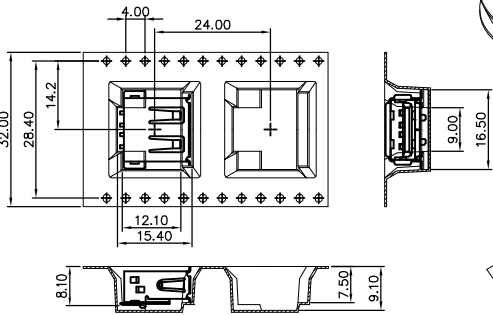
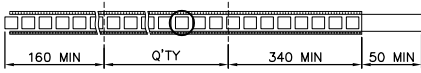

- NOTES:
 1. MATERIAL:
 REEL: PS.
 CARRIER: PS.
 COVER TAPE: PBT.
 2. DIMENSION
 REEL: #330mmX37.1mm
 SHIPPING CARTON: L=350mm,W=350mm,H=250mm
 3. QUANTITY:
 PRIMARY PACKING: 300PCS/REEL
 SECONDARY PACKING: 9REELS/CARTON(2,700PCS).
 4. WEIGHT:
 NET WEIGHT: 0.46KG/REEL, 4.15 KG/CARTON.
 GROSS WEIGHT: 0.97 KG/REEL, 9.7 KG/CARTON.
 5. PEELING RESISTANCE: 20G TO 130G.
 6. PEELING SPEED: 300MM/MIN.

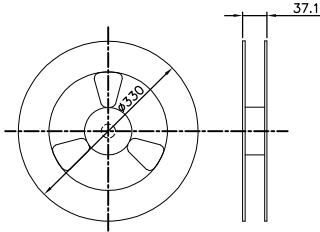
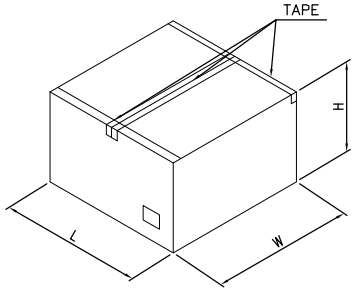
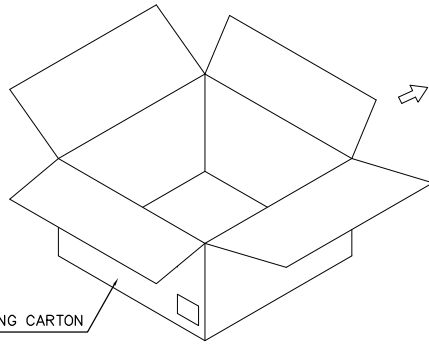

OBSOLETE 6-1734038-1
 PART NUMBER

THIS DRAWING IS A CONTROLLED DOCUMENT.		DIN		TE Connectivity	
DIMENSIONS: MM		DW			
TOLERANCES UNLESS OTHERWISE SPECIFIED: 0 PLC ± .05 1 PLC ± .03 2 PLC ± .02 3 PLC ± .01 4 PLC ± .01 5 PLC ± .01 6 PLC ± .01 ANGLES ± .01		PRODUCT SPEC APPLICATION SPEC WEIGHT		NAME USB CONNECTOR, RECEPTACLE, R/A, A TYPE	
MATERIAL		FINISH		SIZE CAGE CODE DRAWING NO A300779 C=1734038	
				RESTRICTED TO CUSTOMER DRAWING SCALE SHEET 3 of 4 REV C6	

THIS DRAWING IS UNPUBLISHED. RELEASED FOR PUBLICATION AUG 2008

© COPYRIGHT 2009 BY TYCO ELECTRONICS CORPORATION. ALL RIGHTS RESERVED.

LOC	DIST	REVISIONS					
DW		#	LWR	DESCRIPTION	DATE	DN	APVD
				SEE SHEET 1.			

PULL OUT DIRECTION

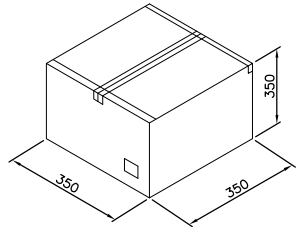
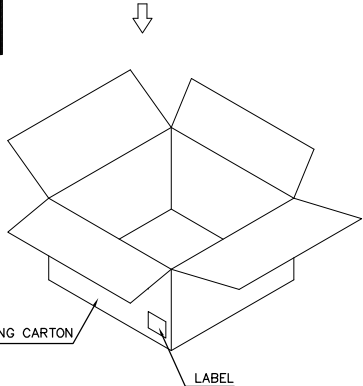
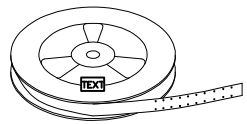
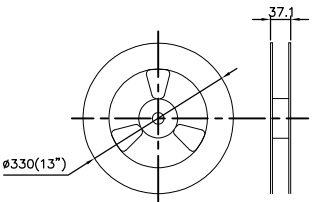
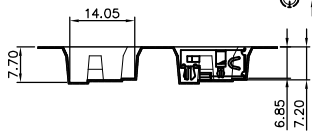
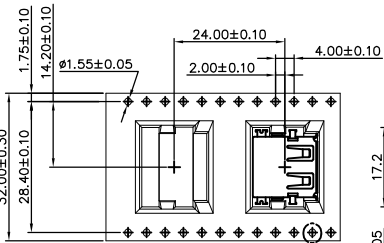

- NOTES:
1. MATERIAL:
REEL: PS.
CARRIER: PS.
COVER TAPE: PBT.
 2. DIMENSION
REEL: 0.330mmX37.1mm
 3. PEELING RESISTANCE: 20G TO 130G.
 4. PEELING SPEED: 300MM/MIN.

TAPE & REEL	8.92 Kg	4.91 Kg	350	9	3150 PCS	8-1734038-4
PACKAGING	GROSS WEIGHT	NET WEIGHT	PCS/REEL	REELS/CARTON	QUANTITY	PART NUMBER
						8-1734038-4

OBSOLETE

THIS DRAWING IS A CONTROLLED DOCUMENT.

DIMENSIONS:		TOLERANCES UNLESS OTHERWISE SPECIFIED:	
MM			
	0 PLC	±	-
	1 PLC	±	-
	2 PLC	±	-
	3 PLC	±	-
	4 SDC	±	-
	ANGLES	±	-
MATERIAL	FINISH		

DWG	CHK	APVD	NAME	TE Connectivity	
PRODUCT SPEC	USB CONNECTOR, RECEPTACLE, R/A, A TYPE				
APPLICATION SPEC	SIZE	CAGE CODE	DRAWING NO	RESTRICTED TO	
WEIGHT	A3	300779	C=1734038		
CUSTOMER DRAWING	SCALE	SHEET	4 of 4	REV	C6

X-ON Electronics

Largest Supplier of Electrical and Electronic Components

Click to view similar products for te connectivity manufacturer:

Other Similar products are found below :

[570416-000](#) [CLTEQ-M81CE-SSRELAY-4-20V](#) [4-1633138-8](#) [D38999/24FJ4AN](#) [4-1195131-0](#) [650069-000](#) [SMD100-2](#) [2EDL4CM](#)
[DTS20W19-11PD-3028](#) [DTS20W19-11PD-3028-LC](#) [DTS20W19-32SD-3028-LC](#) [DTS20W19-32SD-3028](#) [NC6-P104-06](#) [TXR64AB90-](#)
[3616AI](#) [DTS26F21-41HE](#) [DTS26F21-41AE](#) [DTS26F21-41PE-LC](#) [DTS26F21-11SE-3028-LC](#) [D38999/24WF32JE](#) [D38999/24WF32SE-LC](#)
[DTS24W19-32HE](#) [D38999/20JB35HA](#) [D38999/24WJ20PA](#) [164-8033-08](#) [D38999/24FF32JE](#) [D38999/24FF32SE-LC](#) [D38999/24WF32JB](#)
[D38999/24WG11HA](#) [D38999/24WG11HN](#) [MS27467T21F11H](#) [DJT16E21-11HA](#) [DTS24F19-32HE](#) [DTS20W19-32SA-3028-LC](#) [DTS24F19-](#)
[11SC-3028-LC](#) [DTS24F19-11SC-3028](#) [DJT14E13-98HB](#) [D38999/20WC8BB](#) [1-330599-5](#) [DTS24F21-41HN-LC](#) [DTS24F21-41HN](#)
[DTS24F21-41AN](#) [DTS24F21-39HN](#) [DTS24F21-41PN-LC](#) [AFD50-10-6SN-1A-LC](#) [DJT10F17-26HC](#) [DTS24W19-32HB](#) [ACT20JE99HA](#)
[DJT10E17-26HC](#) [DJT10E17-26HN](#) [DJT10F17-26HA](#)