

THIS DRAWING IS UNPUBLISHED. RELEASED FOR PUBLICATION  
 (C) COPYRIGHT ALL RIGHTS RESERVED.

LOC		DIST		REVISIONS			
P	LTR	DESCRIPTION		DATE	DWN	APVD	
E3		REVISED ECR-18-012951		29SEP18	T.Q	W..H	

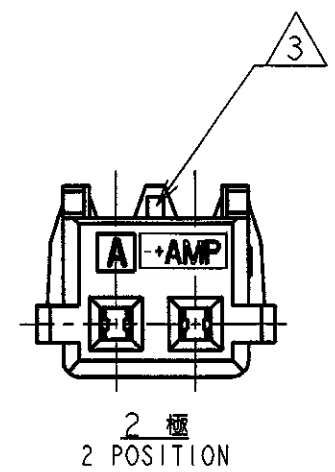
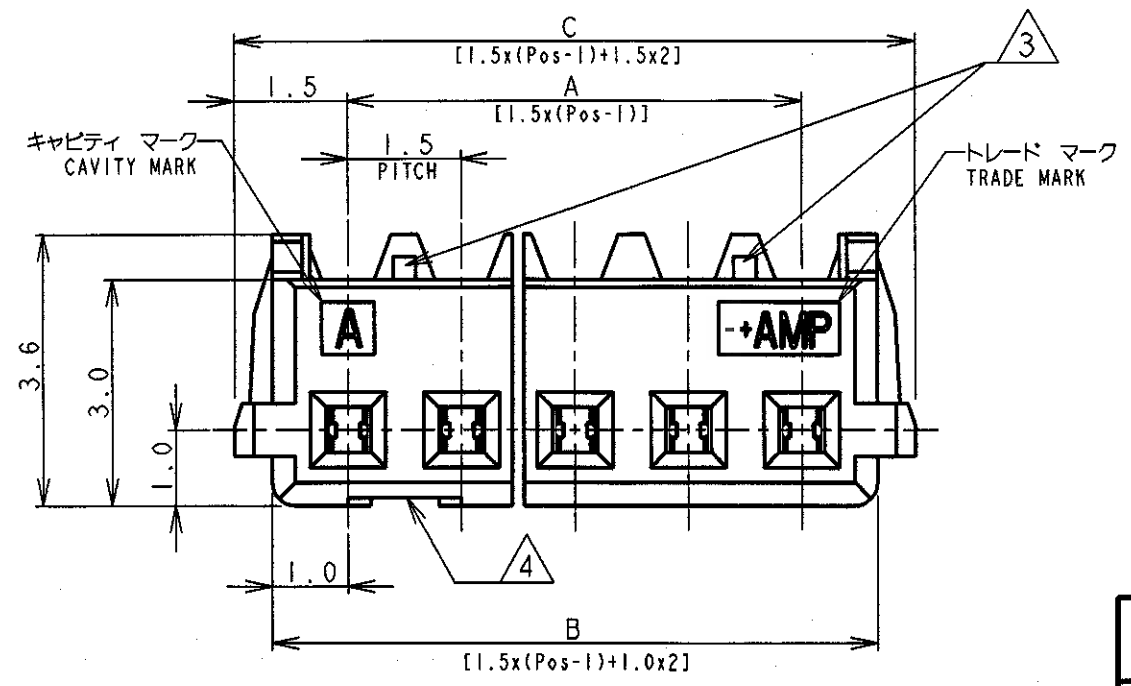
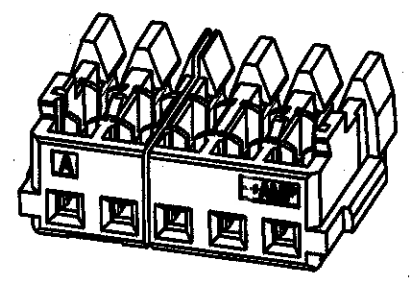
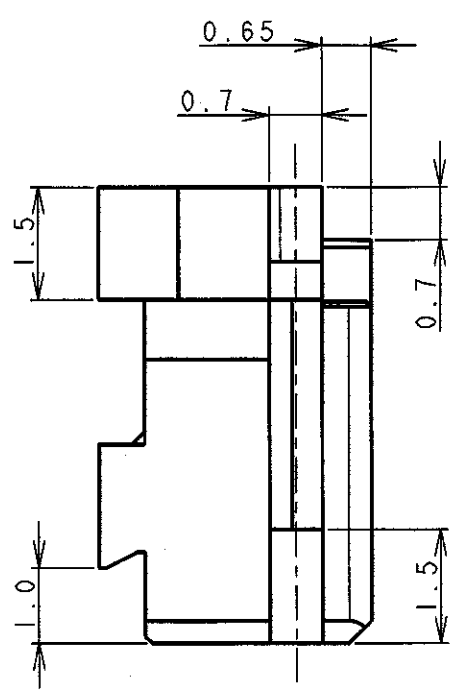
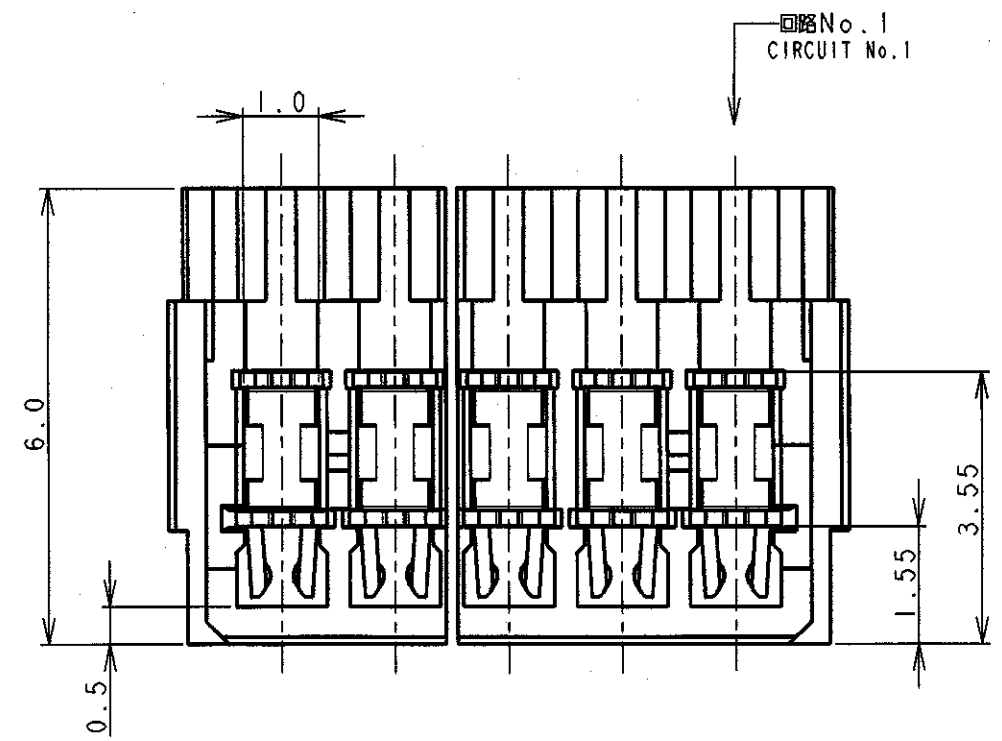

注記

- 1. 適用電線範囲: AWG #26&#28  
被覆外径:  $\phi 0.8\text{mm} \sim \phi 0.95\text{mm}$
- 2. 材料: ハウジング-ガラス入りナイロン UL94V-0、色: グレー、青  
コンタクト-錫めっき済み、りん青銅
- 3. ハウジング ロック:  
2極は、1箇所 3~20極は、2箇所
- 4. ゲート口は左付きと右付きが存在する。(2極品を除く)

NOTES:

- 1. APPLICABLE WIRE SIZE: AWG #26&#28  
INSULATION DIA RANGE:  $\phi 0.8\text{mm} \sim \phi 0.95\text{mm}$
- 2. MATERIAL:  
HOUSING: NYLON(G.F.) UL94V-0, COLOR: GRAY, BLUE  
CONTACT: PRE-TIN PHOS-BRONZE
- 3. HOUSING LOCK:  
2 POSITION - SINGLE LOCK  
3 TO 20 POSITIONS - DOUBLE LOCK
- 4. CONNECTOR HAVE THE GATE LEFT SIDE AND RIGHT SIDE. (EXCEPT 2Pos.)

DIMENSIONS: 単位: 毫 mm	TOLERANCES UNLESS OTHERWISE SPECIFIED 一般公差 10 $\mu$ : $\pm 0.2$ 30 $\mu$ >10 : $\pm 0.25$ 100 $\mu$ >30 : $\pm 0.3$ ANGLE : $\pm 3^\circ$	DWN	12. JUL '96	WIRE RANGE	0.08mm <sup>2</sup> - 0.14mm <sup>2</sup>	INSULATION DIA	$\phi 0.8\text{mm} \sim \phi 0.95\text{mm}$
		CHK	12. JUL '96	APVD	S. Kobayashi 9/15 99	TE Connectivity	
MATERIAL 材料 SEE NOTE 2 注記2参照	FINISH 仕上 SEE NOTE 2 注記2参照	APVD	J. TANIGAWA	NAME	AMP Mini Common Terminated (CT) Connector 1.5mm PITCH		
		PRODUCT SPEC	108-5525	製品規格	MT RECEPTACLE ASSEMBLY		
		APPLICATION SPEC	114-5223	取付適用規格	SIZE	CAGE CODE	DRAWING NO
		WEIGHT	SEE TABLE 表参照	取付適用規格	A3	00779	③-353293
CUSTOMER DRAWING				SCALE	NON	SHEET	1 OF 2
				REV	E3		

THIS DRAWING IS UNPUBLISHED. ALL RIGHTS RESERVED.

LOC	DIST	REVISIONS			
P	LTR	DESCRIPTION	DATE	DWN	APVD
		SEE SHEET 1			

0.97	31.5	30.5	28.5	20	7-353293-0	4-353293-0	2-353293-0
0.92	30.0	29.0	27.0	19	6-353293-9	3-353293-9	1-353293-9
0.87	28.5	27.5	25.5	18	6-353293-8	3-353293-8	1-353293-8
0.83	27.0	26.0	24.0	17	6-353293-7	3-353293-7	1-353293-7
0.78	25.5	24.5	22.5	16	6-353293-6	3-353293-6	1-353293-6
0.73	24.0	23.0	21.0	15	6-353293-5	3-353293-5	1-353293-5
0.68	22.5	21.5	19.5	14	6-353293-4	3-353293-4	1-353293-4
0.64	21.0	20.0	18.0	13	6-353293-3	3-353293-3	1-353293-3
0.59	19.5	18.5	16.5	12	6-353293-2	3-353293-2	1-353293-2
0.54	18.0	17.0	15.0	11	6-353293-1	3-353293-1	1-353293-1
0.49	16.5	15.5	13.5	10	6-353293-0	2-353293-0	1-353293-0
0.45	15.0	14.0	12.0	9	5-353293-9	2-353293-9	353293-9
0.40	13.5	12.5	10.5	8	5-353293-8	2-353293-8	353293-8
0.35	12.0	11.0	9.0	7	5-353293-7	2-353293-7	353293-7
0.30	10.5	9.5	7.5	6	5-353293-6	2-353293-6	353293-6
0.26	9.0	8.0	6.0	5	5-353293-5	2-353293-5	353293-5
0.21	7.5	6.5	4.5	4	5-353293-4	2-353293-4	353293-4
0.16	6.0	5.0	3.0	3	5-353293-3	2-353293-3	353293-3
0.11	4.5	3.5	1.5	2	5-353293-2	2-353293-2	353293-2
WEIGHT (g)	C	B	A	Pos.	BLUE	BLACK	GRAY
	寸法 DIMENSIONS				製品型番 P/N		

DIMENSIONS: 単位: ㎜  
 TOLERANCES UNLESS OTHERWISE SPECIFIED:  
 一般公差  
 10 > : ±0.2  
 30 > : ±0.25  
 100 > : ±0.3  
 ANGLE : ±3°

DWN T. FURUYA 12. JUL '96  
 CHK J. TANIGAWA 12. JUL '96  
 APVD  
 PRODUCT SPEC 製品規格  
 108-5525  
 APPLICATION SPEC 取付適用規格  
 114-5223  
 WEIGHT SEE TABLE 表参照  
 CUSTOMER DRAWING

WIRE RANGE 絶縁電線断面積  
 0.08mm<sup>2</sup> - 0.14mm<sup>2</sup>  
 INSULATION DIA 被覆外径  
 ∅0.8mm - ∅0.95mm  
 MATERIAL SEE SHEET 1 OF 2 材料 1枚目参照  
 FINISH SEE SHEET 1 OF 2 仕上 1枚目参照  
**TE** TE Connectivity  
 NAME 名称  
 AMP Mini Common Terminated (CT) Connector 1.5mm PITCH  
 MT RECEPTACLE ASSEMBLY  
 SIZE CAGE CODE DRAWING NO  
 A4 00779 C-353293  
 SCALE 尺度 NON SHEET 2 OF 2 REV E3

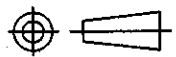

## X-ON Electronics

Largest Supplier of Electrical and Electronic Components

*Click to view similar products for [Headers & Wire Housings](#) category:*

*Click to view products by [TE Connectivity](#) manufacturer:*

Other Similar products are found below :

[95000-104TRLF](#) [10135584-644402LF](#) [DF62W-EP2022PCA](#) [95000-106TRLF](#) [DF62W-2022SCA](#) [DF62W-EP2022PC](#) [2203348](#) [DF62W-2022SC](#) [1084018](#) [1029039](#) [1084017](#) [802-10-012-10-002000](#) [1112640](#) [1112639](#) [000-34000](#) [0009482033](#) [0009507031](#) [57102-S06-03LF](#) [57202-S52-04LF](#) [PCN6-15S-2.5E](#) [0039019024](#) [58102-G61-06LF](#) [582553-1](#) [0009508121](#) [0050291907](#) [018731A](#) [LY20-4P-DT1-P1E-BR](#) [02.125.8002.8](#) [60101931](#) [60598-1 \(Cut Strip\)](#) [M1625-3R/100](#) [61062-3](#) [61082-181009](#) [636-1427](#) [638009-1](#) [641938-9](#) [641991-4](#) [644168-1](#) [647662-1](#) [65039-019ELF](#) [65817-002LF](#) [65817-015LF](#) [65863-015LF](#) [66207-023LF](#) [67016-026LF](#) [67046-001LF](#) [67095-007LF](#) [68002-116](#) [68016-236H](#) [68648-049](#)