

THIS DRAWING IS UNPUBLISHED.

RELEASED FOR PUBLICATION

, 19

© COPYRIGHT 19

BY AMP INCORPORATED. ALL INTERNATIONAL RIGHTS RESERVED.

LOC
AFDIST
50

P

F

ZONE

LTR

REVISIONS

DESCRIPTION

DATE

APPD

A RELEASE PER FASR, AF-8187

10/26/92

PF/DS

1 CONTINUOUS STRIP ON REEL.

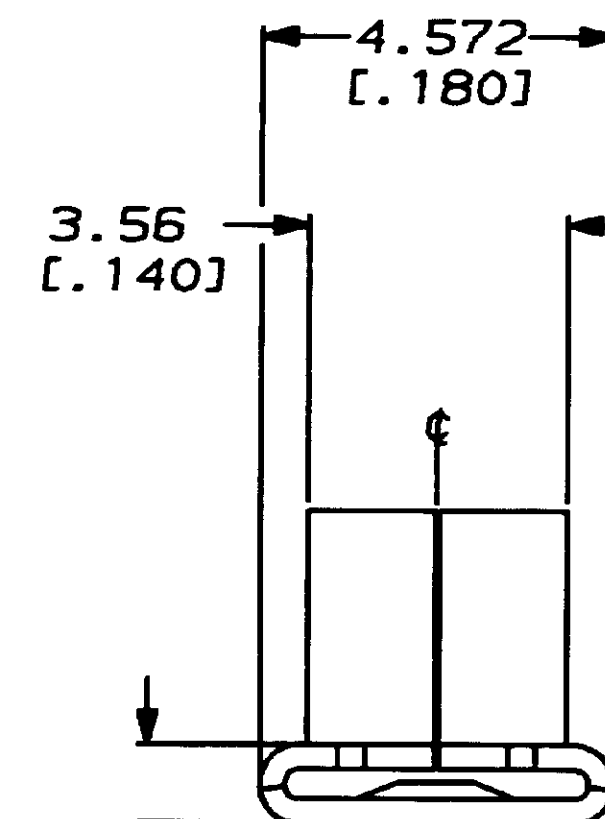
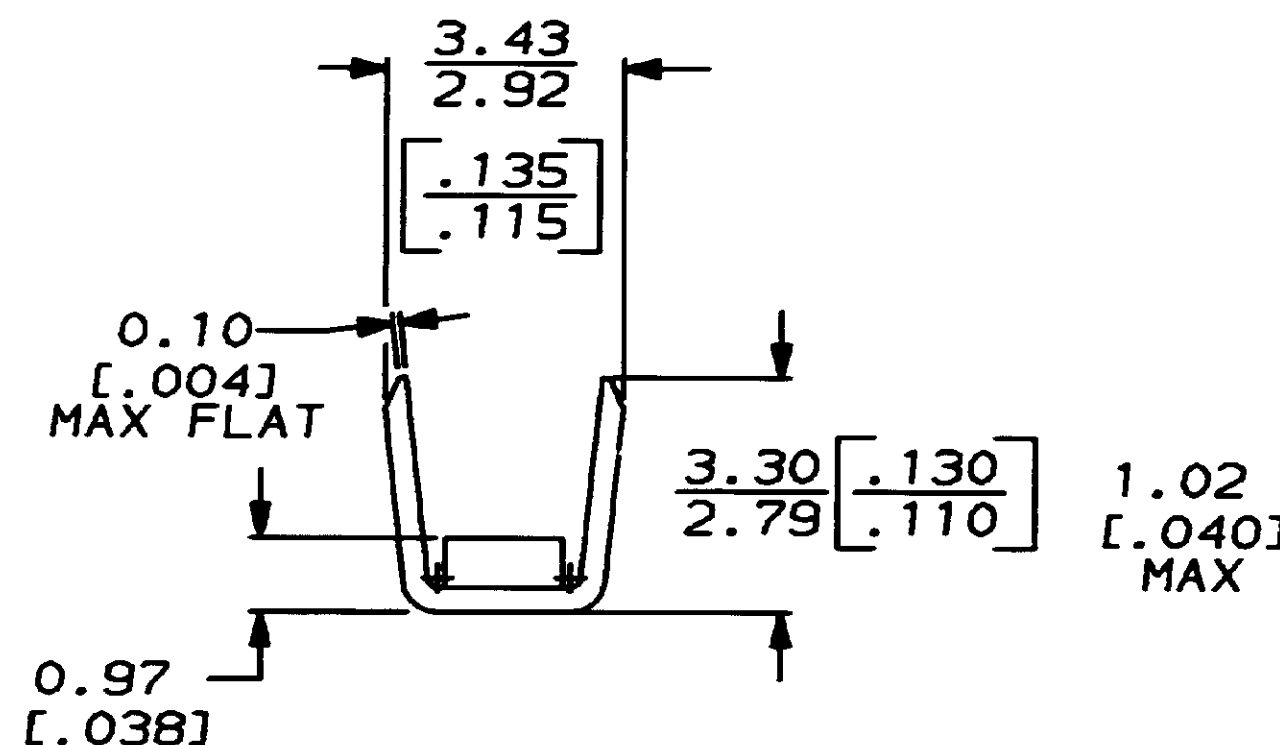
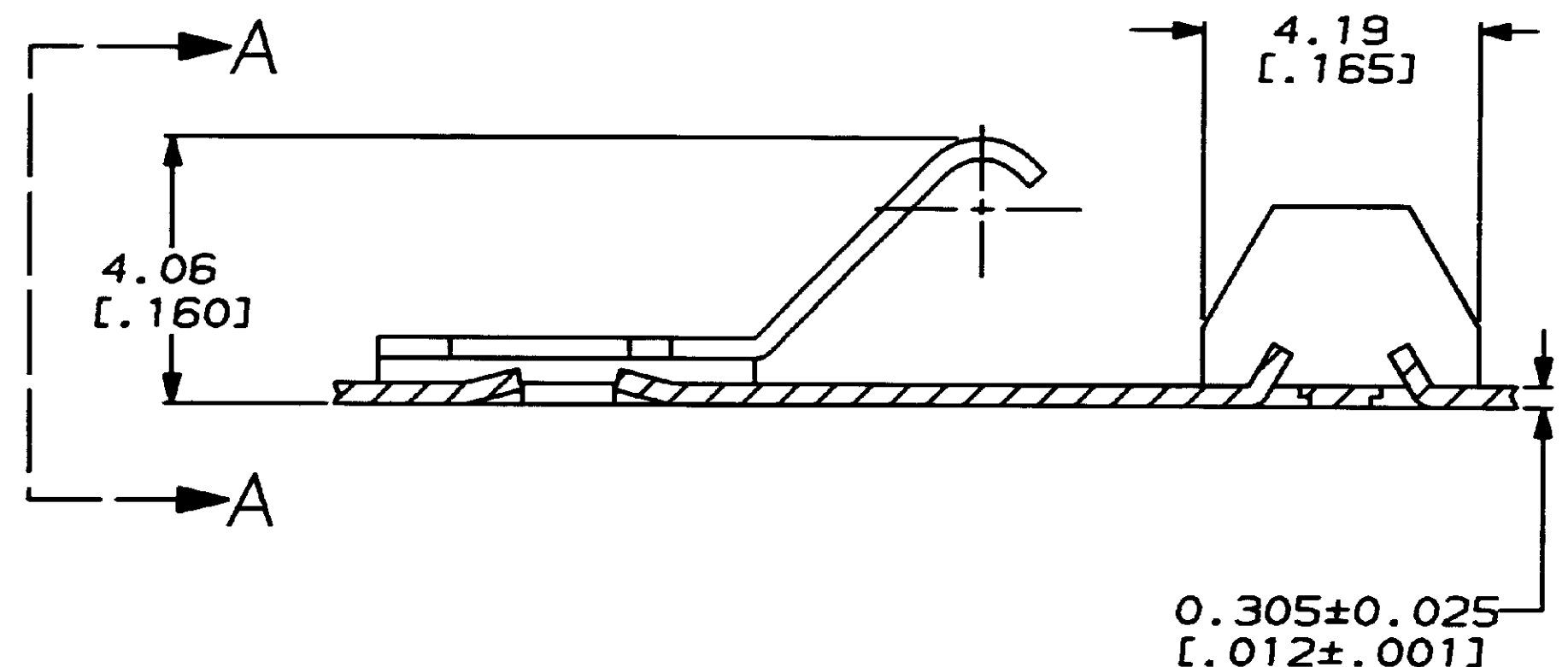
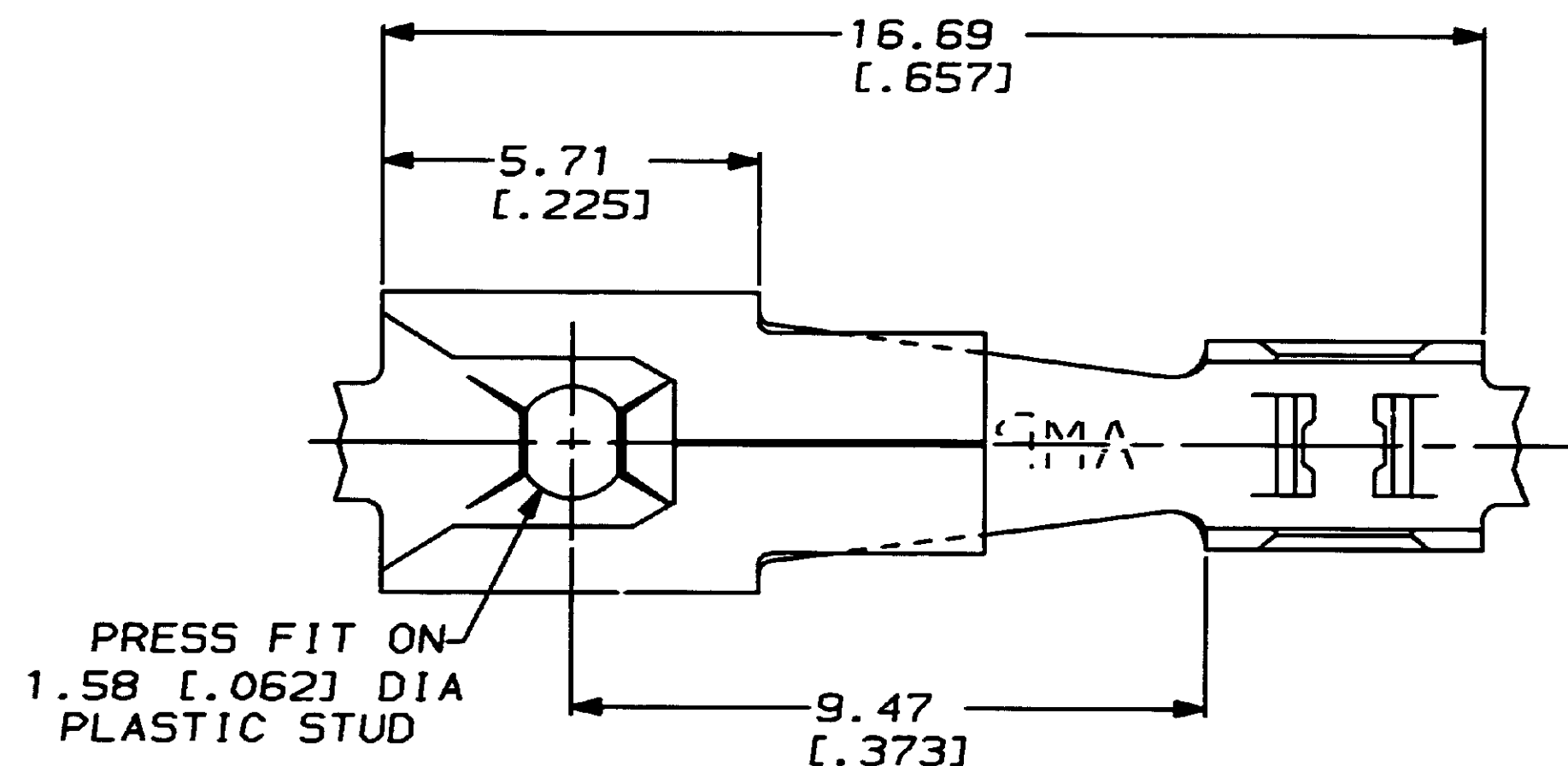

VIEW A-A

2.16
[.085] THK0.3mm² FLAT WIRE
[22] AWG

63671-1

INSULATION RANGE

WIRE RANGE

PART NO

DO NOT SCALE PRINT.
UNLESS SPECIFIED
DIMENSIONS IN INCHES
TOLERANCES ON:
2 PLC DEC ± 0.25 [.010]
3 PLC DEC ± -
ANGLES ± -

MATERIAL

H04 PHOS BRONZE

FINISH

DR 8/17/92
P FORTNEY
CHK 8/17/92
JR RUTH

APPD 8/17/92
D SCHENK

APPD 8/17/92
R MEAVILL

PRODUCT SPEC

APPLICATION SPEC

WEIGHT -

AMP AMP Incorporated
Harrisburg, PA 17105-3608

NAME

SPECIAL TERMINAL

SIZE

CAGE CODE

DRAWING NO

B

00779

C-63671

SCALE

8:1

SHEET

1 OF 1

THIS DRAWING IS A CONTROLLED DOCUMENT FOR
AMP INCORPORATED. IT IS SUBJECT TO CHANGE
AND THE CONTROLLING ENGINEERING ORGANIZATION
SHOULD BE CONTACTED FOR THE LATEST REVISION.

X-ON Electronics

Largest Supplier of Electrical and Electronic Components

Click to view similar products for [Headers & Wire Housings](#) *category:*

Click to view products by [TE Connectivity](#) *manufacturer:*

Other Similar products are found below :

[95000-104TRLF](#) [10135584-644402LF](#) [DF62W-EP2022PCA](#) [95000-106TRLF](#) [DF62W-2022SCA](#) [DF62W-EP2022PC](#) [2203348](#) [DF62W-2022SC](#) [1084018](#) [1029039](#) [1084017](#) [802-10-012-10-002000](#) [1112640](#) [1112639](#) [891-007-9SS-BST1T](#) [000-34000](#) [0008550134](#) [0009482033](#) [0009507031](#) [57102-F02-18ULF](#) [57102-S06-03LF](#) [57202-S52-04LF](#) [PCN6-15S-2.5E](#) [0039019024](#) [58102-G61-06LF](#) [582553-1](#) [0009485154](#) [0009508121](#) [009176003701906](#) [0022285053](#) [0050291907](#) [018731A](#) [LY20-4P-DT1-P1E-BR](#) [02.125.8002.8](#) [60101931](#) [60598-1 \(Cut Strip\)](#) [M1625-3R/100](#) [61062-3](#) [61082-181009](#) [CSU011177004](#) [636-1427](#) [638009-1](#) [641938-9](#) [641991-4](#) [644168-1](#) [644827-2](#) [647662-1](#) [65039-019ELF](#) [65692-001LF](#) [65781-018](#)