

THIS DRAWING IS UNPUBLISHED. RELEASED FOR PUBLICATION
 © COPYRIGHT 19 BY TYCO ELECTRONICS CORPORATION. ALL RIGHTS RESERVED.

| LOC | DIST | REVISIONS | | | | | |
|-----|------|-----------|-----|--------------------------|-----------|-----|------|
| | | P | LTR | DESCRIPTION | DATE | DWN | APVD |
| FX | 00 | | A | RELEASED PER NPR 2001054 | 19APR2001 | DWF | DWF |

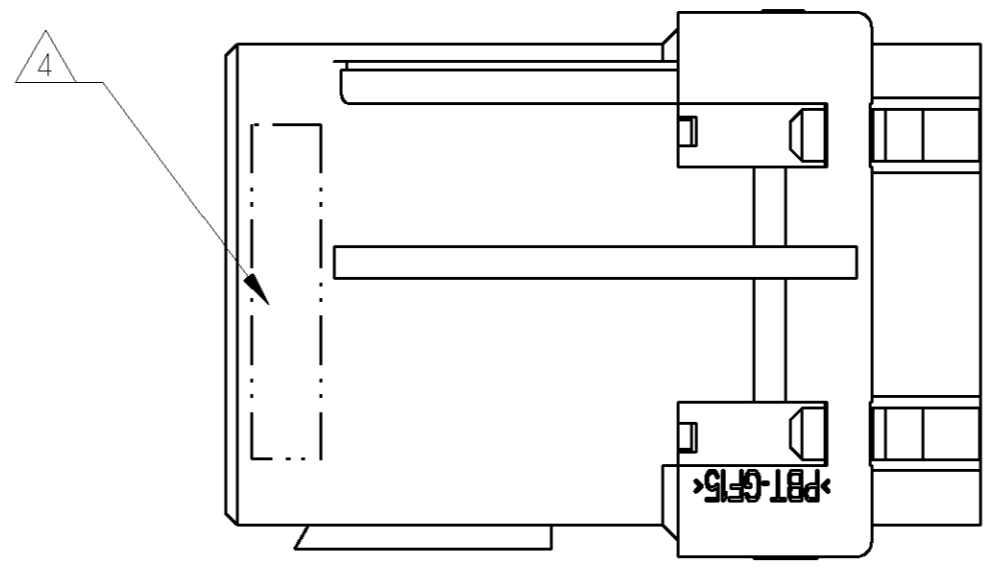
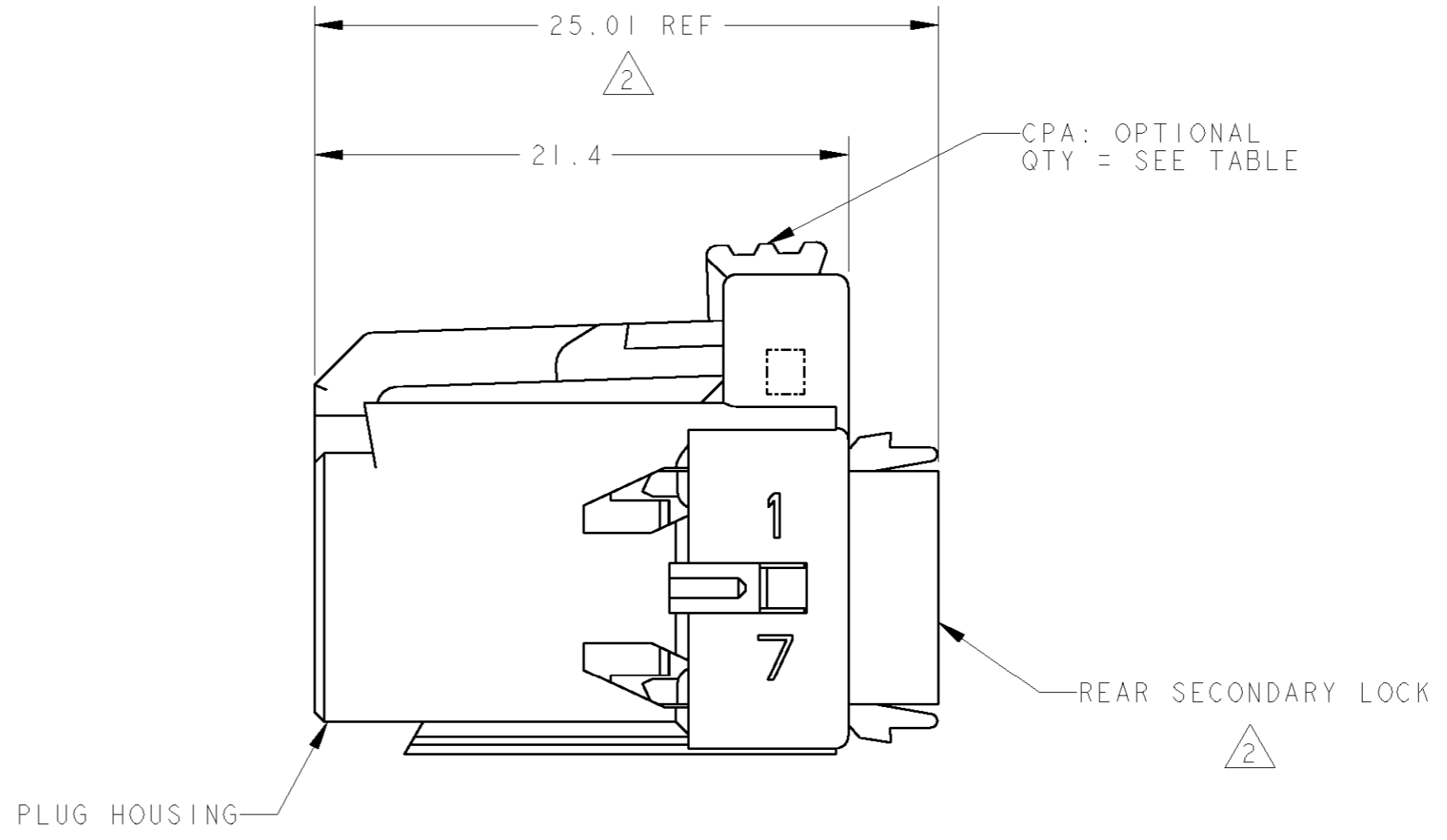
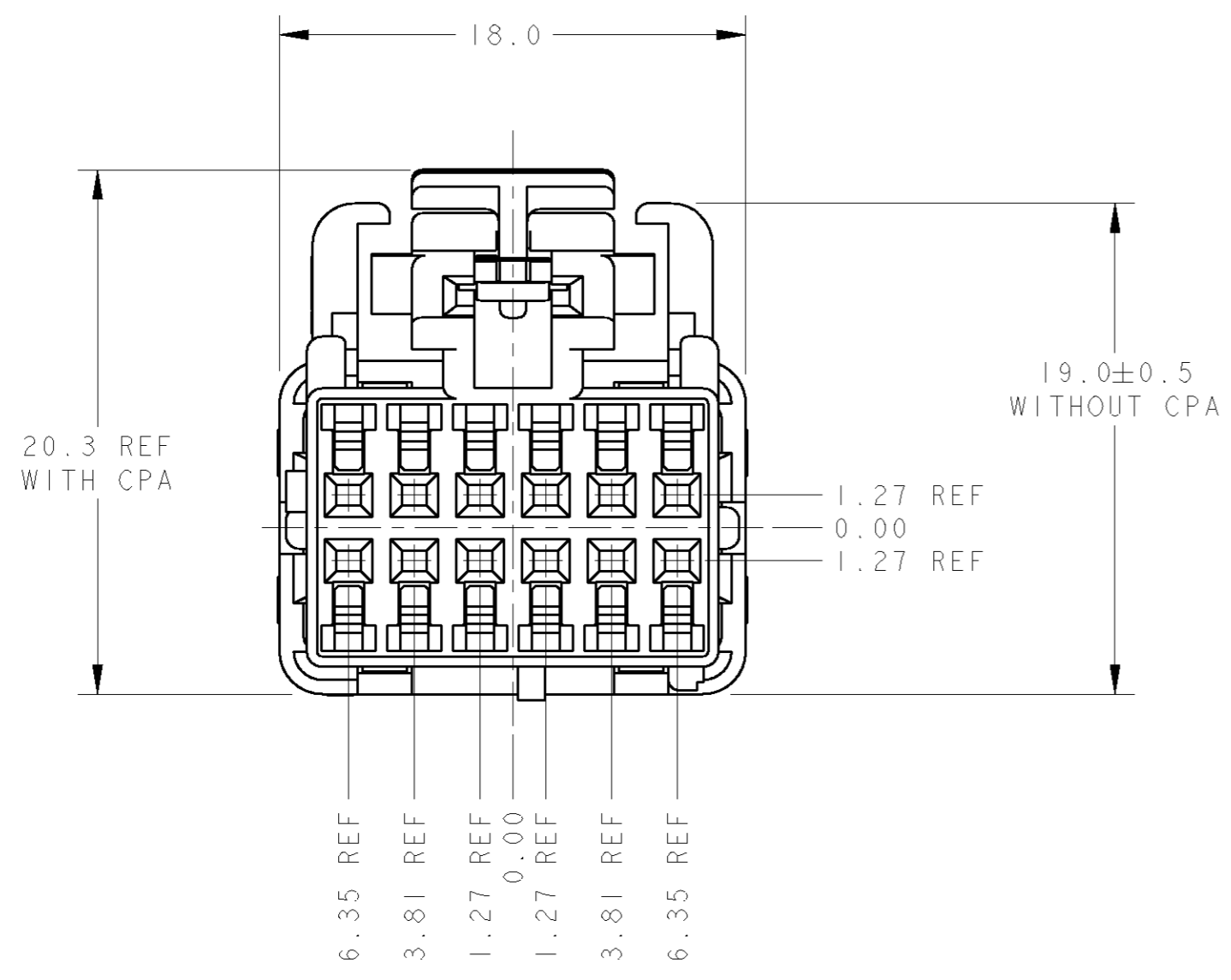

1. 638394-5 SHOWN.
- △ 2 REAR SECONDARY LOCK, SHOWN IN PRE-LATCHED POSITION.
- △ 3 PLUG HOUSING: PBT, 15% GLASS FILLED, 25% MAX REGRIND, COLOR: SEE TABLE. REAR SECONDARY LOCK: PBT, UNFILLED, GRAY, 25% MAX REGRIND. CPA: PBT, 15% GLASS FILLED, RED, 25% MAX REGRIND.
- △ 4 MARK FOUR DIGIT JULIAN DATE CODE (DDDY), LOCATED IN APPROXIMATE AREA SHOWN.
5. TERMINALS SOLD SEPARATELY, SEE AMP RECOMMENDED P/N 1326028 (GOLD) OR 638551 (TIN) FOR TERMINATION AND REELING OPTIONS.
6. THIS PRODUCT HAS A MISMATING FORCE OF 100 NEWTONS.
- △ 7 WEIGHT OF ASSEMBLY WITH CPA IS: 3.6 GRAMS
 WEIGHT OF ASSEMBLY WITHOUT CPA IS: 3.5 GRAMS

| | | | |
|--------|---------|----------------------------------|-------------|
| GREEN | 1 | "D" | 638394-8 |
| BLUE | 1 | "C" | 638394-7 |
| YELLOW | 1 | "B" | 638394-6 |
| BLACK | 1 | "A" | 638394-5 |
| GREEN | N/A | "D" | 638394-4 |
| BLUE | N/A | "C" | 638394-3 |
| YELLOW | N/A | "B" | 638394-2 |
| BLACK | N/A | "A" | 638394-1 |
| COLOR | CPA QTY | KEYING ARRANGEMENT (SEE SHEET 2) | PART NUMBER |

| | | | | |
|--|--|---------------------------------|---|-----------------------|
| THIS DRAWING IS A CONTROLLED DOCUMENT FOR TYCO ELECTRONICS CORPORATION IT IS SUBJECT TO CHANGE AND THE CONTROLLING ENGINEERING ORGANIZATION SHOULD BE CONTACTED FOR THE LATEST REVISION. | | DWN D. FRY 26AUG99 | AMP Incorporated Harrisburg, PA 17105-3608 | |
| DIMENSIONS: mm | | CHK A. EBRAHEEM 19APR2001 | NAME PLUG ASSEMBLY, UNSEALED, 12 POSITION 2X6, 0.64mm CONNECTOR | |
| TOLERANCES UNLESS OTHERWISE SPECIFIED: 0 PLC ± 1 PLC ±0.4 2 PLC ±0.30 3 PLC ± 4 PLC ± ANGLES ± FINISH - | | APVD G. BALON 19APR2001 | APPLICATION SPEC SAE/USCAR-2 8/97 | |
| MATERIAL △ 3 | | PRODUCT SPEC - | SIZE A2 | RESTRICTED TO - |
| | | WEIGHT △ 7 | CAGE CODE 00779 | DRAWING NO. 638394 |
| CUSTOMER DRAWING | | SCALE 4:1 | | SHEET 1 OF 2 |

THIS DRAWING IS UNPUBLISHED. RELEASED FOR PUBLICATION
 © COPYRIGHT 19 BY TYCO ELECTRONICS CORPORATION. ALL RIGHTS RESERVED.

| LOC | DIST | REVISIONS | | | | | |
|-----|------|-----------|-----|-------------|------|-----|------|
| | | P | LTR | DESCRIPTION | DATE | DWN | APVD |
| FX | 00 | - | | SEE SHEET 1 | - | - | - |
| | | | | | | | |
| | | | | | | | |

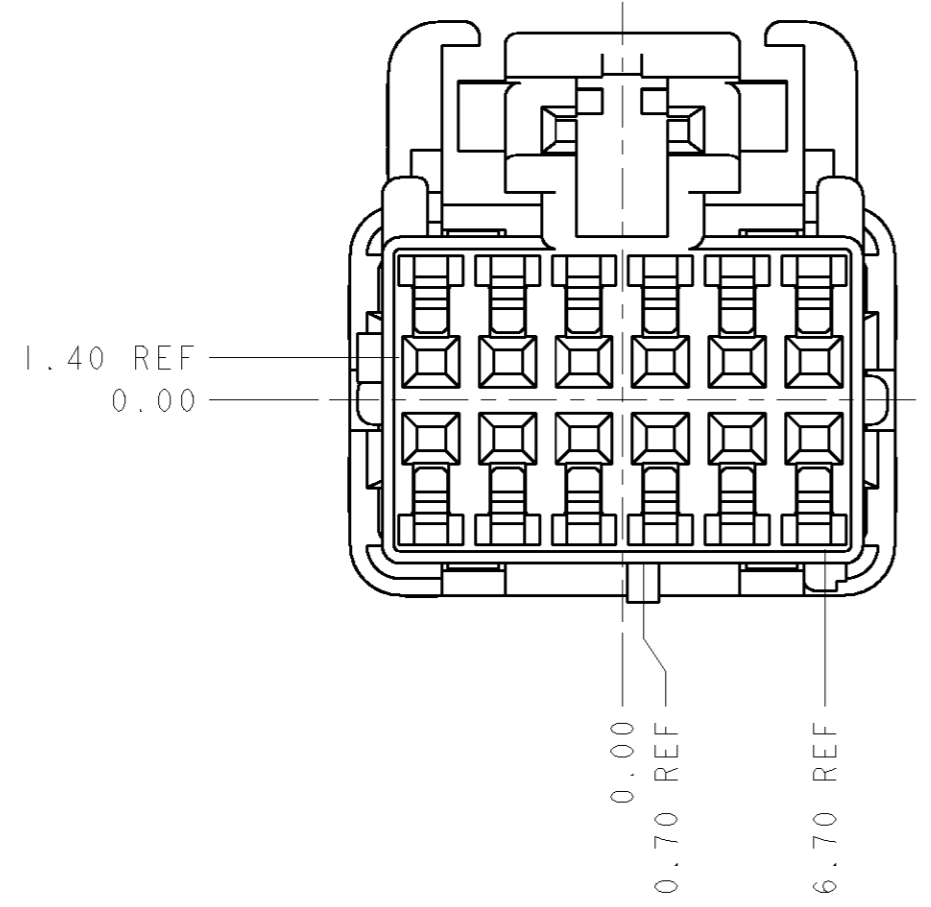

KEY CODE "A"
 (APPLIES TO -1 AND -5 ONLY)
 SCALE 4:1

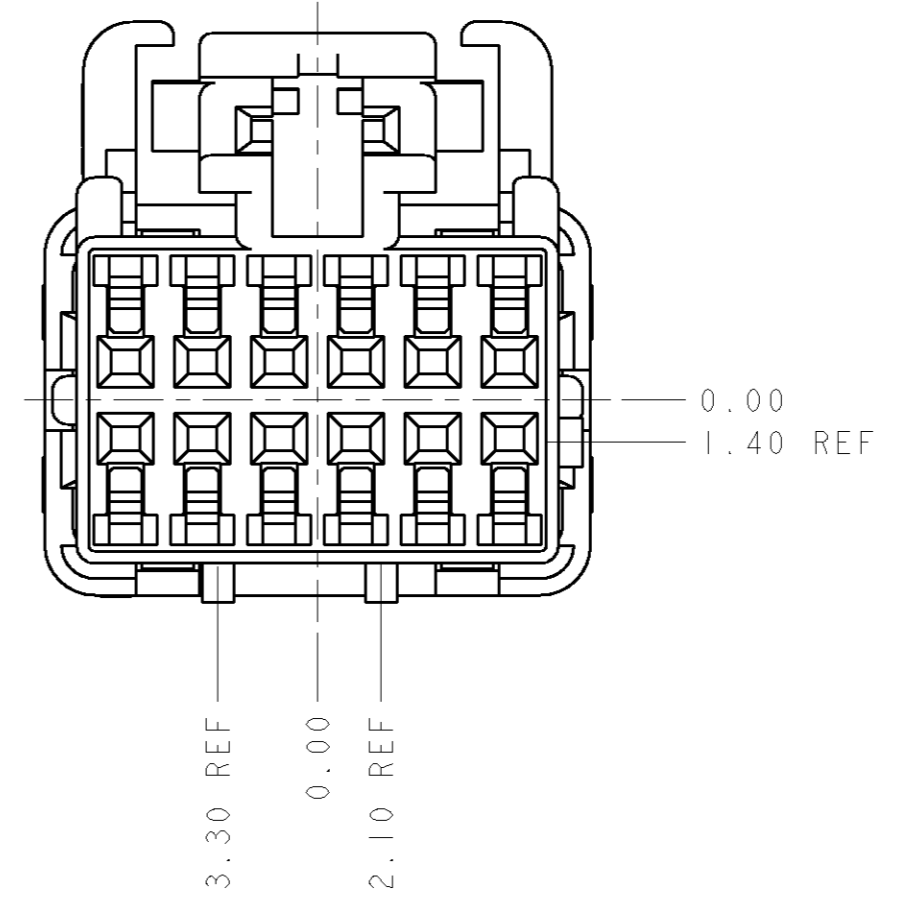

KEY CODE "B"
 (APPLIES TO -2 AND -6 ONLY)
 SCALE 4:1

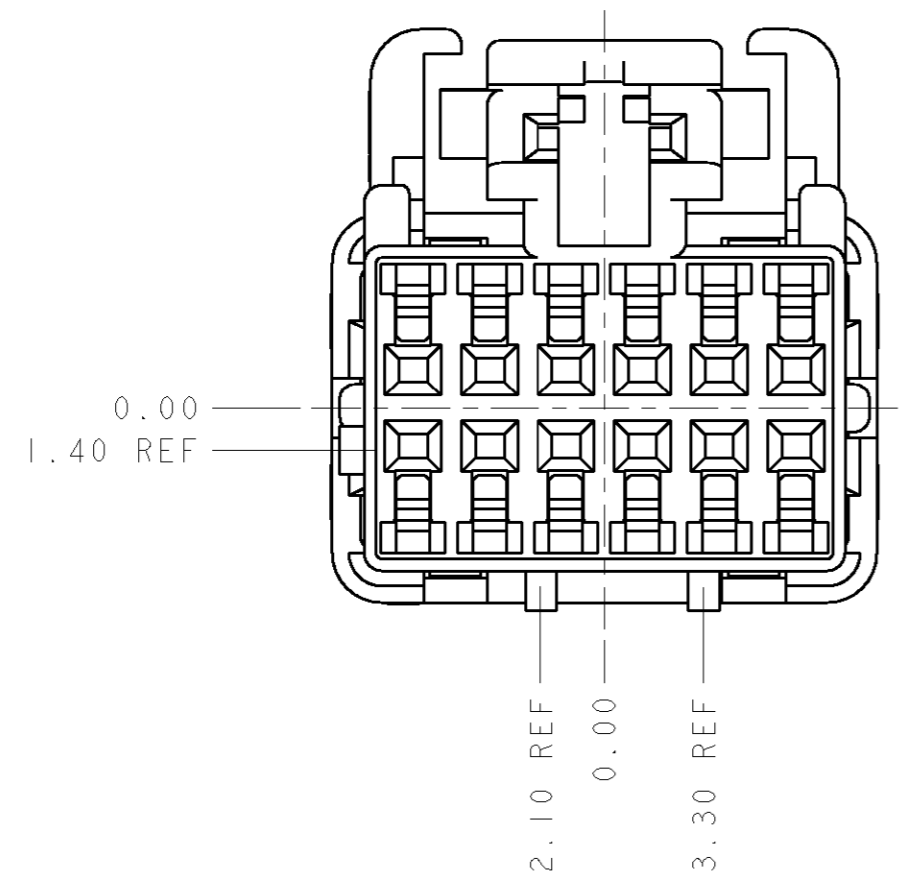

KEY CODE "C"
 (APPLIES TO -3 AND -7 ONLY)
 SCALE 4:1

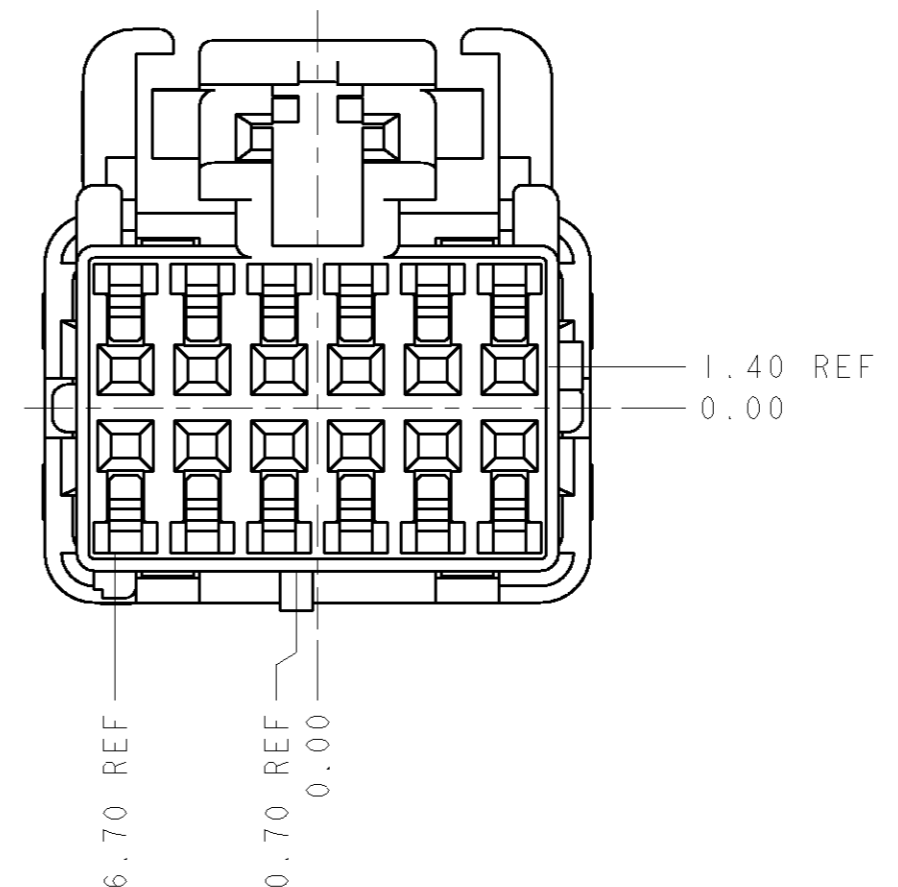

KEY CODE "D"
 (APPLIES TO -4 AND -8 ONLY)
 SCALE 4:1

| | | | |
|---|--|--|--|
| <small>THIS DRAWING IS A CONTROLLED DOCUMENT FOR TYCO ELECTRONICS CORPORATION IT IS SUBJECT TO CHANGE AND THE CONTROLLING ENGINEERING ORGANIZATION SHOULD BE CONTACTED FOR THE LATEST REVISION.</small> | | DWN D. FRY 26AUG99 CHK A. EBRAHEEM 19APR2001 APVD G. BALON 19APR2001 | AMP AMP Incorporated Harrisburg, PA 17105-3608 |
| DIMENSIONS: mm | TOLERANCES UNLESS OTHERWISE SPECIFIED: 0 PLC ± 1 PLC ±0.4 2 PLC ±0.30 3 PLC ± 4 PLC ± ANGLES ± FINISH - | NAME PLUG ASSEMBLY, UNSEALED, 12 POSITION 2X6, 0.64mm CONNECTOR | RESTRICTED TO - |
| MATERIAL - | | PRODUCT SPEC - APPLICATION SPEC - WEIGHT - | SIZE A2 CAGE CODE 00779 DRAWING NO. 638394 SCALE 4:1 SHEET 2 OF 2 REV A |
| | | CUSTOMER DRAWING | |

X-ON Electronics

Largest Supplier of Electrical and Electronic Components

Click to view similar products for [Automotive Connectors](#) category:

Click to view products by [TE Connectivity](#) manufacturer:

Other Similar products are found below :

[003-018-000](#) [60403001](#) [60993906-B](#) [M902-2131](#) [M902-2161](#) [72.330.1035.1](#) [73.353.4028.0](#) [F119300-B](#) [F166900](#) [F258300-B](#) [F358300-B](#)
[F407400](#) [F444110](#) [F487000](#) [F509500B-B](#) [827153-1](#) [8N1515-32-24P](#) [9-1326729-8](#) [925474-1](#) [928905-1](#) [964562-4](#) [968782-1](#) [GT17SA-8DS-](#)
[HU](#) [98891-1012](#) [98947-1016](#) [12004147](#) [12004475-L](#) [12010290](#) [12010309-B](#) [12015454](#) [12020219-B](#) [12020308](#) [12041318-B](#) [12052225-L](#)
[12052466](#) [12059125](#) [12064869](#) [12004327-B](#) [12010503-B](#) [12015308](#) [12015384](#) [12015909](#) [1-21030-1](#) [12041254](#) [12041318](#) [12047946-B](#)
[12047957](#) [12047957-L](#) [12059473](#) [12066261](#)