

THIS DRAWING IS UNPUBLISHED. RELEASED FOR PUBLICATION
 © COPYRIGHT - By - TE CONNECTIVITY ALL RIGHTS RESERVED.

| LOC | | DIST | | REVISIONS | | | |
|-----|-----|---------------------------|-----------|-----------|------|--|--|
| P | LTR | DESCRIPTION | DATE | DWN | APVD | | |
| W | | REVISED PER ECR-20-000826 | 29MAY2020 | PC | SW | | |

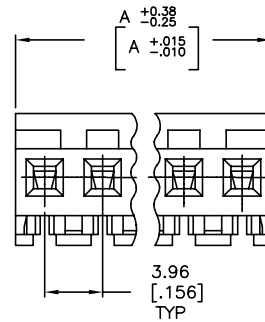
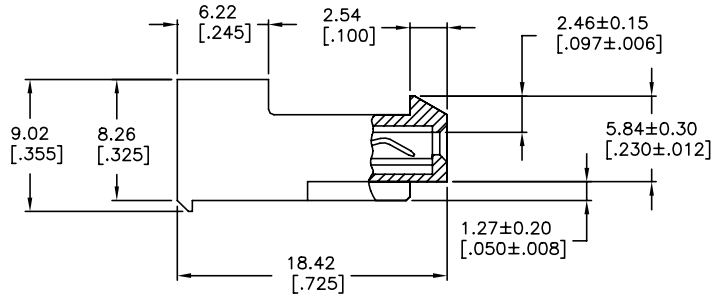
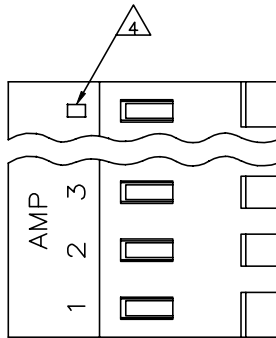

| | | |
|--------------|----|------------|
| 95.10[3.744] | 24 | 5-640430-4 |
| 91.13[3.588] | 23 | 5-640430-3 |
| 87.17[3.432] | 22 | 5-640430-2 |
| 83.21[3.276] | 21 | 5-640430-1 |
| 79.25[3.120] | 20 | 5-640430-0 |
| 75.29[2.964] | 19 | 4-640430-9 |
| 71.32[2.808] | 18 | 4-640430-8 |
| 67.36[2.652] | 17 | 4-640430-7 |
| 63.40[2.496] | 16 | 4-640430-6 |
| 59.44[2.340] | 15 | 4-640430-5 |
| 55.47[2.184] | 14 | 4-640430-4 |
| 51.51[2.028] | 13 | 4-640430-3 |
| 47.55[1.872] | 12 | 4-640430-2 |
| 43.59[1.716] | 11 | 4-640430-1 |
| 39.62[1.560] | 10 | 4-640430-0 |
| 35.66[1.404] | 9 | 3-640430-9 |
| 31.70[1.248] | 8 | 3-640430-8 |
| 27.74[1.092] | 7 | 3-640430-7 |
| 23.77[.936] | 6 | 3-640430-6 |
| 19.81[.780] | 5 | 3-640430-5 |
| 15.85[.624] | 4 | 3-640430-4 |
| 11.89[.468] | 3 | 3-640430-3 |
| 7.92[.312] | 2 | 3-640430-2 |

1 MATERIAL: CONNECTOR - NYLON UL94-V2 (BLUE).
 CONTACTS - 0.30[.012] THICK COPPER ALLOY
 (BRIGHT TIN-LEAD 0.00203[.000080] MIN. THICK
 FOR CONTACTS 640430-2 THRU 2-640430-4).
 (MATTE WHISKER MITIGATED TIN 0.00203[.000080]
 MIN. THICKNESS OVER NICKEL UNDERPLATE FOR
 3-640430-2 THRU 5-640430-4).

2 CONTACTS ACCEPT 26 AWG WIRE WITH 2.41[.095] MAX
 INSULATION DIAMETER.

3 CONTACTS MUST ACCEPT 1.14±0.03[.045]
 POST AND REMAIN LOCKED IN POSITION.

4 IDENTIFICATION NUMBER FOR LAST CIRCUIT MAY
 NOT APPEAR ON ALL ASSEMBLIES.

5 DIMENSIONS IN BRACKETS ARE IN INCHES.

6 HOUSING FEATURES ARE: CLOSED END WITH LOCKING
 RAMP.

7 OBSOLETE PARTS: OBSOLETE CIS STREAMLINING PER D.RENAUD/D.SINISI

8 OBSOLETE PARTS

| | | | |
|--------------|--------------|----|------------|
| △ SUPERCEDED | 95.10[3.744] | 24 | 2-640430-4 |
| △ SUPERCEDED | 91.13[3.588] | 23 | 2-640430-3 |
| △ SUPERCEDED | 87.17[3.432] | 22 | 2-640430-2 |
| △ SUPERCEDED | 83.21[3.276] | 21 | 2-640430-1 |
| △ SUPERCEDED | 79.25[3.120] | 20 | 1-640430-0 |
| △ SUPERCEDED | 75.29[2.964] | 19 | 1-640430-9 |
| △ SUPERCEDED | 71.32[2.808] | 18 | 1-640430-8 |
| △ SUPERCEDED | 67.36[2.652] | 17 | 1-640430-7 |
| △ SUPERCEDED | 63.40[2.496] | 16 | 1-640430-6 |
| △ SUPERCEDED | 59.44[2.340] | 15 | 1-640430-5 |
| △ SUPERCEDED | 55.47[2.184] | 14 | 1-640430-4 |
| △ SUPERCEDED | 51.51[2.028] | 13 | 1-640430-3 |
| △ SUPERCEDED | 47.55[1.872] | 12 | 1-640430-2 |
| △ SUPERCEDED | 43.59[1.716] | 11 | 1-640430-1 |
| △ SUPERCEDED | 39.62[1.560] | 10 | 1-640430-0 |
| △ SUPERCEDED | 35.66[1.404] | 9 | 640430-9 |
| △ SUPERCEDED | 31.70[1.248] | 8 | 640430-8 |
| △ SUPERCEDED | 27.74[1.092] | 7 | 640430-7 |
| | 23.77[.936] | 6 | 640430-6 |
| | 19.81[.780] | 5 | 640430-5 |
| △ SUPERCEDED | 15.85[.624] | 4 | 640430-4 |
| | 11.89[.468] | 3 | 640430-3 |
| | 7.92[.312] | 2 | 640430-2 |

| | | | | |
|--|--|---|------|--|
| THIS DRAWING IS A CONTROLLED DOCUMENT. | | DWN S. CARPENTER 08JUL2003 | | |
| DIMENSIONS: mm [INCHES] | | CHK D. BOSSI 08JUL2003 | | |
| TOLERANCES UNLESS OTHERWISE SPECIFIED: | | APVD D. BOSSI 08JUL2003 | NAME | |
| 0 PLC ± - | | PRODUCT SPEC | | |
| 1 PLC ± - | | 108-1051 | | |
| 2 PLC ± - | | APPLICATION SPEC | | |
| 3 PLC ± 0.13 [0.005] | | 114-1020 | | |
| 4 PLC ± - | | SIZE CAGE CODE DRAWING NO RESTRICTED TO | | |
| 5 PLC ± - | | A2 00779 C=640430 | | |
| FINISH | | CUSTOMER DRAWING | | |
| SCALE 4:1 | | SHEET 1 of 1 REV W | | |

X-ON Electronics

Largest Supplier of Electrical and Electronic Components

Click to view similar products for [Headers & Wire Housings](#) category:

Click to view products by [TE Connectivity](#) manufacturer:

Other Similar products are found below :

[95000-104TRLF](#) [10135584-644402LF](#) [DF62W-EP2022PCA](#) [95000-106TRLF](#) [DF62W-2022SCA](#) [DF62W-EP2022PC](#) [2203348](#) [DF62W-2022SC](#) [1084018](#) [1029039](#) [1084017](#) [802-10-012-10-002000](#) [1112640](#) [1112639](#) [000-34000](#) [0009482033](#) [0009507031](#) [57102-S06-03LF](#) [57202-S52-04LF](#) [PCN6-15S-2.5E](#) [0039019024](#) [58102-G61-06LF](#) [582553-1](#) [0009508121](#) [0050291907](#) [018731A](#) [LY20-4P-DT1-P1E-BR](#) [02.125.8002.8](#) [60101931](#) [60598-1 \(Cut Strip\)](#) [M1625-3R/100](#) [61062-3](#) [61082-181009](#) [636-1427](#) [638009-1](#) [641938-9](#) [641991-4](#) [644168-1](#) [647662-1](#) [65039-019ELF](#) [65817-002LF](#) [65817-015LF](#) [65863-015LF](#) [66207-023LF](#) [67016-026LF](#) [67046-001LF](#) [67095-007LF](#) [68002-116](#) [68016-236H](#) [68648-049](#)