

THIS DRAWING IS UNPUBLISHED. RELEASED FOR PUBLICATION ,19 .  
 © COPYRIGHT 19 BY AMP INCORPORATED. ALL RIGHTS RESERVED.

| LOC |     | DIST        |                      | REVISIONS |     |      |  |
|-----|-----|-------------|----------------------|-----------|-----|------|--|
| P   | LTR | DESCRIPTION |                      | DATE      | DWN | APVD |  |
| G   | 14  | G           | REV PER 0G3A-0176-02 | 08APR02   | JR  | TM   |  |

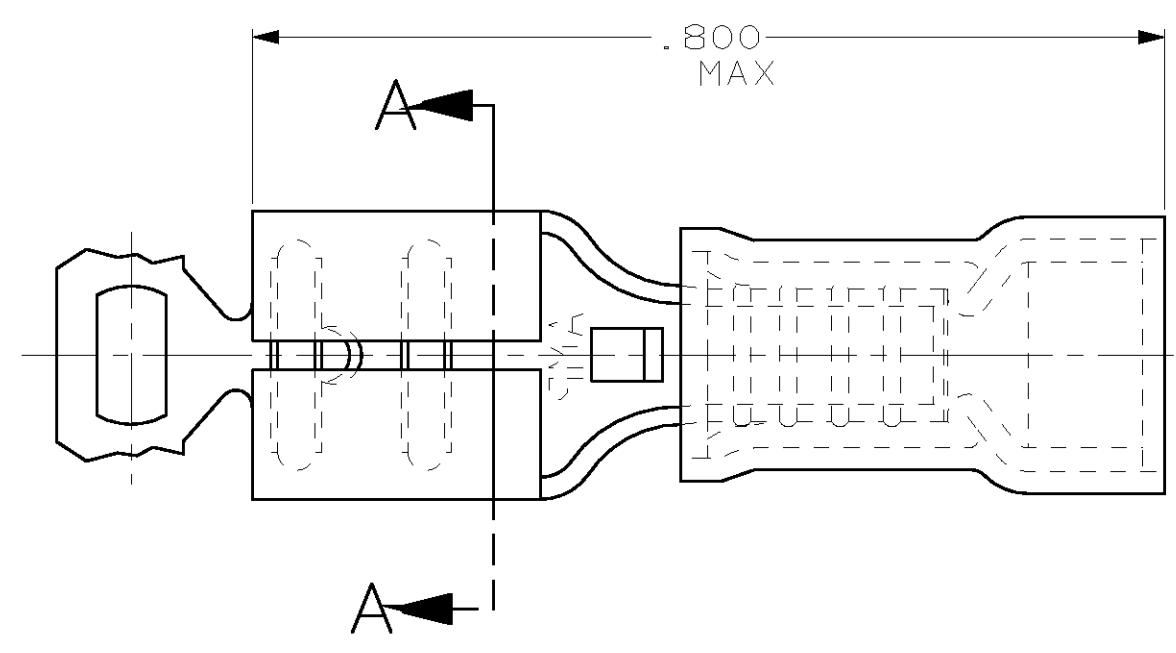

- 1. INSULATION DIA .170 MAX
- 2. FITS TAB .020 THK

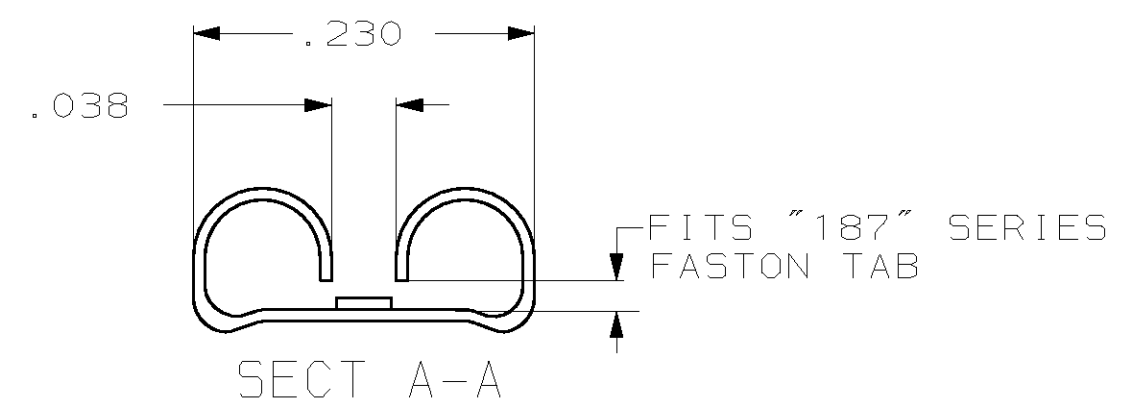
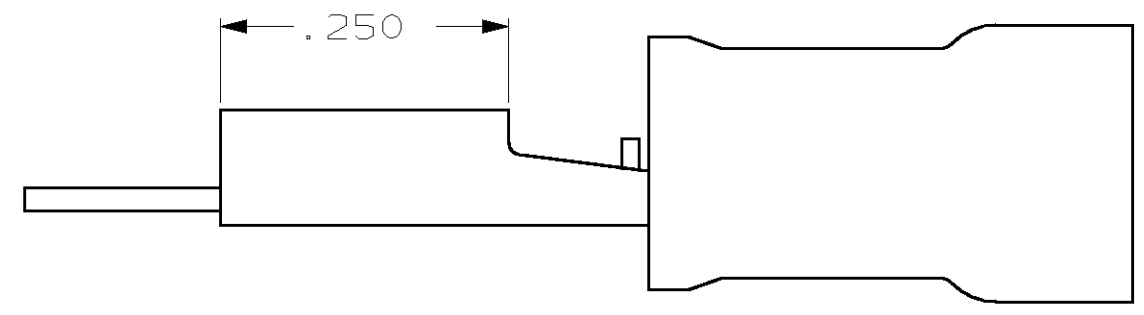

|     |              |          |
|-----|--------------|----------|
| -   | -            | 640918-1 |
| QTY | PACKAGE TYPE | PART NO  |

**AMP INCORPORATED**  
**CUSTOMER SERVICE SYSTEM**

|  |  |
|--|--|
| FOR ADDITIONAL PRODUCT INFORMATION OR COPIES OF DRAWINGS AND TECHNICAL DOCUMENTS | PRODUCT INFORMATION CENTER<br>1-800-522-6752 |
| FOR APPLICATION TOOLING INFORMATION  | TOOLING ASSISTANCE CENTER<br>1-800-722-1111  |
| FOR ORDER ENTRY  | 1-800-526-5142                               |

MAX RECOMMENDED OPERATING TEMPERATURE:  
-

VOLTAGE RATING:  
-

CIRCULAR MIL AREA:  
-

THIS DRAWING IS A CONTROLLED DOCUMENT FOR AMP INCORPORATED. IT IS SUBJECT TO CHANGE AND THE CONTROLLING ENGINEERING ORGANIZATION SHOULD BE CONTACTED FOR THE LATEST REVISION.

| DIMENSIONS, INCHES | TOLERANCES UNLESS OTHERWISE SPECIFIED: |
|--------------------|--|
|                    | 0 PLC ±-                               |
|                    | 1 PLC ±-                               |
|                    | 2 PLC ±.015                            |
|                    | 3 PLC ±-                               |
|                    | 4 PLC ±-                               |
|                    | ANGLES ±-                              |

MATERIAL: BODY, BRASS .016  
 SLV, NYLON, COLOR, BLUE

FINISH: BODY, TIN

|                  |          |           |
|------------------|----------|-----------|
| DWN              | L OLMEDA | 26 JUN 95 |
| CHK              | M ELLIS  | 26 JUN 95 |
| APVD             | B BARE   | 26 JUN 95 |
| PRODUCT SPEC     | -        | -         |
| APPLICATION SPEC | -        | -         |
| WEIGHT           | -        | -         |

CUSTOMER DRAWING

**AMP** AMP Incorporated  
 Harrisburg, PA 17105-3608

NAME: RECEPTACLE, 187 SERIES, FASTON™, PIDG™, WIRE SIZE, 16-14 AWG

|      |           |            |
|------|-----------|------------|
| SIZE | CAGE CODE | DRAWING NO |
| A3   | 00779     | C-640918   |

SCALE: NT5 SHEET: 1 OF 1 REV: G

## X-ON Electronics

Largest Supplier of Electrical and Electronic Components

*Click to view similar products for [Terminals](#) category:*

*Click to view products by [TE Connectivity](#) manufacturer:*

Other Similar products are found below :

[00-054007-01074-6](#) [00-054007-70206-1](#) [00-054007-70210-8](#) [00-054007-70217-7](#) [00-054007-70226-9](#) [00-054007-70228-3](#) [00-054007-70248-1](#) [00-054007-70256-6](#) [00-054007-70301-3](#) [00-054007-70316-7](#) [0-0320562-0](#) [00-054007-49560-4](#) [00-054007-70209-2](#) [00-054007-70225-2](#) [00-054007-70227-6](#) [00-054007-70231-3](#) [00-054007-70241-2](#) [00-054007-70242-9](#) [00-054007-70244-3](#) [00-054007-70246-7](#) [00-054007-70263-4](#) [00-054007-70288-7](#) [00-054007-70290-0](#) [00-054007-70300-6](#) [00-054007-70304-4](#) [01-2065-1-0216](#) [01-2900-1-04412](#) [00581P0075](#) [600TS-10](#) [60205-1](#) [604200-1](#) [605601-1](#) [60598-1-CUT-TAPE](#) [61314-6-C](#) [61810-3](#) [61-S](#) [61-SN](#) [626-0194](#) [62-NBM-A](#) [62-SN](#) [62-SP](#) [63-S](#) [640179-1](#) [M55155/059I03](#) [M55155/079C01](#) [M55155/099H02](#) [M55155/109H01](#) [M55155/109H02](#) [M55155/12XH05](#) [M55155/16XH02](#)