

LOC	DIST	REVISIONS			
CM	00	REV	DATE	BY	APPV
H	REVISED PER ECR-20-000541		15MAY2020	PC	SW

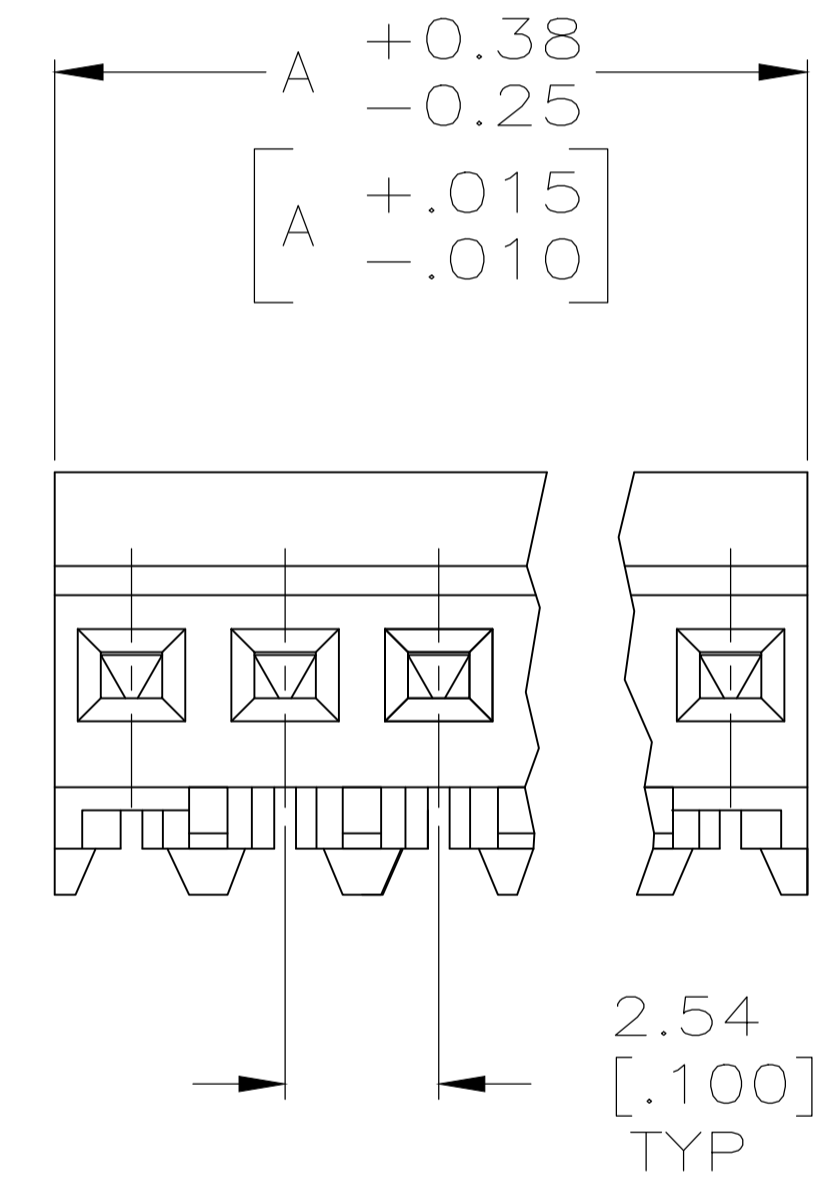
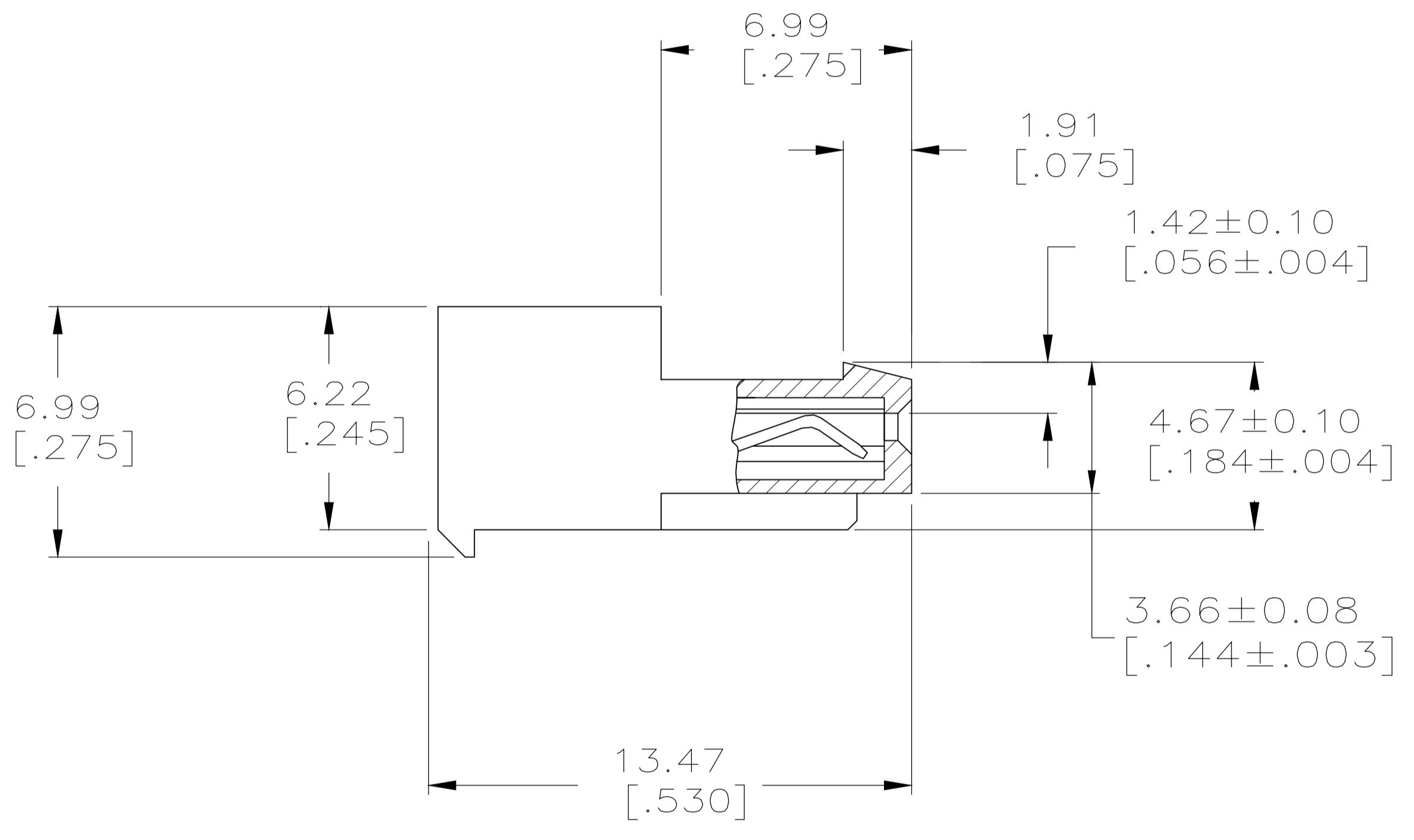
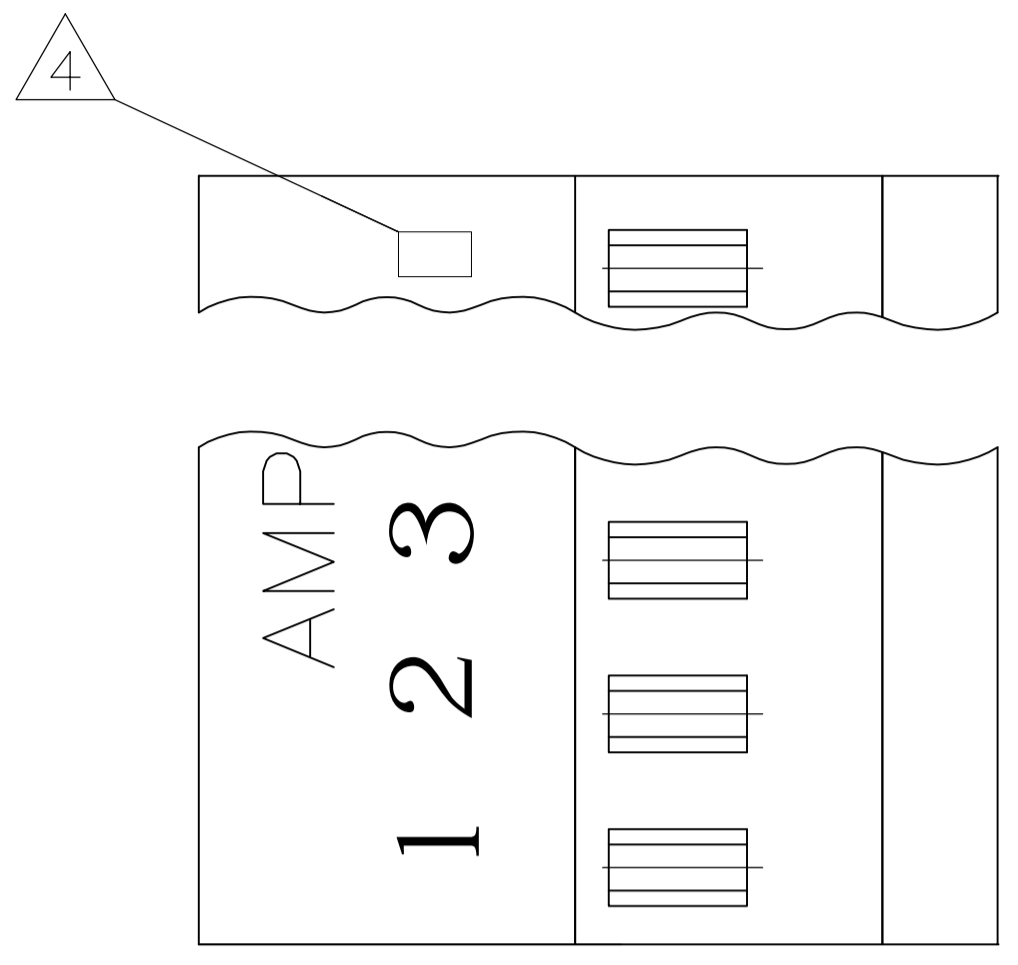

- 1 MATERIAL: CONNECTOR-NYLON UL94V-2 (RED).
CONTACTS-0.30 [.012] THICK COPPER ALLOY
BRIGHT TIN-LEAD 0.00203 [.000080] MINIMUM
THICK FOR CONTACTS 641534-2 THRU 641534-8,
MATTE WHISKER MITIGATED TIN PLATE 0.00203 [.000080]
MINIMUM THICK OVER NICKEL UNDERPLATE FOR CONTACTS
3-641534-2 THRU 3-641534-8.
- 2 CONTACTS ACCEPT 22 AWG WIRE WITH 1.52 [.060] MAXIMUM INSULATION DIAMETER.
- 3 CONTACTS MUST ACCEPT 0.36-0.51 [.014-.020] SQUARE OR ROUND POST AND REMAINED LOCKED IN POSITION.
- 4 IDENTIFICATION NUMBER FOR LAST CIRCUIT MAY NOT APPEAR ON ALL ASSEMBLIES.
- 5 DIMENSIONS IN BRACKETS ARE IN INCHES.
- 6 HOUSING FEATURES ARE: CLOSED END WITH LOCKING RAMP & LED CONTACT.
- 7 OBSOLETE PARTS: OBSOLETE CIS STREAMLINING PER D.RENAUD/D.SINISI
- 8 OBSOLETE PARTS

LEAD FREE	DIM A	NO.OF POSN	ASSEMBLY
20.32 [.800]	8	3-641534-8	
10.16 [.400]	4	3-641534-4	
7.62 [.300]	3	3-641534-3	
5.08 [.200]	2	3-641534-2	

CONTAINS LEAD	DIM A	NO.OF POSN	ASSEMBLY
20.32 [.800]	8	3-641534-8	
10.16 [.400]	4	3-641534-4	
7.62 [.300]	3	3-641534-3	
5.08 [.200]	2	3-641534-2	

8 SUPERSEDED
7 SUPERSEDED
8 SUPERSEDED
OBSOLETE

THIS DRAWING IS A CONTROLLED DOCUMENT.

DIMENSIONS: mm [INCHES]	TOLERANCES UNLESS OTHERWISE SPECIFIED:	DIN S. HOOVER 10-DEC-2004	TE Connectivity
0 PLC ±	1 PLC ±	CIK: D. ROSSI 10-DEC-2004	NAME: MTA-100 CONNECTOR ASSEMBLY, 22 AWG, FOR .014 TO .020 POST, SPECIAL
2 PLC ±	3 PLC ±	APVD: D. ROSSI 10-DEC-2004	PRODUCT SPEC: 108-1050
4 PLC ±	ANGLES ±	APPLICATION SPEC: 114-1019	RESTRICTED TO: A1 00779 641534
MATERIAL: 1	FINISH: 1	WEIGHT: A1 00779 641534	CUSTOMER DRAWING

SCALE: 8:1 SHEET 1 OF 1 REV H

X-ON Electronics

Largest Supplier of Electrical and Electronic Components

Click to view similar products for [Headers & Wire Housings](#) category:

Click to view products by [TE Connectivity](#) manufacturer:

Other Similar products are found below :

[892-18-020-10-001101](#) [58102-G61-06LF](#) [582553-1](#) [0009485154](#) [009176003701906](#) [0050291907](#) [LY20-4P-DT1-P1E-BR](#) [02.125.8002.8](#)
[609-3404](#) [61062-3](#) [61082-181009](#) [622-3653LF](#) [63453-116](#) [636-1030](#) [636-1427](#) [636-3427](#) [636-4007](#) [641938-9](#) [641991-4](#) [644827-2](#) [65817-](#)
[010LF](#) [65817-015LF](#) [65863-015LF](#) [66207-023LF](#) [67095-007LF](#) [67601157](#) [68645-018](#) [68648-049](#) [70.362.1628.0](#) [70-4210](#) [70-4226B](#) [70-](#)
[4853B](#) [707-5020](#) [707-5028](#) [71.350.2428.0](#) [71918-208LF](#) [71961-016LF](#) [733-134](#) [733-162](#) [754199-000](#) [760-3052](#) [787-8014-00](#) [79531-3000](#)
[FCN-360C032-B](#) [FCN-367T-T012/H](#) [FCN-723D010/2](#) [80.063.4001.1](#) [800-90-001-10-001000](#) [800-90-010-10-002000](#) [801-43-002-10-013000](#)