

THIS DRAWING IS UNPUBLISHED. RELEASED FOR PUBLICATION
 © COPYRIGHT - By - TE CONNECTIVITY ALL RIGHTS RESERVED.

| LOC | DIST | REVISIONS | | | |
|-----|------|-------------|---------------------------|-----------|-------|
| P | LTR | DESCRIPTION | DATE | DWN | APVD |
| CM | 54 | J | REVISED PER ECR-20-000826 | 29MAY2020 | PC SW |

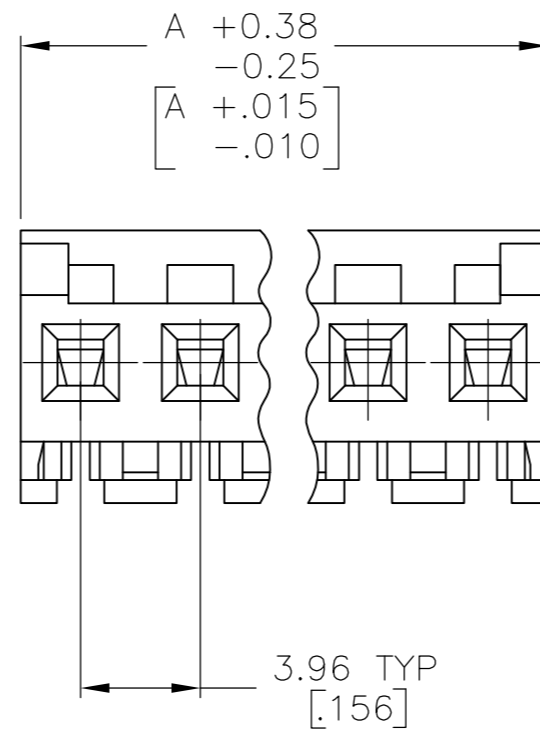
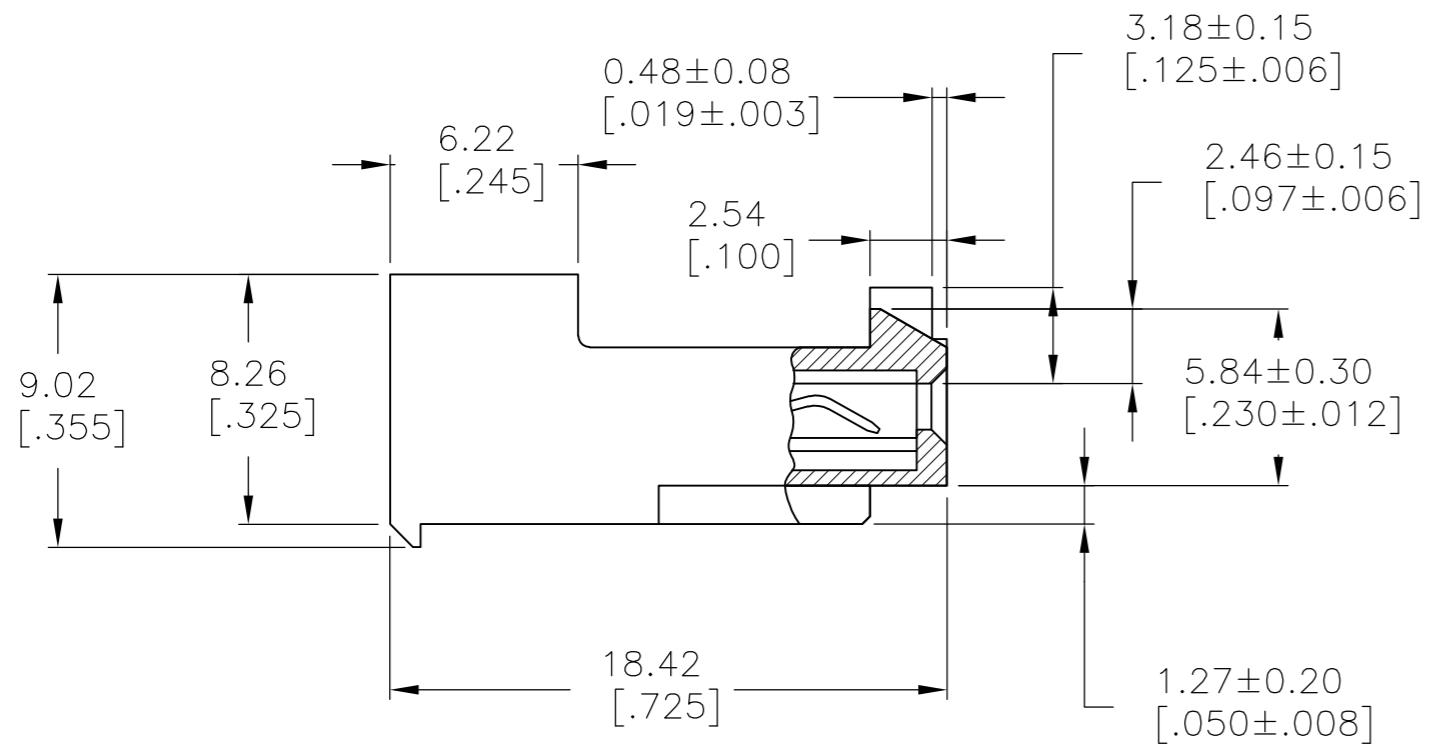
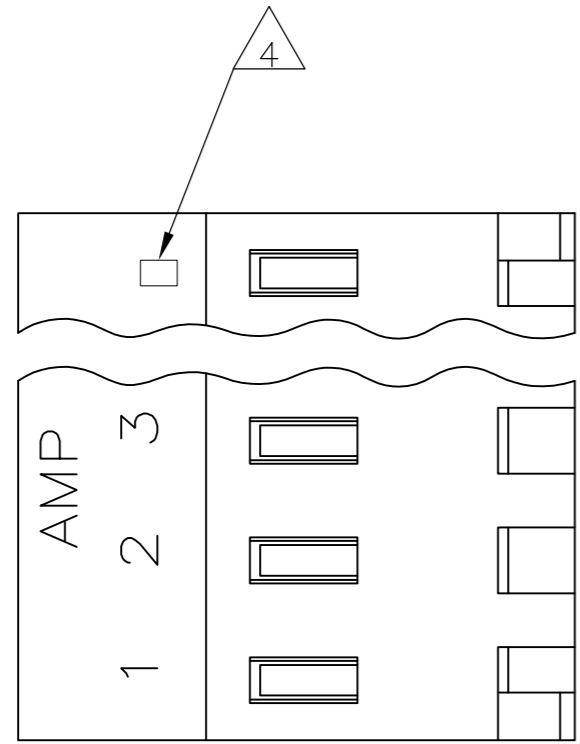

| | | | |
|-------|---------|----|------------|
| 95.10 | [3.744] | 24 | 5-643821-4 |
| 91.14 | [3.588] | 23 | 5-643821-3 |
| 87.17 | [3.432] | 22 | 5-643821-2 |
| 83.21 | [3.276] | 21 | 5-643821-1 |
| 79.25 | [3.120] | 20 | 5-643821-0 |
| 75.29 | [2.964] | 19 | 4-643821-9 |
| 71.32 | [2.808] | 18 | 4-643821-8 |
| 67.36 | [2.652] | 17 | 4-643821-7 |
| 63.40 | [2.496] | 16 | 4-643821-6 |
| 59.44 | [2.340] | 15 | 4-643821-5 |
| 55.47 | [2.184] | 14 | 4-643821-4 |
| 51.51 | [2.028] | 13 | 4-643821-3 |
| 47.55 | [1.872] | 12 | 4-643821-2 |
| 43.59 | [1.716] | 11 | 4-643821-1 |
| 39.62 | [1.560] | 10 | 4-643821-0 |
| 35.66 | [1.404] | 9 | 3-643821-9 |
| 31.70 | [1.248] | 8 | 3-643821-8 |
| 27.74 | [1.092] | 7 | 3-643821-7 |
| 23.77 | [.936] | 6 | 3-643821-6 |
| 19.81 | [.780] | 5 | 3-643821-5 |
| 15.85 | [.624] | 4 | 3-643821-4 |
| 11.89 | [.468] | 3 | 3-643821-3 |
| 7.92 | [.312] | 2 | 3-643821-2 |

| | | | |
|-------|---------|----|------------|
| 95.10 | [3.744] | 24 | 2-643821-4 |
| 91.14 | [3.588] | 23 | 2-643821-3 |
| 87.17 | [3.432] | 22 | 2-643821-2 |
| 83.21 | [3.276] | 21 | 2-643821-1 |
| 79.25 | [3.120] | 20 | 2-643821-0 |
| 75.29 | [2.964] | 19 | 1-643821-9 |
| 71.32 | [2.808] | 18 | 1-643821-8 |
| 67.36 | [2.652] | 17 | 1-643821-7 |
| 63.40 | [2.496] | 16 | 1-643821-6 |
| 59.44 | [2.340] | 15 | 1-643821-5 |
| 55.47 | [2.184] | 14 | 1-643821-4 |
| 51.51 | [2.028] | 13 | 1-643821-3 |
| 47.55 | [1.872] | 12 | 1-643821-2 |
| 43.59 | [1.716] | 11 | 1-643821-1 |
| 39.62 | [1.560] | 10 | 1-643821-0 |
| 35.66 | [1.404] | 9 | -643821-9- |
| 31.70 | [1.248] | 8 | -643821-8- |
| 27.74 | [1.092] | 7 | -643821-7- |
| 23.77 | [.936] | 6 | -643821-6- |
| 19.81 | [.780] | 5 | -643821-5- |
| 15.85 | [.624] | 4 | -643821-4- |
| 11.89 | [.468] | 3 | -643821-3- |
| 7.92 | [.312] | 2 | -643821-2- |

7 SUPERSEDED
 8 OBSOLETE SUPERSEDED
 7 SUPERSEDED
 8 SUPERSEDED

1 MATERIAL: CONNECTOR - NYLON UL94V-2 (BLUE).
 CONTACTS - 0.30[.012] THICK COPPER ALLOY (BRIGHT TIN LEAD 0.00203 [.000080] MIN THK FOR CONTACTS 643821-2 THRU 2-643821-4, MATTE WHISKER MITIGATED TIN .00203(.000080) MIN THICKNESS OVER NICKEL UNDERPLATE FOR 3-643821-2 THRU 5-643821-4)

2 CONTACTS ACCEPT 26 AWG WIRE WITH 2.41[.095] MAX INSULATION DIAMETER.

3 CONTACTS MUST ACCEPT 1.14±0.03 [.045±.001] SQUARE POST AND REMAIN LOCKED IN POSITION.

4 IDENTIFICATION NUMBER FOR LAST CIRCUIT MAY NOT APPEAR ON ALL ASSEMBLIES.

5 DIMENSIONS IN BRACKETS ARE IN INCHES.

6 HOUSING FEATURES ARE: CLOSED END WITH LOCKING RAMP & POLARIZING TABS.

7 OBSOLETE PARTS: OBSOLETE CIS STREAMLINING PER D.RENAUD/D.SINISI

8 OBSOLETE PARTS

| | | | | |
|--|--|----------------------|------|---|
| THIS DRAWING IS A CONTROLLED DOCUMENT. | | DWN B.LEWIS 12MAR96 | | |
| DIMENSIONS: mm [INCHES] | | CHK R.SWING 12MAR96 | | |
| TOLERANCES UNLESS OTHERWISE SPECIFIED: | | APVD D.CLARK 12MAR96 | NAME | |
| 0 PLC ± - | | PRODUCT SPEC | | MTA-156 CONNECTOR ASSEMBLY 26 AWG, STANDARD |
| 1 PLC ± - | | APPLICATION SPEC | | |
| 2 PLC ± - | | 108-1051 | | SIZE A2 CAGE CODE 00779 DRAWING NO C-643821 RESTRICTED TO - |
| 3 PLC ± - | | 114-1020 | | |
| 4 PLC ± - | | WEIGHT | | SCALE 4:1 SHEET 1 OF 1 REV J |
| ANGLES ± - | | CUSTOMER DRAWING | | |
| FINISH 1 | | | | |

X-ON Electronics

Largest Supplier of Electrical and Electronic Components

Click to view similar products for [Headers & Wire Housings](#) category:

Click to view products by [TE Connectivity](#) manufacturer:

Other Similar products are found below :

[95000-104TRLF](#) [10135584-644402LF](#) [DF62W-EP2022PCA](#) [95000-106TRLF](#) [DF62W-2022SCA](#) [DF62W-EP2022PC](#) [2203348](#) [DF62W-2022SC](#) [1084018](#) [1029039](#) [1084017](#) [802-10-012-10-002000](#) [1112640](#) [1112639](#) [000-34000](#) [0009482033](#) [0009507031](#) [57102-S06-03LF](#) [57202-S52-04LF](#) [PCN6-15S-2.5E](#) [0039019024](#) [58102-G61-06LF](#) [582553-1](#) [0009508121](#) [0050291907](#) [018731A](#) [LY20-4P-DT1-P1E-BR](#) [02.125.8002.8](#) [60101931](#) [60598-1 \(Cut Strip\)](#) [M1625-3R/100](#) [61062-3](#) [61082-181009](#) [636-1427](#) [638009-1](#) [641938-9](#) [641991-4](#) [644168-1](#) [647662-1](#) [65039-019ELF](#) [65817-002LF](#) [65817-015LF](#) [65863-015LF](#) [66207-023LF](#) [67016-026LF](#) [67046-001LF](#) [67095-007LF](#) [68002-116](#) [68016-236H](#) [68648-049](#)