

SPECIFICATION CONTROL DRAWING

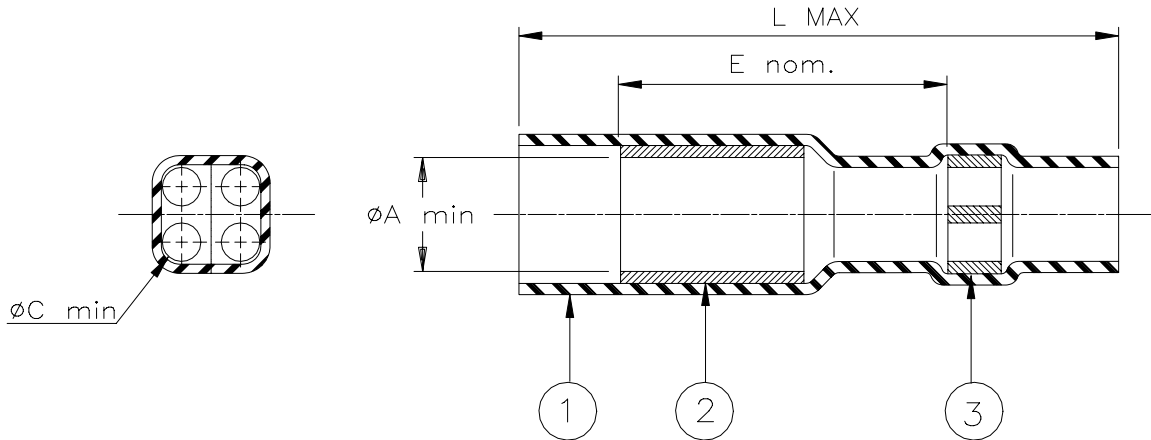

| Product Revision | | Product Dimensions | | | | Cable Dimension |
|------------------|---|--------------------|---------------|------------------|----------------|-----------------|
| Product Name | | L max | E nom | ϕA min | ϕC min | ϕD max |
| D-436-48 | I | 45.9 (1.805) | 25.4 (1.0) | 10.15 (0.400) | 3.8 (0.150) | 3.8 (0.150) |

MATERIALS

1. INSULATION SLEEVE: Heat-shrinkable, transparent blue, radiation cross-linked modified polyvinylidene fluoride.
2. SEALING INSERT: Fluorocarbon-based thermoplastic. Color:clear.
3. SEALING INSERT: Fluorocarbon-based thermoplastic. Color:yellow.

APPLICATION

1. This part is designed to provide an environment -resistant seal on stub or parallel splices with wires rated for at least +135°C.
2. Sealing will not be achieved when more than two wires exit from any hole.
3. Temperature range: -55°C to +150°C.

Cable dimension:

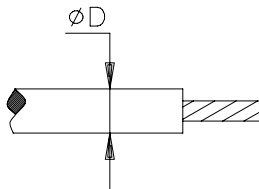

* A trademark of Raychem Corporation.

| | | | | | | | |
|--|--|------------------------------------|--|---|--|---------------------------------|--|
| Raychem | | THERMOFIT DEVICES | | Raychem Corporation 300 Constitution Drive Menlo Park, CA 94025 USA | | TITLE: SEALING SLEEVE | |
| UNLESS OTHERWISE SPECIFIED DIMENSIONS ARE IN MILLIMETERS. INCHES DIMENSIONS ARE BETWEEN BRACKETS. | | | | DOCUMENT NO.: D-436-48 | | | |
| TOLERANCES: 0.00 N/A 0.0 N/A 0 N/A | | ANGLES: N/A ROUGHNESS IN MICRON | | Raychem reserves the right to amend this drawing at any time. Users should evaluate the suitability of the product for their application. | | DCR NUMBER: D981037 | |
| REPLACES: D43648 | | DRAWN BY: M. FORONDA | | DATE: 06/29/98 | | PROD. REV. SEE TABLE | |
| DOC ISSUE: 1 | | SCALE: None | | SIZE: A | | SHEET: 1 of 1 | |

If this document is printed it becomes uncontrolled. Check for the latest revision

X-ON Electronics

Largest Supplier of Electrical and Electronic Components

Click to view similar products for te connectivity manufacturer:

Other Similar products are found below :

[570416-000](#) [CLTEQ-M81CE-SSRELAY-4-20V](#) [4-1633138-8](#) [D38999/24FJ4AN](#) [4-1195131-0](#) [650069-000](#) [SMD100-2](#) [2EDL4CM](#)
[DTS20W19-11PD-3028](#) [DTS20W19-11PD-3028-LC](#) [DTS20W19-32SD-3028-LC](#) [DTS20W19-32SD-3028](#) [NC6-P104-06](#) [TXR64AB90-](#)
[3616AI](#) [DTS26F21-41HE](#) [DTS26F21-41AE](#) [DTS26F21-41PE-LC](#) [DTS26F21-11SE-3028-LC](#) [D38999/24WF32JE](#) [D38999/24WF32SE-LC](#)
[DTS24W19-32HE](#) [D38999/20JB35HA](#) [D38999/24WJ20PA](#) [164-8033-08](#) [D38999/24FF32JE](#) [D38999/24FF32SE-LC](#) [D38999/24WF32JB](#)
[D38999/24WG11HA](#) [D38999/24WG11HN](#) [MS27467T21F11H](#) [DJT16E21-11HA](#) [DTS24F19-32HE](#) [DTS20W19-32SA-3028-LC](#) [DTS24F19-](#)
[11SC-3028-LC](#) [DTS24F19-11SC-3028](#) [DJT14E13-98HB](#) [D38999/20WC8BB](#) [1-330599-5](#) [DTS24F21-41HN-LC](#) [DTS24F21-41HN](#)
[DTS24F21-41AN](#) [DTS24F21-39HN](#) [DTS24F21-41PN-LC](#) [AFD50-10-6SN-1A-LC](#) [DJT10F17-26HC](#) [DTS24W19-32HB](#) [ACT20JE99HA](#)
[DJT10E17-26HC](#) [DJT10E17-26HN](#) [DJT10F17-26HA](#)