

NOTES:

1. ALL DIMENSIONS ARE IN INCHES [MILLIMETERS] [GRAMS] LBS

2. DIMENSIONS APPEARING IN TABLE ARE AS FOLLOWS:

a AS SUPPLIED
b AFTER UNRESTRICTED RECOVERY

3. COATING (ADHESIVE) IS OPTIONAL AS SUPPLIED DIMENSIONS APPEARING IN TABLE ARE FOR UNCOATED PARTS.

DIAMETERS WILL BE REDUCED BY .06 MAX. WHEN COATING IS ADDED, ENTRY MOLDING PORTS ARE OPTIONAL.

4. WHEN -00 MODIFICATION NUMBER IS SPECIFIED MOLDING PORTS WILL BE LOCATED AS SHOWN.

ON SIZES 222A111 AND 222A121 THE 0.18 INCH DIAMETER MOLDING PORT AT "T" WILL BE ELIMINATED. THE 0.12" DIA MOLDING PORT WILL BE ENLARGED TO 0.18 INCHES

5. WEIGHT SHOWN IN TABLE OF DIMENSIONS IS BASED ON POLYOLEFIN PART

6. ORDERING INFORMATION

222A1XX -XX -XX /XXX /0

BASE PART NUMBER

MATERIAL DASH NUMBER

-3 POLYOLEFIN, SEMI RIGID (RT-301)

-4 POLYOLEFIN, FLEXIBLE (RT-1304)

-5 ELASTOMER, FLEXIBLE (RT-501)

-6 SILICONE (RT-602)

-12 FLUORO ELASTOMER, FLEXIBLE (RT-1312)

-25 ELASTOMER, FLUID RESISTANT (RW-2070)

-100 POLYOLEFIN, SEMI-FLEXIBLE ZEROHAL (RT-1323)

ADHESIVE SLASH NUMBER

SEE COMPATIBILITY CHART BELOW

COLOR DESIGNATOR

IF THIS DOCUMENT IS PRINTED IT BECOMES UNCONTROLLED. CHECK FOR THE LATEST REVISION.

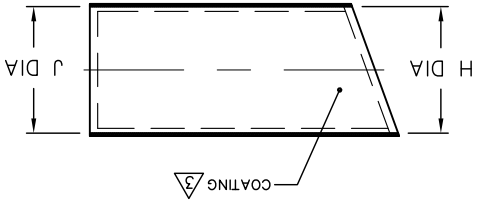

AS SUPPLIED

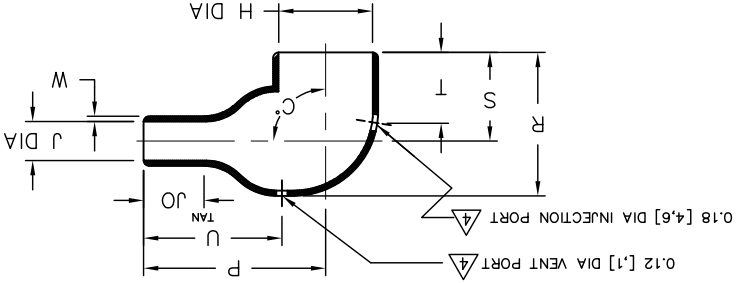

AFTER UNRESTRICTED RECOVERY

TABLE OF DIMENSIONS

PART DESCRIPTION	H		J		P	R	S	T	U	JO	W	C.	
	MIN	MAX	MIN	MAX	MIN	MIN	MIN	MIN	MIN	MIN	MIN	±10%	±5%
222A111	.70	.31	.70	.39	.15	.68	.79	.61	N/A	.45	.17	.04	.002
222A121	.98	.40	.98	.21	.84	.89	.65	.58	N/A	.23	.53	.05	.003
222A132	1.18	.56	1.18	.81	1.25	1.06	1.05	.73	.75	.70	.28	.06	.006
222A142	1.28	.68	1.28	.27	1.44	1.20	1.20	.81	.75	.98	.40	.07	.014
222A152	1.42	.86	1.42	.33	1.72	1.38	.90	.75	1.18	.50	.07	.019	.014
222A163	1.73	1.08	1.73	.37	2.11	1.73	1.15	.75	1.34	.68	.08	.029	.014
222A174	2.09	1.33	2.09	.59	2.98	2.08	1.34	1.00	1.26	.13	.13	.077	.014
222A185	2.66	1.74	2.66	.80	3.84	2.60	1.66	1.00	1.60	.15	.15	.143	.014
222A196	3.45	2.18	3.45	1.28	5.04	3.12	1.93	1.00	2.22	.18	.18	.310	.014

CUSTOMER DRAWING

Raychem Molded Parts
305 Constitution Dr
Menlo Park, CA 94025



DRAWN YUNGUEN
APPROVED DHURRELL



TE CONNECTIVITY RESERVES THE RIGHT TO PRODUCT FOR THEIR APPLICATION. THIS DRAWING AT THE DISCRETION OF THE USER SHOULD EVALUATE THE SIMILARITY OF THE PART TO THE ORIGINAL DRAWING.

DO NOT SCALE THIS DRAWING
SHEET 1 OF 1
222A111thru196
06090
CODE IDENT. NO. DWG. NO.

THIN WALL
BOOT, 90 DEGREE

X-ON Electronics

Largest Supplier of Electrical and Electronic Components

Click to view similar products for [Heat Shrink Cable Boots & End Caps](#) category:

Click to view products by [TE Connectivity](#) manufacturer:

Other Similar products are found below :

[577159N001](#) [007758-000](#) [610368N003](#) [645494-000](#) [M85049/141-02HU](#) [M85049/141-03HU](#) [M85049/141-04HU](#) [687025-000](#) [705331-000](#)
[718446-000](#) [725666N001](#) [729257-000](#) [F21914-000](#) [F27131-000](#) [F85868-000](#) [770-006A103R](#) [770-006A304W1](#) [770-006A305W1](#) [770-](#)
[006A308W1](#) [770-011T303W1](#) [770-011T304W1](#) [770-020S702W1](#) [770-020S704W1](#) [806138-000](#) [806542N001](#) [807507-000](#) [808059-000](#)
[808296-000](#) [808362-000](#) [808828-000](#) [809125-000](#) [809130-000](#) [809218-000](#) [811218-000](#) [811288-000](#) [812014-000](#) [812047-000](#) [813166-000](#)
[813767N002](#) [814417-000](#) [819115N001](#) [819117N001](#) [823026-000](#) [823070-000](#) [825002-000](#) [841189N001](#) [861471-000](#) [866647-000](#) [937577-](#)
[000](#) [950764-000](#)