

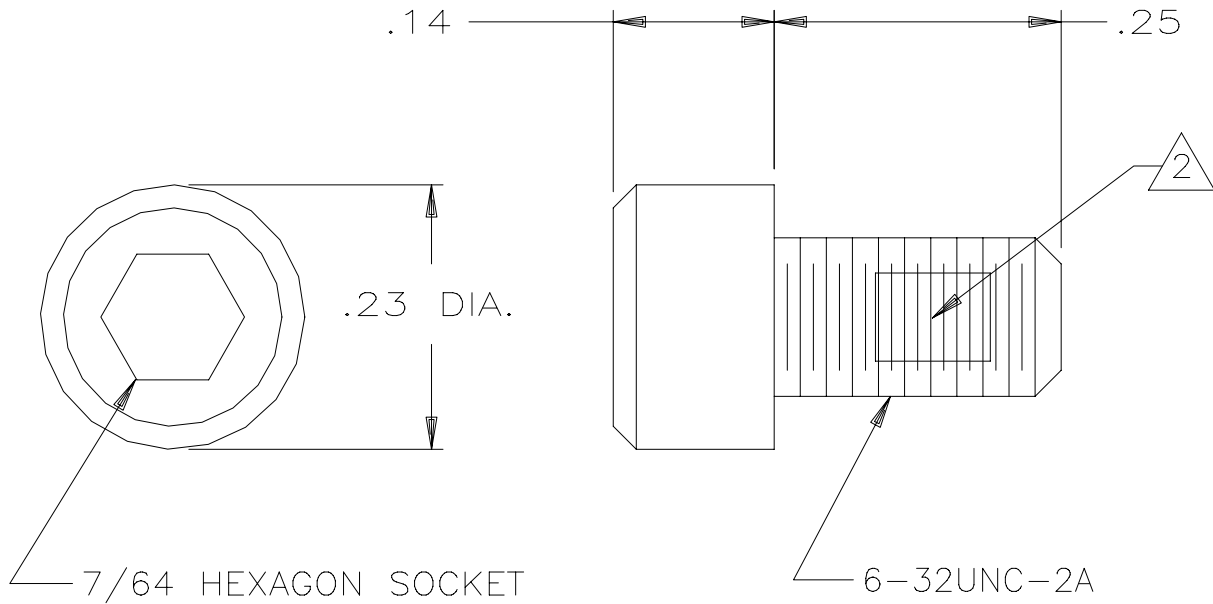

REVISIONS			
LTR	DESCRIPTION	DATE	APPROVED
C	REVISED PER ECN T-013336	890928	J.BLAIR
D	REVISED PER DCR# T-22996	6/11/99	M.HIGGY



NOTES:

1. PART USED WITH MTC RECEPTACLE ASSEMBLIES.
2. SCREW PROVIDED WITH LOCKING ELEMENT IN ACCORDANCE WITH MIL-F-18240, CONFIGURATION B.
3. WEIGHT: .0021 Lbs. [.93 gr.] MAXIMUM.
4. MATERIAL: STAINLESS STEEL PER QQ-S-763  
FINISH: PASSIVATED PER QQ-P-35

SPECIFICATION CONTROL DRAWING

UNLESS OTHERWISE SPECIFIED  
DIMENSIONS ARE IN INCHES.  
METRIC DIMENSIONS ARE  
IN BRACKETS.

DECIMALS  
.XXX ± .005 { mm }  
.XX ± .01 { mm }  
ANGLES  
.X ±  
WEIGHT  
3 lbs { g }

DRAWN	V.D.T.	8-19-76
CHECKED	DCT	9-2-76
APPROVED	RAS	9-3-76
APPROVED	P.M.N.	9-3-76
CAD NAME T22996.DWG		

*Raychem*

RAYCHEM CORPORATION  
300 CONSTITUTION DRIVE  
MENLO PARK, CALIFORNIA 94025

TITLE  
MTC ADAPTOR SCREW

THIRD ANGLE  
PROJECTION

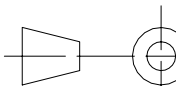

SIZE A	CODE IDENT. NO. 06090	DWG. NO. D-659-0044	REV D
-----------	--------------------------	------------------------	----------

DO NOT SCALE THIS DRAWING

SHEET 1 OF 1

## X-ON Electronics

Largest Supplier of Electrical and Electronic Components

*Click to view similar products for [Screws & Fasteners](#) category:*

*Click to view products by [TE Connectivity](#) manufacturer:*

Other Similar products are found below :

[5721-1440-1/4-SS](#) [593503FX](#) [0098.0094](#) [0098.9206](#) [0098.9219](#) [0098.9221](#) [0098.9262](#) [596-2114-013](#) [59781-1](#) [59781-4](#) [59781-6](#) [0098.0026](#)  
[0098.9210](#) [0098.9212](#) [60227-01](#) [60227-04](#) [60227-08](#) [60228-09](#) [618-00001](#) [62153-03](#) [62153-11](#) [M316-KSSTMCZ100](#) [M3440-SS](#) [M3442-](#)  
[SS](#) [M3448-SS](#) [6291A](#) [6292-1](#) [6-306105-9](#) [6-306131-4](#) [690432-1](#) [699161-000](#) [700989](#) [7-18023-1](#) [7-21002-8](#) [7230-3](#) [7235-3](#) [7248-1](#) [7248-2](#)  
[73542-02](#) [CAPTIVE SHORT THUMBSCREW](#) [F03-02](#) [SUS316](#) [F1209](#) [751-00001](#) [80011](#) [809704-1](#) [8700](#) [8860220](#) [9047](#) [95000002B](#) [9521](#)  
[9885-2](#)