

REVISIONS			
LTR	DESCRIPTION	DATE	APPROVED
N/C	INITIAL RELEASE PER ECN# T-17740	92 SEPT 8	Z. TEMAN
A	REVISED PER ECN# T-18523		

NOTES:

- MATERIAL: LNP STATKON-FE (VIRGIN) HIGH DENSITY POLYETHYLENE.  
COLOR: BLACK
- RESISTIVITY OF MATERIAL ELECTRICALLY CONDUCTIVE PER MIL-STD-1686
- VIEW SHOWING TYPICAL INSTALLATION (ROTATED 180°).

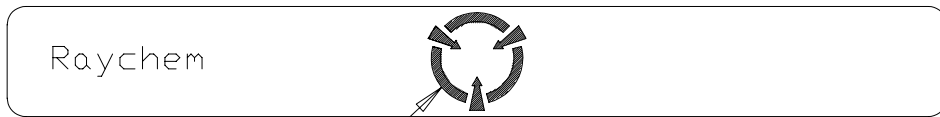
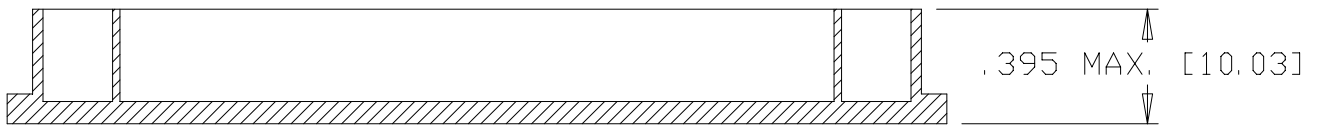
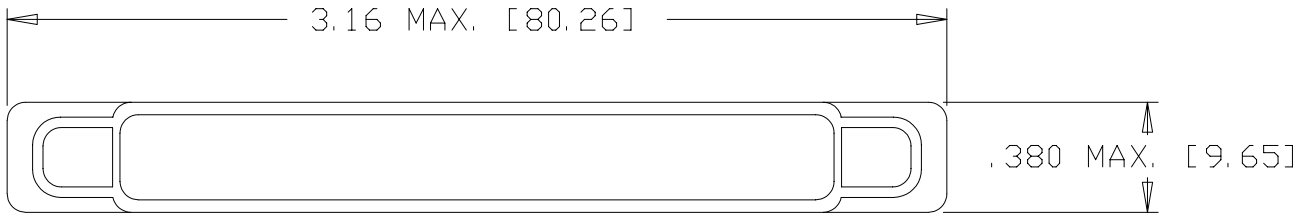

SYMBOL PER MIL-STD-1686A

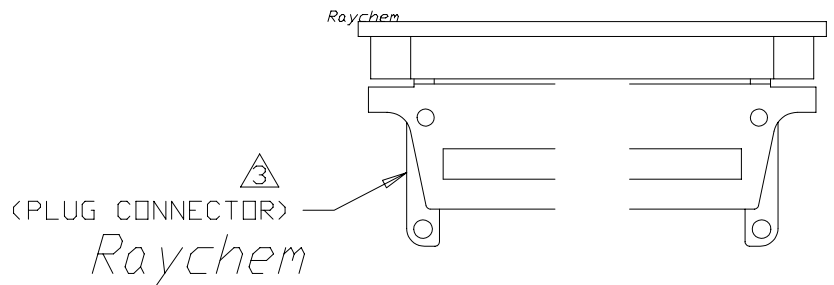

SPECIFICATION CONTROL DRAWING © Raychem Corporation 1992

UNLESS OTHERWISE SPECIFIED  
DIMENSIONS ARE IN INCHES.  
METRIC DIMENSIONS ARE  
IN BRACKETS.

DECIMALS

.XXX ± — [ — mm]

.XX ± — [ — mm]

ANGLES

.X ± —

WEIGHT

2.37 g MAX.

DRAWN	J. B. K.	92 AUG 10
CHECKED		
APPROVED		
APPROVED	Z. TEMAN	92 SEPT 8
CAD NAME	009233-1	

RAYCHEM CORPORATION  
300 CONSTITUTION DRIVE  
MENLO PARK, CALIFORNIA 94025

TITLE			
CAP, DUST, PLUG, 2 INCH, CONDUCTIVE, MTC SERIES			
PCN: 707379			
SIZE	CODE IDENT. NO.	DWG. NO.	REV
A	06090	CHA-0269	A

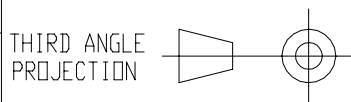

DO NOT SCALE THIS DRAWING		SHEET 1 OF 1	
---------------------------	--	--------------	--

## X-ON Electronics

Largest Supplier of Electrical and Electronic Components

*Click to view similar products for* [Circular MIL Spec Tools, Hardware & Accessories](#) *category:*

*Click to view products by* [TE Connectivity](#) *manufacturer:*

Other Similar products are found below :

[809-199-3](#) [001104](#) [300 04](#) [0113-201-2025](#) [600-006-16](#) [600-079-06](#) [602GB18808](#) [M225201-06](#) [M24758-20E21](#) [M2887610-BC](#) [M2887615-CD](#) [M38999/9-19B](#) [62GB-812-10](#) [630A007NF083A](#) [630B007M051A](#) [630BJ003NF032H](#) [M39029/29-215](#) [650FS002NF16](#) [M81969-14-02](#) [660-008NF14S7-01](#) [660-009M22H8-03](#) [660-013NF19U6-210](#) [660-015M10S6-17](#) [660-015NF10S5-01](#) [660-015NF14R3.5-01](#) [660-023NF19H6-19](#) [660-024NF11S12-01](#) [660-024NF11S3-01](#) [660-050XM17F4-01](#) [660-068NF25R6-30G](#) [660-070M23S8-04](#) [660-073MTCH9-20](#) [M83723/60-116RC](#) [M83723/61-18W](#) [M83723/61-218R](#) [M83723/61-224W](#) [667-224NF16](#) [M85049/126S11N](#) [M85049130-07M](#) [M85049140-09BC](#) [M85049/41-16A W/B](#) [M85049/75-14-1](#) [M8504980-8](#) [M85049/94-10-A](#) [M85049/94-12](#) [M85049/96-10](#) [M85049/96-12](#) [M85049/96-7-A](#) [M855282-10A01A](#) [M85528/2-10B](#) [M855282-18A01A](#)