

THIS DRAWING IS UNPUBLISHED.

RELEASED FOR PUBLICATION

ALL RIGHTS RESERVED.

© COPYRIGHT - By -

MATERIAL:
 HOUSING: THERMOPLASTIC PA, UL94V-0, BLACK.
 TERMINALS: BRIGHT TIN PLATE, COPPER ALLOY.
 SCREWS: 6-32, STEEL, ZINC PLATED AND CLEAR CHROMATE.

ELECTRICAL:
 UL CLASS C: 20A, 150V.
 UL CLASS D: 10A, 300V.
 CSA TYPE B: 20A, 300V.
 CSA TYPE C: 20A, 300V.
 CSA TYPE D: 10A, 300V.
 CSA TYPE E: 20A, 300V.
 WIRE RANGE: 12-22 AWG.

MECHANICAL:
 OPERATING TEMP.: -40°C TO +105°C.
 RECOMMENDED TIGHTENING TORQUE: 7 IN-LBS.

- ① TRIMMED TO LENGTH.
- ② PRELIMINARY PART NUMBER.
- ③ OBSOLETE PARTS.

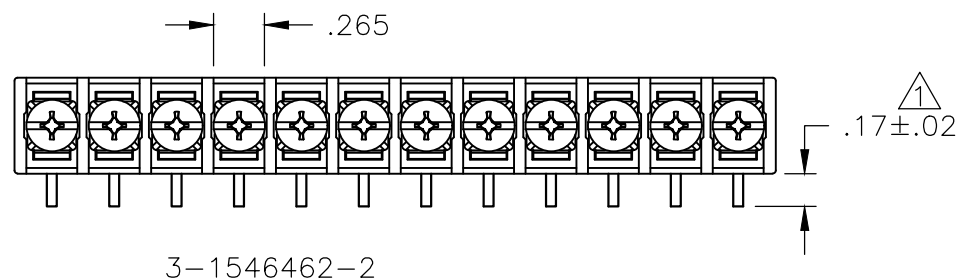
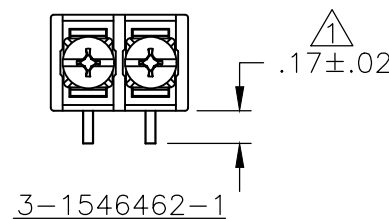
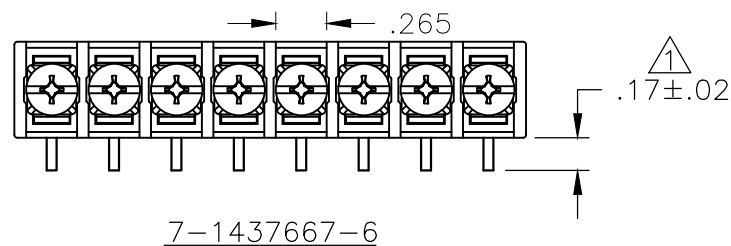
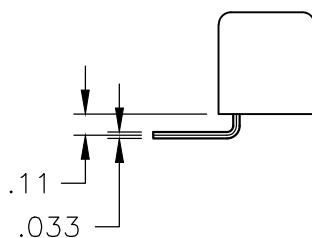
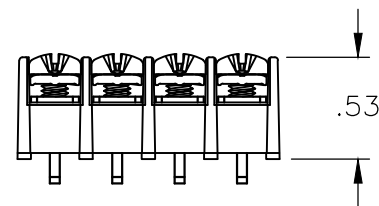
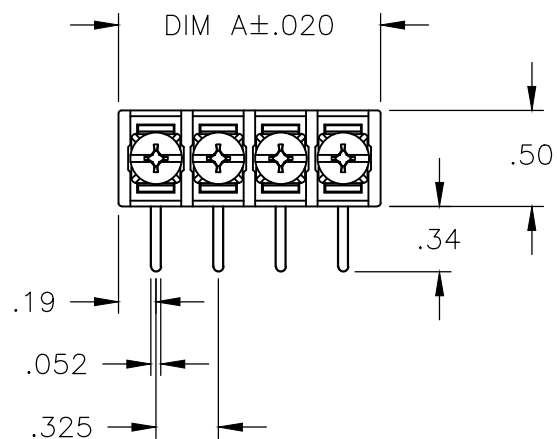

| REVISIONS | | | | | |
|-----------|-----|------------------------|-----------|-----|------|
| P | LTR | DESCRIPTION | DATE | DWN | APVD |
| B3 | | P/N 3-1546462-2 ADDED. | 02APR2018 | RK | PS |

| DIM A | NO OF POS | CATALOG NUMBER | PART NUMBER |
|----------|-----------|------------------|-------------|
| ①② 3.965 | 12 | 4DB-R108-12-SPCL | 3-1546462-2 |
| ③ 9.815 | 30 | 4DB-R108-30 | 3-1546462-0 |
| ③ 9.490 | 29 | 4DB-R108-29 | 2-1546462-9 |
| ③ 9.165 | 28 | 4DB-R108-28 | 2-1546462-8 |
| ③ 8.840 | 27 | 4DB-R108-27 | 2-1546462-7 |
| ③ 8.515 | 26 | 4DB-R108-26 | 2-1546462-6 |
| ③ 8.190 | 25 | 4DB-R108-25 | 2-1546462-5 |
| ③ 7.865 | 24 | 4DB-R108-24 | 2-1546462-4 |
| ③ 7.540 | 23 | 4DB-R108-23 | 1-1437668-7 |
| ③ 7.215 | 22 | 4DB-R108-22 | 2-1546462-2 |
| ③ 6.890 | 21 | 4DB-R108-21 | 2-1546462-1 |
| ③ 6.565 | 20 | 4DB-R108-20 | 7-1437667-8 |
| ③ 6.240 | 19 | 4DB-R108-19 | 1-1546462-9 |
| ③ 5.915 | 18 | 4DB-R108-18 | 1-1546462-8 |
| ③ 5.590 | 17 | 4DB-R108-17 | 1-1546462-7 |
| ③ 5.265 | 16 | 4DB-R108-16 | 1-1546462-6 |
| ③ 4.940 | 15 | 4DB-R108-15 | 7-1437667-7 |
| 4.615 | 14 | 4DB-R108-14 | 1-1546462-4 |
| 4.290 | 13 | 4DB-R108-13 | 1-1546462-3 |
| 3.965 | 12 | 4DB-R108-12 | 1-1546462-2 |
| 3.640 | 11 | 4DB-R108-11 | 1-1546462-1 |
| 3.315 | 10 | 4DB-R108-10 | 1-1546462-0 |
| 2.990 | 9 | 4DB-R108-09 | 1546462-9 |
| 2.665 | 8 | 4DB-R108-08-085 | 7-1437667-6 |
| 2.665 | 8 | 4DB-R108-08 | 1546462-8 |
| 2.340 | 7 | 4DB-R108-07 | 1546462-7 |
| 2.015 | 6 | 4DB-R108-06 | 7-1437667-5 |
| 1.690 | 5 | 4DB-R108-05 | 7-1437667-4 |
| 1.365 | 4 | 4DB-R108-04 | 7-1437667-3 |
| 1.040 | 3 | 4DB-R108-03 | 7-1437667-2 |
| ③ .715 | 2 | 4DB-R108-02-107 | 3-1546462-1 |
| .715 | 2 | 4DB-R108-02 | 7-1437667-1 |

SEE FIGURE

SEE FIGURE ③

THIS DRAWING IS A CONTROLLED DOCUMENT.

| DIMENSIONS: | TOLERANCES UNLESS OTHERWISE SPECIFIED: |
|-------------|--|
| INCHES | |
| 0 PLC | ± - |
| 1 PLC | ± - |
| 2 PLC | ± .01 |
| 3 PLC | ± .005 |
| 4 PLC | ± - |
| ANGLES | ± 2° |

MATERIAL: -
 FINISH: -

DWN: S SCHLEGEL 1/21/03
 CHK: S YODER 1/21/03
 APVD: S YODER 1/21/03
 PRODUCT SPEC: -
 APPLICATION SPEC: -
 WEIGHT: -

STE TE Connectivity

NAME: 4DB SERIES R108 STYLE

SIZE: A3 CAGE CODE: 00779 DRAWING NO: C-7-1437667-1 RESTRICTED TO: -

CUSTOMER DRAWING SCALE: NTS SHEET: 1 OF 1 REV: B3

X-ON Electronics

Largest Supplier of Electrical and Electronic Components

Click to view similar products for [Barrier Terminal Blocks](#) category:

Click to view products by [TE Connectivity](#) manufacturer:

Other Similar products are found below :

[CR151D20104](#) [670A-RZ-15-KT20](#) [6C1N03](#) [6PCR-02](#) [6PCR-02-008](#) [6PCR-05-008](#) [6PCR-08-008](#) [6PCR-09-008](#) [6PCR-13-006](#) [6PCR-15-006](#) [6PCR-21-006](#) [6PCV-06-008](#) [6PCV-06-716](#) [6PCV-09-001](#) [6PCV-10-009](#) [6PCV-15-008](#) [6PCV-17-1206](#) [6PCV-20-323](#) [6PCV-20-720](#) [6PCV-30-006](#) [6STR-06-006](#) [6STR-08-006](#) [6STR-12-008](#) [6STR-13-006](#) [6STR-14-008](#) [6STR-16-008](#) [6STR-17-008](#) [6STR-21-008](#) [6STR-25-008](#) [6STR-27-008](#) [6STV-03-006](#) [6STV-03-008](#) [6STV-04-006](#) [6STV-09-006](#) [6STV-10-006](#) [6WWR-03-693](#) [6WWV-12-008](#) [72212603](#) [72504-C-50](#) [72506-C](#) [72507-C-50](#) [73203](#) [75505-C](#) [75505-C-50](#) [75510-C](#) [77010-50](#) [7C1N08](#) [812-GP-3/4ST-09](#) [8-1437402-5](#) [8-1437402-7](#)