

THIS DRAWING IS UNPUBLISHED.

RELEASED FOR PUBLICATION

ALL RIGHTS RESERVED.

© COPYRIGHT - By -

MATERIAL:
 HOUSING: THERMOPLASTIC PA, UL94V-0, BLACK.
 TERMINALS: BRIGHT TIN PLATE, COPPER ALLOY.
 SCREWS: 6-32, STEEL, ZINC PLATED AND CLEAR CHROMATE.

ELECTRICAL:
 UL CLASS C: 20A, 150V.
 UL CLASS D: 10A, 300V.
 CSA TYPE B: 20A, 300V.
 CSA TYPE C: 20A, 300V.
 CSA TYPE D: 10A, 300V.
 CSA TYPE E: 20A, 300V.
 WIRE RANGE: 12-22 AWG.

MECHANICAL:
 OPERATING TEMP.: -40°C TO +105°C.
 RECOMMENDED TIGHTENING TORQUE: 7 IN-LBS.

- ① TRIMMED TO LENGTH.
- ② PRELIMINARY PART NUMBER.
- ③ OBSOLETE PARTS.

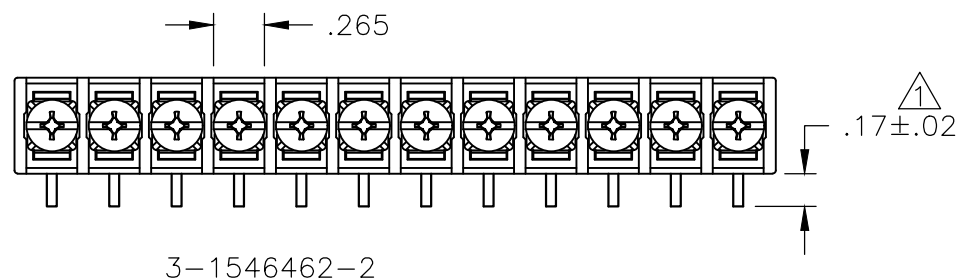
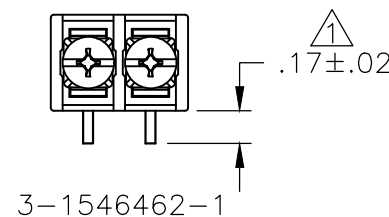
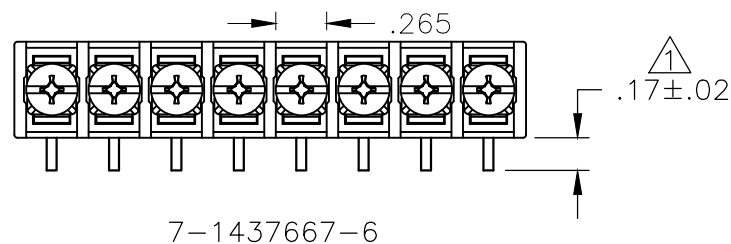
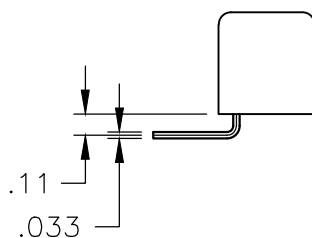
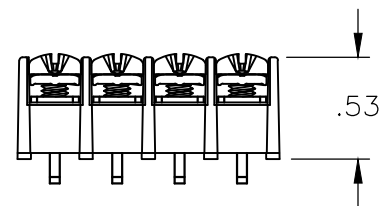
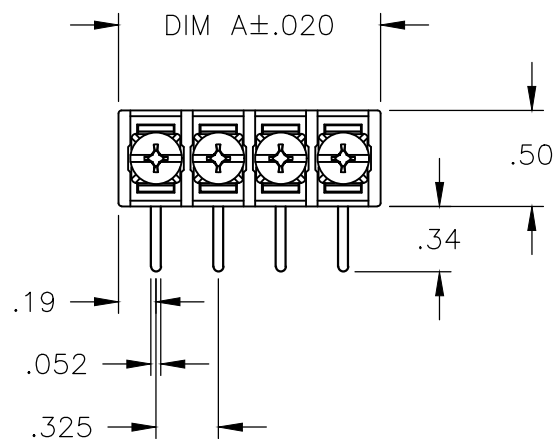

REVISIONS					
P	LTR	DESCRIPTION	DATE	DWN	APVD
	B3	P/N 3-1546462-2 ADDED.	02APR2018	RK	PS

①	②	DIM A	NO OF POS	CATALOG NUMBER	PART NUMBER
①	②	3.965	12	4DB-R108-12-SPCL	3-1546462-2
③		9.815	30	4DB-R108-30	3-1546462-0
③		9.490	29	4DB-R108-29	2-1546462-9
③		9.165	28	4DB-R108-28	2-1546462-8
③		8.840	27	4DB-R108-27	2-1546462-7
③		8.515	26	4DB-R108-26	2-1546462-6
③		8.190	25	4DB-R108-25	2-1546462-5
③		7.865	24	4DB-R108-24	2-1546462-4
③		7.540	23	4DB-R108-23	1-1437668-7
③		7.215	22	4DB-R108-22	2-1546462-2
③		6.890	21	4DB-R108-21	2-1546462-1
③		6.565	20	4DB-R108-20	7-1437667-8
③		6.240	19	4DB-R108-19	1-1546462-9
③		5.915	18	4DB-R108-18	1-1546462-8
③		5.590	17	4DB-R108-17	1-1546462-7
③		5.265	16	4DB-R108-16	1-1546462-6
③		4.940	15	4DB-R108-15	7-1437667-7
		4.615	14	4DB-R108-14	1-1546462-4
		4.290	13	4DB-R108-13	1-1546462-3
		3.965	12	4DB-R108-12	1-1546462-2
		3.640	11	4DB-R108-11	1-1546462-1
		3.315	10	4DB-R108-10	1-1546462-0
		2.990	9	4DB-R108-09	1546462-9
		2.665	8	4DB-R108-08-085	7-1437667-6
		2.665	8	4DB-R108-08	1546462-8
		2.340	7	4DB-R108-07	1546462-7
		2.015	6	4DB-R108-06	7-1437667-5
		1.690	5	4DB-R108-05	7-1437667-4
		1.365	4	4DB-R108-04	7-1437667-3
		1.040	3	4DB-R108-03	7-1437667-2
		.715	2	4DB-R108-02-107	3-1546462-1
		.715	2	4DB-R108-02	7-1437667-1

SEE FIGURE

SEE FIGURE ③

THIS DRAWING IS A CONTROLLED DOCUMENT.

DIMENSIONS:	TOLERANCES UNLESS OTHERWISE SPECIFIED:
INCHES	
0 PLC	± -
1 PLC	± -
2 PLC	± .01
3 PLC	± .005
4 PLC	± -
ANGLES	± 2'

MATERIAL: -
 FINISH: -

DWN	S SCHLEGEL	1/21/03
CHK	S YODER	1/21/03
APVD	S YODER	1/21/03
PRODUCT SPEC	-	-
APPLICATION SPEC	-	-
WEIGHT	-	-

STE TE Connectivity

NAME: 4DB SERIES R108 STYLE

SIZE: A3 CAGE CODE: 00779 DRAWING NO: C-7-1437667-1 RESTRICTED TO: -

CUSTOMER DRAWING SCALE: NTS SHEET: 1 OF 1 REV: B3

X-ON Electronics

Largest Supplier of Electrical and Electronic Components

Click to view similar products for [Barrier Terminal Blocks](#) category:

Click to view products by [TE Connectivity](#) manufacturer:

Other Similar products are found below :

[CR151D20104](#) [670A-RZ-15-KT20](#) [6C1N03](#) [6PCR-02](#) [6PCR-02-008](#) [6PCR-05-008](#) [6PCR-08-008](#) [6PCR-09-008](#) [6PCR-13-006](#) [6PCR-15-006](#) [6PCR-21-006](#) [6PCV-06-008](#) [6PCV-06-716](#) [6PCV-09-001](#) [6PCV-10-009](#) [6PCV-15-008](#) [6PCV-17-1206](#) [6PCV-20-323](#) [6PCV-30-006](#) [6STR-06-006](#) [6STR-08-006](#) [6STR-12-008](#) [6STR-13-006](#) [6STR-14-008](#) [6STR-16-008](#) [6STR-17-008](#) [6STR-21-008](#) [6STR-25-008](#) [6STR-27-008](#) [6STV-03-006](#) [6STV-03-008](#) [6STV-04-006](#) [6STV-09-006](#) [6STV-10-006](#) [6WWR-03-693](#) [6WWV-12-008](#) [6WWV-16-008](#) [72212603](#) [72504-C-50](#) [72506-C](#) [72507-C-50](#) [73203](#) [75505-C](#) [75505-C-50](#) [75510-C](#) [77010-50](#) [7C1N08](#) [812-GP-3/4ST-09](#) [8-1437402-5](#) [8-1437402-7](#)