

- 1 MOLDDED PARTS: FLAME RETARDANT, 94V-0 RATED, GLASS FILLED NYLON OR POLYESTER, BLACK
CONTACTS: BRASS
HARDWARE: BRASS
- 2 CONTACTS: SEE TABLE
INSERTS: UNPLATED
SCREWLOCKS: NICKEL PLATED
- 3 REFER TO APPLICATION SPEC FOR RECOMMENDED P.C. BOARD MOUNTING DIMENSIONS FOR AUTOMATIC INSERTION.
- 4 GOLD FLASH ON THE MATING SURFACES, .000100 MIN TIN OR TIN-LEAD PLATE ON THE SOLDER END, .000050 MIN NICKEL UNDERPLATE ON THE ENTIRE CONTACT.
- 5 .000030 MIN GOLD PLATE ON THE MATING SURFACES, .000100 MIN TIN OR TIN-LEAD PLATE ON THE SOLDER END, .000050 MIN NICKEL UNDERPLATE ON THE ENTIRE CONTACT.
-OR-
GOLD FLASH OVER PALLADIUM- NICKEL PLATE, .000030 MIN TOTAL ON THE MATING SURFACES, .000100 MIN TIN OR TIN-LEAD PLATE ON THE SOLDER END, .000050 MIN NICKEL UNDERPLATE ON THE ENTIRE CONTACT.

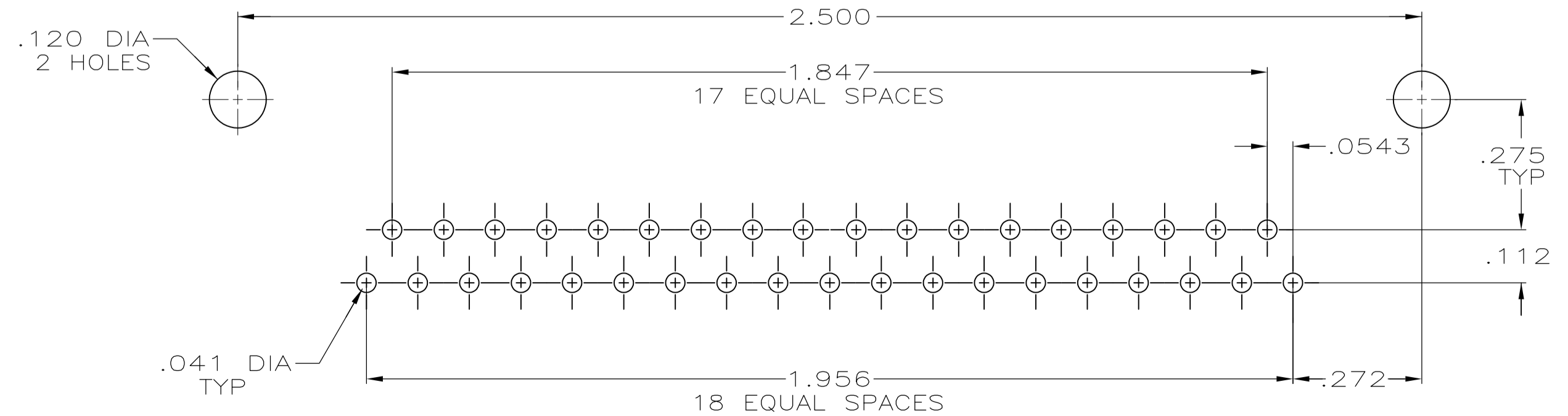
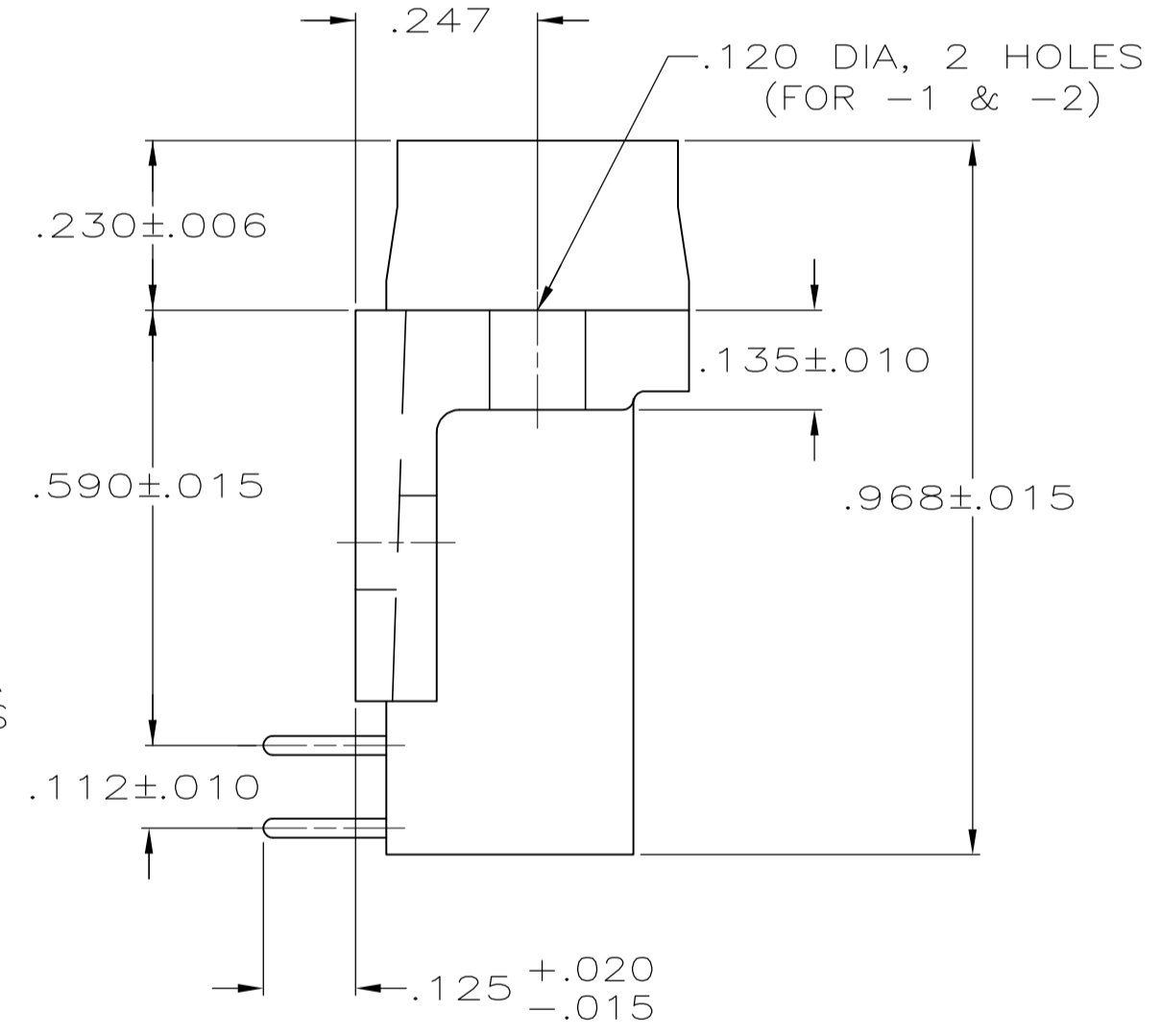
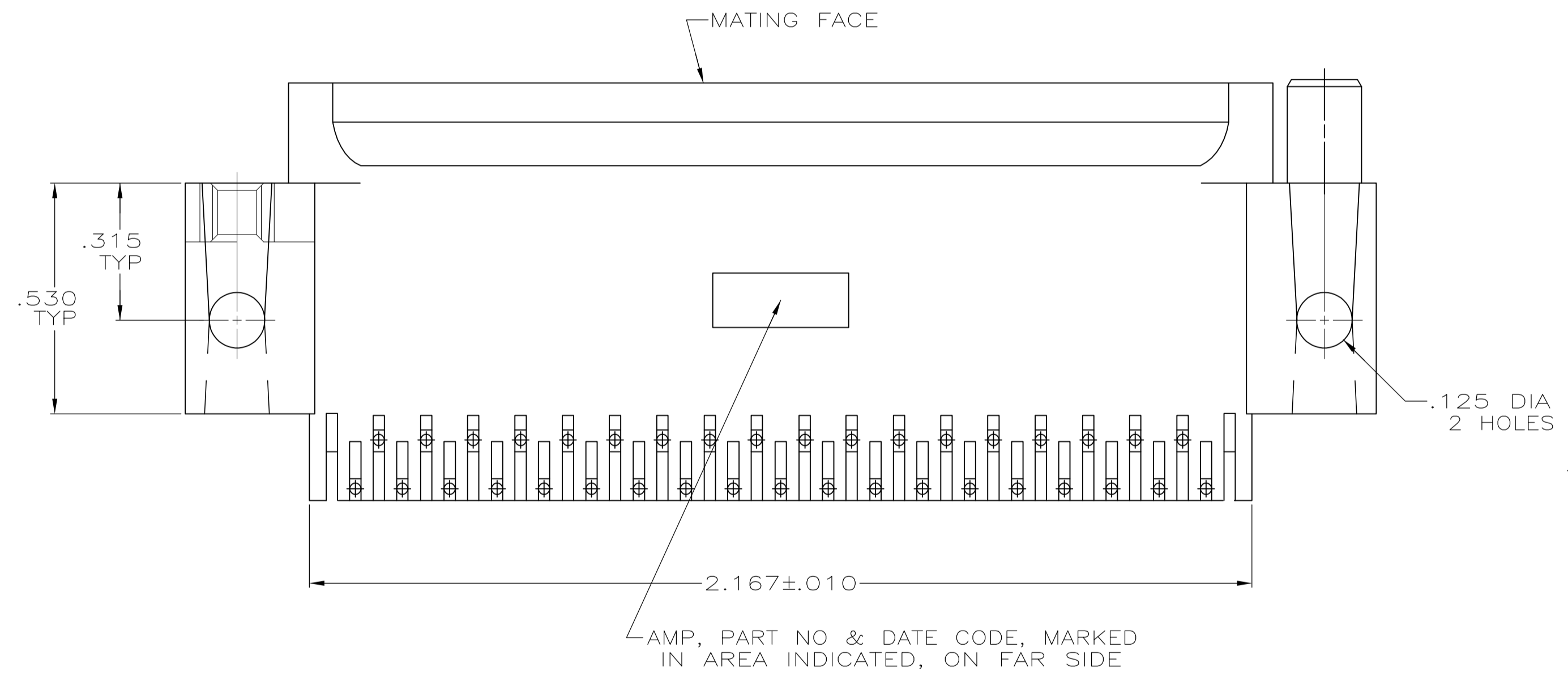

RECOMMENDED P.C. BOARD MOUNTING DIMENSIONS 3

OBSELETE	WITH SCREWLOCKS	5	747470 -6
OBSELETE	WITH SCREWLOCKS	4	747470 -5
OBSELETE	WITH INSERTS	5	747470 -4
OBSELETE	WITH INSERTS	4	747470 -3
	WITH .120 DIA HOLE	5	747470 -2
SUPSD BY 747470-2	WITH .120 DIA HOLE	4	747470 -1
	REMARKS	FINISH	PART NUMBER

THIS DRAWING IS A CONTROLLED DOCUMENT.		DIN	7-29-87	C RICHARD	
DIMENSIONS: INCHES		CHK	8-3-87	S WELDON	
TOLERANCES UNLESS OTHERWISE SPECIFIED:		APVD	8-3-87	B TAYLOR	
0 PLC ± -		NAME	PLUG ASSY, SIZE 4, 37 POSN, RIGHT ANGLE, .590 SERIES, .026 DIA POSTS, AMPLIMITE® HD-20		
1 PLC ± -		PRODUCT SPEC	108-40005		
2 PLC ± -		APPLICATION SPEC	114-40015		
3 PLC ± .005		SIZE	CAGE CODE	DRAWING NO	RESTRICTED TO
4 PLC ± - ± .2		WEIGHT	A1	00779	C=747470
MATERIAL	FINISH	CUSTOMER DRAWING	SCALE	SHEET	REV
1	2		4:1	1 OF 1	

X-ON Electronics

Largest Supplier of Electrical and Electronic Components

Click to view similar products for [D-Sub Standard Connectors](#) category:

Click to view products by [TE Connectivity](#) manufacturer:

Other Similar products are found below :

[56F711-015](#) [012-9507-004](#) [LV242999-142T12](#) [015-0341-000](#) [015-0372-005](#) [015-0372-008](#) [015-8755-001](#) [020419-0104](#) [012-0467-000](#) [012-0515-000](#) [012-9507-034](#) [012-9507-114](#) [020745-0008](#) [609-25P](#) [M24308/2-23Z](#) [CT2-14S-2PCA34](#) [CT2-18-11PCAU](#) [CT6-10SL-3SC](#) [CT6-10SL-4SC](#) [CT6-14S-2SC](#) [CT6E14SA7SC](#) [M83513/01-FC](#) [M83723/76W24619 L/C](#) [M85049/48-3-2F](#) [6STD09PCM99B70X](#) [6STD09SCM99B30X](#) [6STD09SCT99S40X](#) [6STD15PCT99S40X](#) [6STD15SCM99B30X](#) [6STD15SCT99S40X](#) [6STF09PCM05B70X](#) [7-135760-9](#) [MC11E-10-6SN](#) [747552-3](#) [MD1-21PS](#) [MDM-15SCBRM7-F222](#) [MDM96517-699](#) [MDM96521-744](#) [MDVB1-21SL1](#) [MIK0-1-7SH003](#) [MIKQ6-7SH076](#) [MIKQ7-7PH077](#) [MIKQ7-7PH11](#) [MIKQ7-7PH32](#) [MJSV-28SL61](#) [MKJ4A1F14-55S](#) [8-135760-3](#) [8STD09PCM99B30X](#) [PG-KV/PV-16-GROM-SEALING](#) [GDA15P](#)