

| LOC | | DIST | | REVISIONS | | | |
|-----|-----|---------------------------|---------|-----------|------|--|--|
| P | LTR | DESCRIPTION | DATE | DMN | APVD | | |
| B1 | | REVISED PER ECO-11-004835 | 11MAR11 | RK | HMR | | |

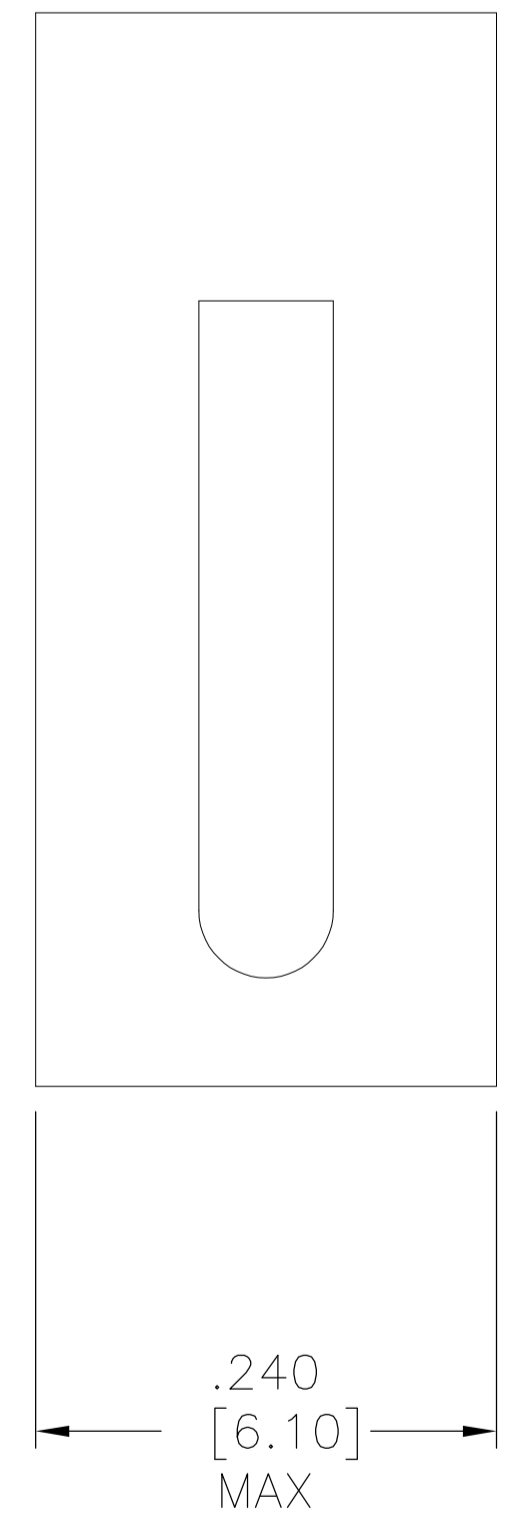
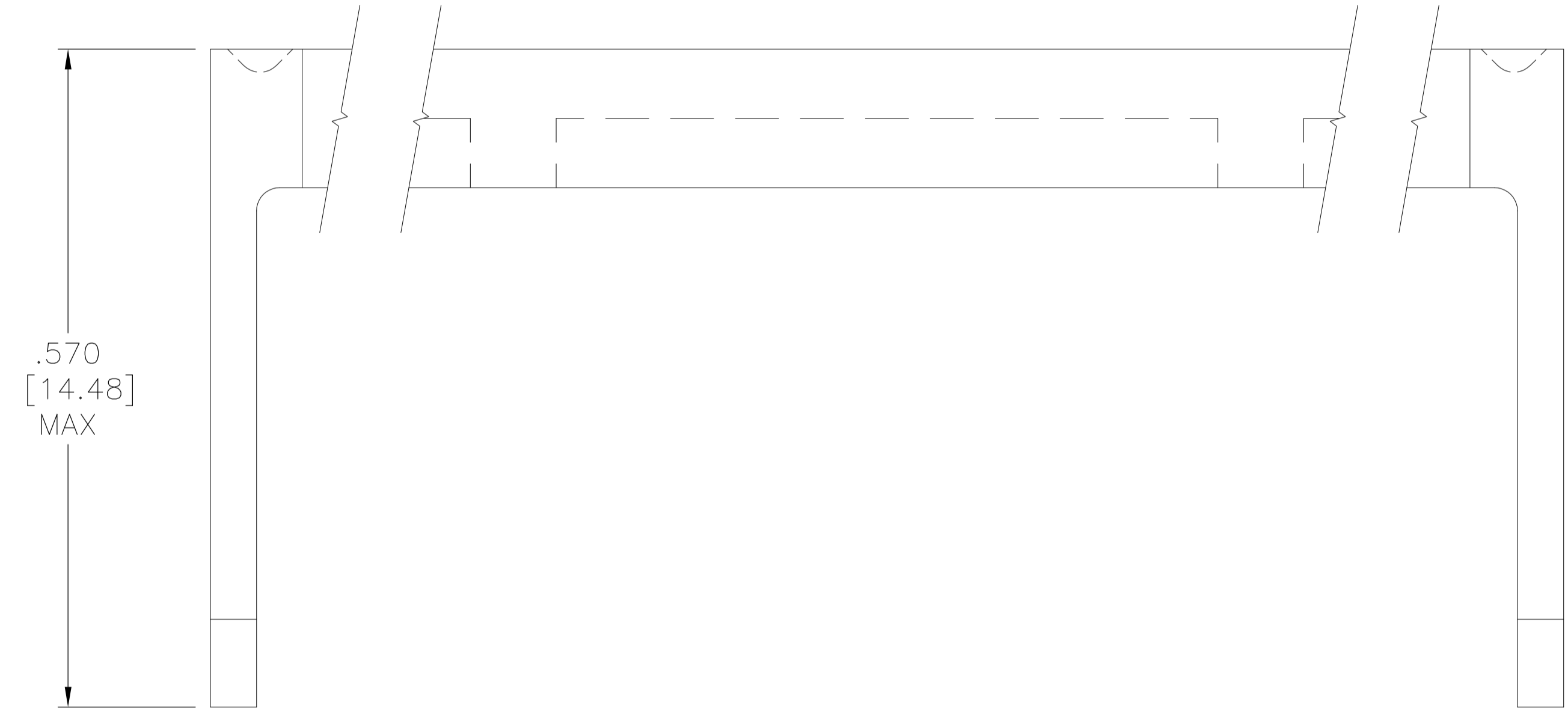
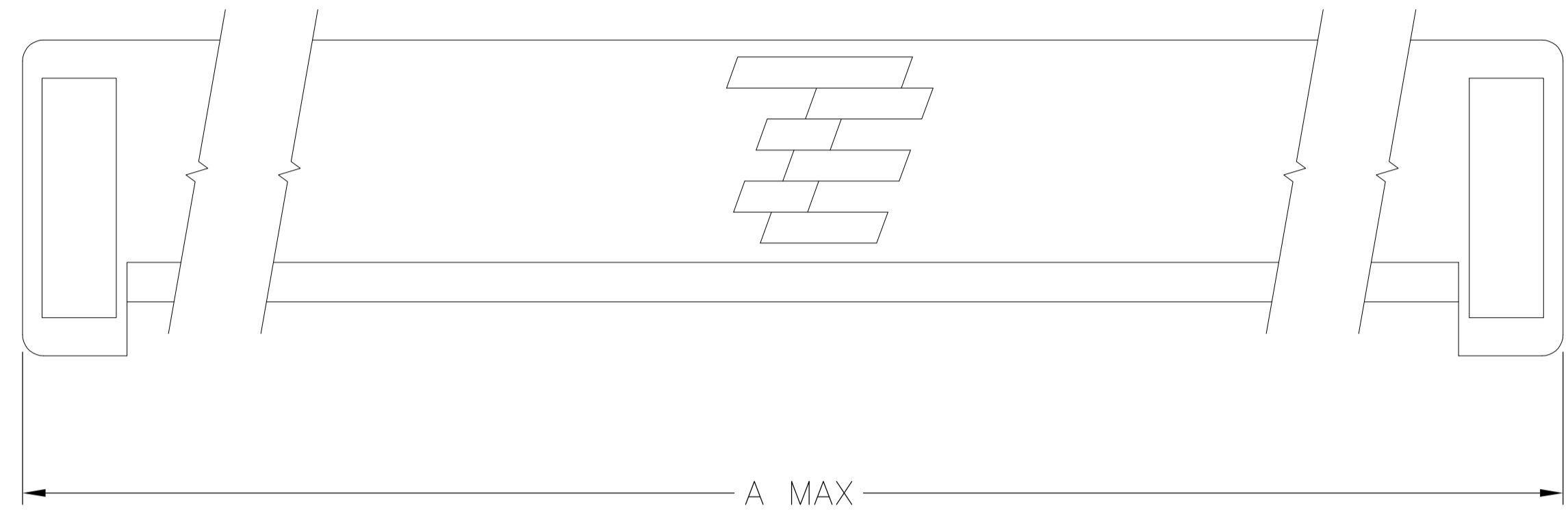

MATERIAL: GLASS REINFORCED THERMOPLASTIC RATED 94V-0.

2. COLOR: BLUE

| | | | | |
|------------------------------|----------|-------------------|----------------|-------------|
| 609-6431HD | 85.95 | (3.384) | 64 | 1-1437022-3 |
| 609-5031HD | 68.17 | (2.684) | 50 | 8-1437021-1 |
| 609-4031HD | 55.47 | (2.184) | 40 | 5-1437021-5 |
| 609-3431HD | 47.85 | (1.884) | 34 | 3-1437021-2 |
| 609-2631HD | 37.69 | (1.484) | 26 | 1-1437021-2 |
| 609-2031HD | 30.07 | (1.184) | 20 | 8-1437020-6 |
| 609-1631HD | 24.99 | (0.984) | 16 | 6-1437020-6 |
| 609-1431HD | 22.45 | (0.884) | 14 | 5-1437020-1 |
| 609-1031HD | 17.37 | (0.684) | 10 | 3-1437020-7 |
| T&B PART NO (REF) | A | NO OF POSN | PART NO | |

| | | | | |
|--|--|-----------------------------------|--|--|
| THIS DRAWING IS A CONTROLLED DOCUMENT. | | DIN W. DABULAS 3/25/83 | TE Connectivity | |
| DIMENSIONS: mm [INCHES] | | CHK: G. KLEMM 3/25/83 | NAME: HEAVY DUTY STRAIN RELIEF FEMALE SOCKET CONNECTOR | |
| TOLERANCES UNLESS OTHERWISE SPECIFIED: | | APVD: R.R. 3/31/83 | PRODUCT SPEC: - | |
| 0. PLC ± - | | APPLICATION SPEC: - | | |
| 1. PLC ± - | | SIZE: A1 | | |
| 2. PLC ± - | | CAGE CODE: 00779 | | |
| 3. PLC ± - | | DRAWING NO: 3-1437020-7 | | |
| 4. PLC ± - | | RESTRICTED TO: - | | |
| ANGLES ± - | | WEIGHT: - | | |
| FINISH: - | | CUSTOMER DRAWING | | |
| 1 | | SCALE: 10:1 SHEET: 1 OF 1 REV: B1 | | |

X-ON Electronics

Largest Supplier of Electrical and Electronic Components

Click to view similar products for [Headers & Wire Housings](#) category:

Click to view products by [TE Connectivity](#) manufacturer:

Other Similar products are found below :

[892-18-020-10-001101](#) [58102-G61-06LF](#) [582553-1](#) [0009485154](#) [009176003701906](#) [0050291907](#) [LY20-4P-DT1-P1E-BR](#) [02.125.8002.8](#)
[609-3404](#) [61062-3](#) [61082-181009](#) [622-3653LF](#) [63453-116](#) [636-1030](#) [636-1427](#) [636-3427](#) [636-4007](#) [641938-9](#) [641991-4](#) [644827-2](#) [65817-](#)
[010LF](#) [65817-015LF](#) [65863-015LF](#) [66207-023LF](#) [67095-007LF](#) [67601157](#) [68645-018](#) [68648-049](#) [70.362.1628.0](#) [70-4210](#) [70-4226B](#) [70-](#)
[4853B](#) [707-5020](#) [707-5028](#) [71.350.2428.0](#) [71918-208LF](#) [71961-016LF](#) [733-134](#) [733-162](#) [754199-000](#) [760-3052](#) [79531-3000](#) [FCN-](#)
[360C032-B](#) [FCN-367T-T012/H](#) [FCN-723D010/2](#) [80.063.4001.1](#) [800-90-010-10-002000](#) [801-43-002-10-013000](#) [801-43-006-10-002000](#)
[801-93-011-10-001000](#)