

© 1962 BY AMP INCORPORATED. ALL RIGHTS RESERVED. AMP PRODUCTS COVERED BY PATENTS AND/OR PATENTS PENDING. APPROVED PER GOVT CONTRACT NO.

REVISIONS

SYM	DESCRIPTION	DATE	APPD
0	RELEASED, WAS CUST. 5168-790	m.s. 5-27-8	JK
0-1	REVISED 2217	m.s. 9-26-67	JK
0 ₂	.031±.016 WAS .031, TOL. BLOCA ±.005 ECI 1797	72 1-1-77	PAW
A	F.I.L. & D.S. ADA171	JRS 11-21-67	B
B	06-1 ECI 0034-92	8-93	RHC

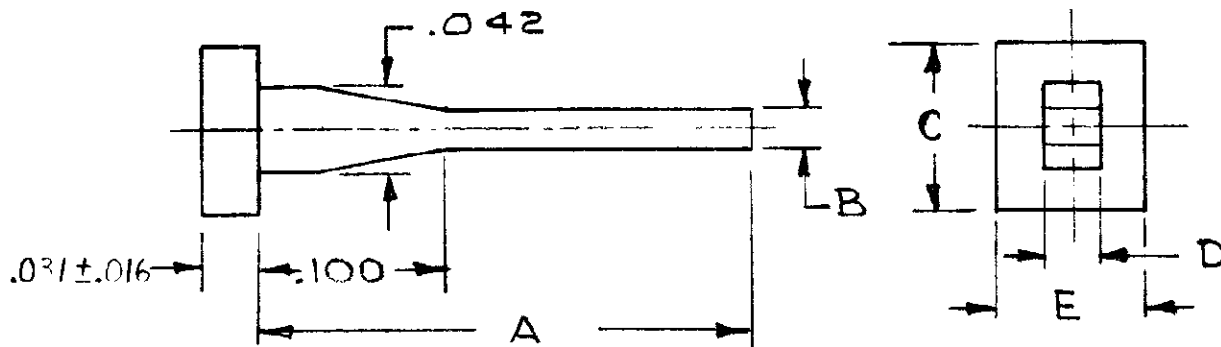

OBSOLETE

MOD. I	86181-2	.360	.025	.140	.070	.090
MOD. III	86181-1	.265	.020	.090	.030	.080
KEY FOR	PART NO.	A	B	C	D	E

AMP INFO

LOC	REV
AD	B/39

UNLESS OTHERWISE SPECIFIED

DIMENSIONS ARE IN INCHES TOLERANCES ON

FRACTIONS	DECIMALS	ANGLES
$\pm \frac{1}{16}$	$\pm .005$	$\pm \frac{1}{2}$

MATERIAL
NYLON

HEAT TREAT
—H—

COLOR
NATURAL

SIGNATURE	DATE
DR <i>Rumold</i>	5-6-67
DSGN ENGR <i>C. Snyder</i>	5/28/67
APPD <i>W. Freese</i>	5-31-67

AMP AMP INCORPORATED
HARRISBURG, PENNSYLVANIA

NAME
KEYING PLUG

DSGN APPD	OTHER APPD
-----------	------------

CODE IDENT NO	SIZE	NUMBER
00779	A	86181
SCALE 10-1	WT	CALC ACTUAL SHEET

X-ON Electronics

Largest Supplier of Electrical and Electronic Components

Click to view similar products for [Headers & Wire Housings](#) category:

Click to view products by [TE Connectivity](#) manufacturer:

Other Similar products are found below :

[892-18-020-10-001101](#) [58102-G61-06LF](#) [582553-1](#) [0009485154](#) [009176003701906](#) [0050291907](#) [LY20-4P-DT1-P1E-BR](#) [02.125.8002.8](#)
[609-3404](#) [61062-3](#) [61082-181009](#) [622-3653LF](#) [63453-116](#) [636-1030](#) [636-1427](#) [636-3427](#) [636-4007](#) [641938-9](#) [641991-4](#) [644827-2](#) [65817-010LF](#) [65817-015LF](#) [65863-015LF](#) [66207-023LF](#) [67095-007LF](#) [67601157](#) [68645-018](#) [68648-049](#) [70.362.1628.0](#) [70-4210](#) [70-4226B](#) [70-4853B](#) [707-5020](#) [707-5028](#) [71.350.2428.0](#) [71918-208LF](#) [71961-016LF](#) [733-134](#) [733-162](#) [754199-000](#) [760-3052](#) [787-8014-00](#) [79531-3000](#)
[FCN-360C032-B](#) [FCN-367T-T012/H](#) [FCN-723D010/2](#) [80.063.4001.1](#) [800-90-001-10-001000](#) [800-90-010-10-002000](#) [801-43-002-10-013000](#)