

A 88061-24-31

REVISIONS			
REV	DESCRIPTION	DATE	APPROVED
A	REVISED PER E.O. C2099	6-28-95	Ⓟ

PROPERTY OF DEUTSCH E.C.D.
 This drawing contains proprietary information that shall not be disclosed, duplicated, or used in whole or in part for any purpose other than to evaluate this drawing.

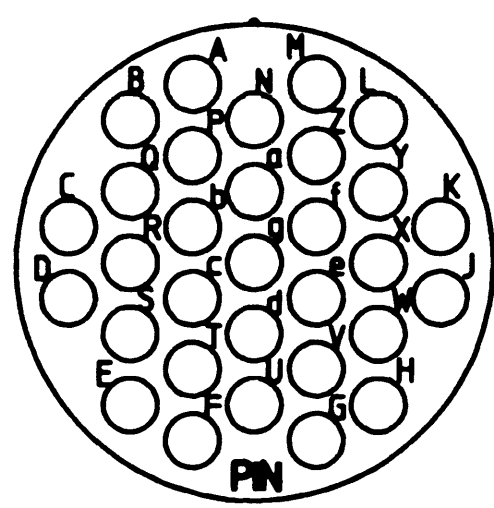

GROMMET
PIN SIDE

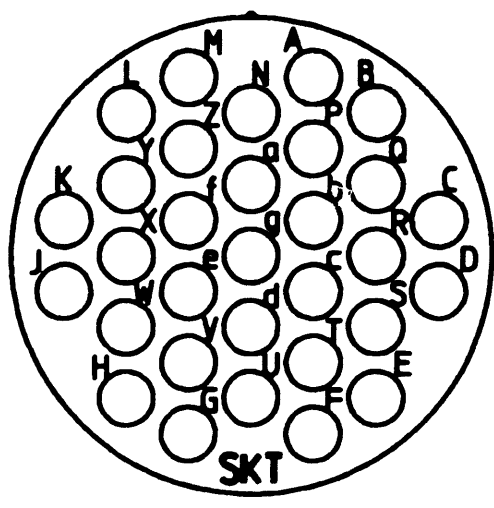

GROMMET
SOCKET SIDE

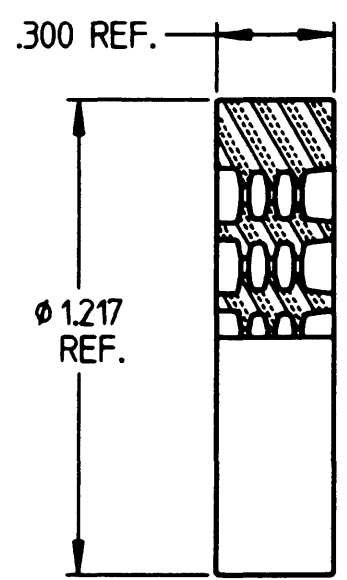

SECONDARY GROMMET
WTA10-24-03

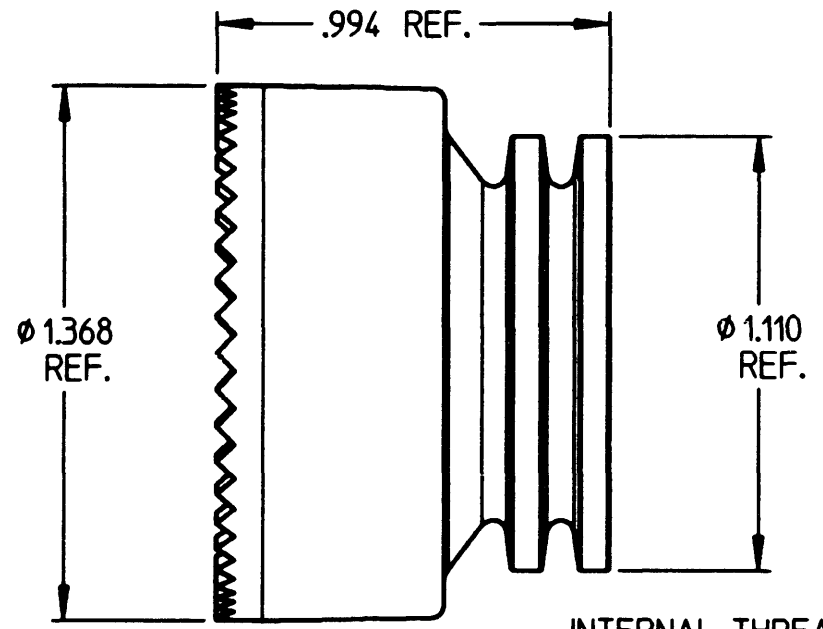

FOLLOWER
WTA10-24-02/22

INTERNAL THREAD
1.4375-18 UNEF 2B

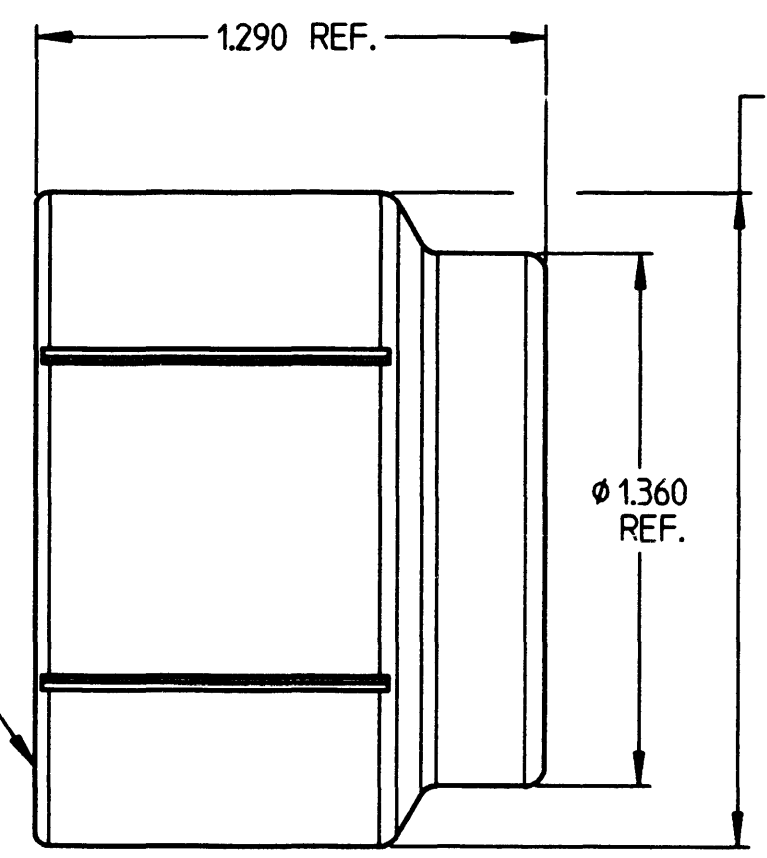

COUPLING NUT
WTA10-24-01/22

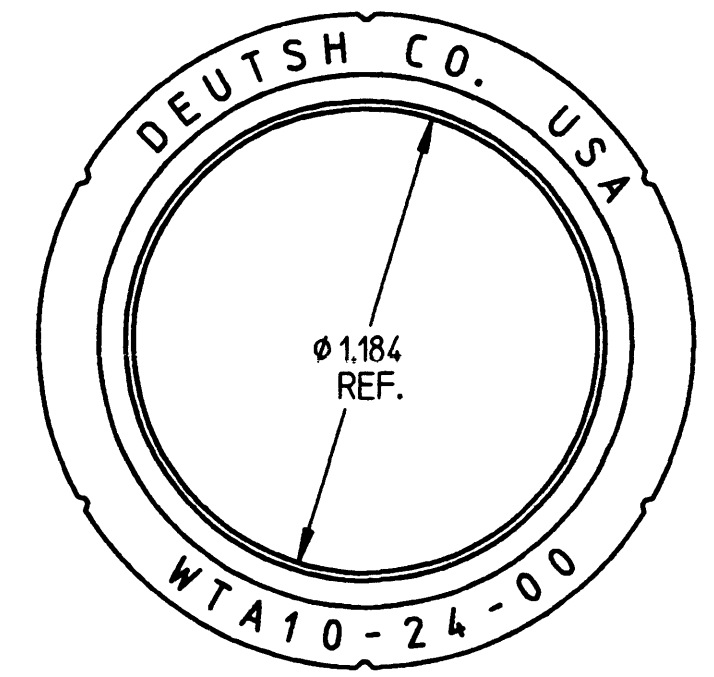

6. EXACT POSITION OF CAVITY IDENTIFICATION OR PART NUMBER MAY VARY.
5. ALL COMPONENT PARTS SHOWN (-01/22, -02/22, -03) ARE INCLUDED IN ALLISON TOP LEVEL P/N: WTA10-24-00/22.
4. ARRANGEMENT OF SECONDARY GROMMET IS 24-31 PER MIL-STD-1669 AND IS REVERSIBLE DEPENDING ON PIN OR SOCKET ARRANGEMENT.
3. BACKSHELL IS FOR 0.874 I.D. / 1.129 O.D. SPLIT CONVOLUTED TUBING.
2. PARTS ARE SHIPPED LOOSE.
1. ALL DIMENSIONS ARE IN INCHES.

SIGNATURE & DATE	
DR	R. GROSS 3-16-94
CHK	B. J. H. 4/24/94
FE	R. Gross 3-16-94
APPD	
SCALE	NONE WT

BACKSHELL SYSTEM
ALLISON WTA10-24-00/22
 SIZE 24
 FOR 22 MM SPLIT CONVOLUTED TUBING
 WITH 24-31 ARR. SECONDARY GROMMET
 ENVELOPE

CP	MATL CODE
DEUTSCH ENGINEERED CONNECTING DEVICES	
36033 Whittier Ave. Hemet, California	
B	88061-24-31
DWG SIZE	CODE 1139 SHEET 1 OF 1

88061-24-31 ENV_A

X-ON Electronics

Largest Supplier of Electrical and Electronic Components

Click to view similar products for [Circular MIL Spec Backshells](#) category:

Click to view products by [TE Connectivity](#) manufacturer:

Other Similar products are found below :

[60-036152-022](#) [610HS012M15](#) [M28840/504WA](#) [M28840/805WB](#) [M28840/809WA](#) [M28840/815WA](#) [M28840/816WA](#) [627AS017M14](#)
[627MA124M14S](#) [655HS002NF11](#) [CW3899-000](#) [M85049/10-134S](#) [M85049/10-17S](#) [M85049/10-33S](#) [M85049/10-94W](#) [M85049/11-28N](#)
[M85049/11-37N](#) [M85049/11-53N](#) [M85049/11-63N](#) [M85049/120-14W](#) [M85049/124-23W](#) [M85049/1720N04B](#) [M85049/1821W05C](#)
[M85049/1825W06C](#) [M85049/1919N05](#) [M85049/23-74W](#) [M85049/24-71N](#) [M85049/25-47N](#) [M85049/25-94W](#) [M85049/27S12N](#) [M85049/39-](#)
[11S](#) [M85049/39-17S](#) [M85049/39-9S](#) [M85049/6-10B](#) [M85049/6-19N](#) [M85049/6-20B](#) [M85049/77-20W04](#) [M85049/78-11N03](#) [M85049/78-](#)
[15W02](#) [M85049/78-17N04](#) [M85049/78-19N05](#) [M85049/79-19N07](#) [M85049/79-25N04](#) [M85049/82-18N02](#) [M85049/82-22P02](#) [M85049/83-](#)
[10W03](#) [M85049/84-20N03](#) [M85049/8-48N](#) [M85049/85-24N01](#) [M85049/85-24P01](#)