

THIS DRAWING IS UNPUBLISHED. RELEASED FOR PUBLICATION
 © COPYRIGHT 20 BY TYCO ELECTRONICS CORPORATION. ALL RIGHTS RESERVED.

LOC	DIST	REVISIONS			
P	LTR	DESCRIPTION	DATE	DWN	APVD
F	00	A	MODIFICATION FENETRE	22-FEB-99	JLQ -
		B	RENFORT A LA BASE DU PION	26-JUL-00	SI -
		C	ADD NEW P/N 953302-3	08-MAR-07	NT, N J.L

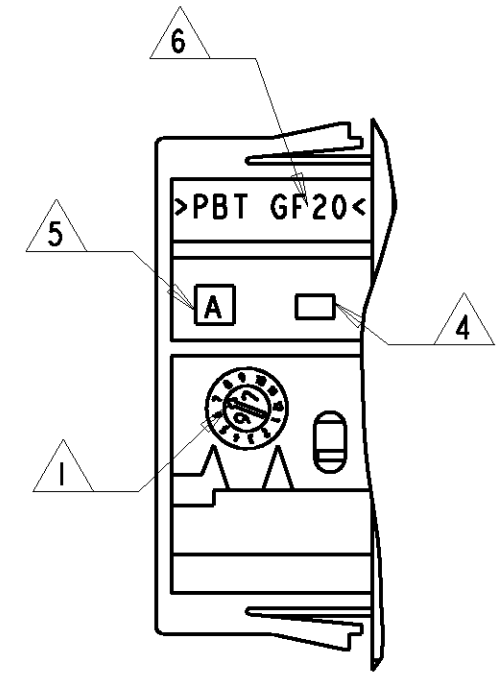
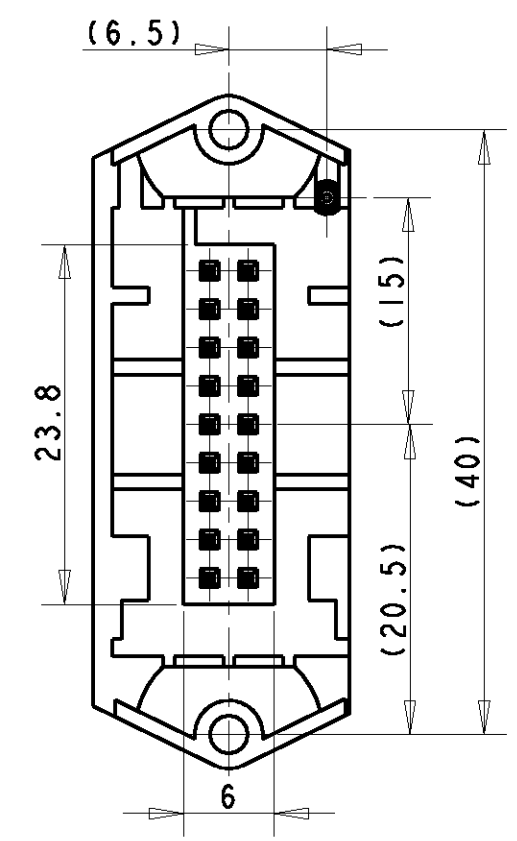
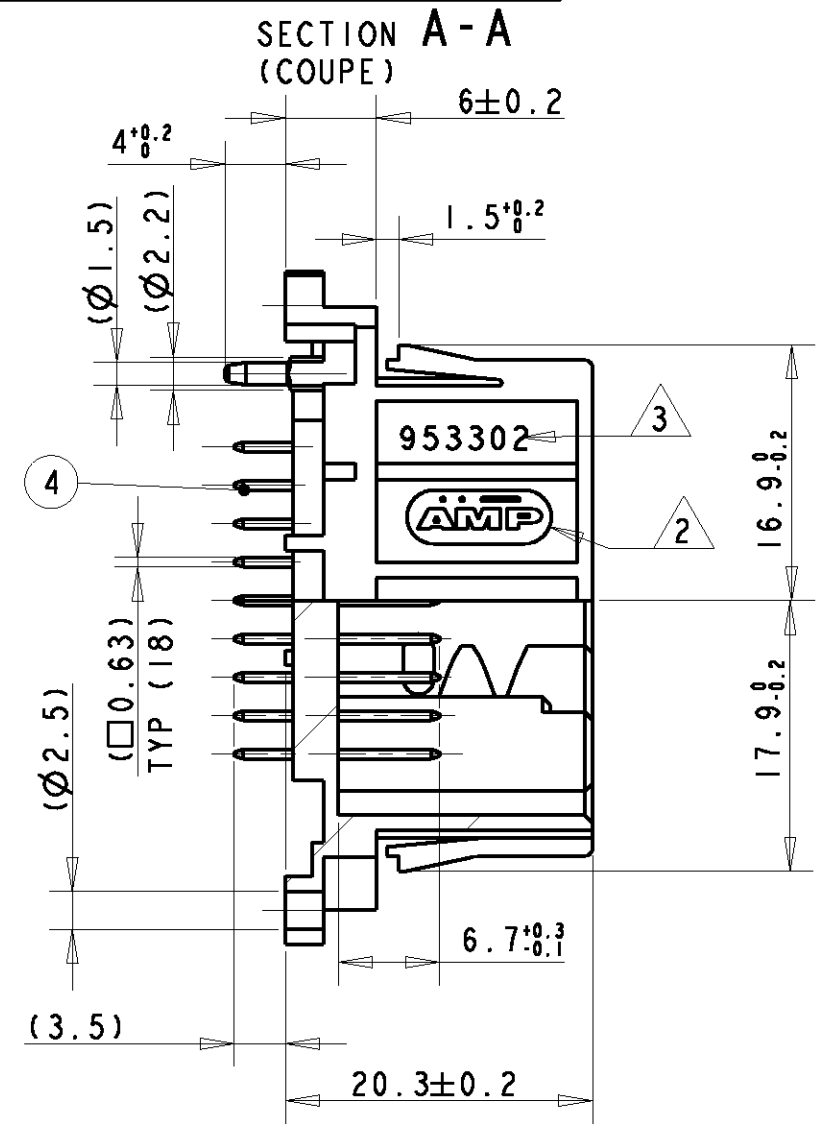
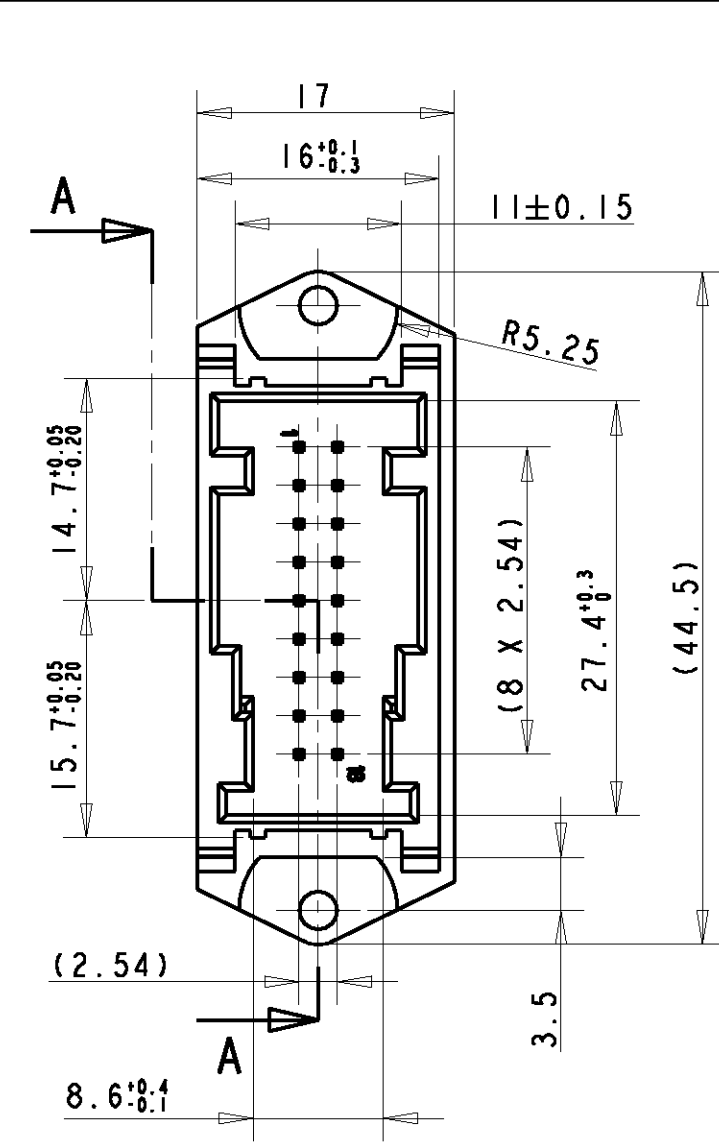

RECOMMANDATION IMPLANTATION CI / RECOMMENDED PCB DETAILS
 VUE DE DESSUS / VIEW FROM TOP

EPAISSEUR CI / PCB THICKNESS : 1.6±0.15

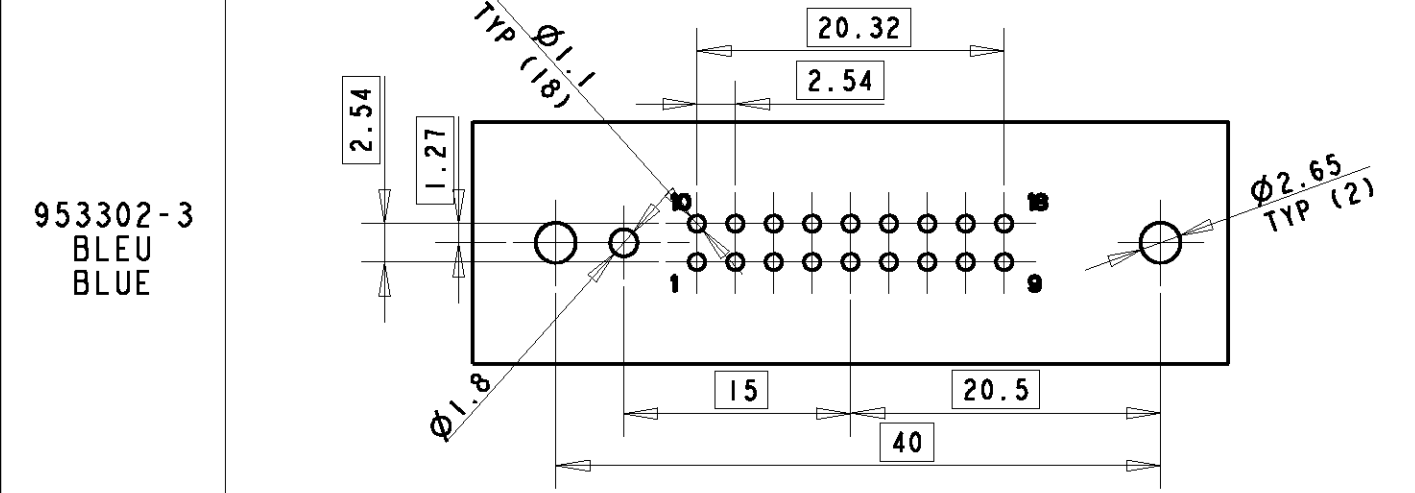
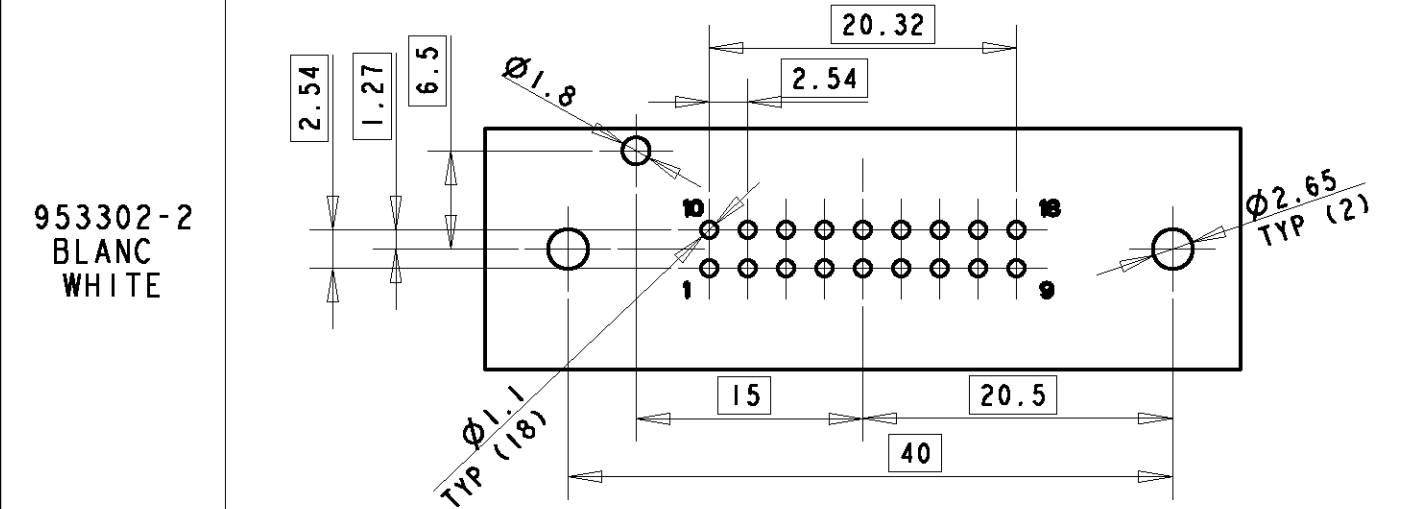
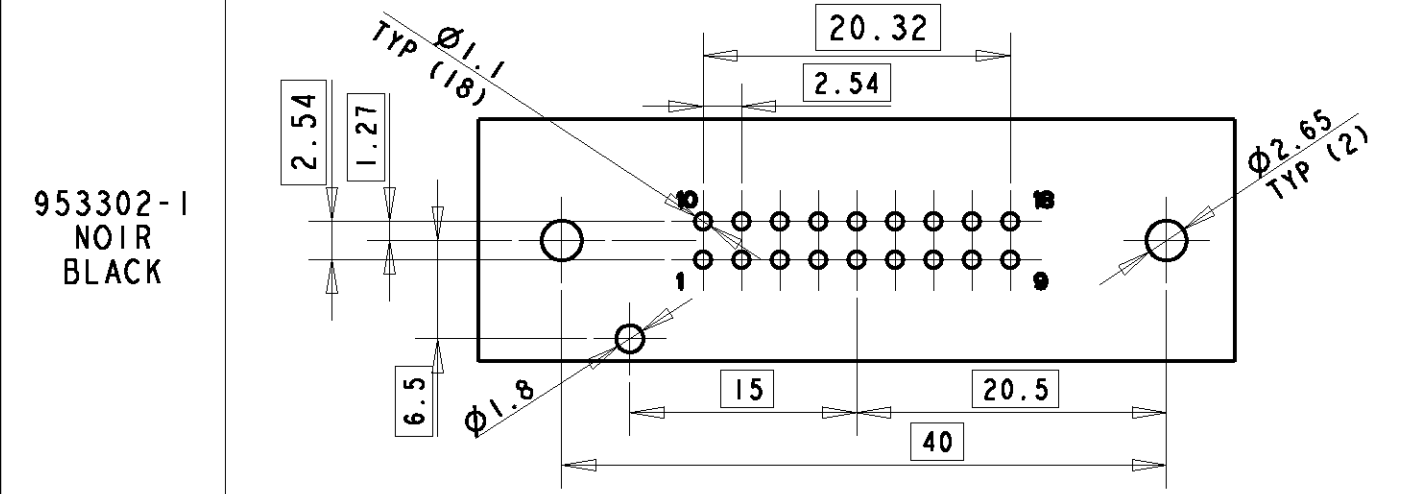

DETROMPAGE / CODING
 ECHELLE / SCALE 1:1

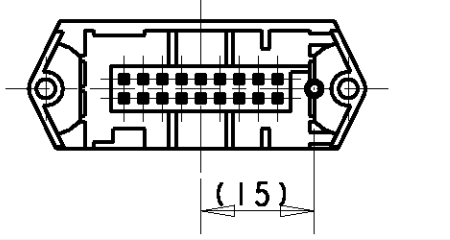
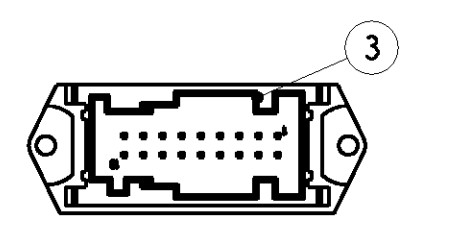
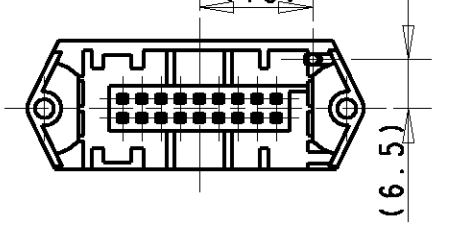
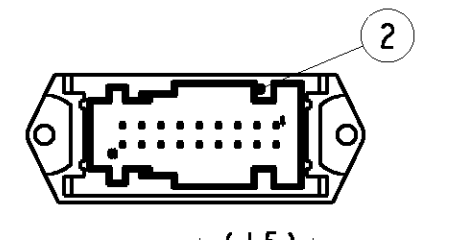
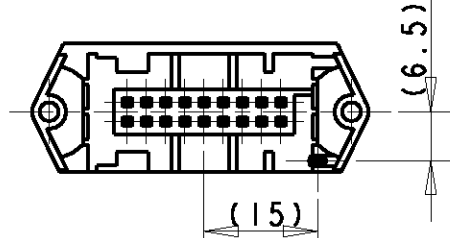
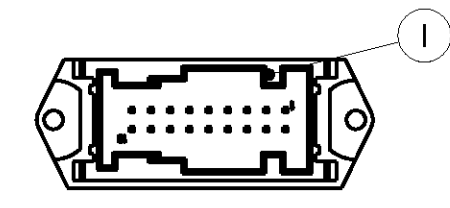

NOTES

- 1 DATE CODE
Date code
- 2 AMP LOGO
Logo d'AMP
- 3 ASSY PART NUMBER
Référence du produit assemblé
- 4 CAVITY MARKING
N° d'empreinte du moule
- 5 REVISION STATUS
Révision du moule
- 6 MATERIAL REFERENCE
Matière

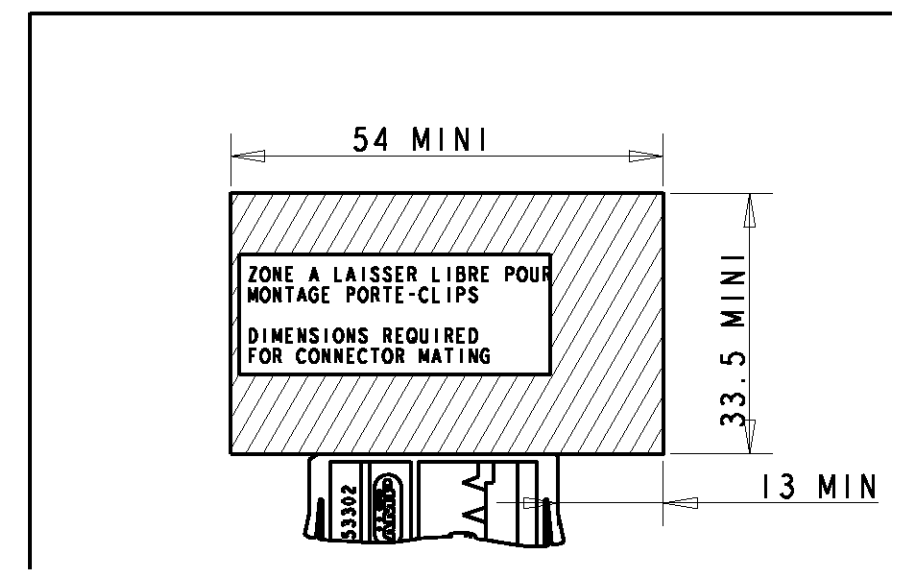

REF / ASSY P/N	QTY (Qté)	MATERIAL (Matière)	DESIGNATION	COLOR (Couleur)	ITEM
953302-1	18	CuSn6	MQS CONTACT	BLEU / BLUE	④
953302-2	18	PBT GF20	BOITIER / HOUSING	BLANC / WHITE	②
953302-3	18	PBT GF20	BOITIER / HOUSING	NOIR / BLACK	①

DIMENSIONS: mm		TOLERANCES UNLESS OTHERWISE SPECIFIED:	
SEE TABLE		PLC	±0.3
SEE TABLE		PLC	±0.3
SEE TABLE		PLC	±0.3
SEE TABLE		PLC	±0.3
SEE TABLE		ANGLES	±5°
SEE TABLE		FINISH	

DWN	J. LAQUERBE	30-OCT-97	Tyco Electronics France SAS 95300 Pontoise, France	
CHK	J. LAQUERBE	25-MAR-99		
APVD	D. MUYL	25-MAR-99		
PRODUCT SPEC	108-15146		NAME	18 WAY MQS STRAIGHT HEADER WITH EARS
APPLICATION SPEC			EMBASE 18 V MQS DROITE AVEC OREILLES	
WEIGHT	5g		SIZE	A2
CUSTOMER DRAWING	SCALE 2:1		CAGE CODE	00779
	SHEET 1 OF 1		DRAWING NO	C-953302
	REV C		RESTRICTED TO	

X-ON Electronics

Largest Supplier of Electrical and Electronic Components

Click to view similar products for [Automotive Connectors](#) category:

Click to view products by [TE Connectivity](#) manufacturer:

Other Similar products are found below :

[003-018-000](#) [60403001](#) [60993906-B](#) [M902-2131](#) [M902-2161](#) [72.330.1035.1](#) [73.353.4028.0](#) [F119300-B](#) [F166900](#) [F258300-B](#) [F358300-B](#)
[F407400](#) [F444110](#) [F487000](#) [F509500B-B](#) [827153-1](#) [8N1515-32-24P](#) [9-1326729-8](#) [925474-1](#) [928905-1](#) [964562-4](#) [968782-1](#) [GT17SA-8DS-](#)
[HU](#) [98891-1012](#) [98947-1016](#) [12004147](#) [12004475-L](#) [12010290](#) [12010309-B](#) [12015454](#) [12020219-B](#) [12020308](#) [12041318-B](#) [12052225-L](#)
[12052466](#) [12059125](#) [12064869](#) [12004327-B](#) [12010503-B](#) [12015308](#) [12015384](#) [12015909](#) [1-21030-1](#) [12041254](#) [12041318](#) [12047946-B](#)
[12047957](#) [12047957-L](#) [12059473](#) [12066261](#)