

NOTES:

1. ALL DIMENSIONS ARE IN INCHES [MILLIMETERS] [GRAMS] LBS

2. DIMENSIONS APPEARING IN TABLE ARE AS FOLLOWS:

a AS SUPPLIED
b AFTER UNRESTRICTED RECOVERY

3. COATING (ADHESIVE) IS OPTIONAL AS SUPPLIED DIMENSIONS APPEARING IN TABLE ARE FOR UNCOATED PARTS.

DIAMETERS WILL BE REDUCED BY .06 MAX. WHEN COATING IS ADDED, ENTRY MOLDING PORTS ARE OPTIONAL.

4. WHEN -00 MODIFICATION NUMBER IS SPECIFIED MOLDING PORTS WILL BE LOCATED AS SHOWN.

ON SIZES 222A111 AND 222A121 THE 0.18 INCH DIAMETER MOLDING PORT AT "T" WILL BE ELIMINATED. THE 0.12" DIA MOLDING PORT WILL BE ENLARGED TO 0.18 INCHES

5. WEIGHT SHOWN IN TABLE OF DIMENSIONS IS BASED ON POLYOLEFIN PART

6. ORDERING INFORMATION

222A1XX -XX -XX /XXX /0

BASE PART NUMBER

MATERIAL DASH NUMBER

-3 POLYOLEFIN, SEMI RIGID (RT-301)

-4 POLYOLEFIN, FLEXIBLE (RT-1304)

-5 ELASTOMER, FLEXIBLE (RT-501)

-6 SILICONE (RT-602)

-12 FLUORO ELASTOMER, FLEXIBLE (RT-1312)

-25 ELASTOMER, FLUID RESISTANT (RW-2070)

-100 POLYOLEFIN, SEMI-FLEXIBLE ZEROHAL (RT-1323)

MODIFICATION NUMBER

ADHESIVE SLASH NUMBER

SEE COMPATIBILITY CHART BELOW

COLOR DESIGNATOR

IF THIS DOCUMENT IS PRINTED IT BECOMES UNCONTROLLED. CHECK FOR THE LATEST REVISION.

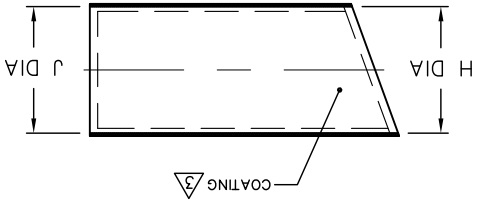

AS SUPPLIED

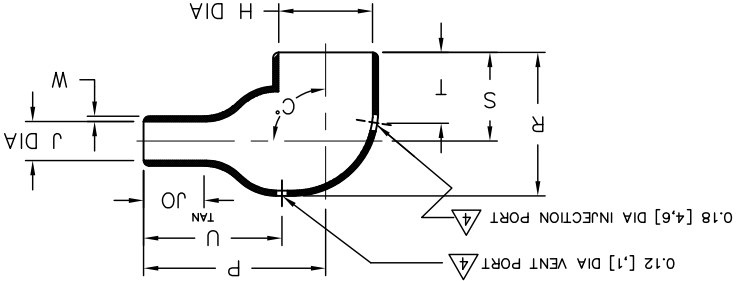

AFTER UNRESTRICTED RECOVERY

TABLE OF DIMENSIONS

PART DESCRIPTION	H		J		P	R	S	T	U	JO	W	C.	WEIGHT REF
	MIN	MAX	MIN	MAX									
222A111	.70	.31	.17	.79	.61	.79	.45	N/A	.17	.04	.12	.04	.002
222A121	.98	.40	.21	.84	.21	.84	.58	N/A	.23	.05	.13	.05	[1.36]
222A132	1.18	.56	.81	1.06	1.05	1.05	.73	.75	.70	.28	.15	.06	[2.72]
222A142	1.28	.68	.90	1.27	1.44	1.20	.81	.75	.98	.40	.18	.07	[6.35]
222A152	1.42	.86	1.04	1.33	1.72	1.38	.90	.75	1.18	.50	.07	.09	[8.62]
222A163	1.43	.98	1.08	1.73	1.73	1.38	.90	.75	1.34	.68	.08	.08	[13.15]
222A174	2.09	1.33	1.84	2.09	2.98	2.08	1.34	1.00	2.10	1.26	.13	.07	[34.93]
222A185	2.66	1.74	2.66	2.66	3.84	2.60	1.66	1.00	2.80	1.60	.15	.14	[64.86]
222A196	3.45	2.18	3.45	2.48	5.04	3.12	1.93	1.00	3.45	2.22	.18	.10	[140.6]

CUSTOMER DRAWING

Raychem Molded Parts
305 Constitution Dr
Menlo Park, CA 94025



DRAWN YUNGUEN
APPROVED DHURRELL



TE CONNECTIVITY RESERVES THE RIGHT TO PRODUCT FOR THEIR APPLICATION.
SHOULD THIS DRAWING AT THE USERS PRODUCTION.
THIRD ANGLE
SIZE B
CODE IDENT. NO. 06090
DWG. NO. 222A111thru196

TITLE BOOT, 90 DEGREE, THIN WALL

REVISIONS	
LTR	DESCRIPTION
V	REVISED PER ECO-15-010088
	DATE 07/01/15

X-ON Electronics

Largest Supplier of Electrical and Electronic Components

Click to view similar products for [Heat Shrink Cable Boots & End Caps](#) category:

Click to view products by [TE Connectivity](#) manufacturer:

Other Similar products are found below :

[577159N001](#) [007758-000](#) [610368N003](#) [645494-000](#) [M85049/141-02HU](#) [M85049/141-03HU](#) [M85049/141-04HU](#) [687025-000](#) [705331-000](#)
[718446-000](#) [725666N001](#) [729257-000](#) [F21914-000](#) [F27131-000](#) [F85868-000](#) [770-006A103R](#) [770-006A304W1](#) [770-006A305W1](#) [770-](#)
[006A308W1](#) [770-011T303W1](#) [770-011T304W1](#) [770-020S702W1](#) [770-020S704W1](#) [806138-000](#) [806542N001](#) [807507-000](#) [808059-000](#)
[808296-000](#) [808362-000](#) [808828-000](#) [809125-000](#) [809130-000](#) [809218-000](#) [811218-000](#) [811288-000](#) [812014-000](#) [812047-000](#) [813166-000](#)
[813767N002](#) [814417-000](#) [819115N001](#) [819117N001](#) [823026-000](#) [823070-000](#) [825002-000](#) [841189N001](#) [861471-000](#) [866647-000](#) [937577-](#)
[000](#) [950764-000](#)