

Receptacle Contacts

**Technical Features**

**Material**

Contact: CuNiSi  
Pin Contact: Copper-Alloy  
Cantilever Spring: Stainless Steel

**Contact Finish:**

Tin plated, silver plated,  
gold plated

**Conductor Binding:**

Crimp Technology/  
Insulation Displacement

**Wire Size Range:**

0.14–0.75 mm<sup>2</sup>  
Single Wires (FLR)

**Current Carrying Capacity:**

Up to 7.5 A at 80 °C

**Temperature Range:**

–40 °C ... +120 °C (tin plated)  
–40 °C ... +130 °C (silver plated)  
–40 °C ... +140 °C (gold plated)

**Centerline:**

2.54 x 2.54 mm Standard  
4.0 x 4.0 mm SWS Standard  
4.0 x 3.5 mm SWS Staggered

**Mating Cycles:**

20 tin plated  
20 silver plated  
100 gold plated

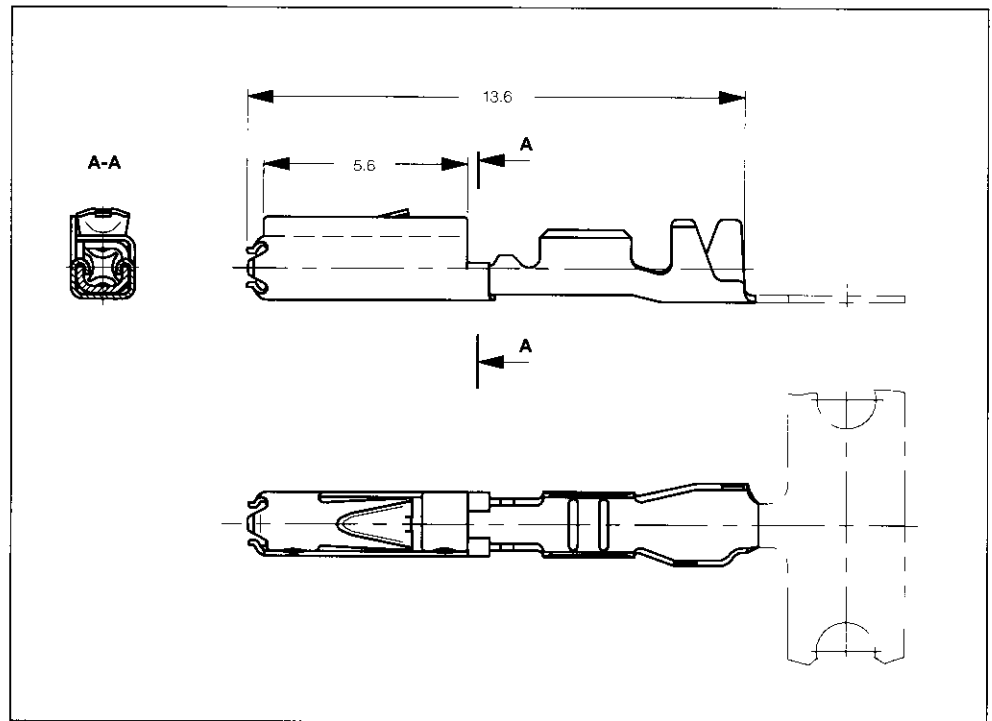

**Special Applications:**

Inmoldable Pin Contact,  
Insulation Displacement Recep-  
tacle Contact,  
Receptacle Contact with Short  
Circuit Area

**Table Drawings:**

929454 (Receptacle Contact)  
929453 (Pin Contact)

**Product Specification:**

108-18030

**Application Specification:**

114-18021 Standard  
114-18025 Single Wire Sealing  
System

**Standard Receptacle Contacts**

Wire Size Range (mm <sup>2</sup> )	Insulation Diameter		Material and Finish	Part Numbers				Applicator	Hand Tool 539635-1 with Die Set
	FLK (mm)	FLR (mm)		Strip Form	Packaging Unit	Loose-Piece	Packaging Unit		
0.14–0.22	–	0.9–1.2	tin plated	1355717-1	13,000	1355718-1	500	541695	–
			gold plated	1355717-5	13,000	1355718-5	500		
0.2–0.5	–	0.9–1.6	tin plated	928999-1	13,000	963726-1	1,000	878439	539682-2
			gold plated	928999-5	13,000	963726-5	1,000		
			silver plated	928999-6	13,000	963726-6	1,000		
0.50–0.75	–	1.6–1.9	tin plated	963715-1	10,000	963729-1	500	878591	539682-2
			gold plated	963715-5	10,000	963729-5	500		
			silver plated	963715-6	10,000	963729-6	500		

**Single Wire Sealing System**

Wire Size Range (mm <sup>2</sup> )	Insulation Diameter		Material and Finish	Part Numbers				Applicator	Hand Tool 539635-1 with Die Set
	FLK (mm)	FLR (mm)		Strip Form	Packaging Unit	Loose-Piece	Packaging Unit		
0.2–0.5	–	0.9–1.6	tin plated	962885-1	9,000	963727-1	500	878553	539685-2
			gold plated	962885-5	9,000	963727-5	500		
			silver plated	962885-6	9,000	963727-6	500		
0.50–0.75	–	1.6–1.9	tin plated	965906-1	9,000	965907-1	500	878799	539685-2
			gold plated	965906-5	9,000	965907-5	500		
			silver plated	965906-6	9,000	965907-6	500		

## X-ON Electronics

Largest Supplier of Electrical and Electronic Components

*Click to view similar products for [Automotive Connectors](#) category:*

*Click to view products by [TE Connectivity](#) manufacturer:*

Other Similar products are found below :

[003-018-000](#) [60403001](#) [60993906-B](#) [M902-2131](#) [M902-2161](#) [M902-2344](#) [72.330.1035.1](#) [73.353.4028.0](#) [F119300-B](#) [F166900](#) [F258300-B](#)  
[F358300-B](#) [F407400](#) [F444110](#) [F487000](#) [F509500B-B](#) [827153-1](#) [8N1515-32-24P](#) [9-1326729-8](#) [925474-1](#) [928905-1](#) [964562-4](#) [968782-1](#)  
[GT17SA-8DS-HU](#) [98891-1012](#) [98947-1016](#) [12004147](#) [12004475-L](#) [12010290](#) [12010309-B](#) [12015454](#) [12020219-B](#) [12041318-B](#) [12052225-](#)  
[L](#) [12052466](#) [12064869](#) [12004327-B](#) [12015308](#) [12015384](#) [12015909](#) [1-21030-1](#) [12041254](#) [12041318](#) [12047946-B](#) [12047957](#) [12047957-L](#)  
[12059473](#) [12066261](#) [12110546](#) [12110546-B](#)