

NOTES:

- 1 BRAID TERMINATION RING (RAYCHEM PART NUMBER TR04A1) IS SUPPLIED LOOSE WITH ADAPTER. RING IS DESIGNED TO BE INSTALLED BY RESISTIVE ELECTRICAL HEATING AND IS MARKED WITH THERMOCHROMIC PAINT WHICH CHANGES COLOR WHEN INSTALLATION TEMPERATURE IS REACHED.
- 2. TEMPERATURE RATING FOR ALUMINUM ALLOY IS -65° TO +150°C.
- 3. PART SHALL BE PERMANENTLY MARKED WITH PART NUMBER PER MIL-STD-130.
- 4. PLATING IS CADMIUM PER QQ-P-416 TYPE II CLASS 3 OVER ELECTROLESS NICKEL PER MIL-C-26074 CLASS 3 OR 4 GRADE B (500 HOUR SALT SPRAY RESISTANT FINISH).
- 6. ALL CORNERS SHALL BE ROUNDED.
- 7. THIS PART IS DESIGNED TO TERMINATE A BRAIDED CABLE SHIELD AND A HEAT SHRINKABLE BOOT TO A CONNECTOR.
- 8 RING SHALL NOT BE MARKED.
- 9 PART MATES WITH CONNECTOR MS3456W10S-2S.

REVISIONS				
ZONE	LTR	DESCRIPTION	DATE (YR-MO-DA)	APPROVED

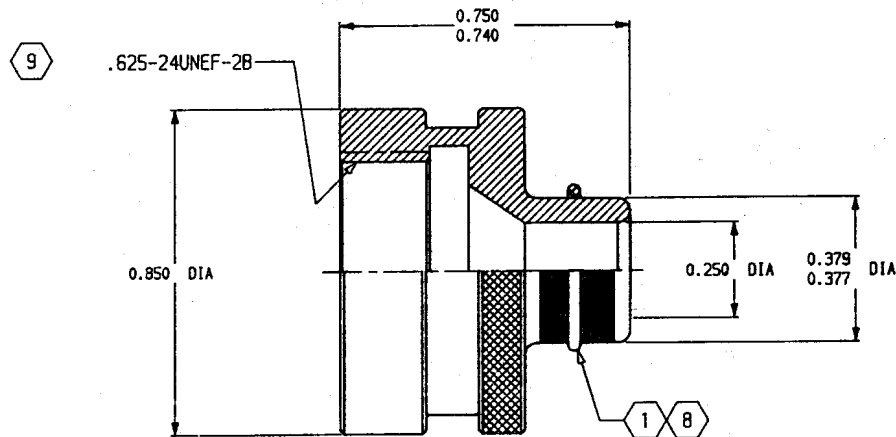

THIS DRAWING AND THE INFORMATION SET FORTH HEREON ARE THE PROPERTY OF RAYCHEM CORPORATION AND ARE TO BE HELD IN TRUST AND CONFIDENCE. PUBLICATION, DUPLICATION, DISCLOSURE, OR USE FOR ANY PURPOSE NOT EXPRESSLY AUTHORIZED IN WRITING BY RAYCHEM CORPORATION IS PROHIBITED.

MECHANICAL PROPERTIES	PMIC		UNLESS OTHERWISE SPECIFIED, DIMENSIONS ARE IN INCHES TOLERANCES ON 2 PLACE 3 PLACE ± 0.005	CONTRACT NUMBER		RAYCHEM CORPORATION 300 CONSTITUTION DRIVE MENLO PARK, CALIFORNIA 94025	
	YP			CONTRACTOR		ADAPTER, SHIELD TERMINATION	
TS		THIRD ANGLE PROJECTION	DRAWN BY	DATE (YR-MO-DA)	SIZE		
EL2			DO NOT SCALE THIS DRAWING	K. T.	89-03-02	C	06090
RA		NATI. ENGR	CHECKER	ENGINEER	SCALE	NONE	SHEET
SH			W.C. GAY	L. VONDRAN			
PH			DRAWING APPROVAL	DESIGN APPROVAL			
	NEXT ASSY	USED ON	W.C. GAY	3-3-89			
	APPLICATION						

4

3

2

1

X-ON Electronics

Largest Supplier of Electrical and Electronic Components

Click to view similar products for [Circular MIL Spec Strain Reliefs & Adapters](#) category:

Click to view products by [TE Connectivity](#) manufacturer:

Other Similar products are found below :

[896227-000](#) [899170S004](#) [0113-023-000](#) [6000-063-0022](#) [CS6624-000](#) [620AB038Z136](#) [620AS001Z108](#) [620AS038Z112](#) [620AS038Z120](#)
[620AS038Z132](#) [620FB038NF08](#) [620HA038NF09](#) [620HA038NF11](#) [620HA038NF13](#) [620HA038NF25](#) [620HB049NF17](#) [620HS038NF11](#)
[620HS038Z121](#) [620HS042XM19](#) [620HS042XM25](#) [620HS048B17](#) [620MS064NF12](#) [620MS065Z107](#) [620MS065ZNU06](#) [627-123NF21-11](#)
[627-125NF23-6](#) [630J041M06H](#) [630J041M20H](#) [637S010NF0212H](#) [637S010NF0416A](#) [640830-000](#) [659943-000](#) [66241-10A](#) [CW0597-000](#)
[CW0598-000](#) [CW0948-000](#) [CY0122-000](#) [M85049/41-6A W/B](#) [M85049/42-12DS](#) [M85049/47N8](#) [M85049/51-1-14S](#) [M85049/51S16S](#)
[M85049/60-1N16](#) [M85049/60-2G12W](#) [M85049/69-11N](#) [CZ3661-000](#) [D02922-000](#) [70.360.1628.0](#) [703797-000](#) [705825-000](#)