

NOTES

1. ALL DIMENSIONS ARE IN INCHES
[MILLIMETERS]
2. DIMENSIONS APPEARING IN TABLE ARE AS FOLLOWS:
a - AS SUPPLIED
b - AFTER UNRESTRICTED RECOVERY
3. COATING IS OPTIONAL. AS SUPPLIED DIMENSIONS APPEARING IN TABLE ARE FOR UNCOATED PARTS WHEN COATING IS ADDED, ENTRY DIAMETERS WILL BE REDUCED BY 0.06 MAX.

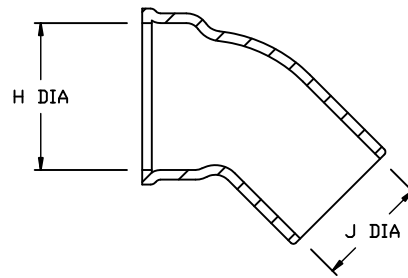

AS SUPPLIED

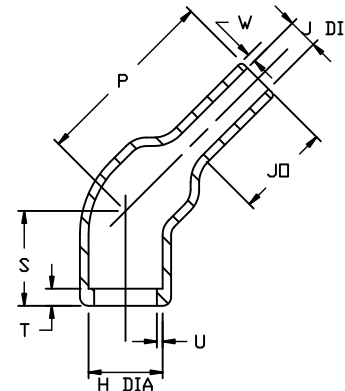

AFTER UNRESTRICTED RECOVERY

REVISIONS		
LTR	DESCRIPTION	DATE
A1	REVISED PER ECO-13-016159	10/11/2013

ORDERING INFORMATION

BASE PART NUMBER 245W0XX -X /XX -0

MATERIAL DASH NUMBER _____

-3 POLYOLEFIN, SEMI RIGID (RT-301)
-4 POLYOLEFIN, FLEXIBLE (RT-1304)
-12 FLUORO ELASTOMER, FLEXIBLE (RT-1312)
-25 ELASTOMER, FLUID RESISTANT (RW-2070)

ADHESIVE SLASH NUMBER _____
SEE COMPATIBILITY CHART BELOW

COLOR DESIGNATOR _____

PART DESCRIPTION	H		J		P	S	T	U	JO	W
	MIN	MAX	MIN	MAX	±10%	±10%	±10%	±10%	±10%	±20%
	a	b	a	b	b	b	b	b	b	b
245W032	.60 [15,4]	.55 [14,0]	.35 [8,8]	.23 [5,8]	1.15 [29,2]	.50 [12,7]	.12 [3,0]	.04 [1,0]	.67 [17,0]	.06 [1,5]
245W042	.88 [22,4]	.68 [17,3]	.61 [15,6]	.28 [7,1]	1.50 [38,1]	.50 [12,7]	.12 [3,0]	.04 [1,0]	.88 [22,4]	.07 [1,7]
245W053	1.16 [29,5]	.90 [22,8]	.89 [22,7]	.33 [8,5]	1.65 [41,9]	.50 [12,7]	.12 [3,0]	.05 [1,3]	.86 [21,8]	.08 [2,0]
245W063	1.44 [36,6]	1.11 [28,3]	1.17 [29,7]	.40 [10,1]	1.93 [49,0]	.50 [12,7]	.12 [3,0]	.07 [1,8]	.96 [24,4]	.09 [2,3]
245W074	1.72 [43,6]	1.35 [34,4]	1.45 [36,8]	.61 [15,6]	2.25 [57,2]	.50 [12,7]	.12 [3,0]	.07 [1,8]	1.00 [25,4]	.12 [3,0]

Raychem Molded Parts
CUSTOMER DRAWING

COMPATIBILITY CHART

MATERIAL DASH NO.	ADHESIVE (COATING) SLASH NUMBER	ADHESIVE (COATING) S NUMBER
-3	/42; /86	S-1017; S-1048
-4	/42; /86	S-1017; S-1048
-12	N/A	N/A
-25	/86; /225	S-1048; S-1206

UNLESS OTHERWISE SPECIFIED DIMENSIONS ARE METRIC AND INCHES ARE IN BRACKETS.
DECIMAL TOLERANCES
XXX ± 0.13 (.005)
XX ± 0.25 (.01)
X ± 0.50 (.10)
ANGLE TOLERANCE
.X ± 1 DEG.

DRAWN
M Mazariegos
10/17/11

APPROVED
D.Hurrell
10/17/11

RPN _____

CAD FILE:
245W0XX_CD

STE TE Connectivity

TITLE
45° BOOT (SPIN LOCK BOOT)

SIZE **B** CODE IDENT. NO. **06090** DWG. NO. **245W0XX**

THIRD ANGLE PROJECTION

© 2011-2013 Tyco Electronics Corporation. All rights reserved. DO NOT SCALE THIS DRAWING SHEET 1 OF 1

X-ON Electronics

Largest Supplier of Electrical and Electronic Components

Click to view similar products for [Heat Shrink Cable Boots & End Caps](#) category:

Click to view products by [TE Connectivity](#) manufacturer:

Other Similar products are found below :

[577159N001](#) [645494-000](#) [CX4132-000](#) [687025-000](#) [705331-000](#) [718446-000](#) [725666N001](#) [729257-000](#) [F27131-000](#) [F85868-000](#) [770-003S106W2](#) [770-013210W1](#) [770-013311](#) [770-013312](#) [806542N001](#) [807507-000](#) [808362-000](#) [808618-000](#) [809125-000](#) [809130-000](#) [809218-000](#) [812014-000](#) [812047-000](#) [813166-000](#) [813767N002](#) [814741-000](#) [819117N001](#) [823026-000](#) [823070-000](#) [841189N001](#) [861471-000](#) [866647-000](#) [879515-000](#) [937577-000](#) [957073-000](#) [982033-2](#) [A77813-000](#) [R280576000](#) [D96192-000](#) [163549-000](#) [EN3BOOTLKIT](#) [MTPSRBCL-C](#) [1954015-1](#) [200W531-3-0](#) [202A163-4-0-CS5067](#) [202A343-3-00-0](#) [202B221-13-0](#) [202B231-13-0](#) [202B563-25-07-0](#) [202C241-13-0](#)