

202D211-100 to 202D299-100

a) Part as supplied

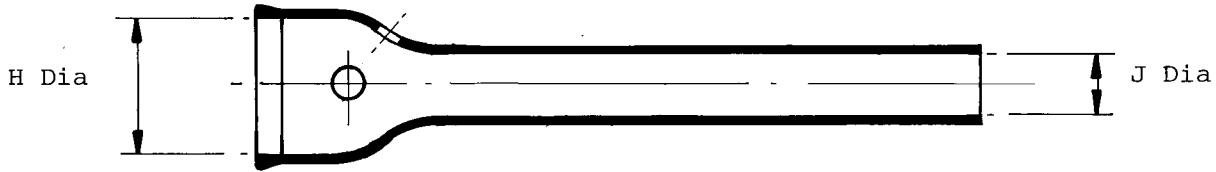

b) Part after unrestricted recovery

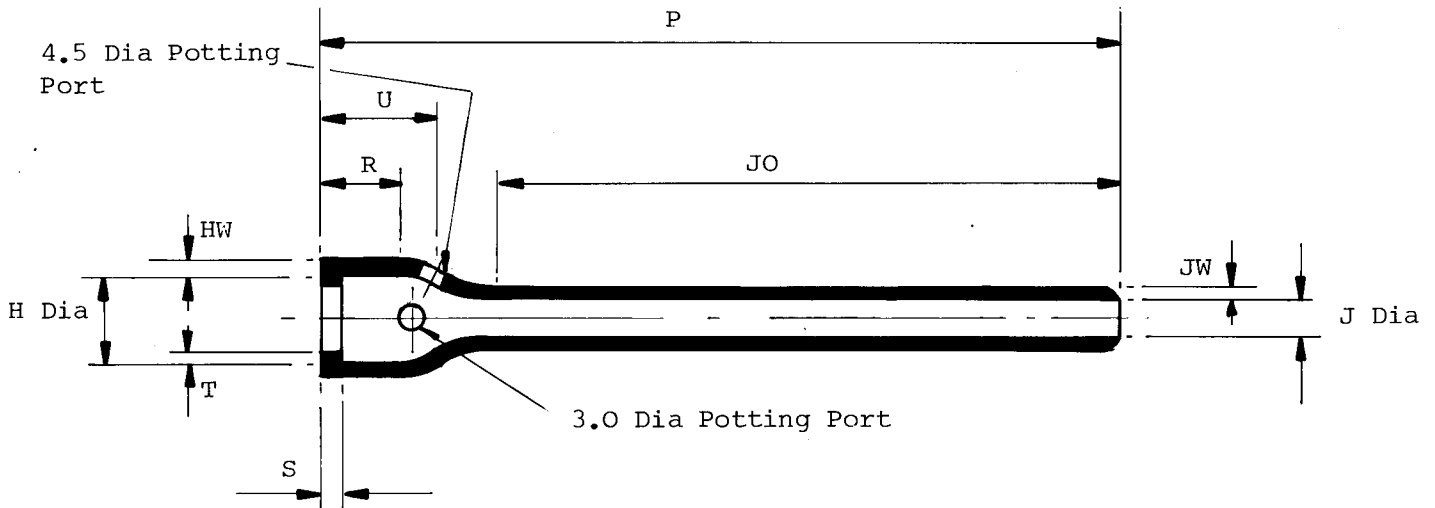

Dimensions in millimetres

Part No.	H		J		P	JO	R	S	T	HW	JW	U
	min a	max b	min a	max b	+10% b	+10% b	Ref b	Ref b	Ref b	+20% b	+20% b	+10% b
202D211	22.0	11.4	16.0	6.4	106	86	12	3.0	1.0	1.5	1.1	14
202D22.1	26.0	15.0	19.0	7.4	121	99	12	3.0	1.0	1.5	1.1	15
202D232	30.0	18.8	21.0	8.4	139	113	12	3.0	1.0	1.8	1.1	15
202D242	34.0	22.9	24.0	9.7	160	131	12	3.0	1.0	1.8	1.1	16
202D253	37.0	29.5	26.0	10.4	178	142	14	3.0	1.7	2.0	1.1	18
202D263	44.0	34.0	31.0	12.2	203	163	15	3.0	1.7	2.0	1.1	20
202D274	50.0	41.2	36.0	14.2	203	158	15	3.0	1.7	2.3	1.4	21
202D285	63.0	47.0	44.0	17.5	203	153	16	3.0	2.0	2.5	1.4	23
202D296	69.0	59.7	49.0	19.6	203	143	16	3.0	2.0	2.5	1.4	24
202D299	82.0	67.1	57.0	22.9	203	138	16	3.0	2.0	2.5	1.4	31

**Copyright(!)  
Urheberrechte**

The copyright in this drawing is the property of Raychem Ltd. The drawing is issued on condition that it is not copied, reproduced, or disclosed to a third party, either in whole or in part without the prior written consent of Raychem Ltd.

Drawn M. Rogers Checked *[Signature]* Issue 1 Date Dec '85

Conforms to ISO Recommendations  
3rd Angle Projection  
Not to scale

Approval  
Design

MKTG

Q.C.

*[Signature]*

*[Signature]*

*[Signature]*

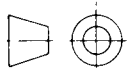

## Ordering Information

202D963-\*/\*\*-0

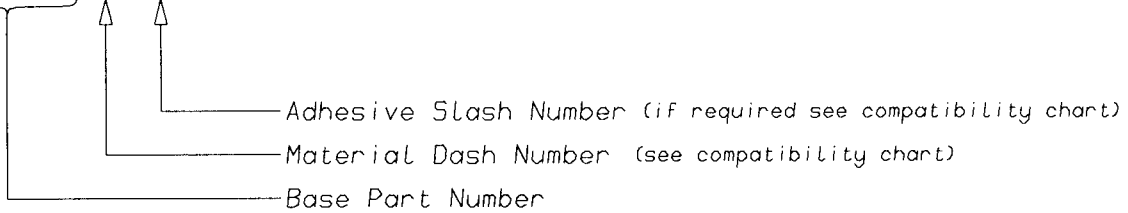

## COMPATIBILITY CHART

MATERIAL DASH NUMBER	MATERIAL DESCRIPTION	COATING SLASH NUMBER
-12	VITON	N/A
-100	ZERO HALOGEN	/86, /180

AS SUPPLIED DIMENSIONS ARE FOR UNCOATED PARTS,  
WHEN COATING IS ADDED, ENTRY DIAMETERS WILL REDUCE BY 1.5mm MAX.

POTTING PORTS ARE OPTIONAL  
WHEN SPECIFIED BY SUFFIX "-00"  
THEY WILL BE LOCATED AS SHOWN

Raychem  
 Electronics OEM Division Europe  
 Swindon, Wiltshire, England.  
 Telephone: (01793) 528171 Fax: 573923

## X-ON Electronics

Largest Supplier of Electrical and Electronic Components

*Click to view similar products for [Cable Boots](#) category:*

*Click to view products by [TE Connectivity](#) manufacturer:*

Other Similar products are found below :

[618235-000](#) [622A014-3-0](#) [CX4132-000](#) [879103-4](#) [879515-000](#) [889092](#) [982033-2](#) [R280576000](#) [1300830729](#) [MTPSRBCL-C](#) [1811481-1](#)  
[200W531-3-0](#) [202A121-386-0](#) [202A142-4-00/42-0](#) [202A163-4-0-CS5067](#) [202B221-13-0](#) [202B231-13-0](#) [202B563-25-07-0](#)  
[202C621710CS5361](#) [202D132-4-07/42-0](#) [202D221-4-0-CS5349](#) [202D221-4-26-0](#) [202D263-25-08-0](#) [202D263-4-22/42-0](#) [202D263-4-88-0](#)  
[202D921-2542-0](#) [202E336-71-0](#) [202F211-50-22-0-CS8474](#) [202F242-50-05-0](#) [202F242-51-04/164-0](#) [202K121-25-CS-1858-0](#) [202K121-25-](#)  
[CS-2062-0](#) [202K132-25-01/225-0CS8387](#) [202K153-3-0186-0](#) [202S132-25-UP-0](#) [203W301-3/42-0](#) [207W613-100/184-0-CS5657](#) [207W623-](#)  
[100-01/184-0](#) [207W634-100/184-0-CS5657](#) [207W656-100-01/184-0](#) [207W667-100-01/184-0](#) [207W667-100/184-0](#) [208A011-3-0](#) [208A021-3-](#)  
[0](#) [221A011-51164-0-CS7133](#) [222A121-2586](#) [222A152-342-0](#) [222A213-25-0-CS5613](#) [222D221-25-13/86-0](#) [222D232-4-61-0-CS5078](#)