



# DEUTSCH DMC-MD SERIES

SINGLE MODULE EN4165, ARINC 809,  
BACC65 CONNECTORS

Quick Change Modular Connector Solutions  
For Aircraft IFE and Cabin Systems

## Table of Contents

Introduction	3
Overview and Specifications	4 - 5
Part Numbering System	
Shells	6
Accessories	7
Backshells (and Plugs)	8
Backshells (and Receptacles)	9
Additional Parts	10
Shell Dimension and Panel Mounting	11
Modules	12 - 13
Panel Mount Cutout Dimensions	14 - 15

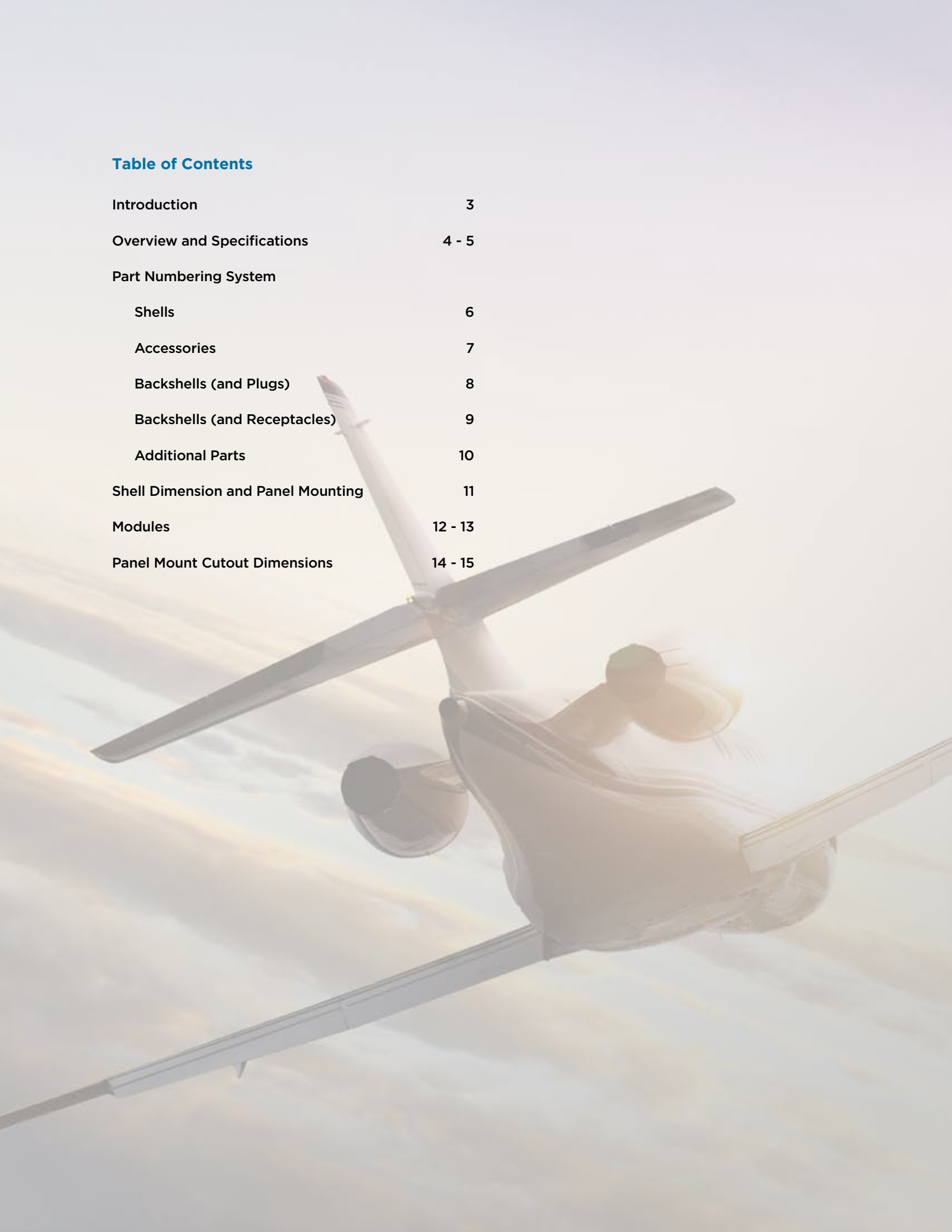

# FLEXIBLE MODULARITY FOR CABIN SYSTEMS

## MODULARITY

- Crimp and PCB contacts size 24 to size 8
- Signal, coaxial, Quadrax, power, and optical contacts
- High-speed Ethernet modules
- Aluminum cable compliant
- Easily replaced modules for fast reconfiguration
- Allows mixing of male and female modules in each connector half
- Wide range of modules allows great flexibility in configuration

## EASY TO INSTALL

- Multiple keying possibilities
- Quick-install coupling
- Toolless assembly

## RELIABILITY

- Environmental sealing
- Vibration resistant
- EMI protection as per EN4165 standard
- Meets FAA flammability, smoke, and toxicity requirements
- EN4165, ARINC 809, and BACC65 compliant

## WEIGHT OPTIMIZATION

- Nickel-plated composite shells
- Compact solution

Originally designed in the 1980s, DEUTSCH DMC-MD connectors have evolved into one of the most widely used connector styles for cabin applications in commercial aerospace. Standardized in European Standard EN4165, DMC-MD connectors provide a modular, flexible, and reliable system. The connectors are available in both multi-cavity and single-module configurations, using the same modules, to provide compact, lightweight connectivity.

## DEUTSCH DMC-MD Single-Module Connectors



**TE Components . . . TE Technology . . . TE Know-how . . .**  
AMP | Agastat | CII | Hartman | Kilovac | Microdot | Nanonics | Polamco | Raychem | Rochester | DEUTSCH  
SEACON Phoenix | L.L. Rowe | Phoenix Optix | AFP | SEACON

Get your product to market faster with a smarter, better solution.

# THE STANDARD CONNECTOR FOR 4TH GENERATION CABIN NETWORKS

ARINC 809, BACC65, EN4165



## Specifications

### MATERIALS

- **Housing:** Composite, nickel plated
- **Modules:** Thermoplastic and fluoronated silicone
- **Crimp Contacts:** Copper alloy, plated gold over nickel
- **PCB Contacts:** Copper alloy, plated gold over nickel, with lead or RoHS tinning option

### MECHANICAL/ENVIRONMENTAL

- **Temperature Range:** -55°C to +175°C
- **Vibration:** 20 g
- **Durability:** 500 mating cycles
- **Salt Spray:** 500 hours
- **Interfacial Sealing:**  $1.1 \times 10^{-2}$  bar

### ELECTRICAL

- **Insulation Resistance:** 5000 MΩ
- **Contact Current Rating:**
  - Size 24: 3 A
  - Size 23: 5 A
  - Size 22: 5 A
  - Size 20: 7.5 A
  - Size 16: 13 A
  - Size 12: 23 A
  - Size 8: 46 A

### EMI SHIELDING PERFORMANCE

Frequency (MHz)	100	200	300	400	800	1000
Attenuation (dB)	50	45	45	40	35	30

### WEIGHT

Extender Receptacle	Short Receptacle	Plug	Backshell
7 gr	6 gr	9 gr	4 - 7 gr
0.015 lbs	0.013 lbs	0.020 lbs	0.009 - 0.015 lbs

### QUALIFIED

- EN4165
- ARINC 809
- BACC65

### APPLICATIONS

- Cabin Systems
- In-Flight Entertainment
- Avionics



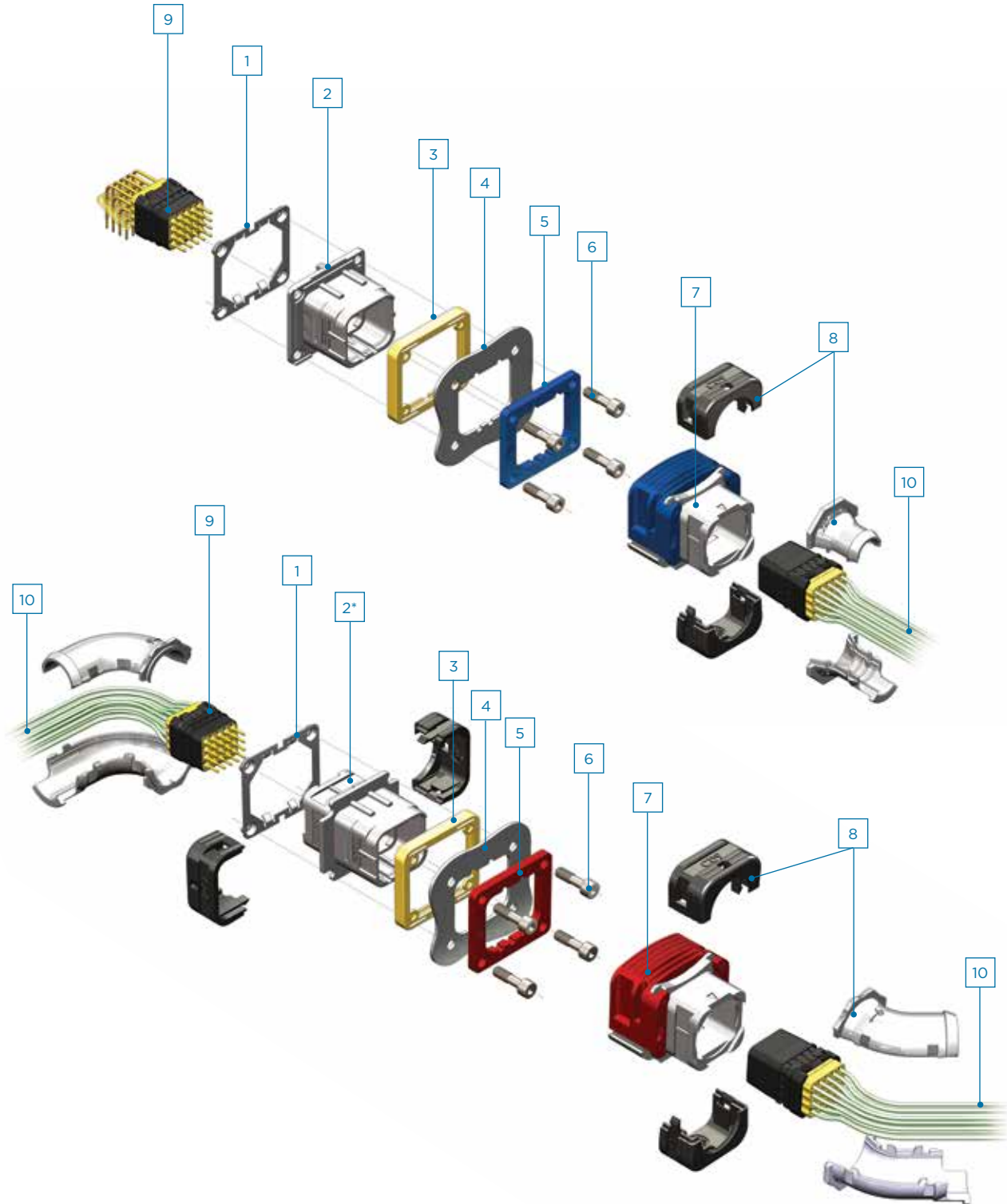

- |                                  |                                      |                    |
|----------------------------------|--------------------------------------|--------------------|
| <b>1</b> Nut plate (option)      | <b>4</b> Panel (up to 2 mm thick)    | <b>8</b> Backshell |
| <b>2</b> Short receptacle        | <b>5</b> Color coding plate (option) | <b>9</b> Modules   |
| <b>2*</b> Extender receptacle    | <b>6</b> Screws (not supplied)       | <b>10</b> Cables   |
| <b>3</b> Sealing gasket (option) | <b>7</b> Plug                        |                    |



**DESIGNATION SYSTEM FOR SHELLS**

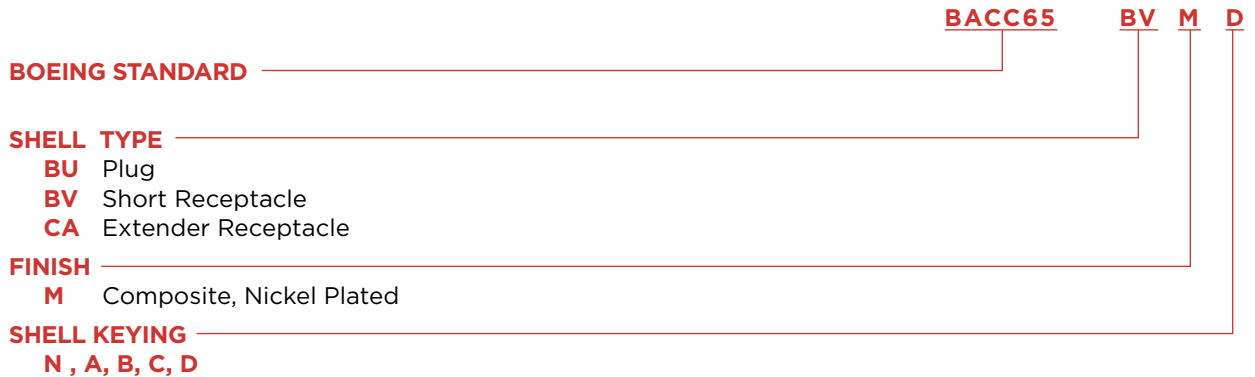
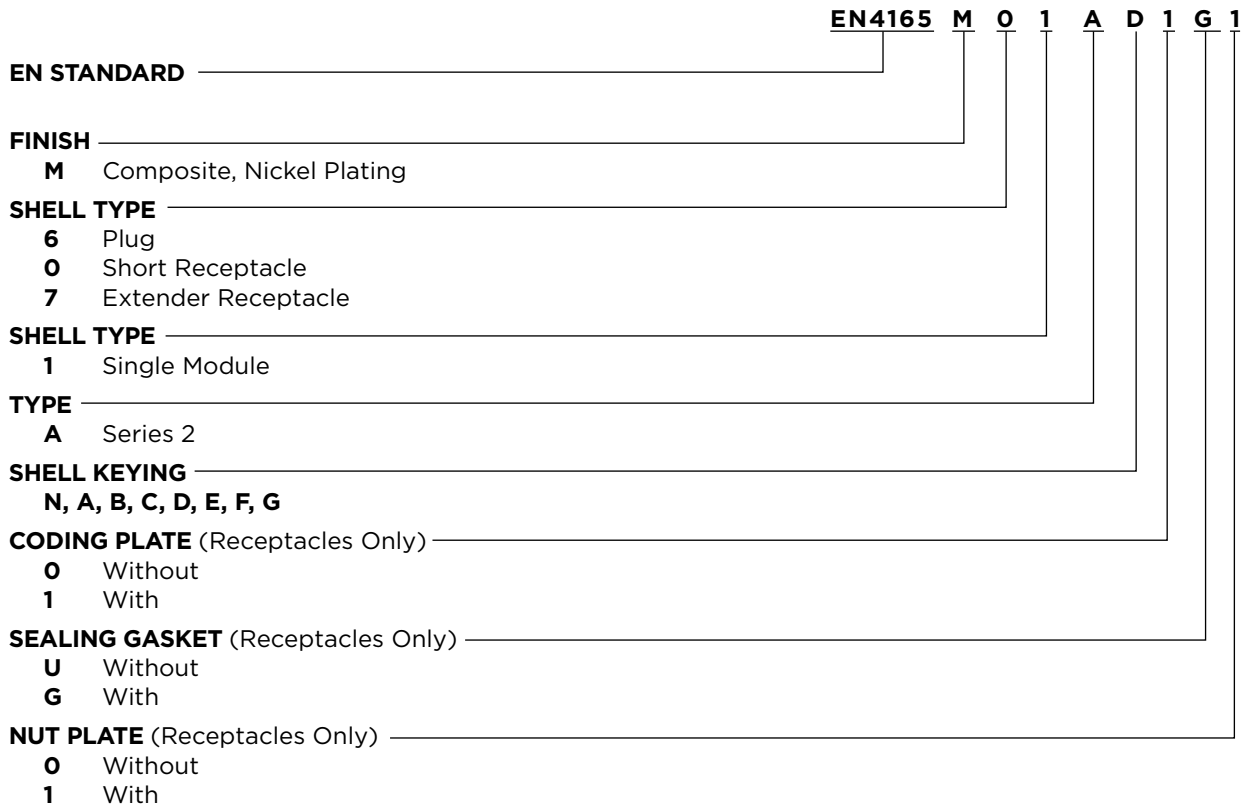
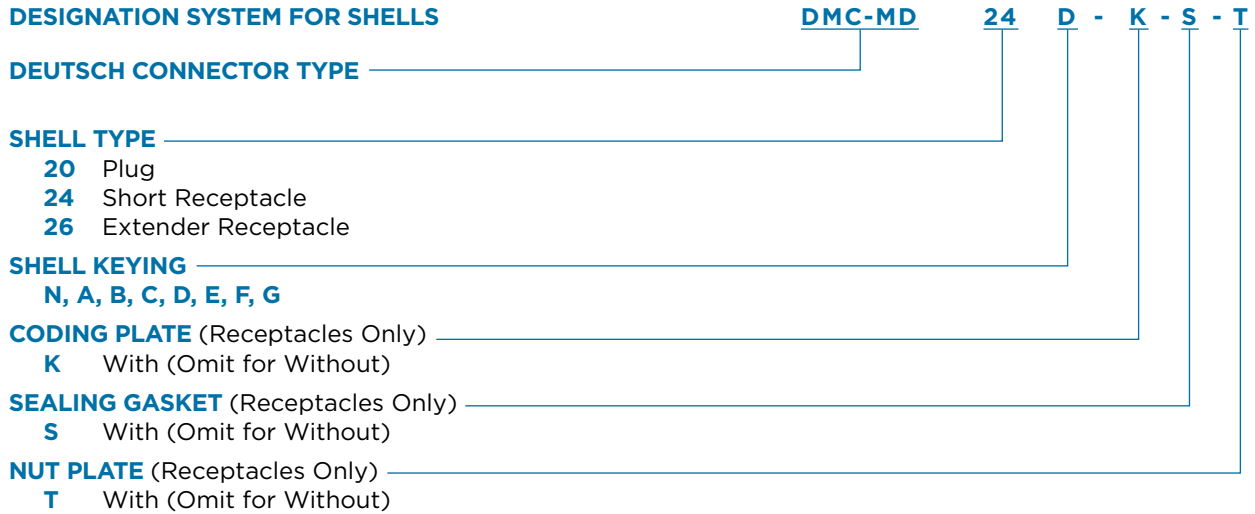



**DESIGNATION SYSTEM FOR ACCESSORIES**

**787-8055 - 20 M**

**DEUTSCH CONNECTOR TYPE**

**ACCESSORIES TYPE**

- 10** Straight Chimney
- 11** Clampshell
- 12** Straight Tie Wrap Ø 7
- 13** Straight Tie Wrap Ø 10
- 20** 45° Indexable Chimney
- 21** 45° Indexable Chimney Tie Wrap
- 30** 90° Indexable Chimney
- 31** 90° Indexable Chimney Tie Wrap

**PLATING**

- M** Nickel

**EN4165 M 20**

**EN STANDARD**

**FINISH**

- M** Composite, Nickel Plating

**ACCESSORIES TYPE**

- 10** Straight Chimney
- 20** 45° Indexable Chimney
- 30** 90° Indexable Chimney
- 10 A** Straight Tie Wrap Ø 10
- 20 A** 45° Indexable Chimney Tie Wrap
- 30 A** 90° Indexable Chimney Tie Wrap



**BACKSHELLS**

**PLUGS**

STRAIGHT CLAMPSHELL  
787-8055-11M  
Screws delivered



DMC-MD 20 N  
BACC65BUMN  
EN4165M61AN



STRAIGHT CHIMNEY  
787-8055-10M  
EN4165-026M10



DMC-MD 20 A  
BACC65BUMA  
EN4165M61AA

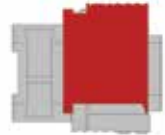

STRAIGHT CHIMNEY  
TIE WRAP Ø 7  
787-8055-12M

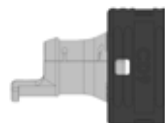

DMC-MD 20 B  
BACC65BUMB  
EN4165M61AB

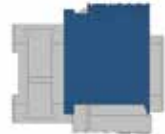

STRAIGHT CHIMNEY  
TIE WRAP Ø 10  
787-8055-13M  
EN4165-026M10A



DMC-MD 20 C  
BACC65BUMC  
EN4165M61AC

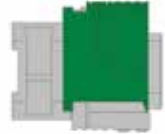

45° INDEXABLE CHIMNEY  
787-8055-20M  
EN4165-026M20

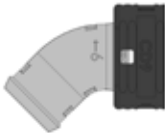

DMC-MD 20 D  
BACC65BUMD  
EN4165M61AD

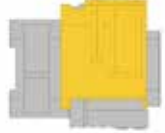

45° INDEXABLE CHIMNEY  
TIE WRAP  
787-8055-21M  
EN4165-026M20A



DMC-MD 20 E  
EN4165M61AE

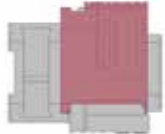

90° INDEXABLE CHIMNEY  
787-8055-30M  
EN4165-026M30



DMC-MD 20 F  
EN4165M61AF

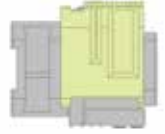

90° INDEXABLE CHIMNEY  
TIE WRAP  
787-8055-31M  
EN4165-026M30A

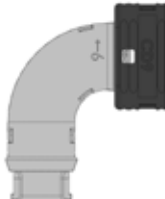

DMC-MD 20 G  
EN4165M61AG



TE/DEUTSCH Part Numbers (DMC-MD / 787)  
BOEING Part Numbers (BACC65)  
STANDARD Part Numbers (EN4165)





**RECEPTACLES**

EXTENDER RECEPTACLE

DMC-MD 26 \*X  
 BACC65CAM\*X  
 EN4165M71A\*X

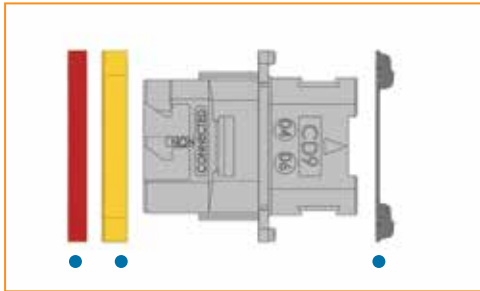

• : To be ordered separately  
 (no BACC65 references)

\*X



SHORT RECEPTACLE

DMC-MD 24 \*X  
 BACC65BVM\*X  
 EN4165M01A\*X

• : To be ordered separately  
 (no BACC65 references)

**NO ACCESSORY CAN BE USED  
 WITH THIS RECEPTACLE**

**BACKSHELLS**

STRAIGHT CLAMPSHELL  
 787-8055-11M  
 Screws delivered



STRAIGHT CHIMNEY  
 787-8055-10M  
 EN4165-026M10



STRAIGHT CHIMNEY  
 TIE WRAP Ø 7  
 787-8055-12M

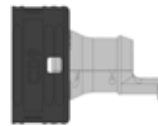

STRAIGHT CHIMNEY  
 TIE WRAP Ø 10  
 787-8055-13M  
 EN4165-026M10A



45° INDEXABLE CHIMNEY  
 787-8055-20M  
 EN4165-026M20



45° INDEXABLE CHIMNEY  
 TIE WRAP  
 787-8055-21M  
 EN4165-026M20A



90° INDEXABLE CHIMNEY  
 787-8055-30M  
 EN4165-026M30



90° INDEXABLE CHIMNEY  
 TIE WRAP  
 787-8055-31M  
 EN4165-026M30A



TE/DEUTSCH Part Numbers (DMC-MD / 787)  
 BOEING Part Numbers (BACC65)  
 STANDARD Part Numbers (EN4165)



**OPTIONAL PARTS FOR RECEPTACLE**

**Keying Plate**

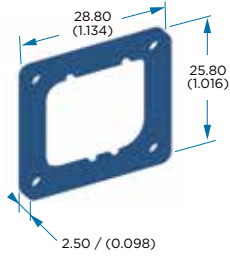

- N: 787-0015-00 EN4165-25CN
- A: 787-0015-01 EN4165-25CA
- B: 787-0015-02 EN4165-25CB
- C: 787-0015-03 EN4165-25CC
- D: 787-0015-04 EN4165-25CD
- E: 787-0015-05 EN4165-25CE
- F: 787-0015-06 EN4165-25CF
- G: 787-0015-07 EN4165-25CG

**Sealing Gasket**

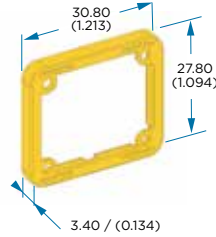

787-0011-00  
EN4165-25E

**Nut Plate**

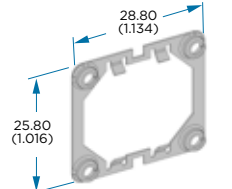

Recommended Screw Torque  
0.5 ±0.1 N.m or 4.4 ±0.9 in.lbf  
787-0016-00  
EN4165-25D

**Panel Mounting Bracket**

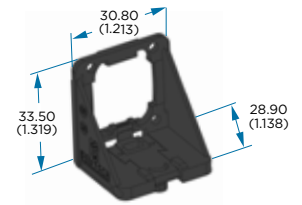

787-8014-00

**PROTECTIVE CAPS**



Protection Level	Plug Cap	Receptacle Cap	ESD Receptacle Cap	Receptacle and Extender Cap	Plug Flight Cap	Receptacle and Extender Flight Cap
	104-0236-00	104-0235-00	104-0334-00	With Lanyard: 787-8011-00 W/O Lanyard: 787-8009-00	787-8010-00	With Lanyard: 787-8017-00 EN4165M3C W/O Lanyard: 787-8016-00
Shipping	X	X	X	-	-	-
Dust	X	X	X	X	X	X
EMI	-	-	X	X	X	X
Low Pressure Sealing	-	-	-	-	X	X



**MOUNTING BRACKETS**

• Locate mating parts

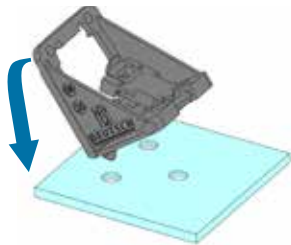

• Install rear dowels

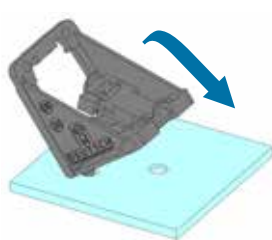

• Fix and snap in position

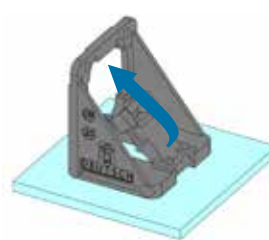

• Installed

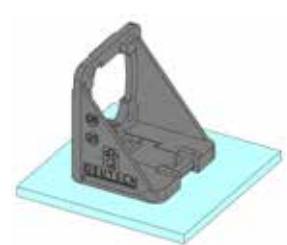

• Align receptacle with bracket

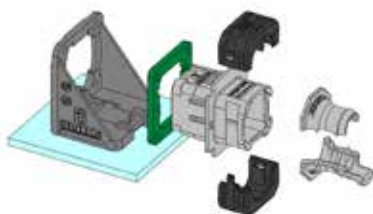

• Install and fix in position

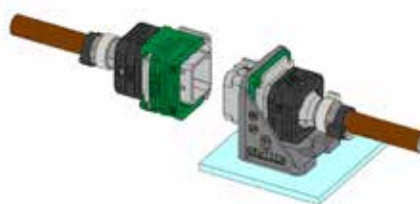

• Assembled

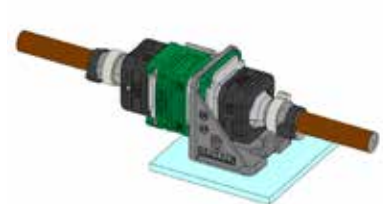



**RECEPTACLES & PLUG**

**BACKSHELL / CHIMNEY INDEXATION**

**Receptacle**

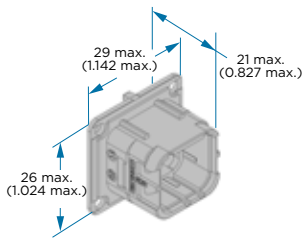

**Extender Receptacle**

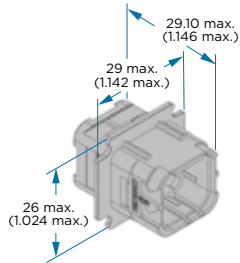

**Plug**

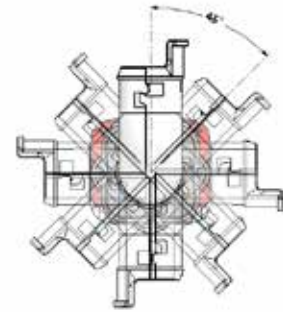
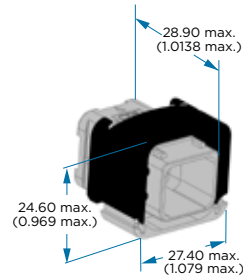

All backshells can be indexed in eight positions on the rear of plug and extender receptacle shell. This gives maximum flexibility during design and cable installation and reduces the number of variants and components.

**MOUNTING PANEL DETAILS**

**Box Mounting Receptacle**

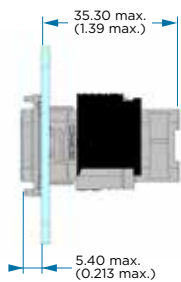

**Extender Receptacle**

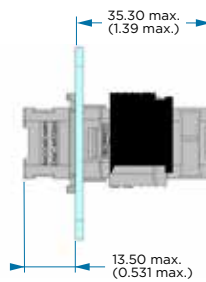

**Straight Chimney**

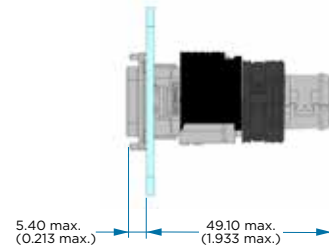

**Straight Clampshell**

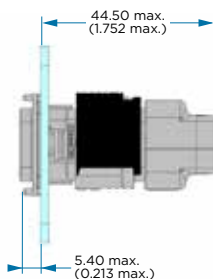

**Straight Chimney Tie Wrap**

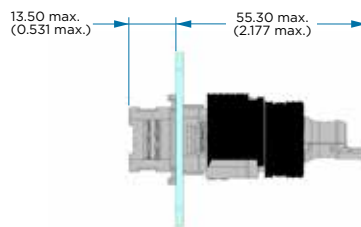

**Universal Unshielded Accessory**

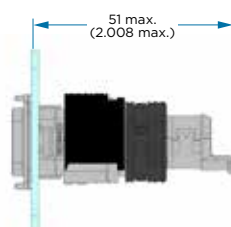

**45° Indexable Chimney**

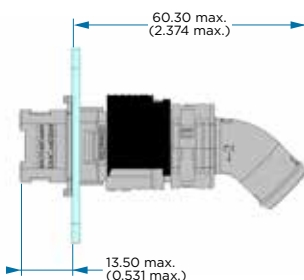

**45° Indexable Chimney Tie Wrap**

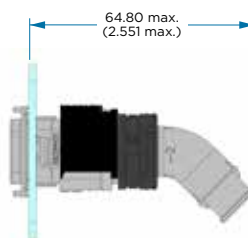



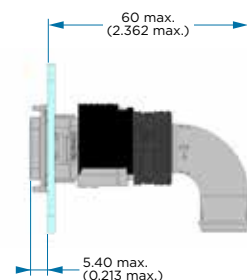

















**90° Indexable Chimney**









**ELECTRICAL MODULES / AS39029/57 AND /58 AND EN3155 CONTACT COMPLIANT**

Configuration	Pin Contacts		Socket Contacts	
	View	Part No.	View	Part No.
30 Size 23 Contacts		DMC-MR 30-23 AN		DMC-MR 30-23 BN
20 Size 22 Contacts		DMC-M 20-22 AN BACI10BC2022PNB EN4165A20-221NA		DMC-M 20-22 BN BACI10BC2022SNB EN416520-22 A1NB
20 Size 22 Contacts		DMC-MA 20-22 AN EN4165A20A221NA		DMC-MA 20-22 BN EN4165A20A221NB
12 Size 20 Contacts		DMC-M 12-20 AN BACI10BC1220PNB EN4165A12-201NA		DMC-M 12-20 BN BACI10BC1220SNB EN4165A12-201NB
8 Size 16 Contacts		DMC-M 08-16 AN BACI10BC0816PNB EN4165A08-161NA		DMC-M 08-16 BN BACI10BC0816SNB EN4165A08-161NB
4 Size 12 Contacts		DMC-M 04-12 AN EN4165A04-121NA		DMC-M 04-12 BN EN4165A04-121NB
1 Size 8 Contact		DMC-M 01-08 AN EN4165A01-081NA		DMC-M 01-08 BN EN4165A01-081NB
6 Size 16 Contacts 5 Size 22 Contacts		DMC-M 99-01 AN BACI10BC1622PNB EN4165A99-011NA		DMC-M 99-01 BN BACI10BC1622SNB EN4165A99-011NB
8 Size 22 Contacts 2 Size 12 Contacts		DMC-M 99-06 AN BACI10BC1001PNB		DMC-M 99-06 BN BACI10BC1001SNB
8 Size 20 Contacts 2 Size 16 Contacts		DMC-M 99-10 AN EN4165A99-101NA		DMC-M 99-10 BN EN4165A99-101NB
6 Size 16 Contacts 5 Size 22 Contacts		DMC-MA 99-01 AN EN4165A99A011NA		DMC-MA 99-01 BN EN4165A99A011NB

**ELECTRICAL MODULES / BACC47 CONTACT COMPLIANT**

Configuration	Pin Contacts		Socket Contacts	
	View	Part No.	View	Part No.
8 Size 20 Contacts 2 Size 16 Contacts		DMC-MB 99-10 AN BACI10BC0910PNB		DMC-MB 99-10 BN BACI10BC0910SNB
12 Size 20 Contacts		DMC-MB 12-20 AN BACI10BC1220APNB		DMC-MB 12-20 BN BACI10BC1220ASNB

Note : DMC-MD connector modules are compatible with aluminium cable contacts and with EN3155-70 / 71 size 22.

Aluminium cable technology possible with size 22 contacts



TE/DEUTSCH Part Numbers (DMC-MD / 787)  
BOEING Part Numbers (BACI10BC)  
STANDARD Part Numbers (EN4165)



### BLANKING MODULES









Configuration	View	Part No.
Blanking Module		DMC-M 00-00 PN EN4165-1N

### SHUNT MODULES





Configuration	View	Part No.
20 Size 22 Contacts 5 Shunts 4 Ways		DMC-M 22-05 BN EN4165A20Y221NB
20 Size 22 Contacts 3 Shunts 4 Ways 4 Shunts 2 Ways		DMC-M 22-07 BN EN4165A2AY221NB
20 Size 22 Contacts 10 Shunts 2 Ways		DMC-M 22-10 BN EN4165A2BY221NB

Distribution shunt modules use dedicated contacts based on standard AS39029. The shunt modules can only be mated with DMC-M 20-22 AN or DMC-MA 20-22 AN modules.

### HIGH-SPEED ETHERNET MODULES

Configuration	Pin Contacts		Socket Contacts	
	View	Part No.	View	Part No.
6 Size 16 Contacts 2 Size 22 Contacts 8 Size 24 Contacts		2226454-1		2226455-1
8 Size 22 Contacts 3 Size 20 Contacts		DMC-M 99-02 AN		DMC-M 99-02 BN
8 Size 20 Contacts 8 Size 24 Contacts		DMC-M 99-03 AN		DMC-M 99-03 BN
6 Size 20 Contacts 2 Size 22 Contacts 8 Size 24 Contacts		DMC-M 99-04 AN		DMC-M 99-04 BN

### FIBER OPTIC AND HYBRID MODULES

Configuration	Module Part No.				Alignment Sleeve
	Pin	Part No.	Socket	Part No.	
6 MC5 Termini		458235		458238	458237-C (Ceramic) 458237-M (Metal)
1 MT Ferrule (12 or 24 Fibers)		DMC-M01-MC6N		DMC-M01-MC6N	Not required
2 ARINC 801 Termini 5 Size 16 Contacts 2 Size 22 Contacts		459736 459736-P (With Contacts) 459823 (Right Angle)		459737 (Ceramic Sleeve) 459737-S (Ceramic Sleeve with Contacts) 459737-M (Metal Sleeve) 459737-M-S (Metal Sleeve with Contacts)	Included with socket module

Note : DMC-M connector's modules are compatible with aluminium cable contacts and with EN3155-70 / 71 size 22.

TE/DEUTSCH Part Numbers (DMC-MD / 787)  
BOEING Part Numbers (BAC110BC)  
STANDARD Part Numbers (EN4165)



# Panel Mounting Cutout Details

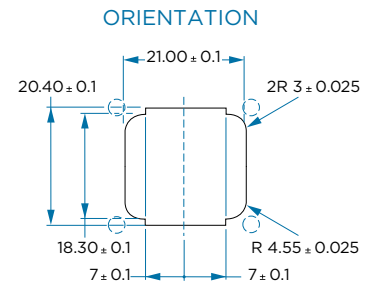
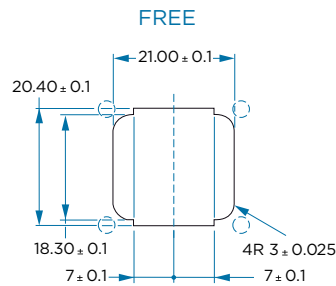
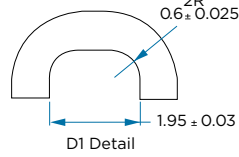
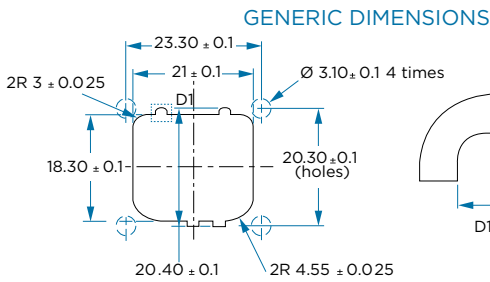
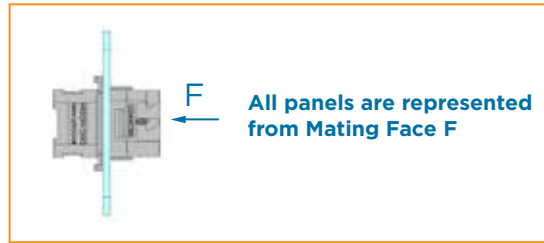

Note: Dimensions are in millimeters. Each hole Ø 3.1 mm must receive a No. 4-40 screw (not supplied)  
Recommended thickness panel: 0.8 mm min. - 2 mm max.

Recommended screw torque is 0.5 ± 0.1 N.m or 4.4 ± 0.9 in.lbf

## PANEL MOUNTING BRACKET CUTOUT DETAILS

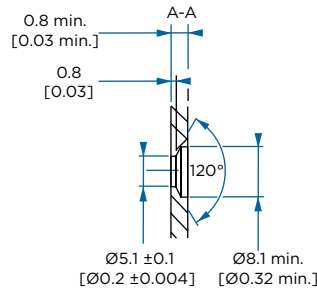
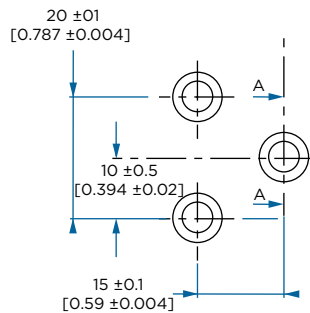

Overall dimensions and characteristics are given for indication guidance only. TE Connectivity reserves the right to modify them for production improvement reasons.



**PANEL CODING KEYING**

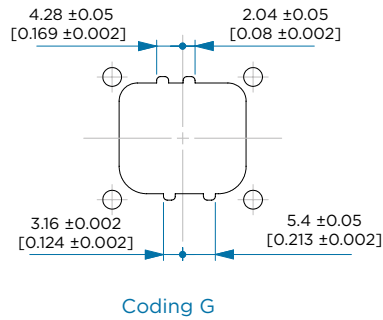
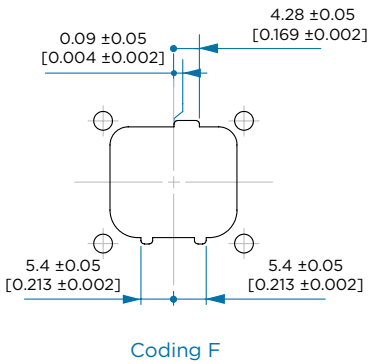
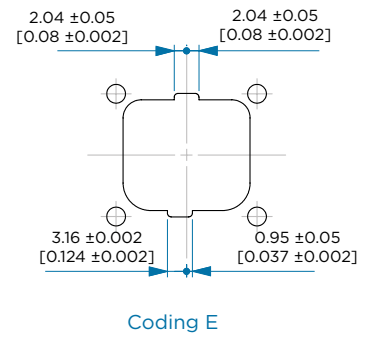
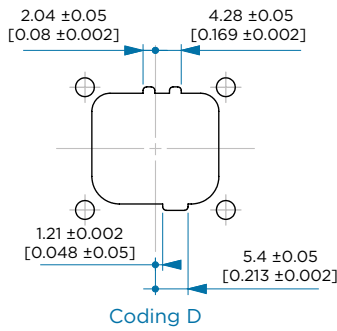
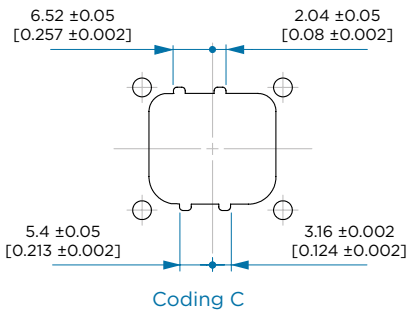
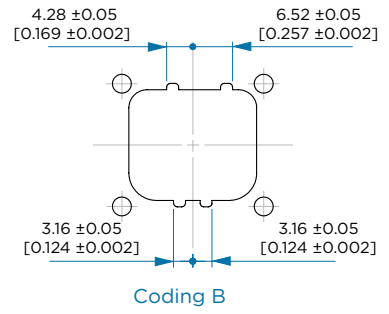
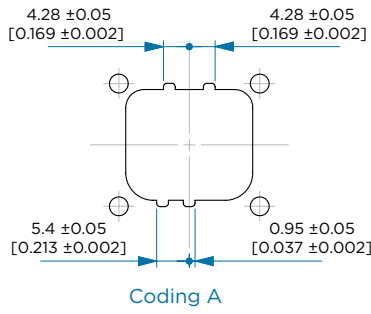
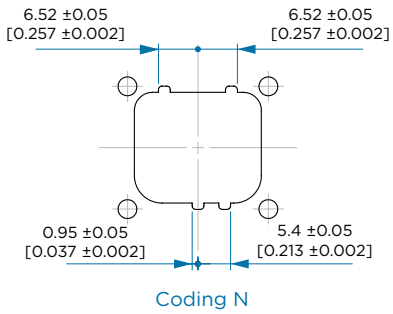

## LET'S CONNECT

We make it easy to connect with our experts and are ready to provide all the support you need. Just call your local support number or visit [www.te.com/industrial](http://www.te.com/industrial) to chat with a Product Information Specialist.

## Technical Support

[te.com/support-center](http://te.com/support-center)

North America	+1 800 522 6752	Asia Pacific	+86 400 820 6015
North America (Toll)	+1 717 986 7777	Japan	044 844 8180
EMEA/South Africa	+800 0440 5100	Australia	+61 2 9554 2695
EMEA (Toll)	+31 73 624 6999	New Zealand	+64 (0) 9 634 4580
India (Toll-Free)	+800 440 5100		

## QUICK CHANGE MODULAR CONNECTOR SOLUTIONS FOR AIRCRAFT IFE AND CABIN SYSTEMS



[te.com/deutsch](http://te.com/deutsch)

DEUTSCH, TE, TE Connectivity and the TE connectivity (logo) are trademarks of the TE Connectivity Ltd. family of companies. Other products, logos, and company names mentioned herein may be trademarks of their respective owners.

While TE has made every reasonable effort to ensure the accuracy of the information herein, nothing herein constitutes any guarantee that such information is error-free, or any other representation, warranty or guarantee that the information is accurate, correct, reliable or current. The TE entity issuing this publication reserves the right to make any adjustments to the information contained herein at any time without notice. All implied warranties regarding the information contained herein, including, but not limited to, any implied warranties of merchantability or fitness for a particular purpose are expressly disclaimed. The dimensions herein are for reference purposes only and are subject to change without notice. Specifications are subject to change without notice.

Consult TE for the latest dimensions and design specifications.

© 2016 TE Connectivity Ltd. family of companies All Rights Reserved.

1-1773725-9 03/16



## X-ON Electronics

Largest Supplier of Electrical and Electronic Components

*Click to view similar products for [Rectangular MIL Spec Connectors](#) category:*

*Click to view products by [TE Connectivity](#) manufacturer:*

Other Similar products are found below :

[891-011-15SA2-BSST](#) [CTS-S16/16](#) [65002-062](#) [CY4602-000](#) [732-8020-01](#) [77058-22-55PN](#) [81542-20](#) [86.030.0053.0](#) [1241346-1](#) [RM252-020-311-2900](#) [DMC-M 08-16 SA](#) [1589051-4](#) [MSO34MPK1E1](#) [BACC65CAMA](#) [BACC65CP1PN](#) [BACI10BC0816PNBA](#) [HSB-D4S03DM222X](#) [2217548-1](#) [891-006-9PS-BST1T](#) [891-009-15SA2-BRT1T](#) [27963-20T12](#) [SIM2N40NC3](#) [SIM2S100A](#) [1604996-2](#) [SMD25PN90L-4055](#) [1900ND08S1B00A](#) [22628-10-6P-791](#) [RE04-212S](#) [M32139/03-G05SN](#) [CTD160E01F-6148](#) [CTJ112E03B](#) [CTJ122E02D-8000](#) [CTJ-3D-12](#) [CTJ920E06N-513](#) [CTJ920E12N-513](#) [CTL-16-090](#) [RM300-000-581-0000](#) [CY4600-000](#) [CY4601-000](#) [38111-14-15SN](#) [38112-14-15PN](#) [MMA23-0111R1](#) [MMD25-0071P1](#) [33516062020](#) [33526M11-08PE](#) [DMC-M99-01AN](#) [Y59113WE20PNV00300](#) [ZPF000000000106310](#) [105979-31](#) [EN4165M01AD0G0](#)