

Materials : Alliage d'aluminium et inox  
Materials : Aluminium alloy and stainless steel

Joint : Silicone conducteur

Joint : Conductive silicone

Protection : Rien

Protection : Nothing

(3) W W

- Nickel noir
- Black nickel
- Cadmium vert olive
- Olive drab cadmium

Boitier : Rien

Shell : Nothing

(1) D D

- Non durci (sans joint)
- Not shielded (without joint)
- Durci (avec joint conducteur)
- Shielded (with conductive joint)

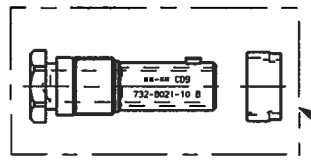

Noix de detrompage  
 threaded keying

DMC-M\* 84 \* \*-01

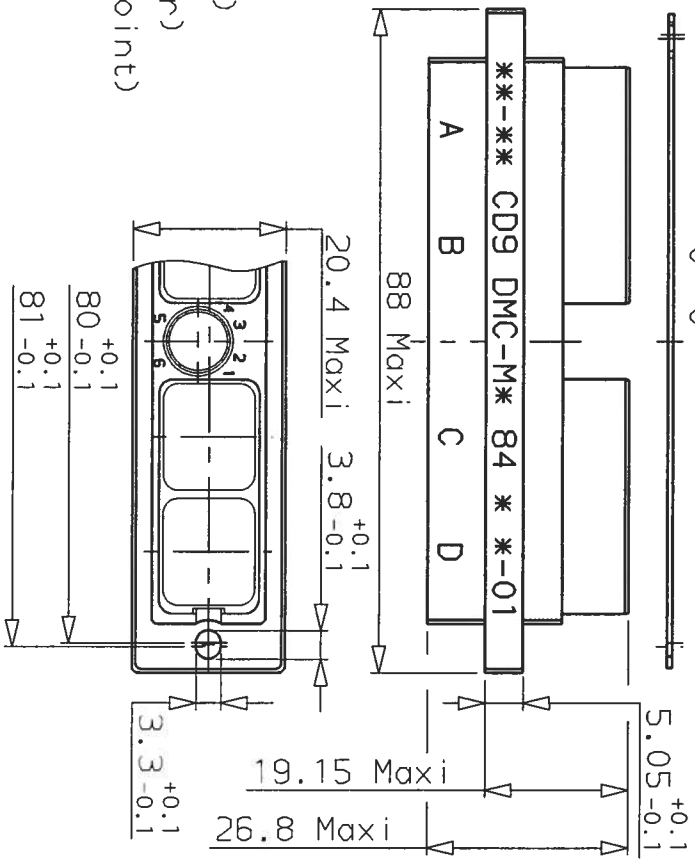

**REFERENCE**

	(1)	(2)	(3)
DMC-M	84		01
DMC-M	84		01
DMC-M	84	A	01
DMC-M	84	A	01
DMC-M	84		01
DMC-M	84		01
DMC-M	84	A	01
DMC-M	84	A	01
DMC-M	84	A	01

Boitier : Rien

Shell : Nothing

(2) A A

- Livre avec noix de detrompage "vis" polarise N
- Delivered with N threaded keying (732-8021-10 B)
- Livre sans noix de detrompage "vis"
- Delivered without threaded keying

Percentage panneau  
 suivant F.T.  
 732-8060-\*\*

Masse sans la noix de detrompage  
 Weight without threaded keying

28 g Maxi

SERIE DMC-M ; DMC-MD (VIS)

DATE 25 07 92

VISA

DESIGNATION EMBASE A COLLERETTE (4 modules)  
 PANEL MOUNTING RECEPTACLE (4 modules)

REF : DMC-M\* 84 \* \*-01  
 (1) (2) (3)

Indice Date Observations  
 ORIGINE : DE 89066

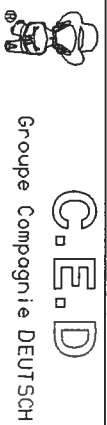

17, rue LAVOISIER  
 27000 EVREUX

**FICHE TECHNIQUE**

204-19-A/F00

## X-ON Electronics

Largest Supplier of Electrical and Electronic Components

*Click to view similar products for [Rectangular Mil Spec Connectors](#) category:*

*Click to view products by [TE Connectivity](#) manufacturer:*

Other Similar products are found below :

[891-011-15SA2-BSST](#) [CTS-S16/16](#) [65002-062](#) [CY4602-000](#) [732-8020-01](#) [77058-22-55PN](#) [81542-20](#) [86.030.0053.0](#) [1241346-1](#) [RM252-020-311-2900](#) [DMC-M 08-16 SA](#) [1589051-4](#) [MSO34MPK1E1](#) [BACC65CAMA](#) [BACC65CP1PN](#) [BACI10BC0816PNBA](#) [HSB-D4S03DM222X](#) [2217548-1](#) [891-006-9PS-BST1T](#) [891-009-15SA2-BRT1T](#) [27963-20T12](#) [SIM2N40NC3](#) [SIM2S100A](#) [1604996-2](#) [SMD25PN90L-4055](#) [1900ND08S1B00A](#) [22628-10-6P-791](#) [RE04-212S](#) [M32139/03-G05SN](#) [CTD160E01F-6148](#) [CTJ112E03B](#) [CTJ122E02D-8000](#) [CTJ-3D-12](#) [CTJ920E06N-513](#) [CTJ920E12N-513](#) [CTL-16-090](#) [RM300-000-581-0000](#) [CY4600-000](#) [CY4601-000](#) [38111-14-15SN](#) [38112-14-15PN](#) [MMA23-0111R1](#) [MMD25-0071P1](#) [33516062020](#) [33526M11-08PE](#) [DMC-M99-01AN](#) [Y59113WE20PNV00300](#) [ZPF000000000106310](#) [105979-31](#) [EN4165M01AD0G0](#)