

REVISIONS

P	LTR	DESCRIPTION	DATE	DWN	APVD
	A	NEW RELEASE PER ECO-14-009834	28JUN2014	DM	DM
	A1	REVISED PER PCN E-18-005300	28MAR2018	SM	DM
	A2	REVISED PER PCN E-20-005457	14APR2020	AP	IG

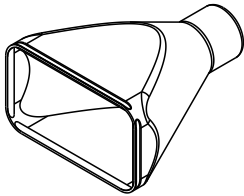

3D VIEW

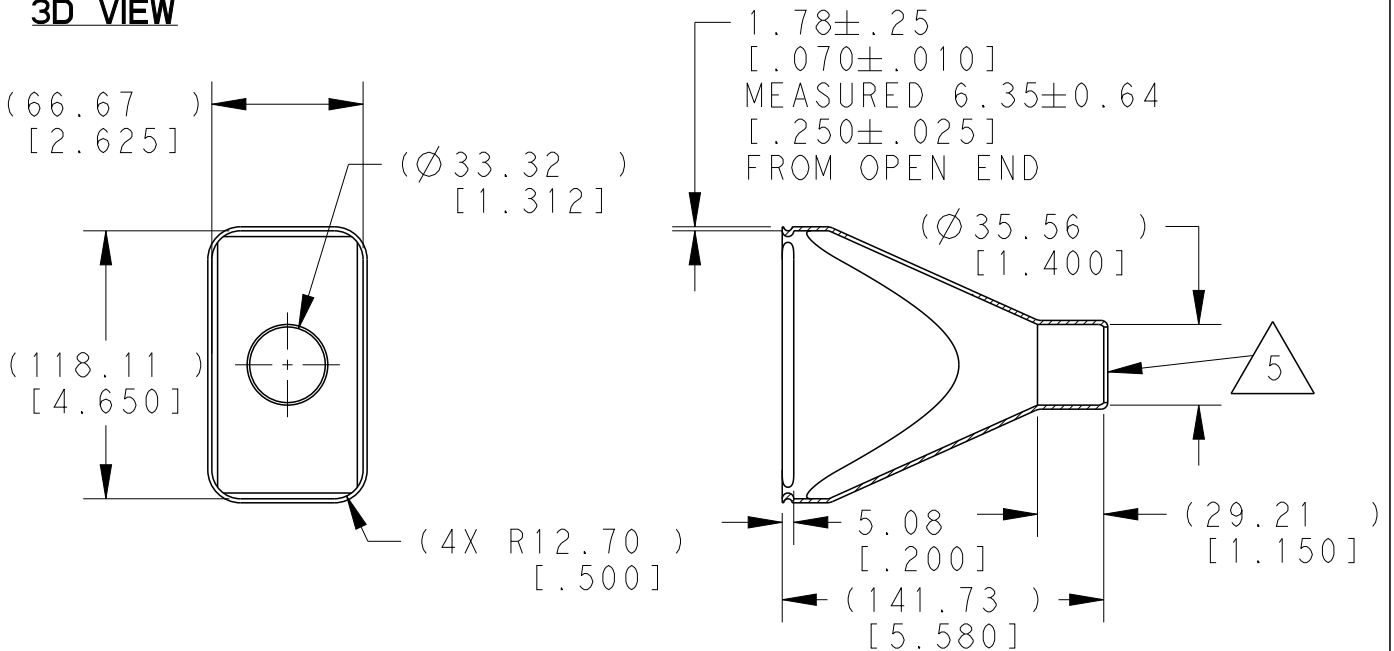

6. SMALL NON-FILLS ARE ACCEPTABLE INSIDE OF PART, INCLUDING SUPPLIER MARKING.

5. SMALL MATERIAL EXTENSION IS ACCEPTABLE ON THIS END ALL AROUND. WALL THICKNESS ON THIS END MAY VARY.

4. BOTTOM OF PART MOLDED OPEN.

3. THIS ACCESSORY PART IS PROVIDED WITHOUT TYPICAL TRANSPORTATION INDUSTRY PROCESS CONTROLS. NO VALIDATION TESTING HAS BEEN PERFORMED. CUSTOMER IS RESPONSIBLE FOR DETERMINING PRODUCT PERFORMANCE AND SUITABILITY FOR APPLICATION.

2. TEMPERATURE RATING: -29°C TO +100°C [-20°F TO +212°F]

1. THIS PART IS USED ON  
 DRB12-102PX(N)E-XXXX RECEPTACLE  
 DRB16-102SXE-XXXX PLUG  
 DRB12-128PX(N)E-XXXX RECEPTACLE  
 DRB16-128SXE-XXXX PLUG  
 WHERE X=A,B,C,D KEYS AND XXXX=MODIFICATION

NOTES:

TE INTEARNAL PN	DEUTSCH PN
DRB102-BT	DRB102-BT

2014  
 RELEASED FOR PUBLICATION  
 ALL RIGHTS RESERVED.  
 BY TE CONNECTIVITY  
 COPYRIGHT 2014  
 THIS DRAWING IS UNPUBLISHED.

DIMENSIONS: MM[INCH]	DWN D.MEYER	28JUN2014	MATERIAL	PVC	FINISH	BLACK
	CHK P.CARNAHAN	28JUN2014	TE Connectivity			
TOLERANCES UNLESS OTHERWISE SPECIFIED:	APVD D.MEYER	28JUN2014				
0 PLC ±	PRODUCT SPEC		SIZE	CAGE CODE	DRAWING NO	RESTRICTED TO
1 PLC ±			A 4	4AFU8	©-DRB102-BT	
2 PLC ±0.63[.025]	APPLICATION SPEC		WEIGHT	84.00 G		
3 PLC ±			CUSTOMER DRAWING	SCALE	3:10	SHEET 1 OF 1
4 PLC ±						REV A2
ANGLES ±5°						

## X-ON Electronics

Largest Supplier of Electrical and Electronic Components

*Click to view similar products for [Automotive Connectors](#) category:*

*Click to view products by [TE Connectivity](#) manufacturer:*

Other Similar products are found below :

[003-018-000](#) [60403001](#) [60993906-B](#) [M902-2131](#) [M902-2161](#) [M902-2344](#) [72.330.1035.1](#) [73.353.4028.0](#) [F119300-B](#) [F166900](#) [F258300-B](#)  
[F358300-B](#) [F407400](#) [F444110](#) [F487000](#) [F509500B-B](#) [827153-1](#) [8N1515-32-24P](#) [9-1326729-8](#) [925474-1](#) [928905-1](#) [964562-4](#) [968782-1](#)  
[GT17SA-8DS-HU](#) [98891-1012](#) [98947-1016](#) [12004147](#) [12004475-L](#) [12010290](#) [12010309-B](#) [12015454](#) [12020219-B](#) [12041318-B](#) [12052225-](#)  
[L](#) [12052466](#) [12064869](#) [12004327-B](#) [12015308](#) [12015384](#) [12015909](#) [1-21030-1](#) [12041254](#) [12041318](#) [12047946-B](#) [12047957](#) [12047957-L](#)  
[12059473](#) [12066261](#) [12110546](#) [12110546-B](#)