

3D VIEW

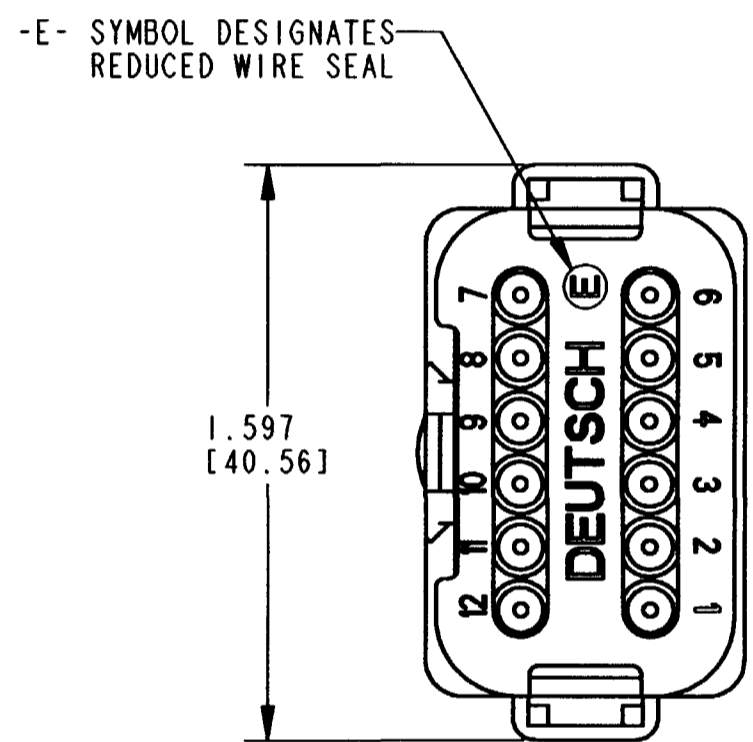
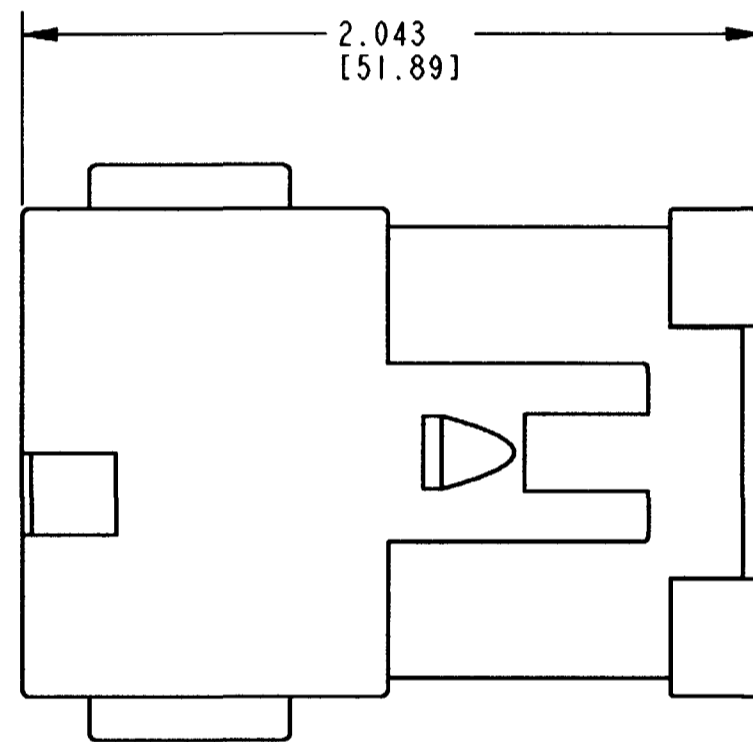
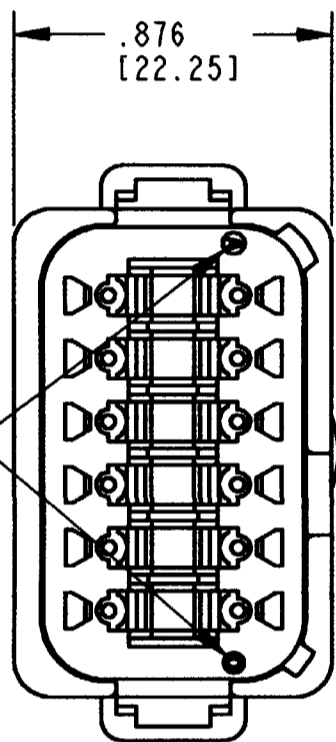

DATE CODE: MONTH IS REPRESENTED BY SEQUENTIAL ALPHA CHARACTERS.
 EX: A = JANUARY.
 DATE CODE: YEAR IS REPRESENTED BY THE LAST NUMERICAL DIGIT. EX. 0 = 2000

REV NC DT04-12PX-CE07

REVISIONS			
SYM	DESCRIPTION	DATE	APPROVED
NC	NEW RELEASE/REPLACES PREVIOUS	2-11-05	RDR
	RELEASE PER E.O. P18825	2-21-05	RDR

CONTACT SIZE	MIN. INSUL. O.D.	MAX. INSUL. O.D.	WIRE RANGE [mm ²]
16	.053 [1.35]	.120 [3.05]	14-20 AWG [2.0-0.5]

4. THIS RECEPTACLE MATES WITH DT06-12S*-**** PLUG, (* = A,B,C,D, KEY ARRANGEMENT; **** = ALL MODIFICATION). CONSULT FACTORY FOR ALL MODIFICATIONS.

3. FOR CONTACTS AND WIRE PERFORMANCE AND APPLICATION CHARACTERISTICS SEE ENVELOPE DRAWING 0425-015-0000 AND 0425-017-0000.

2. DIMENSIONS ARE ±.025 [0.64] UNLESS OTHERWISE SPECIFIED.

NOTES: 1. DIMENSIONS ARE IN INCHES [MILLIMETERS].

SIGNATURE & DATE	
DR	X. SANCHEZ 02FEB05
CHK	JamC. Gant 2/14/05
PE	Teq. Jahan 2/14/05
APPD	S. Beaud 2-7-05
SCALE	NONE
WT	

12 WAY RECEPTACLE
 ENHANCED KEY,
 REDUCED WIRE SEAL
 AND CAP
 -CE07 MOD.
 D.T. SERIES
 ENVELOPE

CP	MATL. CODE
The Deutsch Company DEUTSCH I.P.D. 3850 INDUSTRIAL AVE. HEMET, CALIF. 92545	
B	DT04-12PX-CE07
DWG SIZE	CODE 11139 SHEET 1 OF 2

REV NC	DT04-12P*-CE07	REVISIONS		
SYM	DESCRIPTION	DATE	APPROVED	
NC	SEE SHEET 1	2-11-05	RDR	

PART NO.
DT04-12PA-CE07
KEY ARR. -A-
COLOR: GREY

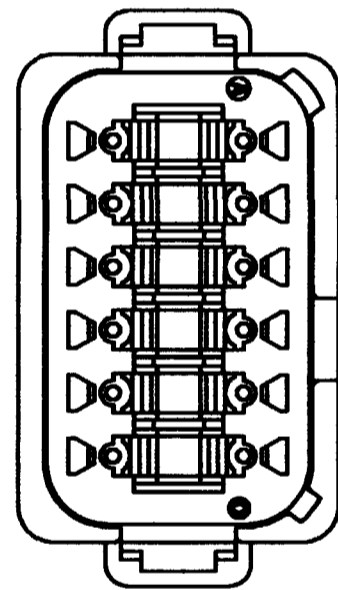

PART NO.
DT04-12PB-CE07
KEY ARR. -B-
COLOR: BLACK

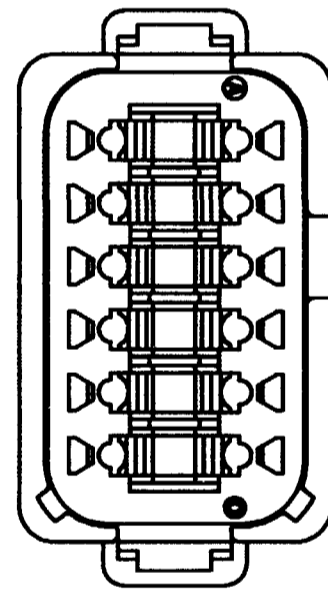

PART NO.
DT04-12PC-CE07
KEY ARR. -C-
COLOR: GREEN

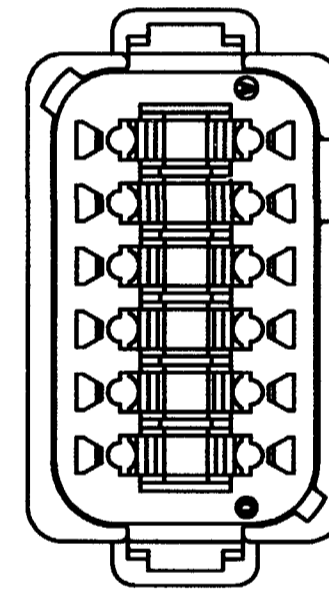

PART NO.
DT04-12PD-CE07
KEY ARR. -D-
COLOR: BROWN

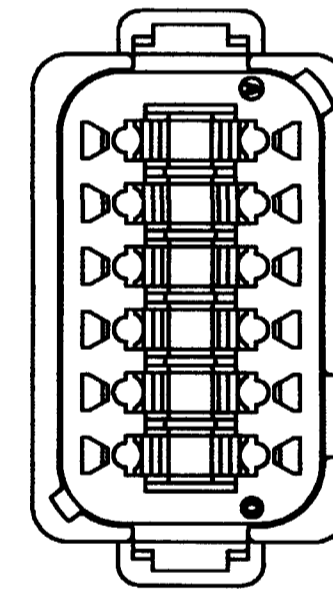

NOTES:

SIGNATURE & DATE		12 WAY RECEPTACLE ENHANCED KEY, REDUCED WIRE SEAL AND CAP -CE07 MOD. D.T. SERIES ENVELOPE	CP	MATL. CODE	
DR	X. SANCHEZ 02FEB05		The Deutsch Company DEUTSCH I.P.D. 3850 INDUSTRIAL AVE. HEMET, CALIF. 92545		
CHK	<i>[Signature]</i> 2/10/05		B	DT04-12P*-CE07	
PE	<i>[Signature]</i> 2/5/05			DWG SIZE	CODE 11139
APPD	<i>[Signature]</i> 2-7-05				
SCALE	NONE	WT			

X-ON Electronics

Largest Supplier of Electrical and Electronic Components

Click to view similar products for [Automotive Connectors](#) category:

Click to view products by [TE Connectivity](#) manufacturer:

Other Similar products are found below :

[003-018-000](#) [60403001](#) [60993906-B](#) [M902-2131](#) [M902-2161](#) [72.330.1035.1](#) [73.353.4028.0](#) [F119300-B](#) [F166900](#) [F258300-B](#) [F358300-B](#)
[F407400](#) [F444110](#) [F487000](#) [F509500B-B](#) [827153-1](#) [8N1515-32-24P](#) [9-1326729-8](#) [925474-1](#) [928905-1](#) [964562-4](#) [968782-1](#) [GT17SA-8DS-](#)
[HU](#) [98891-1012](#) [98947-1016](#) [12004147](#) [12004475-L](#) [12010290](#) [12010309-B](#) [12015454](#) [12020219-B](#) [12020308](#) [12041318-B](#) [12052225-L](#)
[12052466](#) [12059125](#) [12064869](#) [12004327-B](#) [12010503-B](#) [12015308](#) [12015384](#) [12015909](#) [1-21030-1](#) [12041254](#) [12041318](#) [12047946-B](#)
[12047957](#) [12047957-L](#) [12059473](#) [12066261](#)