

P	LTR	DESCRIPTION	DATE	DWN	APVD
	D1	ECR-21-108593	05AUG2021	DRK	IG

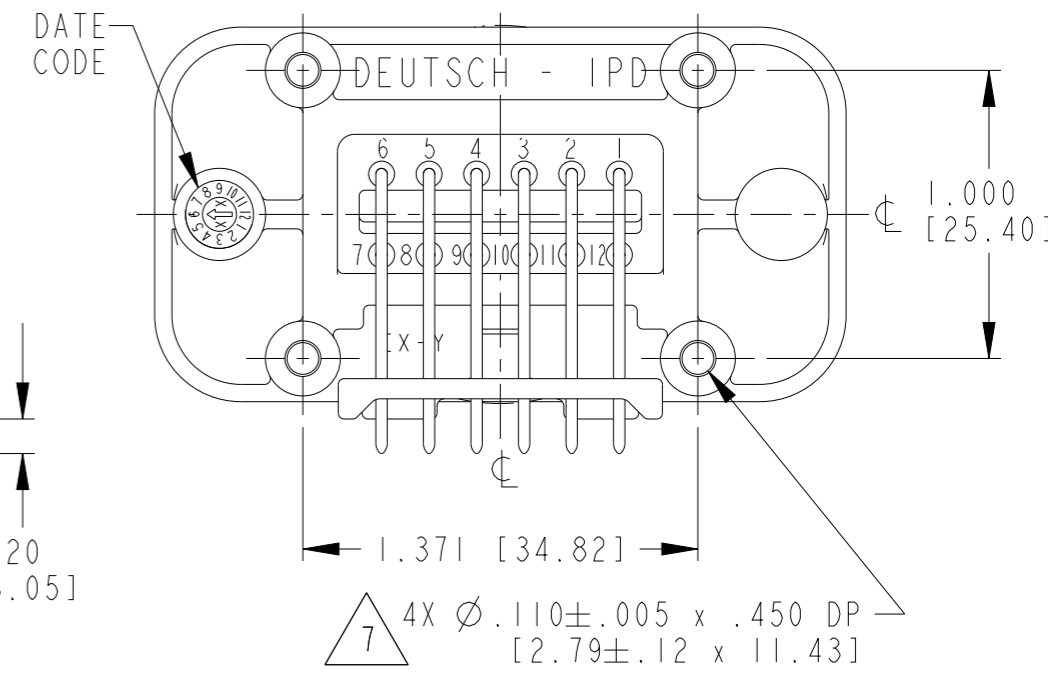
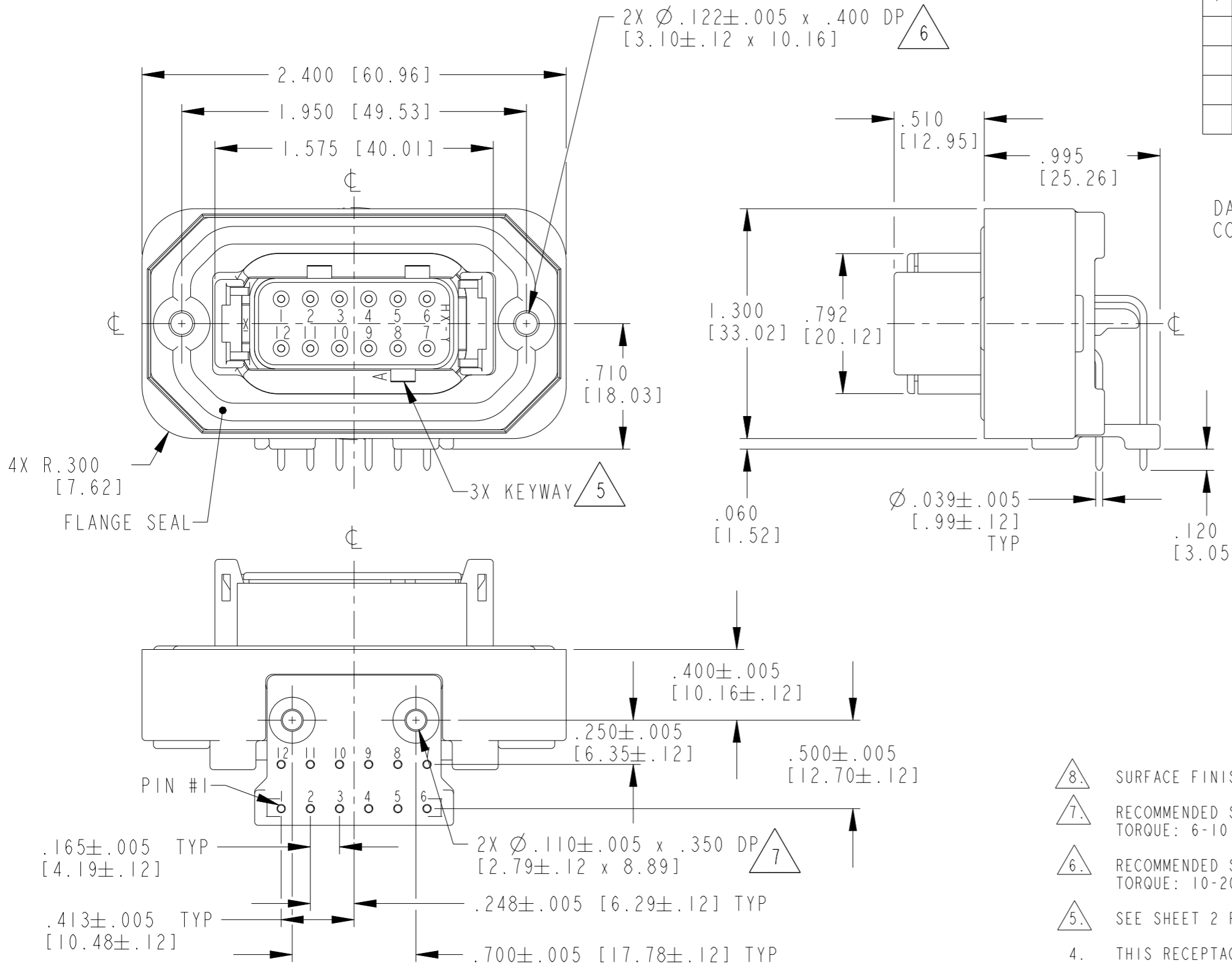

- $\triangle 8$ . SURFACE FINISH: 32 RMS OR BETTER;  $\square .005$  [.12]
- $\triangle 7$ . RECOMMENDED SCREW: 4-20 [M3.12 x 1.27] THREAD-FORMING SCREW. TORQUE: 6-10 IN-LB [.68-1.13 NM].
- $\triangle 6$ . RECOMMENDED SCREW: 6-19 [M3.63 x 1.34] THREAD-FORMING SCREW. TORQUE: 10-20 IN-LB [1.13-2.25 NM].
- $\triangle 5$ . SEE SHEET 2 FOR OTHER KEY ARRANGEMENTS.
- 4. THIS RECEPTACLE MATES WITH DTM06-12S\*-\*\*\*\* PLUG (\*=A,B,C,D KEYS; \*\*\*\*=ALL MODIFICATIONS).

3. CONTACT PLATING - MATING SIDE: NICKEL; PCB SIDE: TIN

$\triangle 2$  MATERIAL -  
HOUSING & PIN ALIGNMENT PLATE: PA46 GF30; GRAY  
SLEEVE RETAINER PA46 GF10 (SEE SHEET 2 FOR COLORS)  
SEALS: VMQ (RED-ORANGE)  
PINS: COPPER ALLOY

1. PANEL CUTOUT:  $\pm 0.010$  [0.25]

NOTES:

THIS DRAWING IS A CONTROLLED DOCUMENT.		DWN D MEYER 23APR2002	TE Connectivity		
DIMENSIONS: INCHES [mm]		CHK B BYFORD 07OCT2011			
TOLERANCES UNLESS OTHERWISE SPECIFIED: $\pm 0.025$ [0.64mm]		APVD S BEARD 07OCT2011	NAME RECEPTACLE 12 #20 SIZE CONTACTS KEY ARRANGEMENTS A, B, C AND D 90 DEG, DTM SERIES		
		PRODUCT SPEC -	RESTRICTED TO -		
MATERIAL $\triangle 2$		APPLICATION SPEC -	SIZE A3	CAGE CODE 11139	DRAWING NO C=DTM13-12PX
		WEIGHT -	SCALE 3:2	SHEET 1 OF 2	REV D1
CUSTOMER DRAWING					

P	LTR	DESCRIPTION	DATE	DWN	APVD
-	-	SEE SHEET 1	-	-	-

**DTM13-12PA**  
**KEY:-A-**

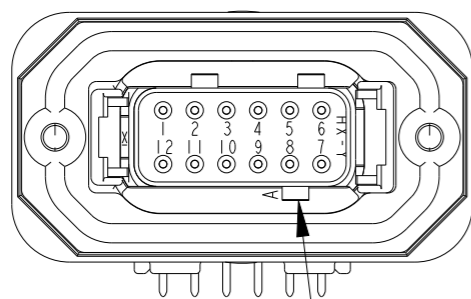

3X KEYWAY  
SLEEVE RETAINER: GRAY

**DTM13-12PB**  
**KEY: -B-**

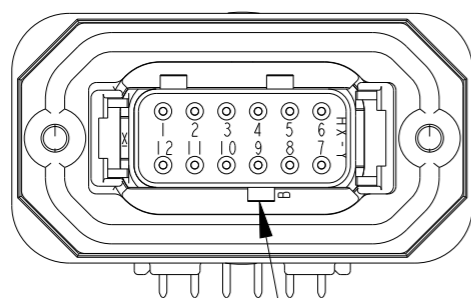

3X KEYWAY  
SLEEVE RETAINER: BLACK

**DTM13-12PC**  
**KEY: -C-**

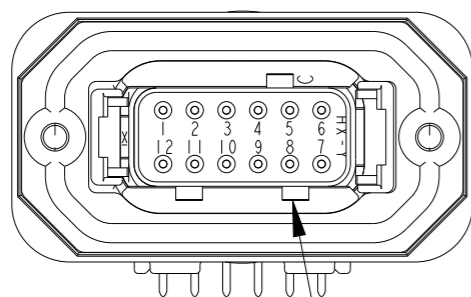

3X KEYWAY  
SLEEVE RETAINER: GREEN

**DTM13-12PD**  
**KEY: -D-**

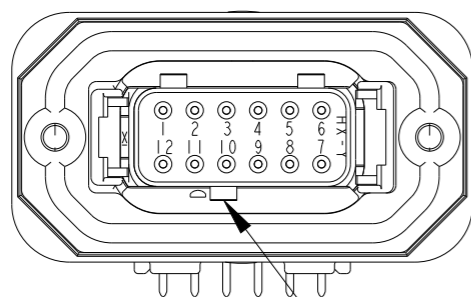

3X KEYWAY  
SLEEVE RETAINER: BROWN

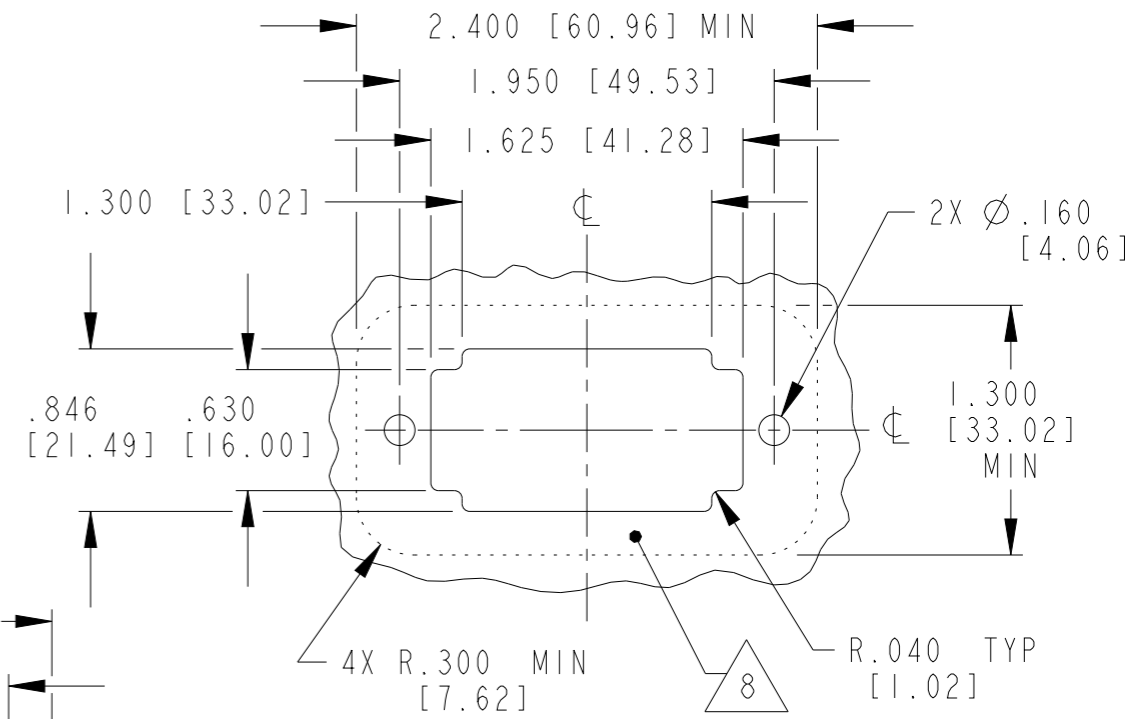

**RECOMMENDED PANEL  
CUTOUT**

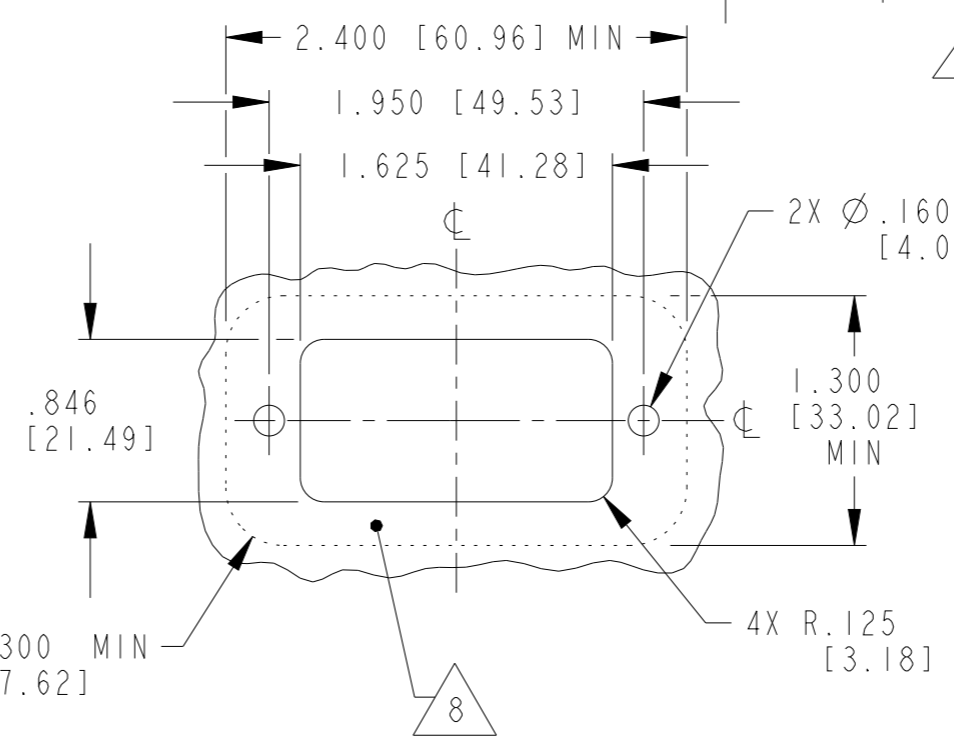

THIS DRAWING IS A CONTROLLED DOCUMENT.		DWN D MEYER 23APR2002														
DIMENSIONS: INCHES [mm]		CHK B BYFORD 07OCT2011														
TOLERANCES UNLESS OTHERWISE SPECIFIED: ±0.025 [0.64mm]		APVD S BEARD 07OCT2011	NAME RECEPTACLE 12 #20 SIZE CONTACTS KEY ARRANGEMENTS A, B, C AND D 90 DEG, DTM SERIES													
<table border="1"> <tr> <td>0 PLC</td> <td>±-</td> </tr> <tr> <td>1 PLC</td> <td>±-</td> </tr> <tr> <td>2 PLC</td> <td>±-</td> </tr> <tr> <td>3 PLC</td> <td>±-</td> </tr> <tr> <td>4 PLC</td> <td>±-</td> </tr> <tr> <td>ANGLES</td> <td>±-</td> </tr> </table>		0 PLC	±-	1 PLC	±-	2 PLC	±-	3 PLC	±-	4 PLC	±-	ANGLES	±-	PRODUCT SPEC -	SIZE A3	CAGE CODE 11139
0 PLC	±-															
1 PLC	±-															
2 PLC	±-															
3 PLC	±-															
4 PLC	±-															
ANGLES	±-															
MATERIAL 2		FINISH -	DRAWING NO C=DTM13-12PX	RESTRICTED TO -												
-		WEIGHT -	SCALE 3:2	SHEET 2 OF 2												
-		CUSTOMER DRAWING	REV DI													

## X-ON Electronics

Largest Supplier of Electrical and Electronic Components

*Click to view similar products for [Automotive Connectors](#) category:*

*Click to view products by [TE Connectivity](#) manufacturer:*

Other Similar products are found below :

[003-018-000](#) [60403001](#) [60993906-B](#) [M902-2131](#) [M902-2161](#) [72.330.1035.1](#) [73.353.4028.0](#) [F119300-B](#) [F166900](#) [F258300-B](#) [F358300-B](#)  
[F407400](#) [F444110](#) [F487000](#) [F509500B-B](#) [827153-1](#) [8N1515-32-24P](#) [9-1326729-8](#) [925474-1](#) [928905-1](#) [964562-4](#) [968782-1](#) [GT17SA-8DS-](#)  
[HU](#) [98891-1012](#) [98947-1016](#) [12004147](#) [12004475-L](#) [12010290](#) [12010309-B](#) [12015454](#) [12020219-B](#) [12020308](#) [12041318-B](#) [12052225-L](#)  
[12052466](#) [12059125](#) [12064869](#) [12004327-B](#) [12010503-B](#) [12015308](#) [12015384](#) [12015909](#) [1-21030-1](#) [12041254](#) [12041318](#) [12047946-B](#)  
[12047957](#) [12047957-L](#) [12059473](#) [12066261](#)