



TE Connectivity

Specification Control Drawing

a) Part as supplied.

HFT5000

Heat-shrinkable Fabric Tubing.

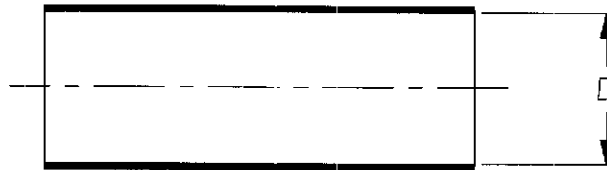

b) Part fully recovered.

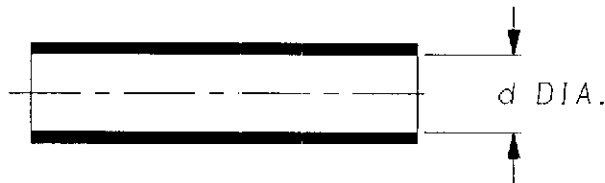

Warp material: E/167 dtex Polyester.

Weft material: 0.30mm nom. Irradiated Modified Polyolefin.
(0.01)

Coating: Modified Polyolefin

Conforms to TE Connectivity Specification RW2060

Dimensions in millimetres. (inches)

PART No.	D DIA.		d DIA.	
	MIN		MAX	
	a		b	
# HFT5000-6/3	6	(0.23)	3	(0.12)
HFT5000-12/6	12	(0.47)	6	(0.24)
HFT5000-20/10	20	(0.79)	10	(0.39)
HFT5000-25/12	25	(0.98)	12	(0.47)
HFT5000-30/15	30	(1.18)	15	(0.59)
HFT5000-34/17	34	(1.34)	17	(0.67)
HFT5000-40/20	40	(1.57)	20	(0.79)
HFT5000-50/25	50	(1.97)	25	(0.98)
HFT5000-60/30	60	(2.36)	30	(1.18)
HFT5000-70/35	70	(2.76)	35	(1.38)
HFT5000-80/40	80	(3.15)	40	(1.57)
HFT5000-100/50	100	(3.94)	50	(1.97)

* Contact Product Management for Performance Characteristics - does not conform fully to RW2060

Fully recovered fabric wall thickness approximately 1mm (0.039)
Longitudinal change on full recovery -10 to -20%

Drawn RK

Checked HMR

Issue 5

Date 24MAR11

Conforms to ISO Recommendations
3rd Angle Projection
Not to Scale

Approval
Design

MKTG.

O.A.

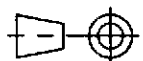

Handwritten signature
25/05/09

		Specification Control Drawing	Part Number HFT5000 Issue 5
Iss.	Date	E.C.R. No.	Details of Change
2	July 2000	CR00-DM-0136	Size 80/40 added
3	March 2004	CR04-CP-0158	Size 6/3 added
4	February 2005	CR05-DM-031	Size 100/50 added

TE Connectivity UK Ltd. Faraday Road, Swindon, Wiltshire, SN3 5HH England Telephone: (01793) 528171 Fax: 572516	TE Connectivity 300, Constitution Drive, Menlo Park, CA 94025 USA Telephone (650) 361-3860 Fax: (650) 361-5579
Cage Code K1010	Cage Code 06090

X-ON Electronics

Largest Supplier of Electrical and Electronic Components

Click to view similar products for [Heat Shrink Tubing and Sleeves](#) category:

Click to view products by [TE Connectivity](#) manufacturer:

Other Similar products are found below :

[5685710001](#) [CR9960-000](#) [5734012004](#) [607381P039](#) [611112-000](#) [6284592002](#) [CX4711-000](#) [CZ1420-000](#) [D-306-38](#) [770-006S302](#) [770-010Y106W1](#) [770-020S705](#) [MFP-3/64"-Clear](#) [790-3012](#) [MHHT-4-15K2-G-104](#) [8003012003](#) [MIL-LT-1-1/2-4-SP](#) [MIL-LT-1-1/2-9-STK](#) [MIL-LT-1/2-2-STK](#) [MIL-LT-3-0-SP](#) [MIL-LT-3/32-0-SP](#) [MIL-LT-3/32-6-SP](#) [MIL-LT-3/4-4-STK](#) [MIL-LT-3/4-6-SP](#) [839602-000](#) [8423-6](#) [FP301-116-48"-Clear](#) [FP301-12-6"-Clear](#) [FP301-1/4-48"-White-Hdr](#) [FP301-18-48"-Black-Hdr](#) [FP301-1/8-6"-Black](#) [FP301-18-6"-Black-Bulk](#) [FP301-316-48"-Blue-Hdr](#) [912229N002](#) [R280637030](#) [HDCW-5515-1000](#) [HDT-0300-48A-BLACK](#) [HDT-0400-48A-Black](#) [HDT-0800-48A-RED](#) [HDT1100-48A-BLK](#) [HDT1500-48A-BLK](#) [HDT-2000-48A-Black](#) [RHW-70/20-1200/ADH-0](#) [DWP-125-0.450-4-55MM-CS879](#) [156082-000](#) [MT5500-3/8-X-SP](#) [MT-FEP-045-032-008-X-60IN](#) [EPS200-1/4-48"-Black](#) [EPS200-1-48"-Black](#) [EPS200-3/16-48"-Black](#)