

### K41 Series Make & Break Load Switching — 5.0 kV Relays

#### K41A, K41B Product Facts

- High current carry rating
- Vacuum dielectric for power switching low current loads
- Glazed ceramics for low current leakage
- Compact, space-saving design
- Meets requirements of MIL-R-83725
- QPL versions available, M83725/21 & M83725/22

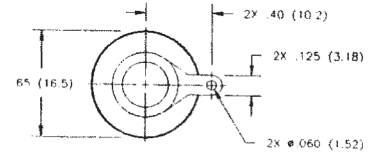
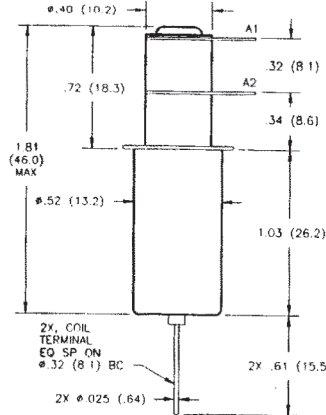
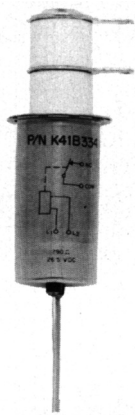

#### K41C Product Facts

- Single pole, double throw version
- Vacuum dielectric for power switching low current loads
- RF ratings to 32 MHz
- Long life: 2 million cycles
- Meets requirements of MIL-R-83725
- QPL version available, M83725/23

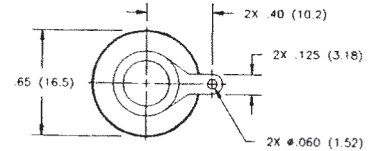
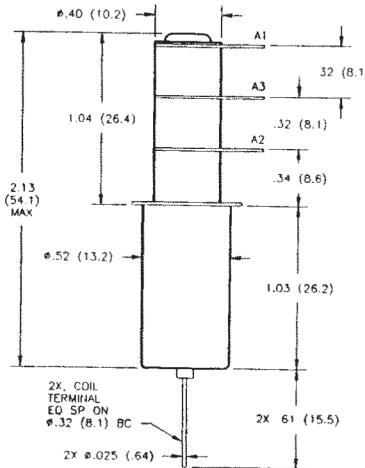
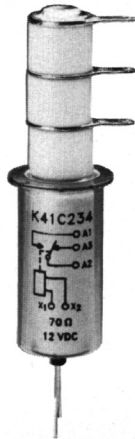

#### Product Specifications for K41A, K41B and K41C

##### Contact Arrangement —

K41A — SPST-NO  
K41B — SPST-NC  
K41C — SPDT

##### Contact Form —

K41A — A  
K41B — B  
K41C — C

**Test Voltage, DC or 60 Hz (Peak) —**  
6 kV

##### Rated Operating Voltage (Peak) —

DC or 60 Hz — 5 kV  
2.5 MHz — 4.5 kV  
16 MHz — 3.5 kV  
32 MHz — 2.8 kV

##### Continuous Carry Current, Max. —

DC or 60 Hz — 30 A  
2.5 MHz — 24 A  
16 MHz — 16 A  
32 MHz — 12 A  
Coil Hi-Pot (Vrms, 60 Hz) — 500 A

##### Contact Capacitance —

Between Open Contacts — 1.2 pF  
Open Contacts to Ground — 1.2 pF

##### Contact Resistance, Max. —

0.02 ohm

##### Operate Time, Max. —

10 ms

##### Release Time, Max. —

10 ms

##### Shock, 11ms, 1/2 Sine (Peak) —

50 g

##### Vibration —

Peak — 10 g (55 to 2000 Hz)

##### Operating Ambient Temperature Range —

-55°C to +125°C

##### Mechanical Life —

2 million cycles

##### Weight, Nominal —

28.35 g (1.0 oz.)

#### Coil Data

Nominal Volts DC	12 Vdc	26.5 Vdc	115 Vdc
Pickup, Max.	8 Vdc	16 Vdc	80 Vdc
Dropout	.5-5 Vdc	1-10 Vdc	5-50 Vdc
Coil Resistance (±10%)	70 Ω	290 Ω	4700 Ω

Ratings listed are for 25°C, sea level conditions

#### Ordering Information

##### Sample Part Number ▶

**K41 A 3 3 4**

##### Series: \_\_\_\_\_

##### Contact Form: \_\_\_\_\_

A = SPST-NO    B = SPST-NC    C = SPDT

##### Coil Voltage: \_\_\_\_\_

2 = 12 Vdc, Bus Wire    3 = 26.5 Vdc, Bus Wire  
5 = 115 Vdc, Bus Wire    7 = 12 Vdc, Turret Terminal\*  
8 = 26.5 Vdc, Turret Terminal\*  
9 = 115 Vdc, Turret Terminal\*

##### High Voltage Connections: \_\_\_\_\_

3 = Solder Connection

##### Mounting: \_\_\_\_\_

2 = Flanged    4 = Standard

For factory-direct application assistance, dial 800-253-4560, ext. 2055, or 805-220-2055.

**\*See page 7-87 for turret terminal dimensions and mounting methods.**

**K41 Series Make & Break Load Switching — 5.0 kV Relays**

**K41P**

**Product Facts**

- Fast, 6 millisecond operate time
- Vacuum dielectric for power switching low current loads
- Latching actuator for low power consumption
- Ideal for frequency agile communication systems
- Meets requirements of MIL-R-83725
- QPL version available, M83725/24

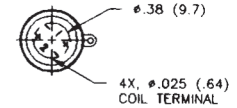
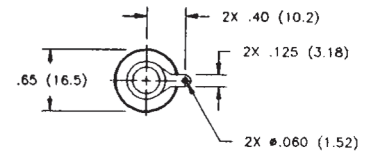
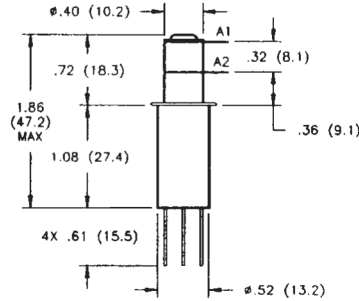
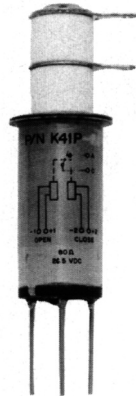

**K41R**

**Product Facts**

- Latching actuator for low power consumption
- Vacuum dielectric for power switching low current loads
- Meets requirements of MIL-R-83725
- Latching version of K41C

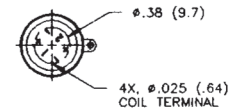
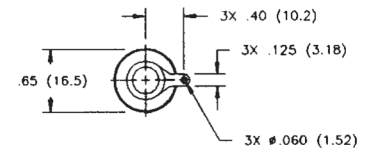
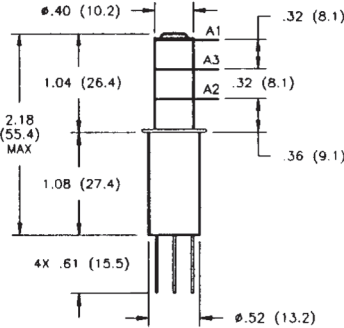
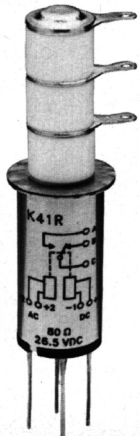

**Product Specifications for K41P and K41R**

**Contact Arrangement** —  
 K41P — SPST-Latching  
 K41R — SPDT-Latching

**Contact Form** —  
 K41P — P  
 K41R — R

**Test Voltage, DC or 60 Hz (Peak)** —  
 6 kV

**Rated Operating Voltage (Peak)** —  
 DC or 60 Hz — 5 kV  
 2.5 MHz — K41P — 4.5 kV  
                   K41R — 4.0 kV  
 16 MHz — K41P — 3.5 kV  
                   K41R — 3.2 kV  
 32 MHz — K41P — 2.8 kV  
                   K41R — 2.5 kV

**Continuous Carry Current, Max.** —  
 DC or 60 Hz — 30 A  
 2.5 MHz — K41P — 20 A  
                   K41R — 16 A  
 16 MHz — K41P — 13 A  
                   K41R — 10 A  
 32 MHz — K41P — 10 A  
                   K41R — 6 A  
 Coil Hi-Pot (Vrms, 60 Hz) — 500 A

**Contact Capacitance** —  
 Between Open Contacts —  
 K41P — 1.2 pF  
 K41R — 1.6 pF  
 Open Contacts to Ground —  
 K41P — 1.2 pF  
 K41R — 1.6 pF

**Contact Resistance, Max.** —  
 0.02 ohm

**Operate Time, Max.** — 6 ms

**Release Time, Max.** — N/A

**Shock, 11ms, 1/2 Sine (Peak)** —  
 K41P — 50 g  
 K41R — 30 g

**Vibration** —  
 Peak — 10 g (55 to 2000 Hz)

**Operating Ambient Temperature Range** — -55°C to +125°C

**Insulation Resistance** —  
 Initial — 10 gigaohms

**Mechanical Life** — 1 million cycles

**Weight, Nominal** —  
 28.35 g (1.0 oz.)

**Coil Data**

Volts, Nominal	26.5 Vdc
Reset & Latch, Max.	16 Vdc
Dropout	N/A
Coil Resistance (±10%)	80 Ω

Ratings listed are for 25°C, sea level conditions.

**Ordering Information**

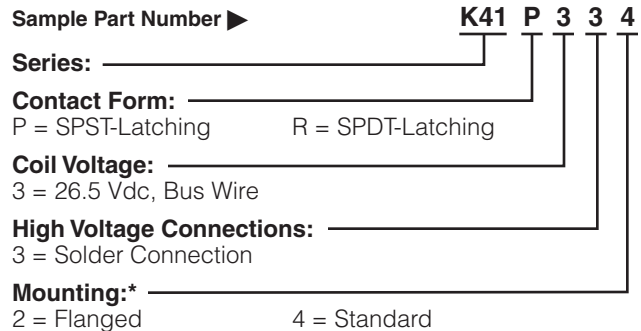

\*See page 7-87 for mounting methods.

For factory-direct application assistance, dial 800-253-4560, ext. 2055, or 805-220-2055.

## X-ON Electronics

Largest Supplier of Electrical and Electronic Components

*Click to view similar products for [Industrial Relays](#) category:*

*Click to view products by [TE Connectivity](#) manufacturer:*

Other Similar products are found below :

[6-1617801-8](#) [6-1618107-9](#) [7-1618273-3](#) [EV250-4A-02](#) [EV250-6A-01](#) [FCA-125-CX8](#) [FCA-325-159](#) [FCA-410-138](#) [8000-S3121](#) [8-1618273-6](#)  
[8-1618393-1](#) [GCA63A220VAC60HZ](#) [GCA63A277VAC60HZ](#) [GCA63A600VAC60HZ](#) [1-1672275-3](#) [1-1833005-4](#) [H-16/S1](#) [A711Z](#) [H-8C](#)  
[H-8/S11](#) [H-8/S68](#) [ACC530U20](#) [ACC730U30](#) [RF303ZM4-12](#) [DH18DA](#) [1423675-8](#) [AR4-15F13-C01](#) [AR7-41F11](#) [AVR907](#) [15732A200](#)  
[B07B032AC1-0329](#) [B329](#) [B490A](#) [1618279-1](#) [BHR124Y](#) [1810DDB-SX](#) [N417](#) [P30C42A12D1-120](#) [2-1617748-6](#) [2-1618375-1](#) [2-1618396-6](#)  
[2-1618398-1](#) [JMAPD-5XL](#) [JMGACD-5M](#) [JMGSC-5LW](#) [JMGSCD-5L](#) [PBO-18A1218](#) [PBO-40A3040](#) [K8DSPH1200480VAC](#) [KA-3C-12A](#)