

| REVISIONS |     |                           |           |     |      |
|-----------|-----|---------------------------|-----------|-----|------|
| P         | LTR | DESCRIPTION               | DATE      | DWN | APVD |
| B         |     | REVISED PER ECO-16-018096 | 30MAY2017 | RK  | PO   |

SPECIFICATIONS:  
 MAKE-BEFORE-BREAK

MATERIALS:  
 ACTUATOR - NYLON 66 UL94V-0, BLACK  
 FRAME - TIN PLATED STEEL  
 TERMINAL BOARD - PHENOLIC LAMINATE UL94HB, NATURAL  
 TERMINAL (SILVER) - COPPER ALLOY- SILVER OVER NICKEL PLATE  
 TERMINAL (GOLD) - COPPER ALLOY- TIN OVER NICKEL PLATE  
 FIXED CONTACT (SILVER) - COPPER ALLOY- SILVER OVER NICKEL PLATE  
 FIXED CONTACT (GOLD) - COPPER ALLOY-GOLD OVER NICKEL PLATE  
 MOVING CONTACT (SILVER) - COPPER ALLOY- SILVER OVER NICKEL PLATE  
 MOVING CONTACT (GOLD) - COPPER ALLOY-GOLD OVER NICKEL PLATE  
 DETENT BALL - STAINLESS STEEL  
 COIL SPRING - TEMPERED STEEL WIRE  
 SEAL - EPOXY

ELECTRICAL:  
 CONTACT RATING - .4VA@20VDC OR PEAK AC (GOLD)  
 300mA@125V AC (SILVER)  
 INITIAL CONTACT RESISTANCE - 30milliohm max.  
 FINAL CONTACT RESISTANCE - 100milliohm max> (AFTER TEST)  
 INSULATION RESISTANCE - 1,000Megohms min."  
 DIELECTRIC STRENGTH - 500V RMS@SEA LEVEL  
 LIFE EXPECTANCY - 15,000 CYCLES MIN."

MECHANICAL:  
 ACTUATION FORCE - 600±300 GRAMS  
 TRAVEL - 2.00±0.51[.079±.020]

ENVIRONMENTAL:  
 OPERATING TEMPERATURE - -20 TO +85 DEGREES C  
 STORAGE TEMPERATURE - -40 TO +100 DEGREES C  
 RESISTANCE TO SOLDER HEAT PER 109-202, CONDITION B  
 SOLDERABILITY PER EIA- 364-52, CLASS 2, CATEGORY 1, 95% MIN  
 COVERAGE

NOTES:

- ALL MATERIALS AND FINISHES SHALL COMPLY WITH EU DIRECTIVE 2002 95/EC OF 27JAN2003 (ROHS).
- ANTI SOLDER WICK SEAL AT TERMINAL TO BOARD INTERFACE.

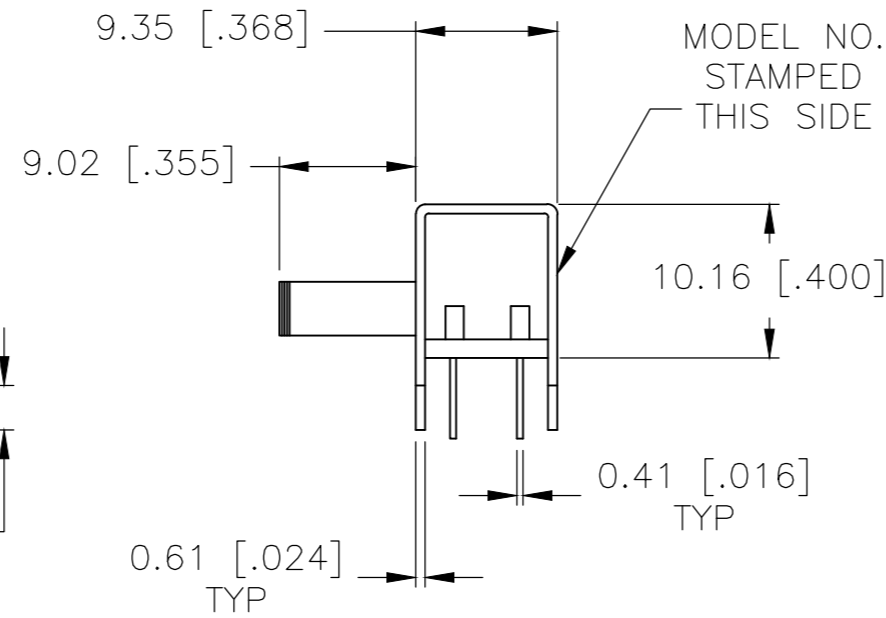
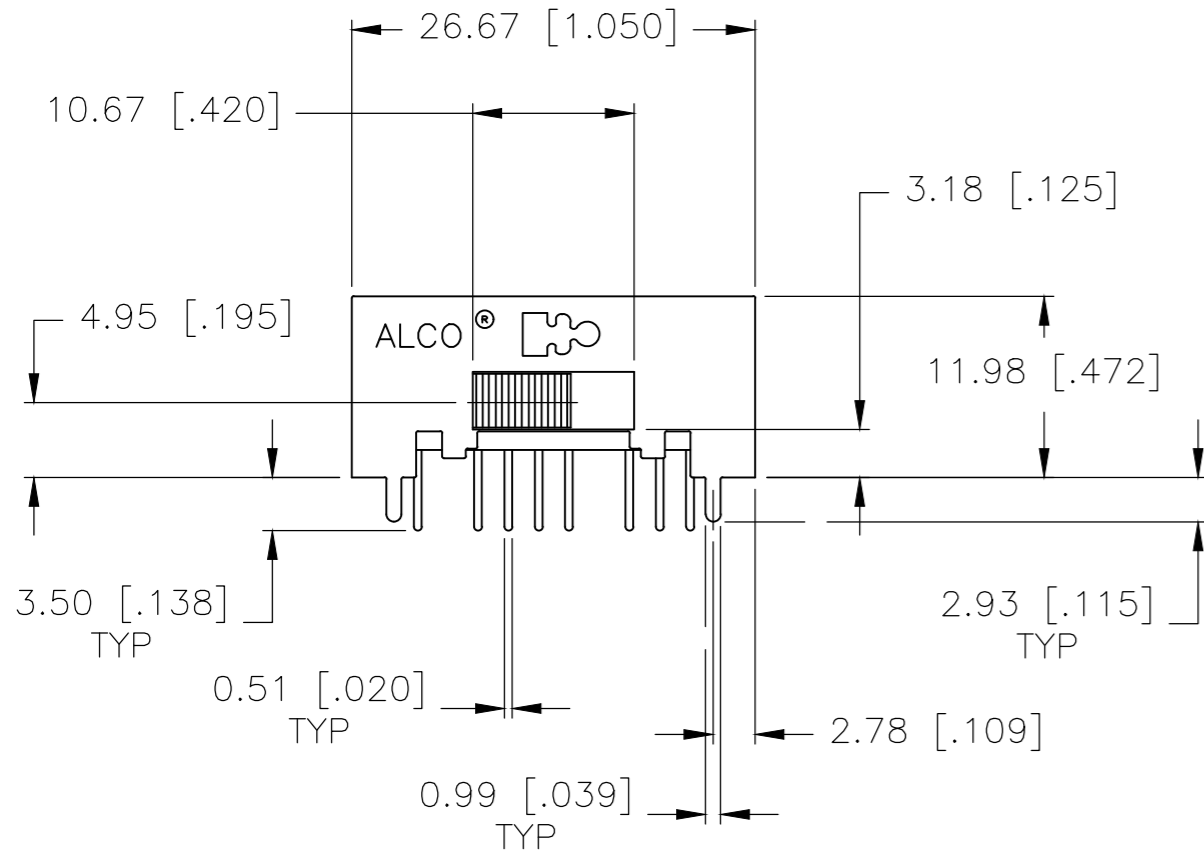
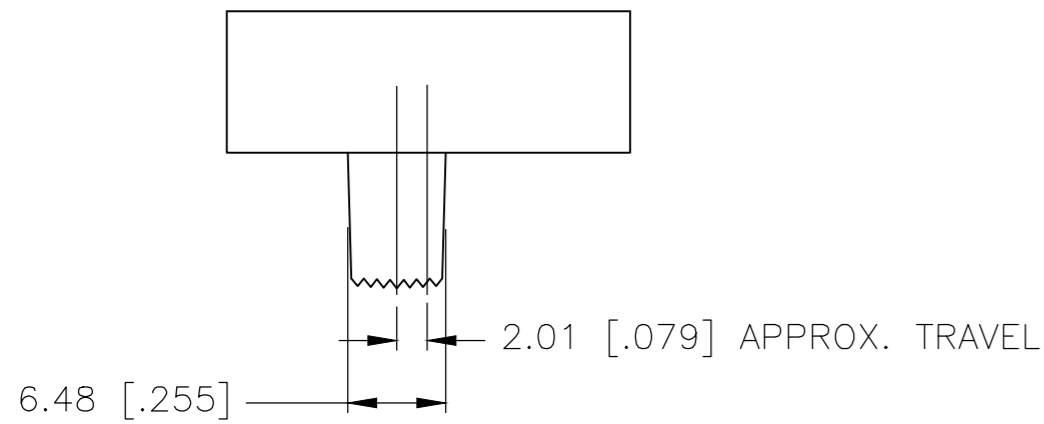

[\*] THIS TERMINAL SET IS NOT USED ON 3350 SERIES

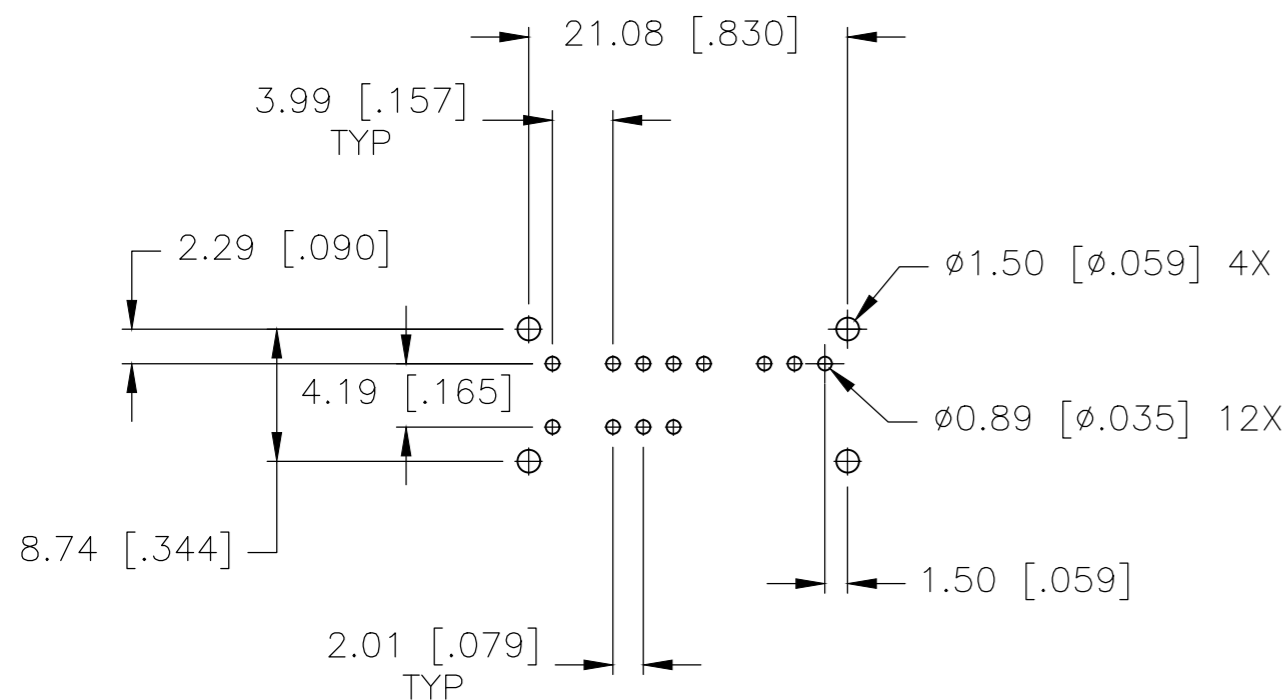
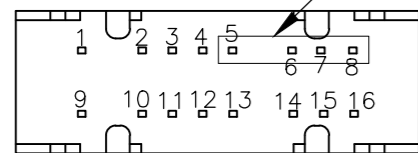

PC HOLE LAYOUT (TOP VIEW)  
 RECOMMENDED TOLERANCES ±.002

|                   |                           |                            |                            |      |                 |              |            |
|-------------------|---------------------------|----------------------------|----------------------------|------|-----------------|--------------|------------|
| OBSOLETE          | 1,2 & 5,6<br>9,10 & 13,14 | 2,3 & 5,7<br>10,11 & 13,15 | 2,4 & 5,8<br>10,12 & 13,16 | 4P3T | GOLD            | MSSA4350RG04 | 1825203-4  |
|                   | 1,2 & 5,6<br>9,10 & 13,14 | 2,3 & 5,7<br>10,11 & 13,15 | 2,4 & 5,8<br>10,12 & 13,16 | 4P3T | SILVER          | MSSA4350R04  | 1825203-3  |
| OBSOLETE          | 1,2, 9,10<br>&13,14       | 2,3, 10,11<br>&13,15       | 2,4, 10,12<br>&13,16       | 3P3T | GOLD            | MSSA3350RG04 | *1825203-2 |
|                   | 1,2, 9,10<br>&13,14       | 2,3, 10,11<br>&13,15       | 2,4, 10,12<br>&13,16       | 3P3T | SILVER          | MSSA3350R04  | *1825203-1 |
|                   |                           |                            |                            | TYPE | CONTACT PLATING | ALCO P/N     | TE P/N     |
| ACTUATOR POSITION |                           |                            |                            |      |                 |              |            |

|  |                    |                  |            |  |           |            |               |
|--|--------------------|------------------|------------|--|-----------|------------|---------------|
| THIS DRAWING IS A CONTROLLED DOCUMENT. |                    | DWN              | 19SEP96    |  |           |            |               |
| DIMENSIONS: mm [INCHES]                |                    | CHK              | C.THEODORE |  |           |            |               |
| TOLERANCES UNLESS OTHERWISE SPECIFIED: |                    | APVD             | -          | NAME                                     |           |            |               |
| 0 PLC ± -                              |                    | PRODUCT SPEC     | -          | SLIDE SWITCH, 3 POS. (MSSA-3350R SERIES) |           |            |               |
| 1 PLC ± -                              |                    | APPLICATION SPEC | -          | SIZE                                     | CAGE CODE | DRAWING NO | RESTRICTED TO |
| 2 PLC ± 0.25[.010]                     |                    | WEIGHT           | -          | A2                                       | 00779     | C=1825203  | -             |
| 3 PLC ± -                              |                    | CUSTOMER DRAWING | -          | SCALE                                    | SHEET     | REV        |               |
| 4 PLC ± -                              |                    |                  |            | 2:1                                      | 1 of 1    | B          |               |
| ANGLES ± 1°                            |                    |                  |            |  |           |            |               |
| MATERIAL                               | FINISH             |                  |            |  |           |            |               |
| SEE SPECIFICATIONS                     | SEE SPECIFICATIONS |                  |            |  |           |            |               |

## X-ON Electronics

Largest Supplier of Electrical and Electronic Components

*Click to view similar products for [Slide Switches](#) category:*

*Click to view products by [TE Connectivity](#) manufacturer:*

Other Similar products are found below :

[6-1437581-1](#) [M43R](#) [MHSS1104A](#) [MMD](#) [GH36W010001](#) [GH49S010001](#) [1437576-8](#) [EPS1PC1](#) [1825074-1](#) [1825160-3](#) [1825167-2](#)  
[25139NLDB](#) [25449NAH](#) [L101011ML04B](#) [SLB1240R45](#) [SLSA12004](#) [1825078-1](#) [1825080-4](#) [1825081-1](#) [1825269-1](#) [1825270-2](#)  
[STS141RA04](#) [T2215BEN506](#) [GF-124-0204](#) [GH46P000001](#) [GH46W000001](#) [GH49P010001](#) [25339NA](#) [25436NLDH](#) [CST91246FK](#)  
[TG36P000000](#) [TG36P000050](#) [47227LFE](#) [49331L](#) [MHSS1105A](#) [50208L](#) [L202091MS02Q](#) [4-1437581-7](#) [X2225CR-437W](#) [48BFSP3M2QT](#)  
[49329L](#) [1101M1S3ZB8E2](#) [1-1437581-1](#) [EG1218REDACTUATOR](#) [TG39W000000](#) [1825075-1](#) [TG36WS80065](#) [T105S1CWZBE](#)  
[SLB1280R5](#) [25136NLDB](#)