



DEUTSCH



NGC Series

4, 6 & 12 poles

Signal connector according to NF F 61-030

■ Technical Characteristics

Electrical

Insulation Resistance : > 5000 M Ω
Crimp Contact : AWG16 (0,5 à 2,5 mm²)
Cable Capacities :
EN 50306-2 cat. M : 0,5 to 2,5 mm²
EN 50264-2-1 & EN 50264-3-1 (type 0.6/1 kV) : up to 1,5 mm²
Grommet Capacity : \varnothing 1,15 to 2,85 mm
Service Voltage : 220 V AC/DC according NF F 61-030
500 V AC/DC according EN 50124-1/A2 (OV3-PD2)
Withstanding voltage : 2550 V according NF F 61-030
3500 V according to EN 50124-1/A2 (OV3-PD2)
Nominal Current : up to 20 A

Physico-chimique

Service Temperature : -40°C +100°C (-40°F +212°F)
Salt Spray > 250 hours
Protection Index : IP 66 mated according to EN 60529
Fluid Resistance : gasoil, mineral oil, acid, base and cutting fluid

Material

Contact : Gold or silver plated brass
Female and Male Shells : Fiber glass reinforced polyamide
Fire & Smoke :
Requirement 2 according to NF F 16-101 & NF F 16-102
UL94V0
Grommet and Interfacial Seal : Silicone
Fire & Smoke :
Requirement 2 according to NF F 16-101 & NF F 16-102

Mechanical

Durability : 500 mating cycles
Vibration & Shocks resistance : category 1 class B according to EN 61373

Wiring Implementation Instructions

See FT10029

Arrangements

Size 4

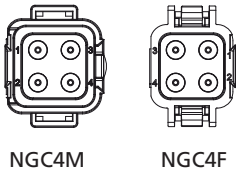

NGC4M

NGC4F

Size 6

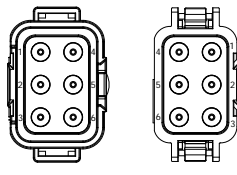

NGC6M

NGC6F

Size 12

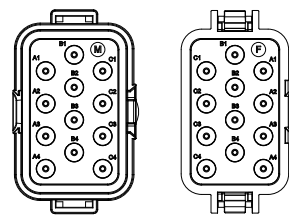

NGC12M

NGC12F

M : Male - F : Female

Part Numbers & Dimensions

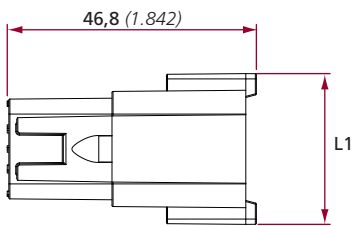

Male Plug

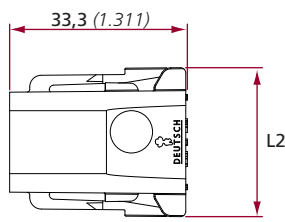

Female Plug

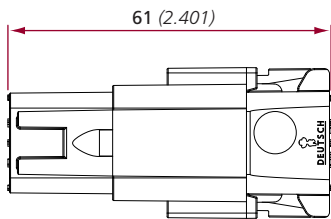

Mated Connector

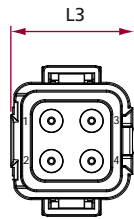

Size	Part Number	L1	L2	L3	Weight*
4	NGC4F	28,5 (1.122)	28,2 (1.110)	23,7 (0.933)	14,9 g
	NGC4M				17 g
6	NGC6F	36,2 (1.425)	35,9 (1.413)	23,7 (0.933)	20,4 g
	NGC6M				23 g
12	NGC12F	47,6 (1.874)	47,3 (1.862)	29,3 (1.153)	36,8 g
	NGC12M				38,5 g

mm / (inch)

Accessory : Strain Relief (mm/inch)

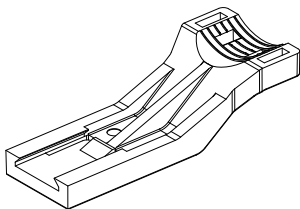

Part Number : **NGCASC**

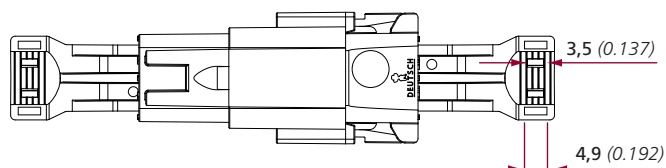
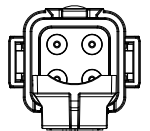
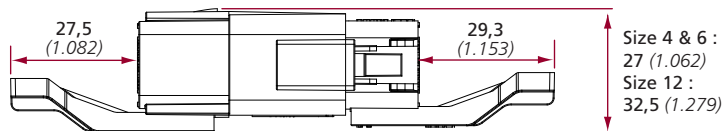

Cables tightening with a plastic collar

Accessory for Male Plug only : Panel Bracket (mm/inch)

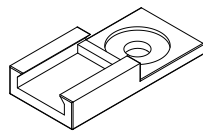

Part Number : **NGCAFP**

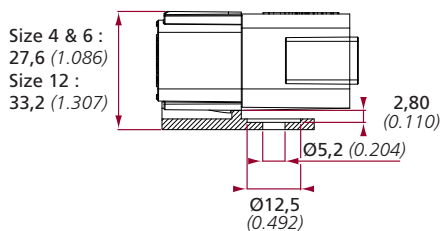

Contacts



Caliber	Plating	Cable section	Part Number MALE	Crimping Tool	Locator	Insertion Tool	Extraction Tool
Ø1,6 mm	Ag	0,5 to 1,82 mm ² (AWG 20 to 15)	SRCS205589-A00	OUT0405-0167AS0 (FT8)	OUTS208448	OUT0405-0337AS	OUTEXT-0321
Ø1,6 mm	Au	0,5 to 1,82 mm ² (AWG 20 to 15)	SRCS205589-A01	OUT0405-0167AS0 (FT8)	OUTS208448	OUT0405-0337AS	OUTEXT-0321
Ø1,6 mm	Ag	1,34 to 2,61 mm ² (AWG 15 to 13)	SRCS209432-A00	OUT0405-0167AS0 (FT8)	OUTS208448	OUT0405-0337AS	OUTEXT-0321
Ø1,6 mm	Au	1,34 to 2,61 mm ² (AWG 15 to 13)	SRCS209432-A01	OUT0405-0167AS0 (FT8)	OUTS208448	OUT0405-0337AS	OUTEXT-0321

Caliber	Plating	Cable section	Part Number FEMALE	Crimping Tool	Locator	Insertion Tool	Extraction Tool
Ø1,6 mm	Ag	0,5 to 1,82 mm ² (AWG 20 to 15)	SRCS202416-A00	OUT0405-0167AS0 (FT8)	OUT0405-0176AS (TP1012)	OUT0405-0337AS	OUTEXT-0321
Ø1,6 mm	Au	0,5 to 1,82 mm ² (AWG 20 to 15)	SRCS202416-A01	OUT0405-0167AS0 (FT8)	OUT0405-0176AS (TP1012)	OUT0405-0337AS	OUTEXT-0321
Ø1,6 mm	Ag	1,34 to 2,61 mm ² (AWG 15 to 13)	SRCS202420-A00	OUT0405-0167AS0 (FT8)	OUT0405-0176AS (TP1012)	OUT0405-0337AS	OUTEXT-0321
Ø1,6 mm	Au	1,34 to 2,61 mm ² (AWG 15 to 13)	SRCS202420-A01	OUT0405-0167AS0 (FT8)	OUT0405-0176AS (TP1012)	OUT0405-0337AS	OUTEXT-0321

Ag : Silver plated - Au : Gold plated

CARRIER KHÉOPS BAC

ZAC Le Monné - Rue du Champ du Verger - CS 30009 - 72705 ALLONNES CEDEX - FRANCE
Tel : +33 (0)2 43 61 45 45 - Fax : +33 (0)2 43 61 45 00 - E-mail : railway@deutsch.net - www.deutsch.net

DEUTSCH reserves the right to alter the specifications of the products described in this document without prior notice.
Overall dimensions and specifications are given for guidance only. For further details, please contact us.

X-ON Electronics

Largest Supplier of Electrical and Electronic Components

Click to view similar products for [Automotive Connectors](#) category:

Click to view products by [TE Connectivity](#) manufacturer:

Other Similar products are found below :

[003-018-000](#) [60403001](#) [60993906-B](#) [M902-2131](#) [M902-2161](#) [M902-2344](#) [72.330.1035.1](#) [73.353.4028.0](#) [F119300-B](#) [F166900](#) [F258300-B](#)
[F358300-B](#) [F407400](#) [F444110](#) [F487000](#) [F509500B-B](#) [827153-1](#) [8N1515-32-24P](#) [9-1326729-8](#) [925474-1](#) [928905-1](#) [964562-4](#) [968782-1](#)
[GT17SA-8DS-HU](#) [98891-1012](#) [98947-1016](#) [12004147](#) [12004475-L](#) [12010290](#) [12010309-B](#) [12015454](#) [12020219-B](#) [12041318-B](#) [12052225-](#)
[L](#) [12052466](#) [12064869](#) [12004327-B](#) [12015308](#) [12015384](#) [12015909](#) [1-21030-1](#) [12041254](#) [12041318](#) [12047946-B](#) [12047957](#) [12047957-L](#)
[12059473](#) [12066261](#) [12110546](#) [12110546-B](#)