

THIS DRAWING IS UNPUBLISHED. RELEASED FOR PUBLICATION  
 © COPYRIGHT - By - ALL RIGHTS RESERVED.

REVISIONS				
P	LTR	DESCRIPTION	DATE	APVD
F3		ADD NEW PN ECO-19-001188	24-Jan-19	WQ.Y K.T
F4		ADD NEW PN ECO-19-017773	21-Nov-19	WQ.Y K.T

FIG A

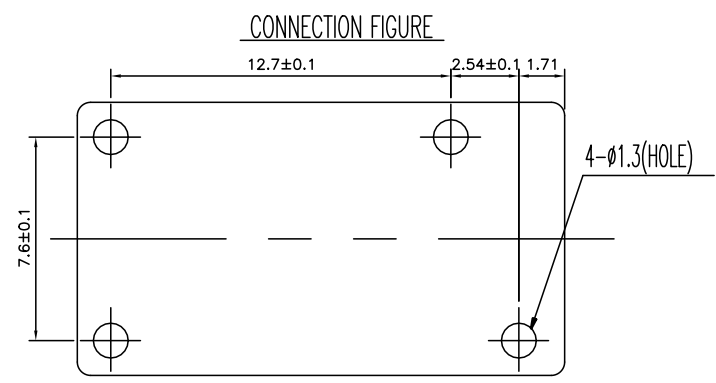
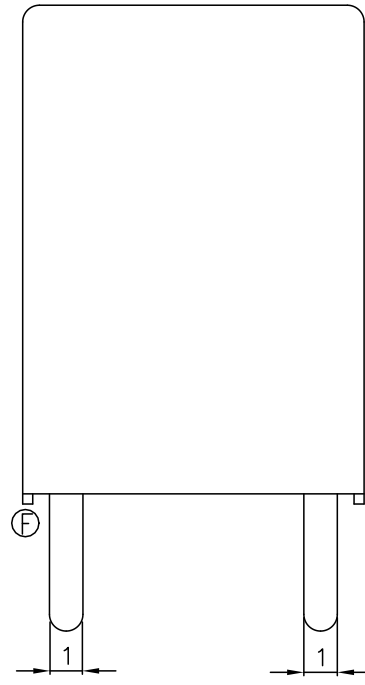
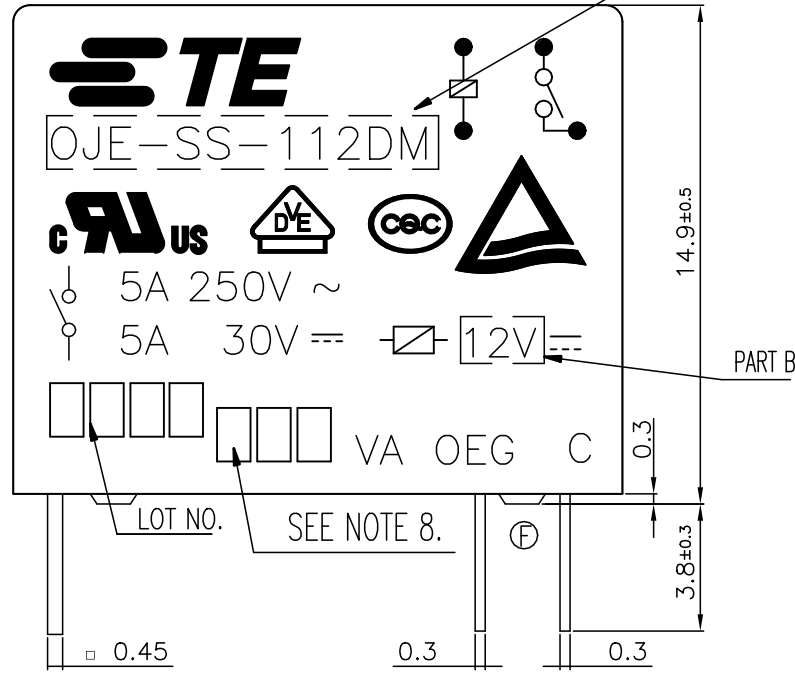
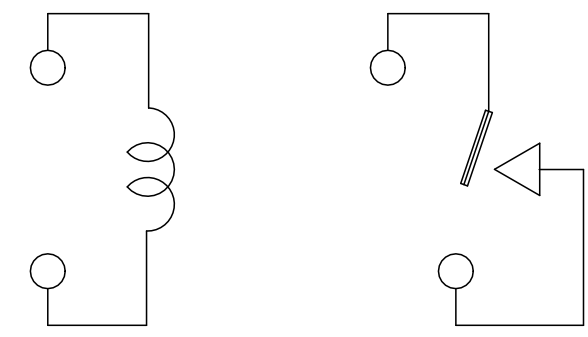

FIGURE FOR PRINTED CIRCUIT BOARD PROCESSING (BOTTOM VIEW)

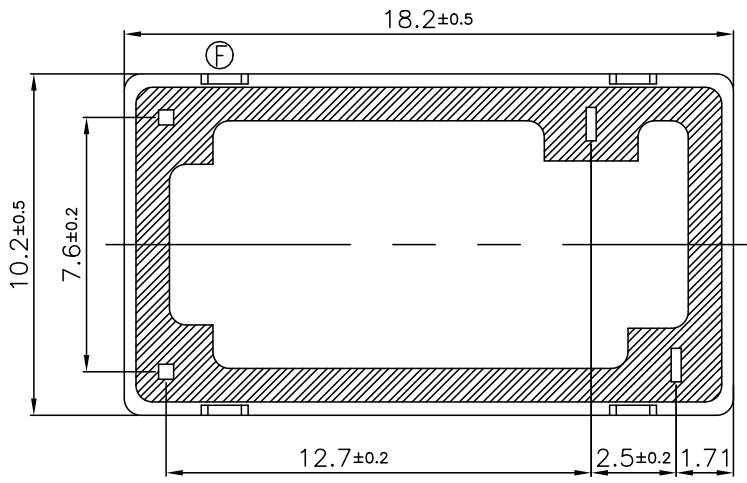

Diagram dimension	Tolerance
0.99mm max.	±0.1mm
1 - 2.99mm	±0.2mm
3mm min.	±0.3mm

THIS DRAWING IS A CONTROLLED DOCUMENT.		DWN Huang.Yunshou	TE Connectivity	
DIMENSIONS: mm		CHK Fu.Bo		
TOLERANCES UNLESS OTHERWISE SPECIFIED:		APVD Zhang.Sunny	NAME	
0 PLC ± -		PRODUCT SPEC	-	
1 PLC ± -		APPLICATION SPEC	-	
2 PLC ± -		WEIGHT	SIZE	RESTRICTED TO
3 PLC ± -			A3	-
4 PLC ± -			CAGE CODE	DRAWING NO
ANGLES ± -			00779	C=1649222
FINISH				
MATERIAL				
CUSTOMER DRAWING			SCALE	SHEET
			5:1	1 OF 3
				REV
				F4

THIS DRAWING IS UNPUBLISHED. RELEASED FOR PUBLICATION  
 © COPYRIGHT - By - ALL RIGHTS RESERVED.

REVISIONS

P	LTR	DESCRIPTION	DATE	DWN	APVD
-	-	SEE SHEET 1	-	-	-

FIG B



PART A

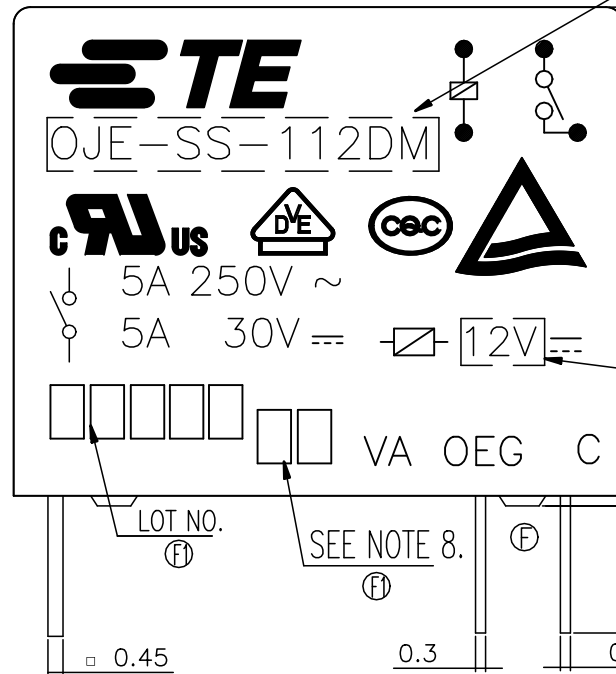

PART B

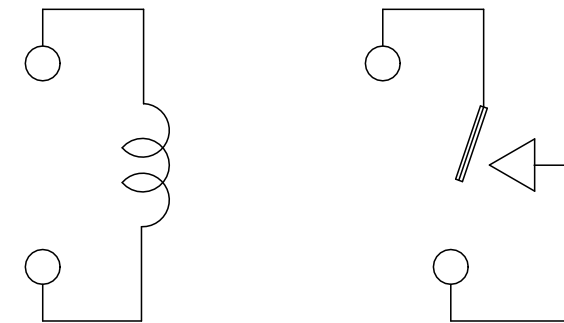
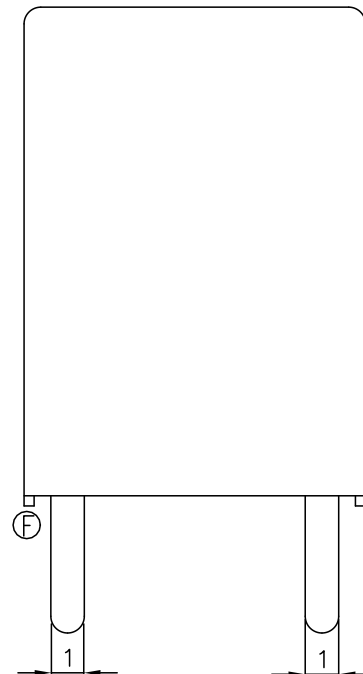

CONNECTION FIGURE

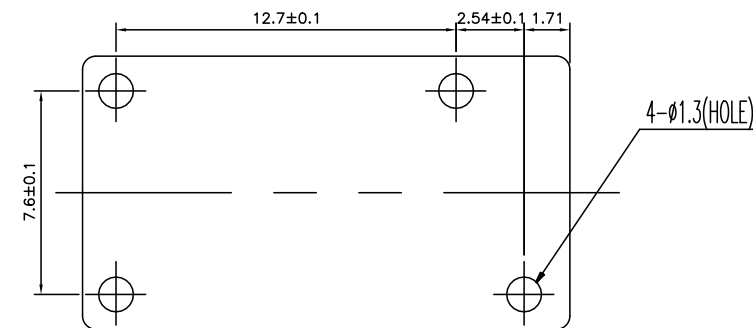
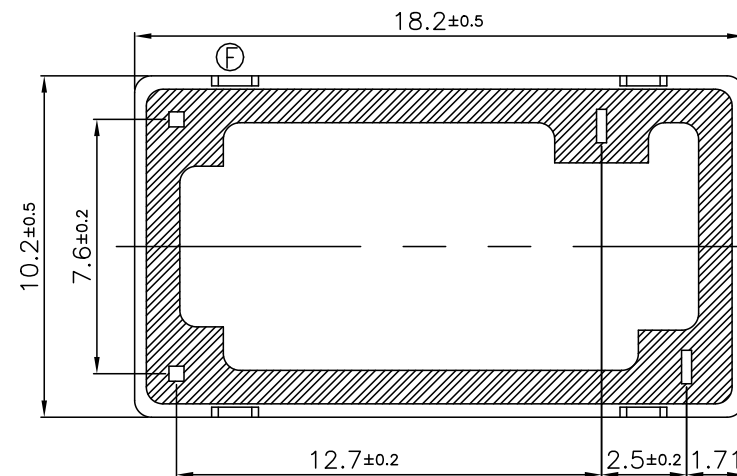

FIGURE FOR PRINTED CIRCUIT BOARD PROCESSING (BOTTOM VIEW)

Diagram dimension	Tolerance
0.99mm max.	±0.1mm
1 - 2.99mm	±0.2mm
3mm min.	±0.3mm



THIS DRAWING IS A CONTROLLED DOCUMENT.		DWN Huang.Yunshou	TE Connectivity	
DIMENSIONS: mm		CHK Fu.Bo		
TOLERANCES UNLESS OTHERWISE SPECIFIED:		APVD Zhang.Sunny	NAME -	
0 PLC ±-		PRODUCT SPEC -	OJE-DM VA TYPE CUSTOMER DRAWING	
1 PLC ±-		APPLICATION SPEC -	SIZE A3	CAGE CODE 00779
2 PLC ±-		WEIGHT -	DRAWING NO C=1649222	RESTRICTED TO -
3 PLC ±-				
4 PLC ±-				
ANGLES ±-				
FINISH -		SCALE 5:1 SHEET 2 OF 3 REV F4		

REVISIONS				
P	LTR	DESCRIPTION	DATE	APVD
-	-	SEE SHEET 1	-	-

FIG B

- PART "B" SHOULD FIT PART "A" AFTER CASE INSERTION PROCESS.
- NO SEALING MATERIAL DROP OUT BEYOND LINE "C"
- SEALING MATERIAL TO BE DROPPED IN HATCHED AREA AS SHOWN.
- LOT NO. SYSTEM AS FOLLOWING:

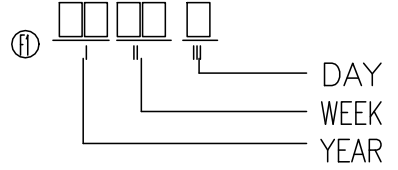

- III, DIGITS FOR DAY OF THE WEEK  
 1...MONDAY IN THIS WEEK;  
 2...TUESDAY IN THIS WEEK;  
 .....  
 7...SUNDAY IN THIS WEEK

- TERMINAL DIMENSIONS BEFORE SOLDER DIP.
- FOR THE TIN-PLATING OF THE PINS: +0.1mm FOR WIDTH. THICKNESS AND DIAMETER +0.5mm FOR LENGTH.
- USED WELDED CONTACT & LASER MARKING.
- ADD LOT NO. SYSTEM AS FOLLOWING;



- I, DIGITS FOR SHIFT OF THE DAY  
 1...DAY SHIFT IN THIS DAY;  
 2...NIGHT SHIFT IN THIS DAY;  
 II, ONE CHARACTER DISTINGUISH THE LINE IDENTITY, SUCH AS: A,B.....Z

F4	A	1-1649222-2	OJE-SH-112DM	12V	OJE-SH-112DM	I
F3	B	1-1649222-1	OJE-SS-112DM	12V	OJE-SS-112DM	k
F3		1-1649222-0	OJE-SS-112DM	12V	OJE-SS-112DM	j
F3	B	1649222-9	OJE-SS-112DM	12V	OJE-SS-112DM	i
F2	A	1649222-8	OJE-SH-112DM	12V	OJE-SH-112DM,00B00	h
F2	B	1649222-7	OJE-SS-112DM	12V	OJE-SS-112DM,00000W	g
F		1649222-6	OJE-SS-112DM	12V	OJE-SS-112DM,0A000	f
E	B	1649222-5	OJE-SS-112DM	12V	OJE-SS-112DM,000G0	e
A	A	1649222-4	OJE-SH-112DM	12V	OJE-SH-112DM,801	d
		1649222-3	OJE-SS-124DM	24V	OJE-SS-124DM,801	c
		1649222-2	OJE-SS-112DM	12V	OJE-SS-112DM,801P	b
F1	B	1649222-1	OJE-SS-112DM	12V	OJE-SS-112DM,801	a
FIG	TE PART NO	PART A	PART B	DESCRIPTION	TYPE	

FIG A

- PART "B" SHOULD FIT PART "A" AFTER CASE INSERTION PROCESS.
- NO SEALING MATERIAL DROP OUT BEYOND LINE "C"
- SEALING MATERIAL TO BE DROPPED IN HATCHED AREA AS SHOWN.
- LOT NO. SYSTEM AS FOLLOWING:

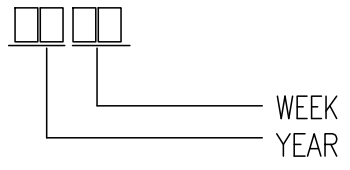

- TERMINAL DIMENSIONS BEFORE SOLDER DIP.
- FOR THE TIN-PLATING OF THE PINS: +0.1mm FOR WIDTH. THICKNESS AND DIAMETER +0.5mm FOR LENGTH.
- USED WELDED CONTACT & LASER MARKING.
- ADD LOT NO. SYSTEM AS FOLLOWING;



- I, DIGITS FOR DAY OF THE WEEK  
 1...MONDAY IN THIS WEEK;  
 2...TUESDAY IN THIS WEEK;  
 .....  
 7...SUNDAY IN THIS WEEK  
 II, DIGITS FOR SHIFT OF THE DAY  
 1...DAY SHIFT IN THIS DAY;  
 2...NIGHT SHIFT IN THIS DAY;  
 III, ONE CHARACTER DISTINGUISH THE LINE IDENTITY, SUCH AS: A,B.....Z

MATERIAL	DESCRIPTION	ITEM
EPOXY RESIN	SEAL (BASE & BOBBIN)	15
3UEW	MAGNETIC WIRE	14
P.B.T	CASE	13
P.B.T	BASE	12
P.B.T	BOBBIN	11
C.P WIRE	COIL TERMINAL	10
P.P.S	CARD	9
Ag	MOVABLE CONTACT	8
Ag	NO.CONTACT	7
STEEL	HINGE SPRING	6
Cu ALLOY	NO.TERMINAL	5
Cu ALLOY	MOVABLE SPRING	4
STEEL	CORE	3
STEEL	ARMATURE	2
STEEL	YOKE	1

THIS DRAWING IS A CONTROLLED DOCUMENT.		DWN Huang.Yunshou	TE Connectivity	
		CHK Fu.Bo		
DIMENSIONS: mm		APVD Zhang,Sunny	NAME	
		PRODUCT SPEC		OJE-DM VA TYPE CUSTOMER DRAWING
TOLERANCES UNLESS OTHERWISE SPECIFIED:		APPLICATION SPEC		
MATERIAL		WEIGHT 0	SIZE A3	CAGE CODE 00779
		DRAWING NO C=1649222		RESTRICTED TO
		CUSTOMER DRAWING		SCALE 5:1
				SHEET 3 OF 3
				REV F4

## X-ON Electronics

Largest Supplier of Electrical and Electronic Components

*Click to view similar products for [Low Signal Relays - PCB category](#):*

*Click to view products by [TE Connectivity manufacturer](#):*

Other Similar products are found below :

[LZN4-US-DC12](#) [LZNQ4-US-DC24](#) [LZNQ4-US-DC48](#) [6-1617347-5](#) [6-1617353-3](#) [6-1617529-6](#) [M39016/20-054M](#) [67RPCX-3](#) [D3493L](#) [7-1393813-3](#) [741B8](#) [MF-11AM-24](#) [MF1201N12](#) [MF-17A-24](#) [FBR244D024/02CS](#) [80.010.4522.1](#) [FL-4036](#) [FLH-11D-6](#) [831A7](#) [MMS124](#) [FTR-B4GA006Z](#) [FW1210S02](#) [FW1521S01](#) [9-1393813-6](#) [9-1617582-5](#) [G6AK-2-H-DC5](#) [G6E-184P-ST-US-DC48](#) [G6G234CDC24](#) [A07A939BZ1-0388](#) [PZ-2A2420](#) [HB1-DC6V](#) [HB1-DC9V](#) [R10-14A10-240](#) [R10-14D10-12](#) [R10-5A10-120F](#) [R10-E1L8-S200](#) [R10-E2468-1](#) [R10-E4Z2-V700](#) [R10-T1L2N-115V](#) [R40-E1Z4-V50](#) [R40-E3Z4-V200](#) [R50-E2Y2-24](#) [HFW11130K01](#) [HFW1201W200](#) [RA30511121](#) [RA-5W-K](#) [RB06H2C12](#) [REL-MR- 60DC/21AU](#) [RG2ET-L-12V](#) [RG2ET-L2-9V](#)